

NOTE: CHAINAGES SHOWN ARE ALONG S. P. OF HARTFORD AVE

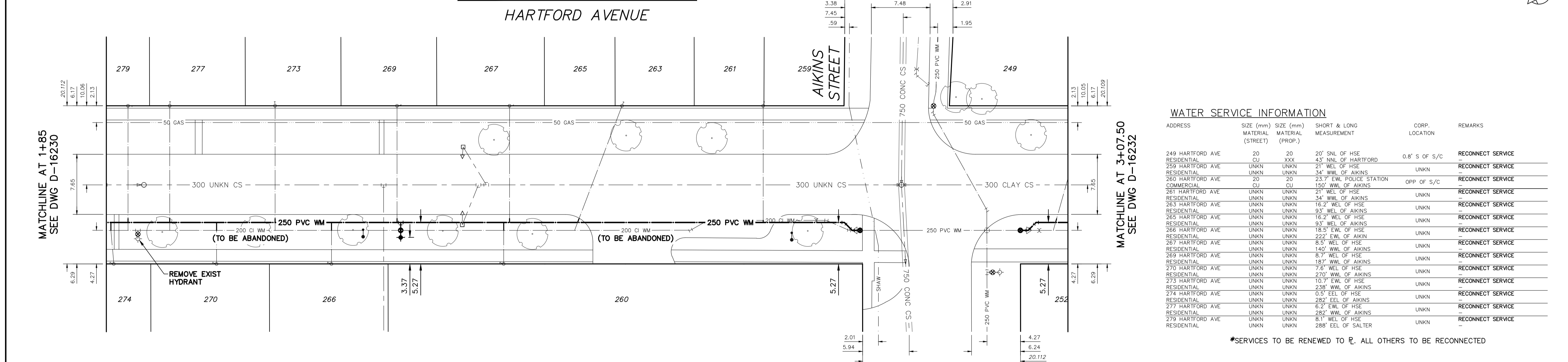

ADDRESS	SIZE (mm) MATERIAL (STREET)	SIZE (mm) MATERIAL (PROP.)	SHORT & LONG MEASUREMENT	CORP. LOCATION	REMARKS
249 HARTFORD AVE RESIDENTIAL	CU	XXX	20' SNL OF HSE 43' NNL OF HARTFORD	0.8' S OF S/C	RECONNECT SERVICE
259 HARTFORD AVE RESIDENTIAL	UNKN	UNKN	21' WEL OF HSE	UNKN	RECONNECT SERVICE
260 HARTFORD AVE COMMERCIAL	CU	CU	23.7' EWL POLICE STATION 150' WWL OF AIKINS	OPP OF S/C	RECONNECT SERVICE
261 HARTFORD AVE RESIDENTIAL	UNKN	UNKN	21' WEL OF HSE	UNKN	RECONNECT SERVICE
263 HARTFORD AVE RESIDENTIAL	UNKN	UNKN	16.2' WEL OF HSE	UNKN	RECONNECT SERVICE
265 HARTFORD AVE RESIDENTIAL	UNKN	UNKN	93' WEL OF AIKINS	UNKN	RECONNECT SERVICE
266 HARTFORD AVE RESIDENTIAL	UNKN	UNKN	18.5' EWL OF HSE	UNKN	RECONNECT SERVICE
267 HARTFORD AVE RESIDENTIAL	UNKN	UNKN	222' EWL OF AIKIN	UNKN	RECONNECT SERVICE
269 HARTFORD AVE RESIDENTIAL	UNKN	UNKN	5.5' WEL OF HSE	UNKN	RECONNECT SERVICE
270 HARTFORD AVE RESIDENTIAL	UNKN	UNKN	140' WWL OF AIKINS	UNKN	RECONNECT SERVICE
273 HARTFORD AVE RESIDENTIAL	UNKN	UNKN	8.7' WEL OF HSE	UNKN	RECONNECT SERVICE
274 HARTFORD AVE RESIDENTIAL	UNKN	UNKN	18.7' WWL OF AIKINS	UNKN	RECONNECT SERVICE
277 HARTFORD AVE RESIDENTIAL	UNKN	UNKN	270' WWL OF AIKINS	UNKN	RECONNECT SERVICE
279 HARTFORD AVE RESIDENTIAL	UNKN	UNKN	10.7' EWL OF HSE	UNKN	RECONNECT SERVICE
			238' WWL OF AIKINS	UNKN	RECONNECT SERVICE
			0.5' EEL OF HSE	UNKN	RECONNECT SERVICE
			282' EEL OF AIKINS	UNKN	RECONNECT SERVICE
			6.2' EWL OF HSE	UNKN	RECONNECT SERVICE
			282' WWL OF AIKINS	UNKN	RECONNECT SERVICE
			8.1' WEL OF HSE	UNKN	RECONNECT SERVICE
			288' EEL OF SALTER	UNKN	RECONNECT SERVICE

*SERVICES TO BE RENEWED TO P. ALL OTHERS TO BE RECONNECTED

NOTE: ALL VALVES TO BE INSTALLED COUNTERCLOCKWISE TO CLOSE

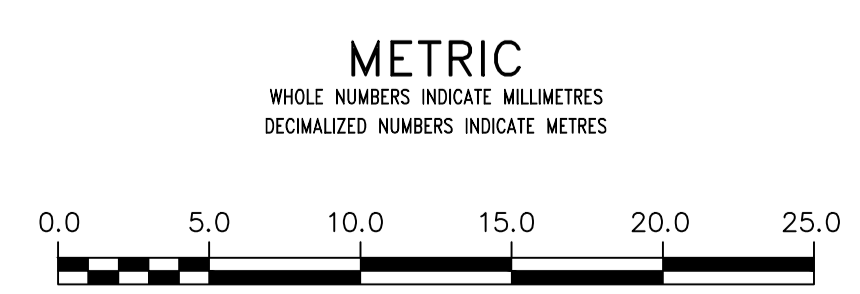

WARNING
IF POWER EQUIPMENT OR EXPLOSIVES ARE TO BE USED FOR EXCAVATION ON THIS PROJECT THE CONTRACTOR MUST:
1) NOTIFY THE GAS COMPANY OF THE PROPOSED LOCATION OF EXCAVATION.
2) TAKE PRECAUTION TO AVOID DAMAGE TO GAS COMPANY INSTALLATIONS.
SEE PROVINCIAL REGULATION 21072 FOR DETAILS

LOCATION APPROVED
UNDERGROUND STRUCTURES
SUPV. U/G STRUCTURES COMMITTEE DATE
NOTE:
LOCATION OF UNDERGROUND STRUCTURES AS SHOWN ARE BASED ON THE BEST INFORMATION AVAILABLE BUT NO GUARANTEE IS GIVEN THAT ALL EXISTING UTILITIES ARE SHOWN OR THAT THE GIVEN LOCATIONS ARE EXACT. CONFIRMATION OF EXISTENCE AND EXACT LOCATION OF ALL UTILITIES MUST BE OBTAINED FROM THE INDIVIDUAL UTILITIES BEFORE PROCEEDING WITH CONSTRUCTION.

B.M. ELEV.	NO.	REVISIONS	DATE	BY
	C	ISSUED FOR TENDER	11/04/22	KG
	B	DETAILED DESIGN SUBMISSION	25/03/22	KG
	A	PRELIMINARY DESIGN SUBMISSION	01/03/22	KG

wsp
1600 Buffalo Place
Winnipeg, Manitoba
R3T 6B8 Canada
Phone: 204-477-6650
wsp.com

DESIGNED BY	K.G.	CHECKED BY	S.M.
DRAWN BY	K.G.	APPROVED BY	S.M.
SCALE:		RELEASED FOR CONSTRUCTION	
HORIZONTAL	1:250		
VERTICAL	1:50		
DATE	2022 04 11	DATE	

ENGINEER'S SEAL
S.C. MINTY
Professional Engineer
2022-04-12
CONSULTANT DRAWING NUMBER
221-0922-00-04

THE CITY OF WINNIPEG
WATER AND WASTE DEPARTMENT
ENGINEERING DIVISION
2022 WATER MAIN RENEWALS - CONTRACT 6
SHEET 04 OF 12
CITY DRAWING NUMBER
D-16231
HARTFORD AVENUE
85.0M EEL OF SALTER STREET
6.0M EEL OF AIKINS STREET

ENGINEERS
GEO-SCIENTISTS
MANITOBA
Certificate of Authorization
WSP Canada Inc.
No. 5750