



- Construction Specifications**
- Construction must conform to the City of Winnipeg, *Standard Construction Specifications* and all references contained herein refer to these specifications. "SD" refers to City of Winnipeg standard details.
  - All materials used for construction must conform to City of Winnipeg, *Approved Products for Underground Use Within the City of Winnipeg* except as indicated otherwise.
  - Water Service to CW-2110**
    - All water services to be saddle connection installed according to CW2110, SD-012.
    - Copper water service shall be in accordance with AWWA C600 and ASTM B88M, Type K, seamless water tubing.
    - Use Class 'B' Bedding where required according to SD-001.
    - For backfilling, refer to SD-002 as follows:
      - Class 'S' Backfill in landscaped & untraveled areas
      - Class '2' Backfill in gravel, hard-surfaced & traveled areas
  - Gravity Sewers Service to CW-2030**
    - All WWS service installation shall be in accordance with CW 2030/2130, SD-014
    - 150mm WWS service pipe shall be in accordance with CAN/CSA B182.2 and ASTM D3034, SDR-35.
    - Drain tile to be single-wall perforated pipe with sock, ADS 06730020BS or approved equal.
    - Catchpits to be Nyoplast, Light Duty Inline Drain, no sump and complete with 12" drop-in grate or approved equal.
    - All pipe installations through road right of way shall be completed with trenchless methods. Any open trench construction on site shall be as follows:
      - Class 'B' Bedding to SD-001
      - Backfill to SD-002: Class '2' in gravel, hard-surfaces, and traveled areas; Class 'S' in landscaped and untraveled areas.
    - To CW2030/2130, Detail SD-014

**General Notes**

- Contractor to obtain all necessary permits.
- Contractor to obtain clearances from all utilities before excavating. Confirm all existing infrastructure information in field before construction. Notify the Engineer immediately of any discrepancies that affect installation or design.
- Confirm all dimensions before beginning construction.
- Consult Geotechnical Report (if available) or geotechnical engineer to confirm the suitability of native soils for backfill.
- Grading by Landscape Architect.
- Existing topographic by Landscape Architect. Refer to Landscape Architect for topographic information.

**NOTE:**  
 - Outdoor spray features shall be equipped with rain sensing devices as not to allow additional flows into the Wastewater Sewer System during rainfall events. Supplier to provide product specifications.  
 - Supplier to provide DWG outline of spray patterns for incorporation into Civil plan.  
 - Supplier to provide estimated flow generated by spray features.

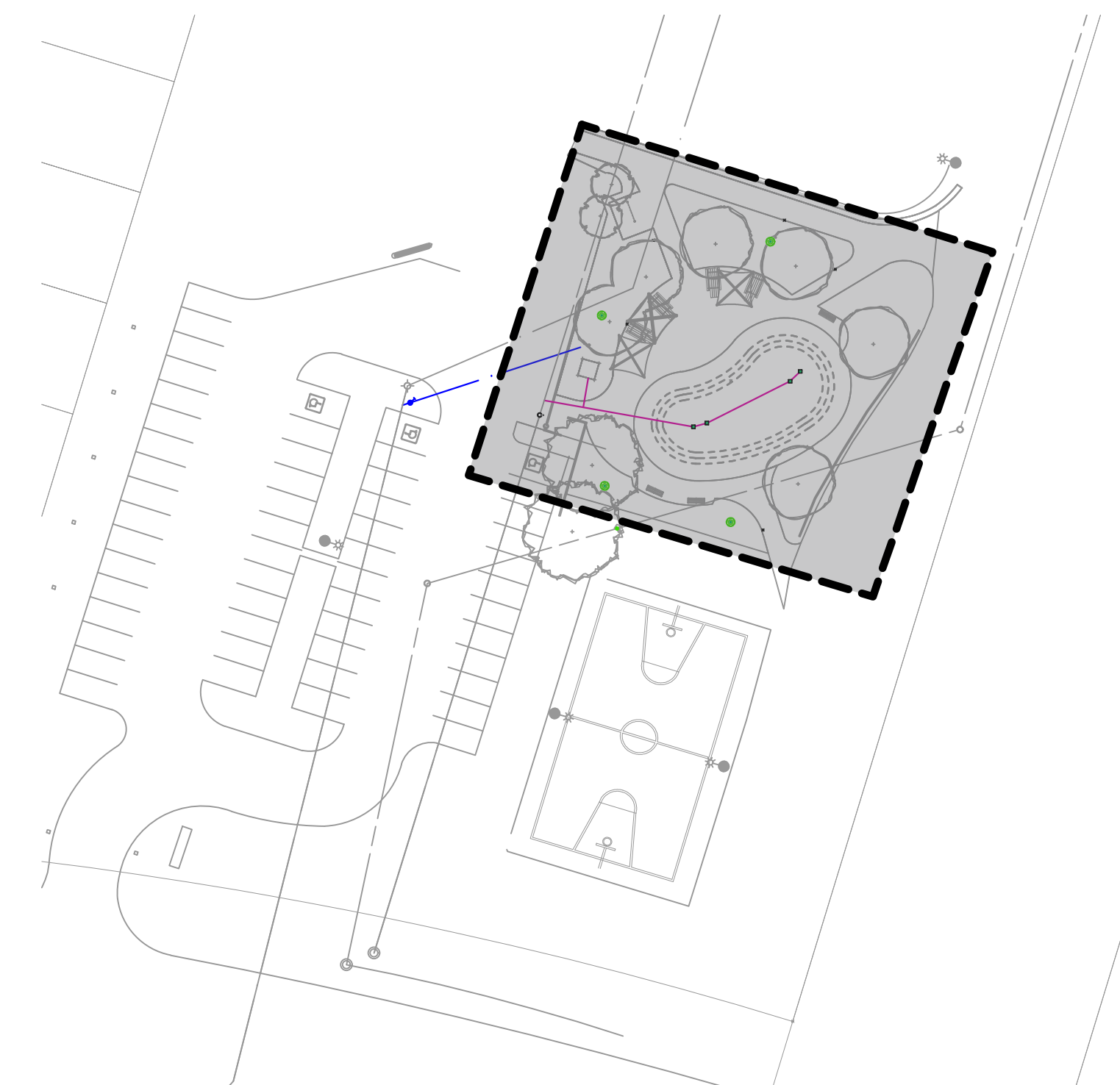

PLAN SITE PLAN  
N.T.S.

EX	LEGEND	PROP
	Slope Direction	6mm
	Topo Grade	100
150 W/M	Watermain	150 W/M
250 WWS	Wastewater Sewer	250 WWS
300 LDS	Land Drainage Sewer	300 LDS
	Hydrant	
	Curb Stop	
	Valve	
	Manhole	
	Catch Basin	
	Ponding Area	

DESIGN STATUS
R3 15 MAR 22 ISSUED FOR TENDER
R2 25 FEB 22 ISSUED FOR PRICING
R1 07 FEB 22 ISSUED FOR APPROVAL
R0 14 OCT 21 PRELIMINARY

UNITS: Whole numbers are millimetres (mm)  
 Decimal numbers are metres (m)  
 Convert Metric to Standard: 1.0m = 3.2808ft  
 scale

project code  
**21-079**  
 As Shown

PLAN SERVICING  
1:100