

NOTE: CHAINAGES SHOWN ARE ALONG CENTRE LINE OF ROW

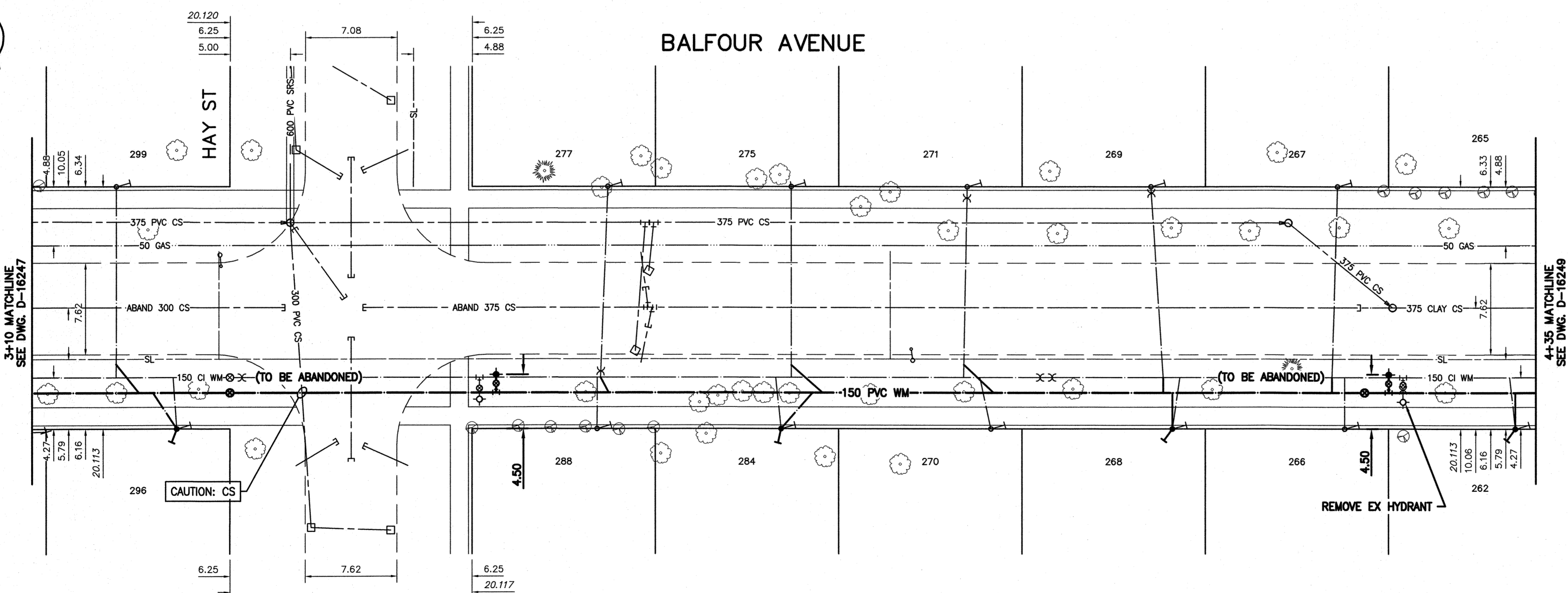
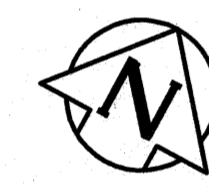

WATER SERVICE INFORMATION

ADDRESS	PIPE SIZE & MATERIAL (STREET)	PIPE SIZE & MATERIAL (PROP.)	SHORT & LONG MEASUREMENT	CORP. LOCATION	REMARKS
299 BALFOUR AVE	CU	CU	3.00 WEL HSE	OPP S/C	RECONNECT SERVICE
RESIDENTIAL	20	20	31.00 WWL HAY		
* 296 BALFOUR AVE	LEAD	LEAD	1.00 EEL HSE	1.0 W S/C	RENEW SERVICE
RESIDENTIAL	20	20	14.50 WWL HAY		
288 BALFOUR AVE	CU	CU	14.00 W E/L HSE	OPP S/C	RECONNECT SERVICE
RESIDENTIAL	20	20	34.10 EEL HAY		
* 284 BALFOUR AVE	CU	CU	3.66 W OF E/L	0.5 W OF S/C	RENEW SERVICE
RESIDENTIAL	20	20	-		
277 BALFOUR AVE	CU	CU	7.00 WEL HSE	2.0 W S/C	RECONNECT SERVICE
RESIDENTIAL	20	20	37.00 EEL HAY		
275 BALFOUR AVE	CU	CU	OPP EL HSE	OPP S/C	RECONNECT SERVICE
RESIDENTIAL	20	20	87.00 EEL HAY		
271 BALFOUR AVE	CU	LEAD	3.00 WEL HSE	1.0 W S/C	RECONNECT SERVICE
RESIDENTIAL	20	12	135.00 EEL HAY		
270 BALFOUR AVE	CU	CU	5.50 WEL HSE	3.0 W S/C	RECONNECT SERVICE
RESIDENTIAL	20	20	141.50 EEL HAY		
269 BALFOUR AVE	-	CU	6.50 EW/L #269	1.0 m E of S/C	RECONNECT SERVICE
RESIDENTIAL	20	20	107.00 EW/L #269 BALFOUR AV		
* 268 BALFOUR AVE	LEAD	LEAD	1.00 EEL E WINDOW	193.0 EEL HAY	RENEW SERVICE
RESIDENTIAL	12	12	191.00 EEL HAY		
267 BALFOUR AVE	CU	LEAD	6.00 WEL HSE	1.5 W S/C	RECONNECT SERVICE
RESIDENTIAL	20	12	236.00 EEL HAY		
266 BALFOUR AVE	CU	LEAD	1.00 EEL HSE	OPP S/C	RECONNECT SERVICE
RESIDENTIAL	20	20	238.00 EEL HAY		
* 262 BALFOUR AVE	LEAD	LEAD	0.80 E/ELL	SAME AS S/C	RENEW SERVICE
RESIDENTIAL	20	16	4.70 W/ELL		

* SERVICES TO BE RENEWED TO 1

NOTE: VALVES TO BE INSTALLED COUNTER-CLOCKWISE TO CLOSE

FOR INDEX SEE D-16245

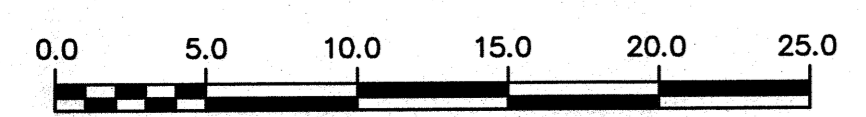

METRIC
WHOLE NUMBERS INDICATE MILLIMETRES
DECIMALIZED NUMBERS INDICATE METRES

ENGINEERS GEOSCIENTISTS MANITOBA
Certificate of Authorization
Stantec Consulting Ltd.
No. 1301

LOCATION APPROVED UNDERGROUND STRUCTURES

SUPV. U/G STRUCTURES COMMITTEE DATE

NOTE:
LOCATION OF UNDERGROUND STRUCTURES AS SHOWN ARE BASED ON THE BEST INFORMATION AVAILABLE BUT NO GUARANTEE IS GIVEN THAT ALL EXISTING UTILITIES ARE SHOWN OR THAT THE GIVEN LOCATIONS ARE EXACT. CONFIRMATION OF EXISTENCE AND EXACT LOCATION OF ALL SERVICES MUST BE OBTAINED FROM THE INDIVIDUAL UTILITIES BEFORE PROCEEDING WITH CONSTRUCTION.

B.M. 53-31 N.W. Cor. Baltimore Rd. & Hay St., Brass plug in 14.8m Conc. pile, 2.4m E. of W.L. Hay St., 2.4m S. of N.L. Baltimore Rd.

DESIGNED BY	RS	CHECKED BY	RS
DRAWN BY	OS	APPROVED BY	RS
SCALE:	HORIZONTAL 1:250	RELEASED FOR CONSTRUCTION	
	VERTICAL 1:50	DATE	2022.03.01
NO.	REVISIONS	DATE	BY
01	ISSUED FOR TENDER	2022.04.22	RS

PLOT DATE: 2022 04 21

Stantec

DESIGNED BY: RS
CHECKED BY: RS
DRAWN BY: OS
APPROVED BY: RS
RELEASED FOR CONSTRUCTION: [Signature]
DATE: 2022.03.01

ENGINEER'S SEAL

PROVINCE OF MANITOBA
2022-04-22
SHERLOCK
Member
24045
REGISTERED PROFESSIONAL ENGINEER

CONSULTANT DRAWING NUMBER: C-203

THE CITY OF WINNIPEG
WATER AND WASTE DEPARTMENT
ENGINEERING DIVISION

2022 WATERMAIN RENEWALS
CONTRACT 5
BALFOUR AVENUE
16.4 W OF HAY STREET TO
64.0 W OF CASEY STREET

SHEET 05 OF 16
CITY DRAWING NUMBER
D-16248