

TYPICAL CROSS SECTION
MORAY STREET RAIL CROSSING RECONSTRUCTION

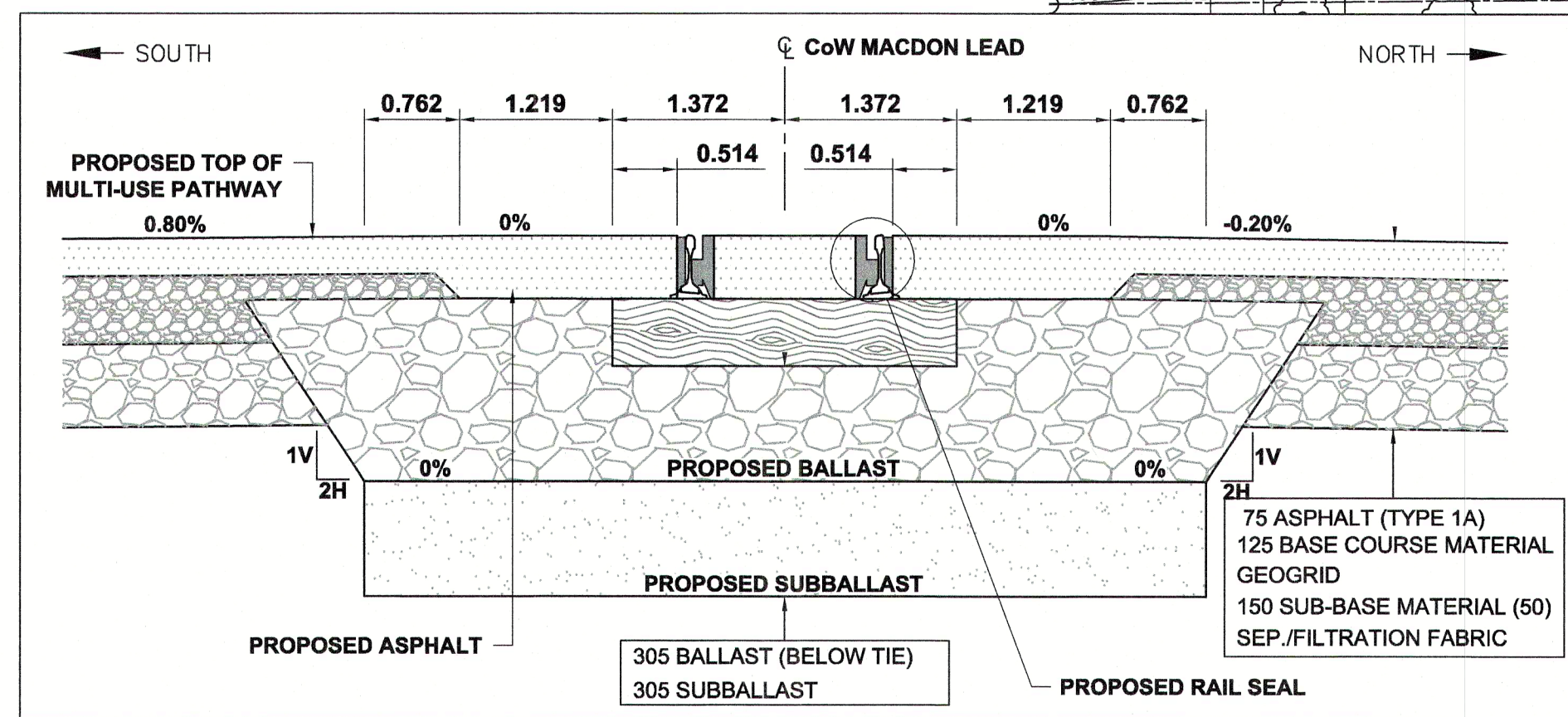
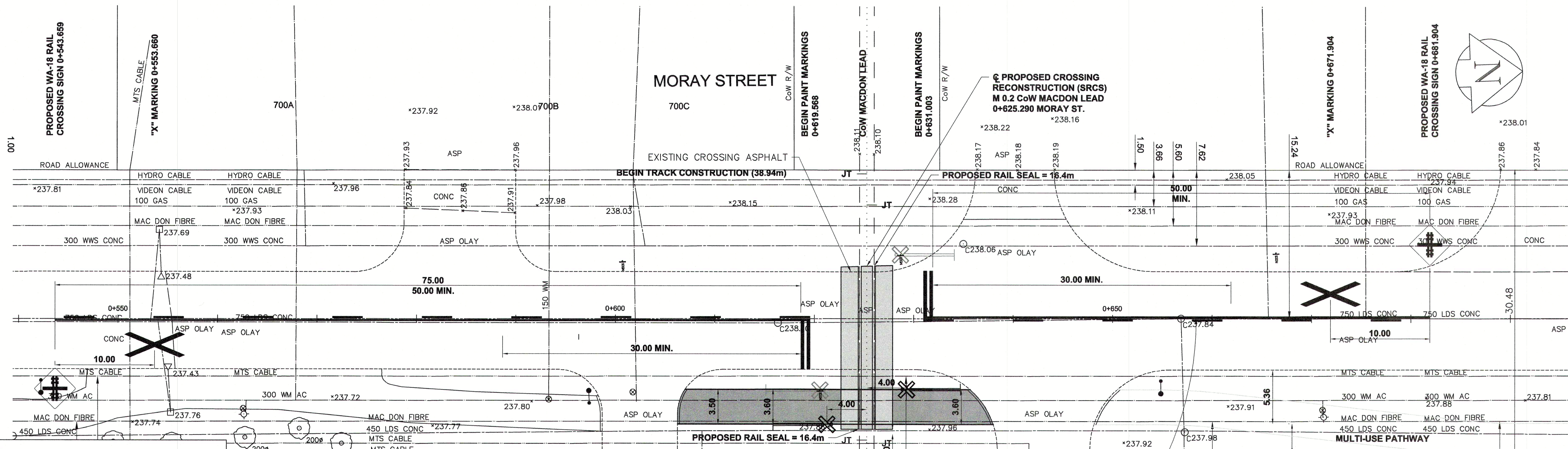
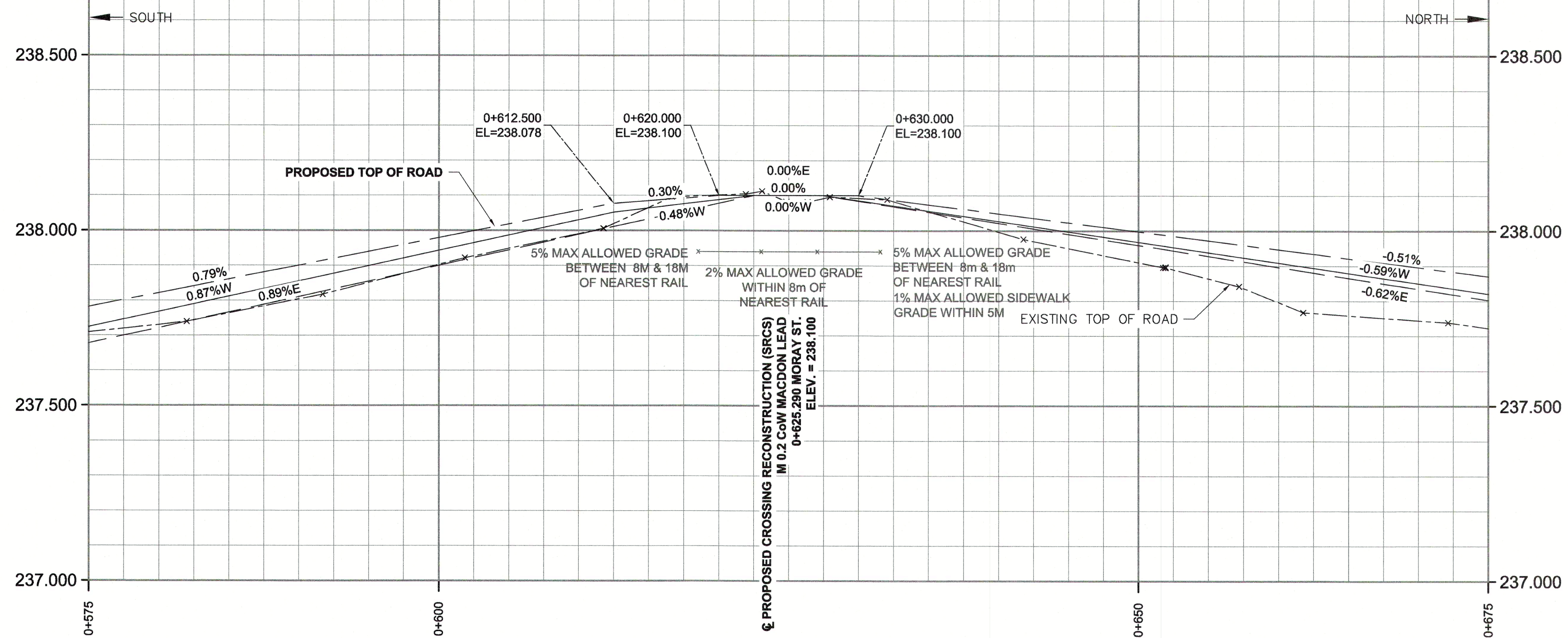

TYPICAL CROSS SECTION
PROPOSED MULTI-USE PATHWAY RAIL CROSSING

- REFERENCE NOTES
- PAVEMENT DIMENSIONS ARE TO BACK OF CURB
 - BASELINE IS CENTRE LINE RIGHT-OF-WAY
 - PROPERTY LINES OBTAINED FROM CITY OF WINNIPEG L.B.I.S., AND NO SCALE FACTOR WAS APPLIED
 - REFER TO AECOM FIELD BOOK NO. 4994

AECOM
Certificate of Authorization
AECOM Canada Ltd.
No. 4671 Date: *Mar 15/22*

METRIC
WHOLE NUMBERS INDICATE MILLIMETRES
DECIMALIZED NUMBERS INDICATE METRES

EXISTING	LEGEND - PLAN	PROPOSED	EXISTING	LEGEND - PLAN	PROPOSED	EXISTING	LEGEND - PROFILE	PROPOSED
150 mm W.M.	WATERMAIN	150 mm W.M.	---	HYDRO	---	---	Q PROFILE	---
150 mm W.M.	HYDRANT	150 mm W.M.	---	M.T.S.	---	---	WEST GUTTER	---
150 mm W.M.	VALVE	150 mm W.M.	---	CONCRETE	---	---	EAST GUTTER	---
300mm L.D.S.	LAND DRAINAGE SEWER	300mm L.D.S.	---	ASPHALT	---	---	N/W PROPERTY LINE	---
250mm W.W.S.	WASTEWATER SEWER	250mm W.W.S.	---	PROPERTY LINE	---	---	S/E PROPERTY LINE	---
150 mm W.M.	MANHOLE	150 mm W.M.	---	SURVEY BAR	---	---	Q TRACK	---
150 mm W.M.	CATCH BASIN	150 mm W.M.	---	ELEVATION	(235.750)	---		
150 mm W.M.	CATCH PIT	150 mm W.M.	---	TREE	---	---		
150 mm W.M.	JUNCTIONS	150 mm W.M.	---	SIDEWALK RAMP	---	---		
150 mm W.M.	CULVERT	150 mm W.M.	---	CONCRETE SIDEWALK	---	---		
150 mm W.M.	GAS	150 mm W.M.	---	FENCE	---	---		

LOCATION APPROVED UNDERGROUND STRUCTURES

SUPV. U/G STRUCTURES COMMITTEE DATE

NOTE:
LOCATION OF UNDERGROUND STRUCTURES AS SHOWN ARE BASED ON THE BEST INFORMATION AVAILABLE. BUT NO GUARANTEE IS GIVEN THAT ALL EXISTING UTILITIES ARE SHOWN OR THAT THE GIVEN LOCATIONS ARE EXACT. CONFIRMATION OF EXISTENCE AND EXACT LOCATION OF ALL SERVICES MUST BE OBTAINED FROM THE INDIVIDUAL UTILITIES BEFORE PROCEEDING WITH CONSTRUCTION.

NO.	REVISIONS	DATE	BY
0	ISSUED FOR TENDER	03/15/2022	BC
A	ISSUED FOR REVIEW	03/09/2022	BC

AECOM

DESIGNED BY: GME
CHECKED BY: BC/RC

DRAWN BY: GME
APPROVED BY:

HOR. SCALE: 1:250
VERTICAL: 1:10

ISSUED FOR TENDER: 03/15/2022 BC
ISSUED FOR REVIEW: 03/09/2022 BC

RELEASER FOR CONSTRUCTION BY:

ENGINEER'S SEAL
PROVINCE OF MANITOBA
R. T. CUNNINGHAM
Member
24711
REGISTERED PROFESSIONAL ENGINEER

CONSULTANT DRAWING NO. CT-19

THE CITY OF WINNIPEG
PUBLIC WORKS DEPARTMENT
ENGINEERING DIVISION

2022 INDUSTRIAL STREET RENEWAL PROGRAM

MORAY STREET - SOUTH OF SAULTEAUX CRESCENT NORTH LEG
PROPOSED CROSSING RECONSTRUCTION M 0.2 CoW MACDON LEAD
PLAN, PROFILE & TYPICAL SECTIONS

CITY DRAWING NUMBER
SHEET 19 OF 20