

100mm CONCRETE SIDEWALK WITH PAVING BAND
NTS

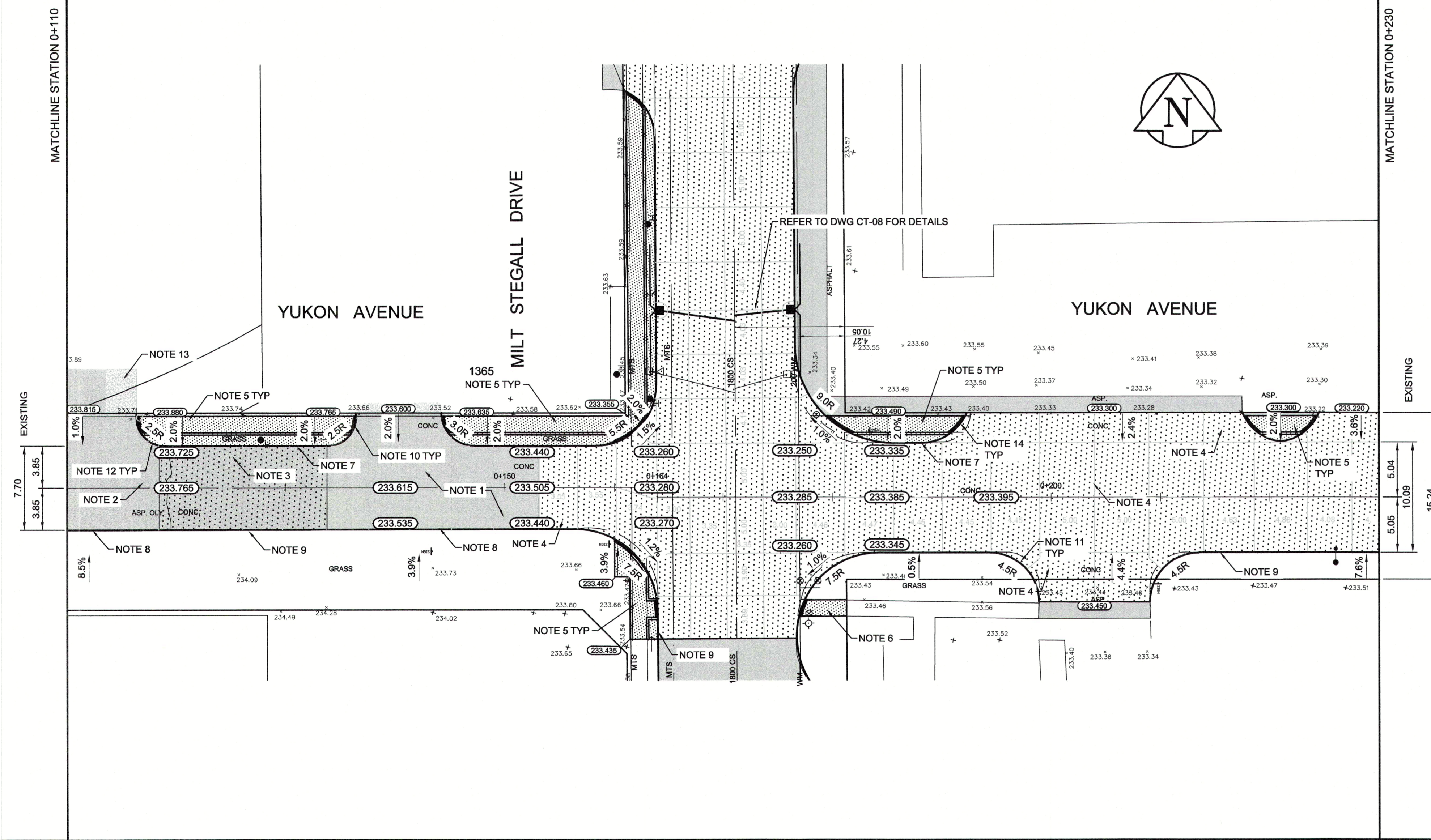

- REFERENCE NOTES:**
- PAVEMENT DIMENSIONS ARE TO BACK OF CURB
 - BASELINE IS CENTRE LINE ROADWAY
 - PROPERTY LINES OBTAINED FROM CITY OF WINNIPEG L.B.I.S., AND NO SCALE FACTOR WAS APPLIED
 - REFER TO AECOM FIELD BOOK NO. 5111
- CONSTRUCTION NOTES:**
- CONSTRUCT NEW ASPHALT PAVEMENT OVERLAY TYPE 1A (100mm AVG. THICKNESS)
 - REMOVE EXISTING ASPHALT PAVEMENT AND CONSTRUCT NEW ASPHALT PAVEMENT OVERLAY TYPE 1A (100mm AVG. THICKNESS)
 - REMOVE EXISTING CONCRETE PAVEMENT AND CONSTRUCT NEW 200mm REINFORCED CONCRETE PAVEMENT c/w ASPHALT OVERLAY TYPE IA
 - REMOVE EXISTING PAVEMENT AND CONSTRUCT NEW 200mm REINFORCED CONCRETE PAVEMENT
 - REMOVE EXISTING SIDEWALK AND CONSTRUCT NEW MONOLITHIC BARRIER CURB (100mm REVEAL HT.) AND 100mm CONCRETE SIDEWALK c/w BLOCKOUT AND PAVING STONES
 - RENEW EXISTING 100mm CONCRETE SIDEWALK
 - REMOVE EXISTING CONCRETE BARRIER CURB
 - RENEW EXISTING CONCRETE BARRIER CURB (150mm REVEAL HT., DOWELLED SD-205)
 - CONSTRUCT NEW CONCRETE BARRIER CURB (150mm REVEAL HT., SEPARATE SD-203A)
 - RENEW CONCRETE CURB RAMP (10-12mm REVEAL HT., MONOLITHIC SD-229A)
 - CONSTRUCT NEW MODIFIED BARRIER CURB (150mm HT., INTEGRAL)
 - CONSTRUCT NEW MODIFIED BARRIER CURB (100mm HT., MONOLITHIC)
 - REGRADE EXISTING GRAVEL
 - CONSTRUCT NEW CONCRETE CURB RAMP (INTEGRAL SD-229A 10-12mm REVEAL)

**ENGINEERS
GEOSCIENTISTS
MANITOBA**
Certificate of Authorization
AECOM Canada Ltd.
No. 4671 Date: *12/15/22*

METRIC
WHOLE NUMBERS INDICATE MILLIMETRES
DECIMALIZED NUMBERS INDICATE METRES

EXISTING	LEGEND - PLAN	PROPOSED	EXISTING	LEGEND - PLAN	PROPOSED	EXISTING	LEGEND - PROFILE	PROPOSED
150 mm W.M.	WATERMAIN	150 mm W.M.	---	HYDRO	---	---	Q PROFILE	---
300mm L.D.S.	LAND DRAINAGE SEWER	300mm L.D.S.	---	M.T.S.	---	---	SOUTH GUTTER	---
250mm W.W.S.	WASTEWATER SEWER	250mm W.W.S.	---	CONCRETE	---	---	NORTH GUTTER	---
○	MANHOLE	●	---	ASPHALT	---	---	S PROPERTY LINE	---
□	CATCH BASIN	■	---	PROPERTY LINE	---	---	N PROPERTY LINE	---
▽	CATCH PIT	▼	---	SURVEY BAR	---	---		---
---	JUNCTIONS	---	---	ELEVATION	235.750	---		---
---	CULVERT	---	---	TREE	---	---		---
---	GAS	---	---	SIDEWALK RAMP	---	---		---
---		---	---	CONCRETE SIDEWALK	---	---		---
---		---	---	FENCE	---	---		---

LOCATION APPROVED UNDERGROUND STRUCTURES

SUPV. U/G STRUCTURES COMMITTEE DATE

NOTE:
LOCATION OF UNDERGROUND STRUCTURES AS SHOWN ARE BASED ON THE BEST INFORMATION AVAILABLE, BUT NO GUARANTEE IS GIVEN THAT ALL EXISTING UTILITIES ARE SHOWN OR THAT THE GIVEN LOCATIONS ARE EXACT. CONFIRMATION OF EXISTENCE AND EXACT LOCATION OF ALL SERVICES MUST BE OBTAINED FROM THE INDIVIDUAL UTILITIES BEFORE PROCEEDING WITH CONSTRUCTION.

B.M. ELEV. #23 - S. side of Ellice Ave, E. of Empress St., Tblt in Concrete foundation of No. 1320 Ellice Ave, 1m E. & 0.3m EL: 233.965

NO.	REVISIONS	DATE	BY
0	ISSUED FOR TENDER	03/15/22	BC
A	ISSUED FOR REVIEW	02/11/22	BC

AECOM

DESIGNED BY	BC	CHECKED BY	RC
DRAWN BY	JT	APPROVED BY	RC
HOR. SCALE: 1:250		RELEASED FOR CONSTRUCTION BY:	
VERTICAL: 1:10		DATE	

ENGINEER'S SEAL

R.T. CUNNINGHAM
Member
24711
REGISTERED PROFESSIONAL ENGINEER

CONSULTANT DRAWING NO. CT-07

THE CITY OF WINNIPEG
PUBLIC WORKS DEPARTMENT
ENGINEERING DIVISION

2022 INDUSTRIAL STREET
RENEWAL PROGRAM

YUKON AVENUE - STATION 0+110 TO STATION 0+230
PAVEMENT REHABILITATION
PLAN/PROFILE

CITY DRAWING NUMBER
SHEET 07 OF 20