

Mar 09, 2022 - 9:10pm F:\2021\211-12618-00-00 - 2022 Street Program Package 22-R-03\4.0 Tech + Prof Services\4.11 Highways\_Bridges\4.11.06 Drawings\03 Working Dwg\211-12618-00-11-RB

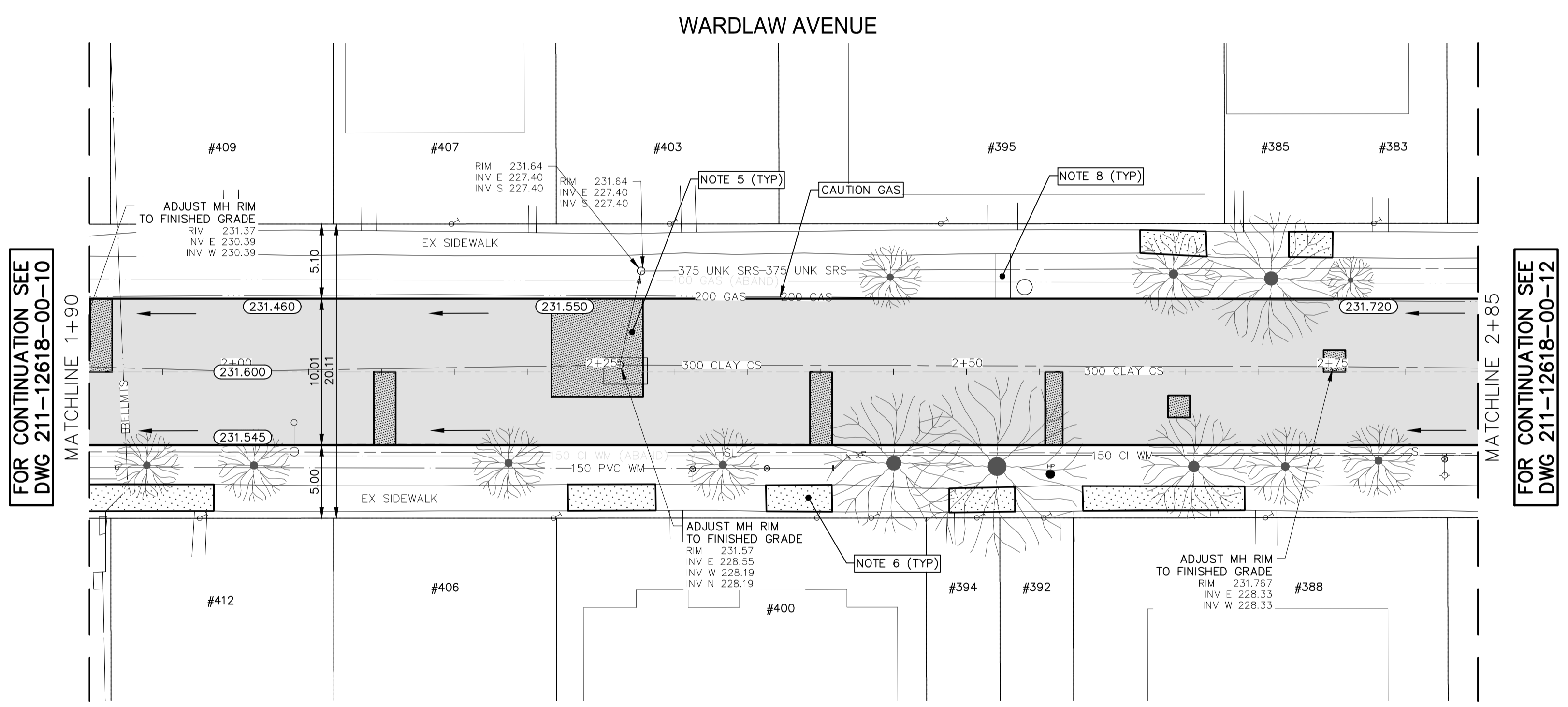
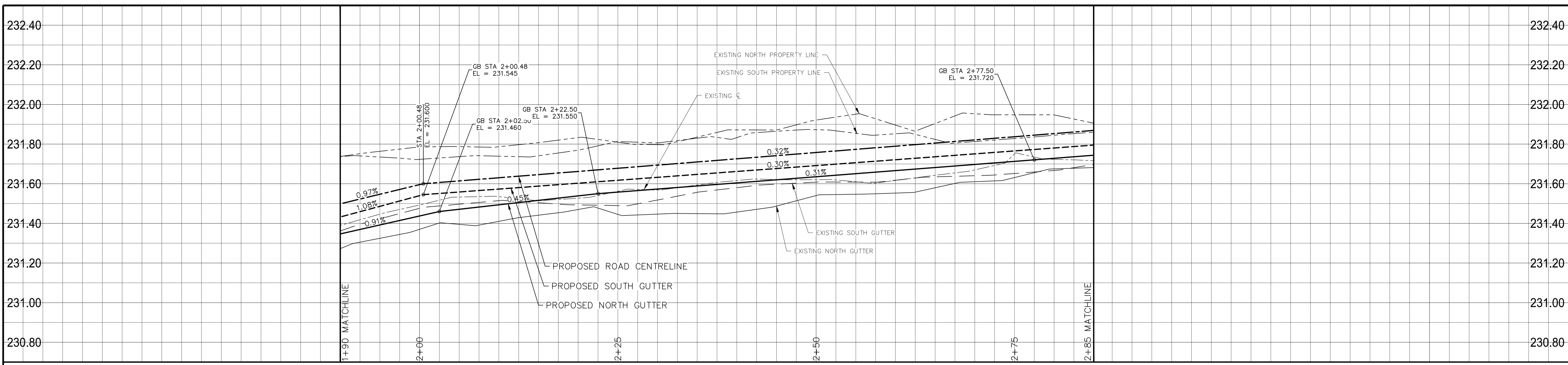

- NOTES:
1. ALL WORK AND MATERIALS TO BE IN ACCORDANCE WITH THE LATEST REVISION OF THE CITY OF WINNIPEG STANDARD CONSTRUCTION SPECIFICATIONS.
  2. CONTRACTOR TO CONFIRM THE LOCATION OF ALL UTILITIES/SERVICES IN THE FIELD PRIOR TO CONSTRUCTION.
  3. ALL ROADWAY DIMENSIONS SHOWN ARE TO BACK OF CURB.
  4. EXISTING ASPHALT TO BE PLANED AS SHOWN OR AS DIRECTED BY CONTRACT ADMINISTRATOR
  5. 150mm PARTIAL CONCRETE SLAB PATCHES SHOWN ARE ONLY A REPRESENTATIVE APPROXIMATION OF THE TENDERED QUANTITIES.
  6. EXISTING SIDEWALK TO BE RENEWED AS PER SD-228A AND AS DIRECTED BY CONTRACT ADMINISTRATOR.
  7. PLANE/REMOVE EXISTING CURB AND CONSTRUCT BARRIER CURB (100mm REVEAL) AS PER SD-206A AND AS DIRECTED BY CONTRACT ADMINISTRATOR.
  8. ALL PRIVATE WALKWAYS TO BE ADJUSTED TO NEW SIDEWALK OR TOP OF CURB ELEVATION, AS DIRECTED BY THE CONTRACT ADMINISTRATOR.
  9. PAVEMENT REPAIR FABRIC TO BE INSTALLED AS DIRECTED BY CONTRACT ADMINISTRATOR.
  10. MODIFIED BARRIER CURB TO BE CONSTRUCTED AT ALL INTERSECTION RADII AND ALLEY RADII
  11. CONTRACTORS TO TAKE PRECAUTIONARY STEPS TO PROTECT EXISTING TREES WITHIN THE LIMITS OF CONSTRUCTION FROM DAMAGE FROM CONSTRUCTION ACTIVITIES AS OUTLINED IN THE SPECIFICATIONS.
  12. LAMP STANDARDS, HYDRO POLES, AND ANCHORS THAT REQUIRE TEMPORARY SUPPORT, REMOVAL OR REPLACEMENT, TO BE DONE SO AT THE EXPENSE OF THE CONTRACTOR AS NECESSARY.
  13. ALL BOULEVARDS TO BE SODDED UNLESS OTHERWISE NOTED.
  14. ADJUST ALL WATER VALVES, HYDRANTS, MANHOLES, AND CATCH BASINS IN WORK AREA TO GRADE.

EXISTING	LEGEND-PLAN	PROPOSED	EXISTING	LEGEND-PROFILE	PROPOSED
---	WATER MAIN	---	⊕	IRON BAR	---
---	LAND DRAINAGE SEWER	---	⊕	HYDRO POLE & LIGHT STANDARD	---
---	WASTE WATER SEWER	---	⊕	LIGHT STANDARD OR TRAFFIC SIGNAL	---
---	HYDRO	---	HP	HYDRO POLE	---
---	BELL/MTS	---	⊕	CURB RAMP	---
---	GAS	---	⊕	DETECTABLE WARNING SURFACE TILE	---
---	SIGNALS	---	---	EDGE OF SIDEWALK	---
○	MANHOLE	○	---	FENCE	---
□	CATCH BASIN	□	---	PROPERTY LINE	---
△	CURB INLET	△	---	EDGE OF ASPHALT	---
---	UTILITIES ADJUSTED	△ □ ○	---	EDGE OF CONCRETE	---
⊔	PLUG	⊔	---	MODIFIED BARRIER CURB	---
⊕	HYDRANT	⊕	---	BARRIER CURB	---
⊕	VALVE	⊕	---	BARRIER CURB AND GUTTER	---
⊕	CURB STOP	⊕	---	CONC SIDEWALK	---
230.99	GROUND GRADE	(231.000)	---	CONCRETE SLAB	---
(231.00)	PAVEMENT GRADE	(231.000)	---	ASPHALT	---
---	ANCHOR	---	---	MILLED SURFACE	---
#11	CIVIC ADDRESS	---	---	PAVEMENT REPAIR FABRIC	---
---	EXISTING	---	---	---	---

LOCATIONS APPROVED UNDERGROUND STRUCTURES

SIGNED BY: \_\_\_\_\_ DATE: \_\_\_\_\_

SUPV UG STRUCTURES

LOCATION OF UNDERGROUND STRUCTURES AS SHOWN ARE BASED ON THE BEST INFORMATION AVAILABLE BUT NO GUARANTEE IS GIVEN THAT ALL EXISTING UTILITIES ARE SHOWN OR THAT THE GIVEN LOCATIONS ARE EXACT CONFIRMATION OF EXISTENCE AND EXACT LOCATION OF ALL SERVICES MUST BE OBTAINED FROM THE INDIVIDUAL UTILITIES BEFORE PROCEEDING

NO.	REVISIONS	DATE	BY
A	DETAILED DESIGN REVIEW	20220301	RB
B	ISSUED FOR TENDER	20220309	RB

G.B.M. TOH @ SW CORNER WARDLAW AVENUE AND DONALD STREET  
ELEV. 232.753

**wsp**

DESIGNED BY: RH/EL  
DRAWN BY: RB/AG

WSP Canada Inc.  
1600 Buffalo Place  
Winnipeg, MB R3T 6B8  
t. 204.477.6650  
f. 204.474.2864  
www.wsp.com

ENGINEER'S SEAL

CHECKED BY: LV  
APPROVED BY: SM

RELEASED FOR CONSTRUCTION

HOR. SCALE: 1:250  
VERTICAL: 1:10

DATE: MAY 2022

FOR TENDER PURPOSES ONLY  
NOT FOR CONSTRUCTION

**METRIC**  
WHOLE NUMBERS INDICATE MILLIMETRES  
DECIMALIZED NUMBERS INDICATE METRES

**ENGINEERS GEOSCIENTISTS MANITOBA**  
Certificate of Authorization  
WSP Canada Inc.  
No. 5750

**THE CITY OF WINNIPEG**  
PUBLIC WORKS DEPARTMENT  
ENGINEERING SERVICES DIVISION

2022 LOCAL STREET RENEWALS  
WARDLAW AVE  
MAJOR REHABILITATION  
STA. 1+90 TO STA. 2+85

CITY DRAWING NUMBER  
SHEET 11 OF 21  
TENDER NO. 884-2021

CONSULTANT ACAD DWG. NO. 211-12618-00-11