

WATER SERVICE INFORMATION

ADDRESS	SIZE (mm) MATERIAL (STREET)	SIZE (mm) MATERIAL (PROP.)	SHORT & LONG MEASUREMENT	LINEAR DISTANCE (1) CORP LOCATION (2)	REMARKS
2 JACK HAWTHORNE BAY RESIDENTIAL	20 CU	20 CU	3.05 SNL HSE	18.9	RECONNECT SERVICE
9 JACK HAWTHORNE BAY RESIDENTIAL	20 PB	20 CU	6.52 SNL HSE	14.9	RENEW TO R W/20 CU
10 JACK HAWTHORNE BAY RESIDENTIAL	20 PB	20 CU	16.295 SSL HEADMASTER ROW	4.4 S OF S/C	RENEW TO R W/20 CU
14 JACK HAWTHORNE BAY RESIDENTIAL	20 PB	20 CU	7.07 EWL HSE	6.2	RECONNECT SERVICE
18 JACK HAWTHORNE BAY RESIDENTIAL	20 PB	20 CU	20.983 SSL HEADMASTER ROW	8.0 N OF S/C	RECONNECT SERVICE
22 JACK HAWTHORNE BAY RESIDENTIAL	20 CU	20 CU	5.69 EWL HSE	0.9	RENEW TO R W/20 CU
			20.478 SSL HEADMASTER ROW	4.4 N OF S/C	RECONNECT SERVICE
			7.14 EWL HSE	7.5	RECONNECT SERVICE
			16.292 SSL HEADMASTER ROW	5.3 N OF S/C	RECONNECT SERVICE
			2.75 SNL HSE	11.4	RENEW TO R W/20 CU
			6.743 SSL HEADMASTER ROW	1.4 N OF S/C	RECONNECT SERVICE

(1) LINEAR DISTANCE FROM THE S/C TO THE CORP USED ALONG BENDS & CURVED R.O.W.
(2) DIRECTION FROM S/C

* SERVICES TO BE RENEWED TO R. ALL OTHERS TO BE RECONNECTED

NOTE: CHAINAGES SHOWN ARE ALONG W. R. OF JACK HAWTHORNE BAY

JACK HAWTHORNE BAY

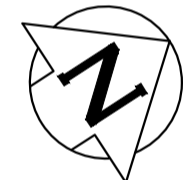
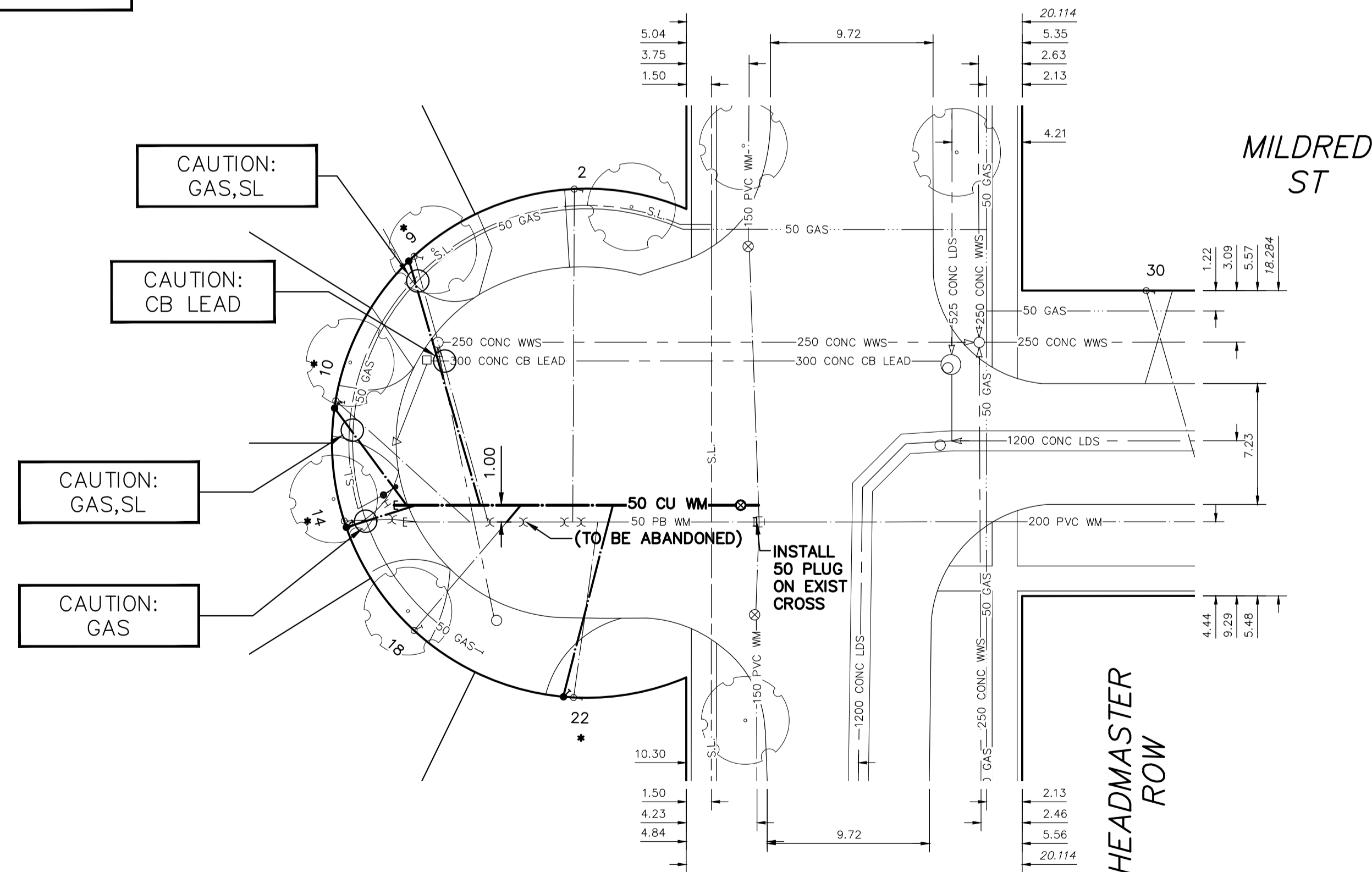

FOR INDEX SEE D-16133

NOTE: ALL VALVES TO BE INSTALLED CLOCKWISE TO CLOSE

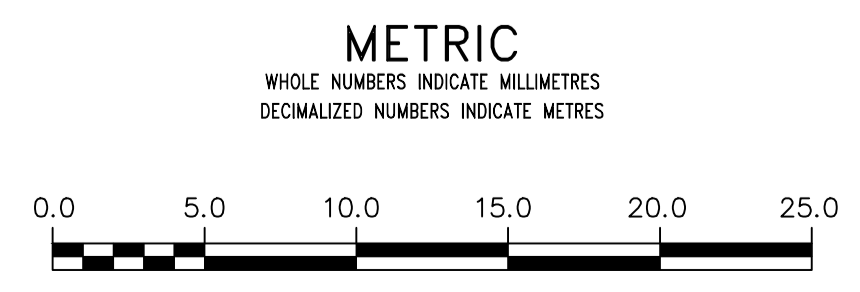

WARNING
IF POWER EQUIPMENT OR EXPLOSIVES ARE TO BE USED FOR EXCAVATION ON THIS PROJECT THE CONTRACTOR MUST:
1) NOTIFY THE GAS COMPANY OF THE PROPOSED LOCATION OF EXCAVATION.
2) TAKE PRECAUTION TO AVOID DAMAGE TO GAS COMPANY INSTALLATIONS.
SEE PROVINCIAL REGULATION 210/72 FOR DETAILS

LOCATION APPROVED
UNDERGROUND STRUCTURES
SUPV. U/G STRUCTURES COMMITTEE DATE
NOTE:
LOCATION OF UNDERGROUND STRUCTURES AS SHOWN ARE BASED ON THE BEST INFORMATION AVAILABLE BUT NO GUARANTEE IS GIVEN THAT ALL EXISTING UTILITIES ARE SHOWN OR THAT THE GIVEN LOCATIONS ARE EXACT. CONFIRMATION OF EXISTENCE AND EXACT LOCATION OF ALL SERVICES MUST BE OBTAINED FROM THE INDIVIDUAL UTILITIES BEFORE PROCEEDING WITH CONSTRUCTION.

VERTICAL DATUM: CGVD28 (HT2.0 Geoid)
HORIZONTAL DATUM: NAD83 (June 1990), Zone 14

NO.	REVISIONS	DATE	BY

DESIGNED BY	RG	CHECKED BY	SC
DRAWN BY	AJ	APPROVED BY	KZ
SCALE:		RELEASED FOR CONSTRUCTION	
HORIZONTAL	1:250		
VERTICAL	1:50		
DATE	2022 07 14	DATE	

PLOT DATE: 2022 07 14

ENGINEER'S SEAL
CONSULTANT DRAWING NUMBER

THE CITY OF WINNIPEG
WATER AND WASTE DEPARTMENT
ENGINEERING DIVISION

2022 WATER MAIN RENEWALS
CONTRACT 12
JACK HAWTHORNE BAY
HEADMASTER ROW TO
JACK HAWTHORNE BAY

SHEET 7 OF 14
CITY DRAWING NUMBER
D-16135