

**SECTION**

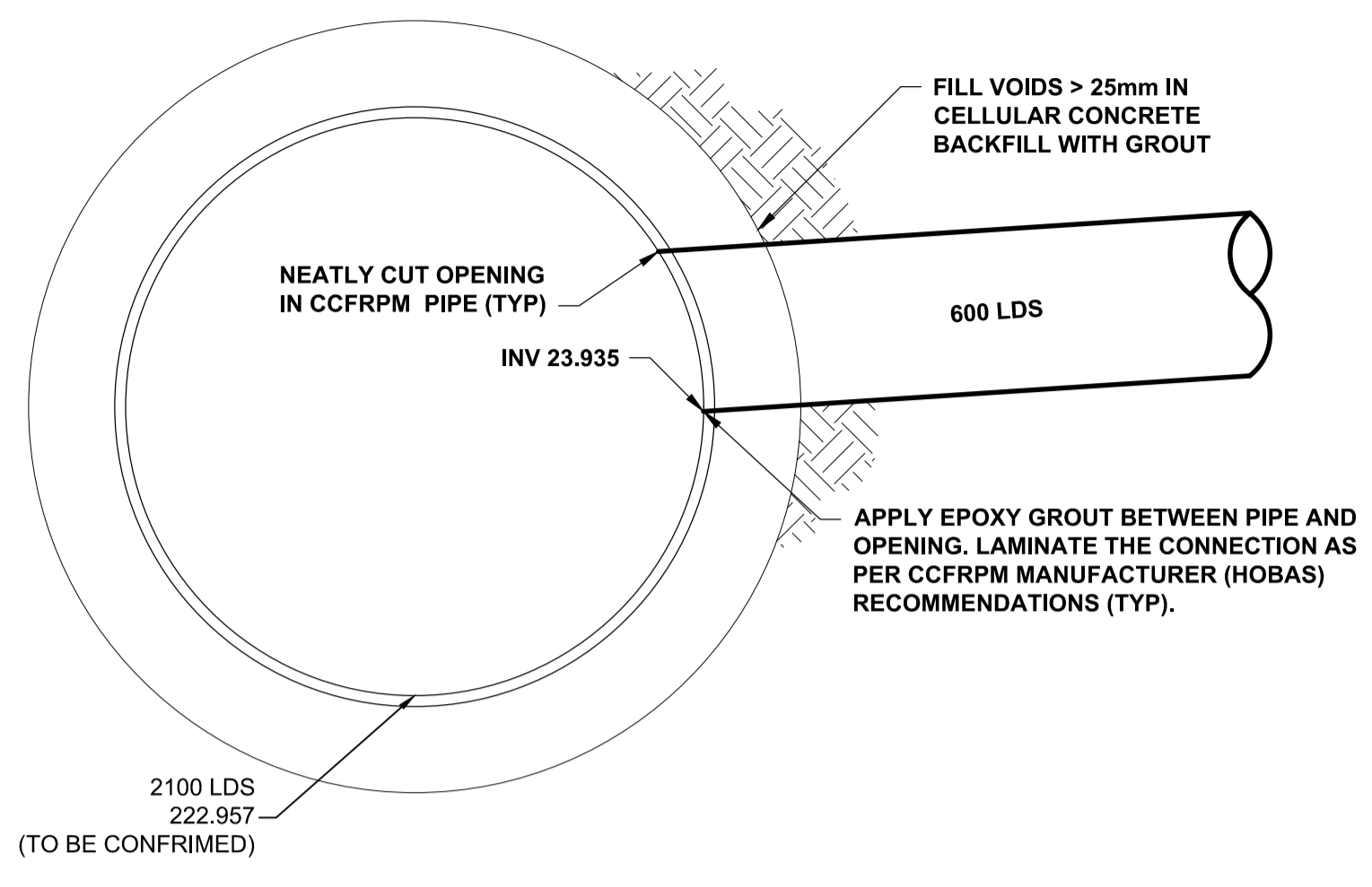

**SECTION**

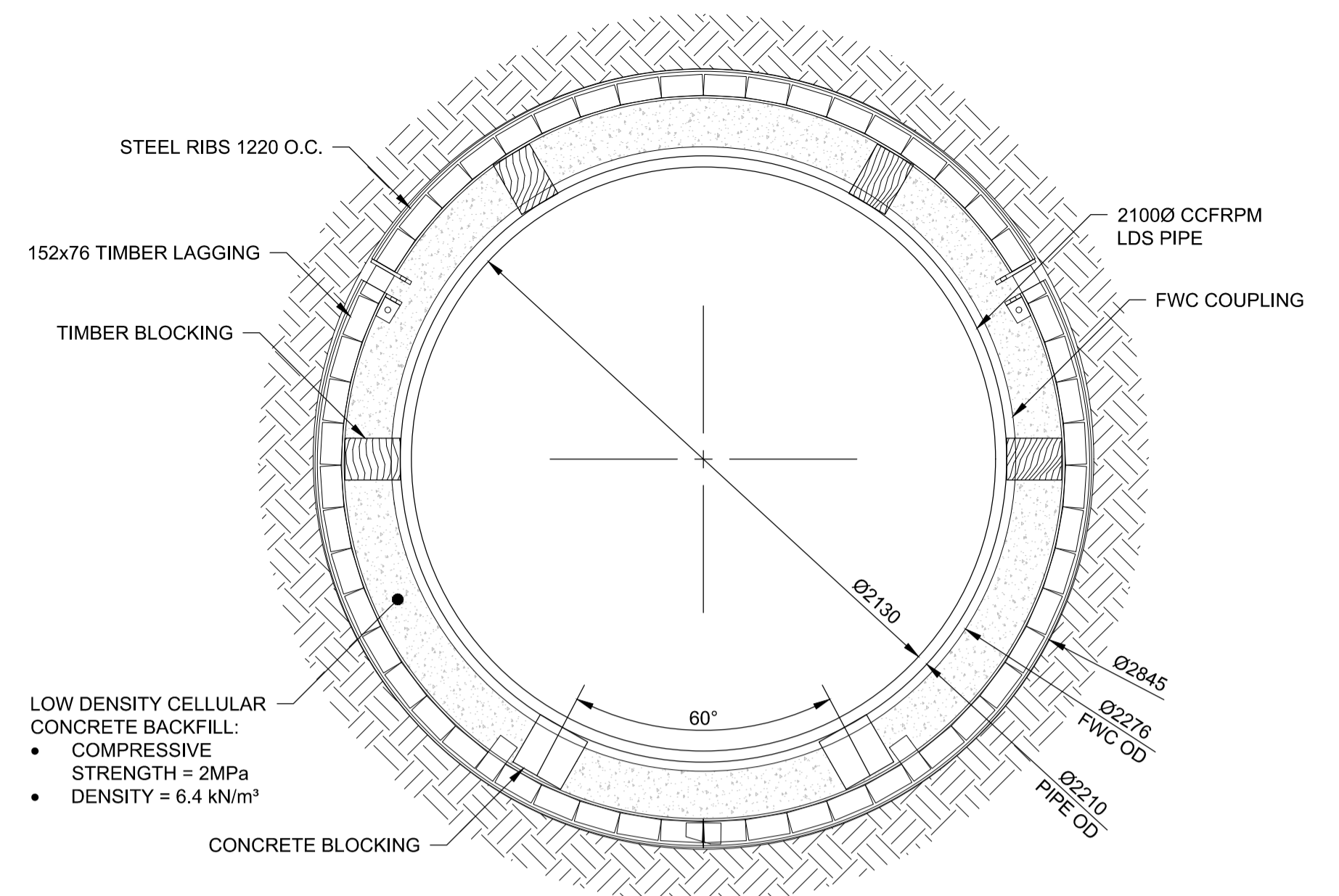

**A SECTION**  
LD-11291 EXISTING 2100Ø LDS

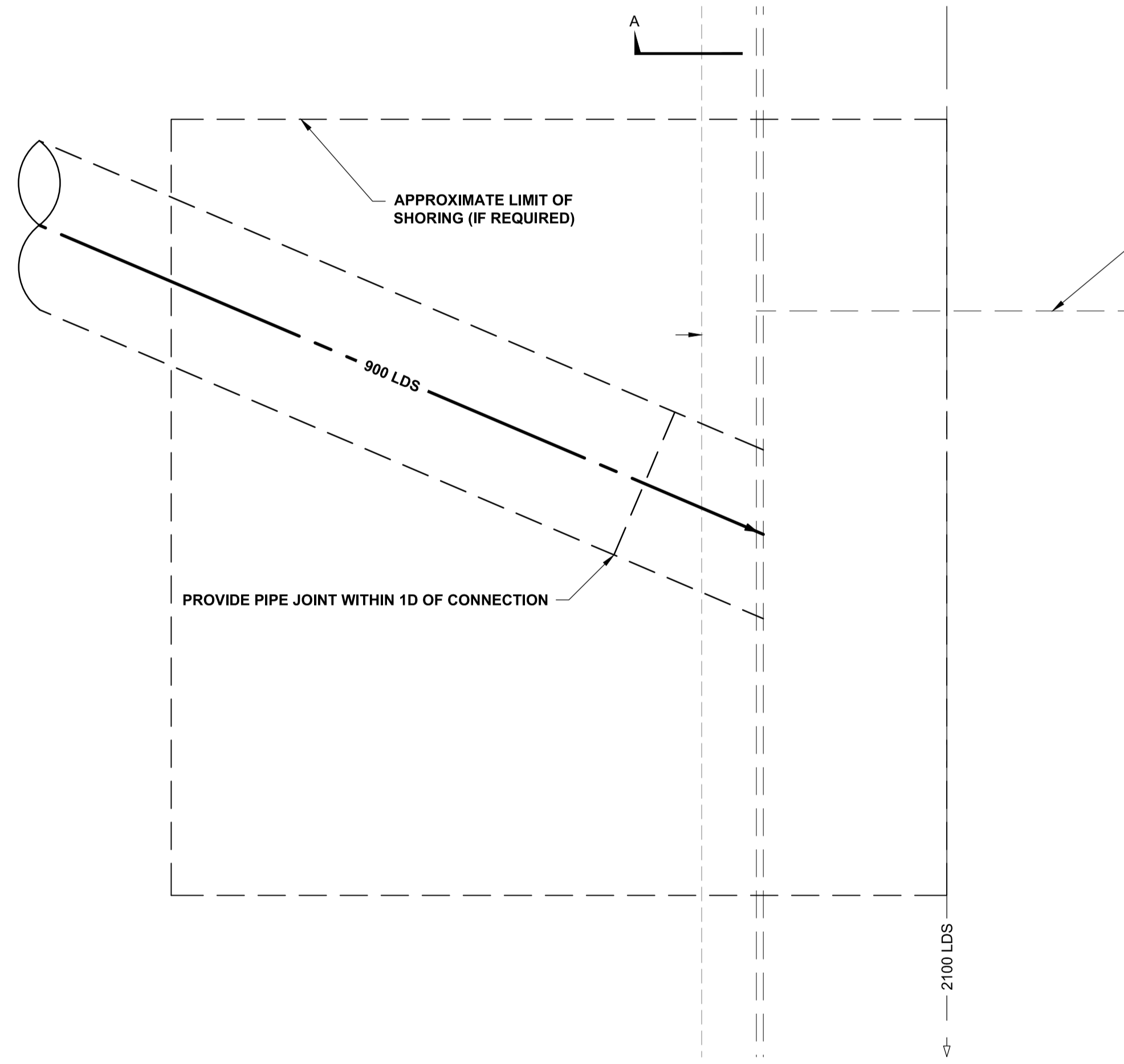

**PLAN**

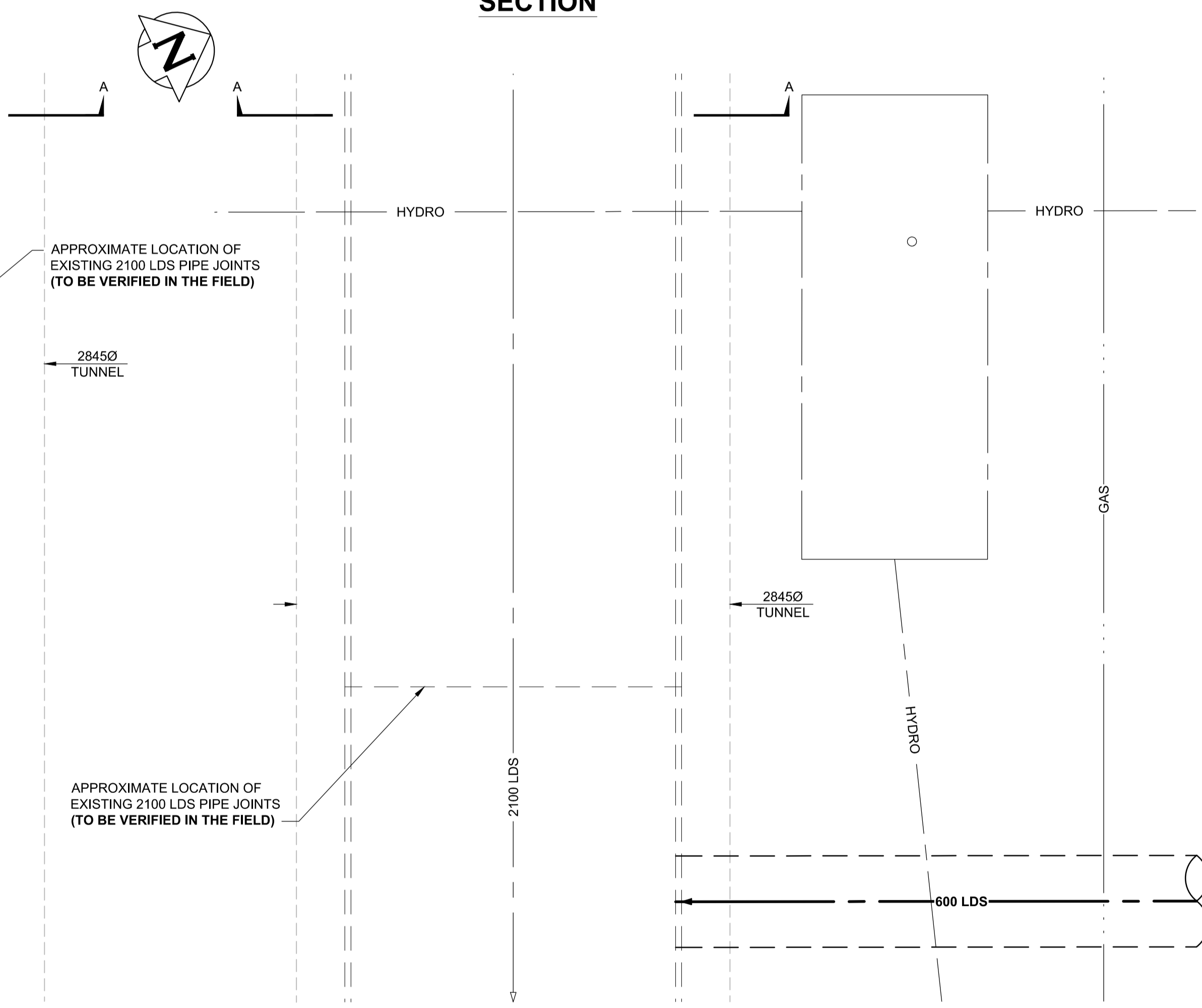

**PLAN**

- NOTES:**
1. VERIFY THE LOCATION OF ALL EXISTING UNDERGROUND UTILITIES PRIOR TO CONSTRUCTION.
  2. SUBMIT SHOP DRAWINGS FOR PROPOSED SHORING (IF REQUIRED) PRIOR TO CONSTRUCTION.
  3. SUBMIT METHODS STATEMENTS FOR PROPOSED TRENCHLESS CONSTRUCTION METHODS PRIOR TO CONSTRUCTION.
  4. 900 LDS CONNECTION MAY BE COMPLETED UTILIZING A SHORED SHAFT, CASING PIPE, OR OTHER SUITABLE MEANS. DETAILS TO BE PROVIDED IN METHOD STATEMENT.
  5. VERIFY LOCATIONS OF EXISTING 2100 LDS PIPE JOINTS. RELOCATE LDS CONNECTION POINTS AS REQUIRED TO ALLOW FOR MIN 300 mm CLEARANCE FROM EXISTING 2100 LDS PIPE JOINTS.

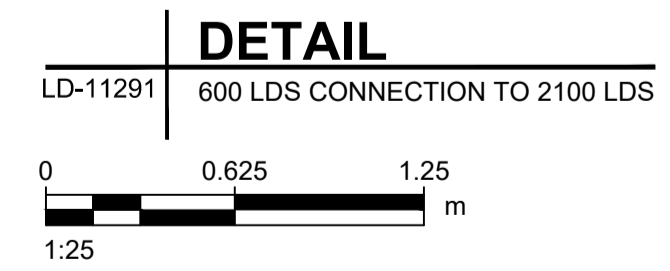
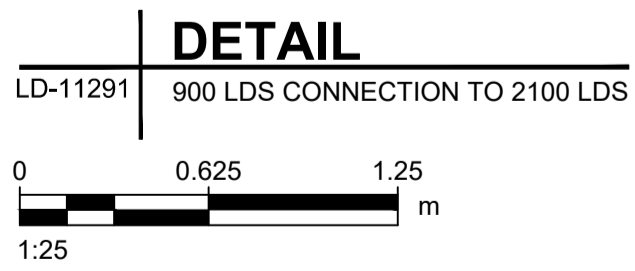

**METRIC**  
WHOLE NUMBERS INDICATE MILLIMETRES  
DECIMALIZED NUMBERS INDICATE METRES

**ENGINEERS GEOSCIENTISTS MANITOBA**  
Certificate of Authorization  
AECOM Canada Ltd.  
No. 4671 Date: 2022/01/27

LOCATION APPROVED UNDERGROUND STRUCTURES		B.M. ELEV.	
SUPV. U/G STRUCTURES COMMITTEE	DATE		
NOTE: LOCATION OF UNDERGROUND STRUCTURES AS SHOWN ARE BASED ON THE BEST INFORMATION AVAILABLE BUT NO GUARANTEE IS GIVEN THAT ALL EXISTING UTILITIES ARE SHOWN OR THAT THE GIVEN LOCATIONS ARE EXACT. CONFIRMATION OF EXISTENCE AND EXACT LOCATION OF ALL SERVICES MUST BE OBTAINED FROM THE INDIVIDUAL UTILITIES BEFORE PROCEEDING WITH CONSTRUCTION.			
0	ISSUED FOR TENDER	22/01/27	ADL
NO.	REVISIONS	DATE	BY

**AECOM**

DESIGNED BY	JAT	CHECKED BY	MGM
DRAWN BY	ADL	APPROVED BY	KWF
SCALE:	HORIZONTAL AS NOTED VERTICAL AS NOTED		
DATE	2022 01 28	DATE	Jan 27/22

PLOT DATE: 2022 01 28

ENGINEER'S SEAL

ORIGINAL SIGNED BY J. Thompson  
27/01/22

CONSULTANT DRAWING NUMBER  
C-4001

**THE CITY OF WINNIPEG**  
WATER AND WASTE DEPARTMENT  
ENGINEERING DIVISION

JEFFERSON EAST COMBINED SEWER RELIEF  
CONTRACT 6B  
STANDARD DETAILS

SHEET 13 OF 13  
CITY DRAWING NUMBER  
LD-11299