

NOTE: CHAINAGES SHOWN ARE ALONG S. P. OF KILBRIDE AVENUE
STA. 1+000.000 = E P. POWERS STREET

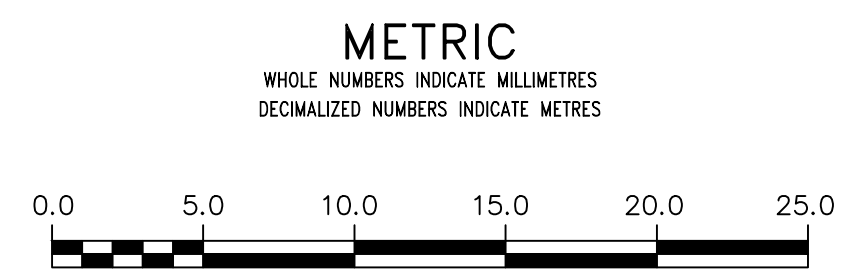
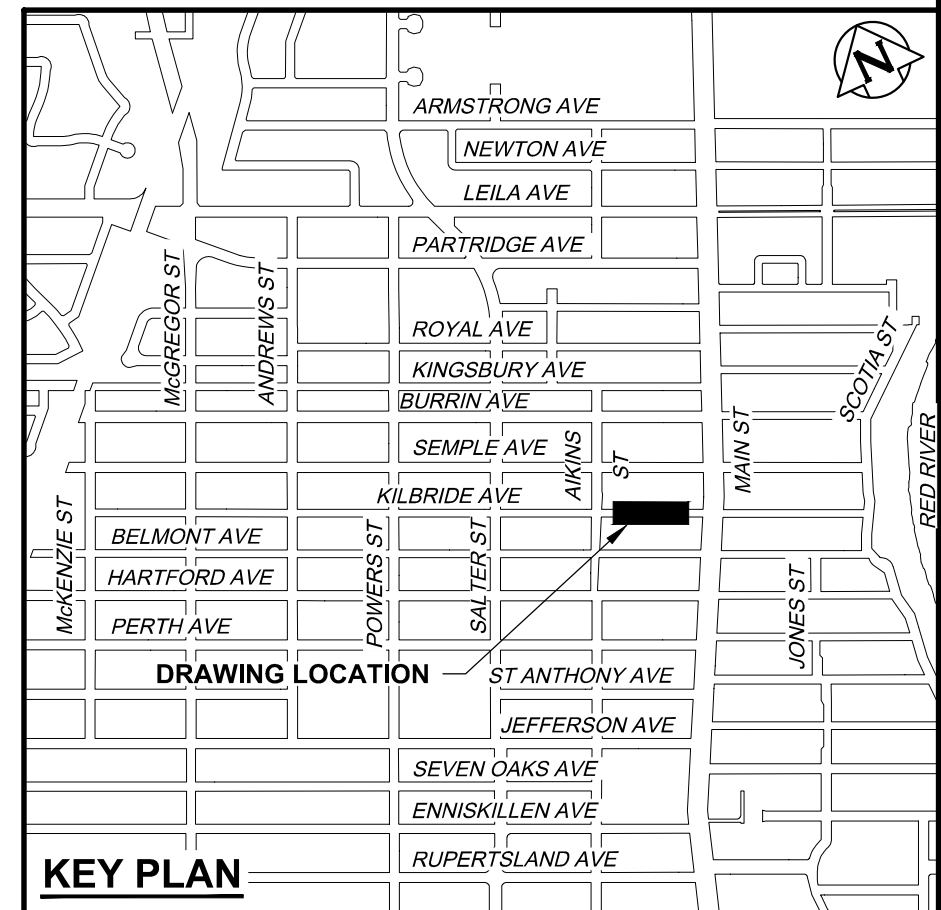
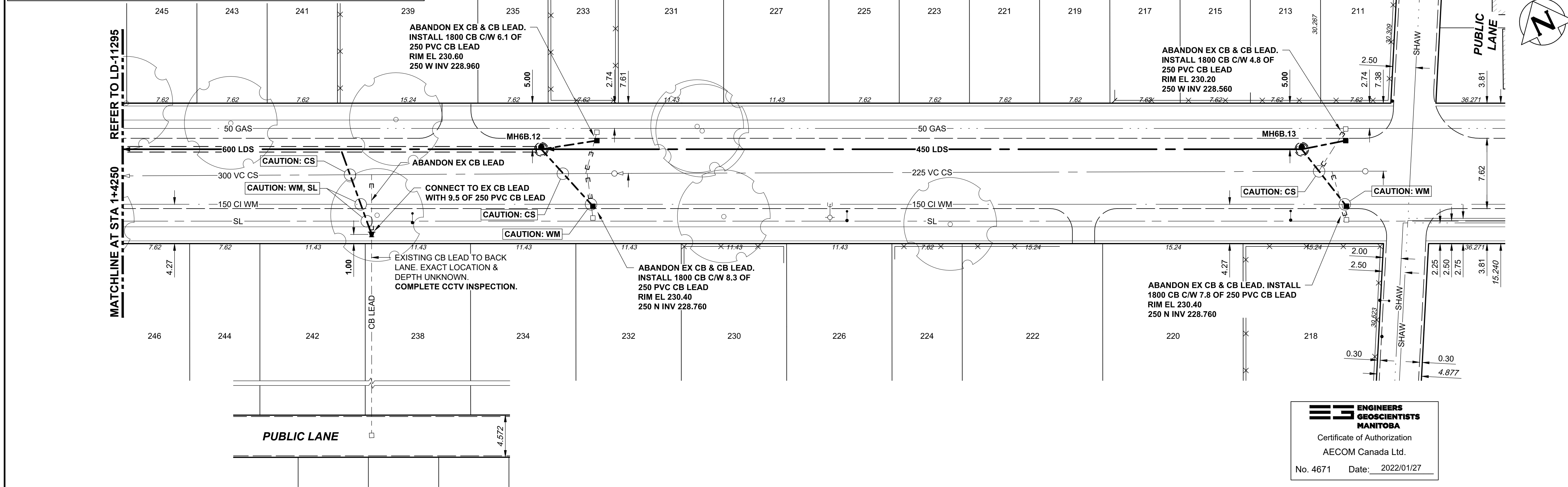

WARNING
IF POWER EQUIPMENT OR EXPLOSIVES ARE TO BE USED FOR EXCAVATION ON THIS PROJECT THE CONTRACTOR MUST:
1) NOTIFY THE GAS COMPANY OF THE PROPOSED LOCATION OF EXCAVATION.
2) TAKE PRECAUTION TO AVOID DAMAGE TO GAS COMPANY INSTALLATIONS.
SEE PROVINCIAL REGULATION 210/72 FOR DETAILS

LOCATION APPROVED
UNDERGROUND STRUCTURES
SUPV. U/G STRUCTURES COMMITTEE DATE
NOTE:
LOCATION OF UNDERGROUND STRUCTURES AS SHOWN ARE BASED ON THE BEST INFORMATION AVAILABLE BUT NO GUARANTEE IS GIVEN THAT ALL EXISTING UTILITIES ARE SHOWN OR THAT THE GIVEN LOCATIONS ARE EXACT. CONFIRMATION OF EXISTENCE AND EXACT LOCATION OF ALL SERVICES MUST BE OBTAINED FROM THE INDIVIDUAL UTILITIES BEFORE PROCEEDING WITH CONSTRUCTION.

B.M. ELEV.		CONSTRUCTION COMPLETION DATE: YYYY MM DD	
0	ISSUED FOR TENDER	22/01/27	ADL
NO.	REVISIONS	DATE	BY

AECOM

DESIGNED BY	JAT	CHECKED BY	MGM
DRAWN BY	ADL	APPROVED BY	KWF
SCALE:	HORIZONTAL 1:250 VERTICAL 1:50		
DATE	2022 01 28	RELEASED FOR CONSTRUCTION	K Zurek
		DATE	Jan 27/22

ENGINEER'S SEAL
ORIGINAL SIGNED BY J. Thompson
27/01/22
CONSULTANT DRAWING NUMBER C-1008

THE CITY OF WINNIPEG
WATER AND WASTE DEPARTMENT
ENGINEERING DIVISION
JEFFERSON EAST COMBINED SEWER RELIEF
Contract 6B
KILBRIDE AVENUE
25m EAST OF AIKINS STREET
TO 30m WEST OF MAIN STREET

SHEET 10 OF 13
CITY DRAWING NUMBER LD-11296