

PLAN VIEW: UNDERGROUND CONSTRUCTION
1:250

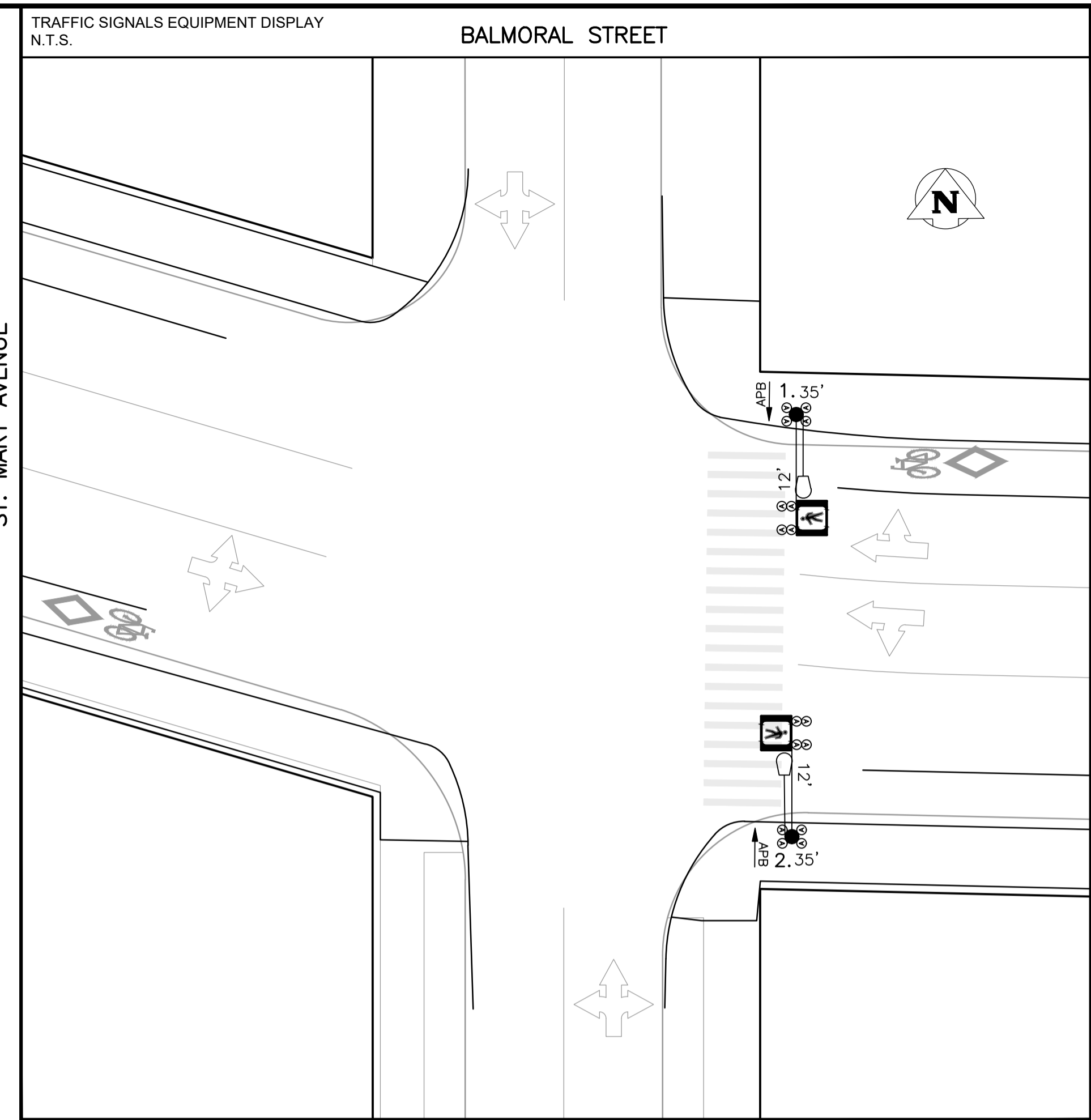

EQUIPMENT DISPLAY LEGEND

EXISTING	PROPOSED (AS SHOWN BELOW)	TRAFFIC SIGNAL HEAD	12'	LOW ARM (SHOWN FROM CENTRE)
PEDESTRIAN HEAD WITH PCS	VEHICLE DETECTION AREA	TRAFFIC SIGNAL POLE		HIGH ARM (SHOWN FROM SIDE)
PEDESTRIAN CORRIDOR BOX	TRAFFIC SIGNAL POLE	APS SINGLE DIRECTION	PB	PUSH BUTTON & DIRECTION (APB = AUDIBLE PB)
RRFB (PHASE 'A' OR 'B')	WOOD POST	APS DUAL DIRECTION (SEPARATE W/FRAME)	ED	ELECTRONIC DISPLAY
			RF	RED FLASHER
			AM	AMBER FLASHER (CIRCUIT 'A' OR 'B')
			CA	CAMERA
			LU	LUMINAIRE

NO.	EQUIPMENT LIST	ARM	BASE	B.B.	NO.	EQUIPMENT LIST	ARM	BASE	B.B.
1.	35' SIGNAL FOR XX WATT (XXXX LUMEN) LUMINAIRE	12'	G	GD					
2.	35' SIGNAL FOR XX WATT (XXXX LUMEN) LUMINAIRE	12'	G	GD					
3.	HYDRO WOOD SERVICE:								

TRAFFIC SIGNALS UNDERGROUND LEGEND			SIGNAL BASE BOLT SQUARE TYPES	
EXISTING	PROPOSED (AS SHOWN BELOW)		BOLT SQUARE (B.S.) DIA.	
1 1/2" PE CONDUIT	POLE BASE	○	TYPE "A" - 8 1/8"	
2" PE CONDUIT	WOOD POST	□	TYPE "B" - 6 3/4"	
4" PVC CONDUIT	CONTROLLER BASE	□	TYPE "C" - 8 1/8" SCREW TYPE	
AERIAL / BURIED CABLE	PEDESTAL BASE	□	TYPE "D" - 12 3/4", 1 1/4" DIA. BOLTS, 24" DIA.	
CONDUIT STUB	TERMINAL BASE	□	TYPE "OD" - 12 3/4", 1 1/4" DIA. BOLTS, 28" DIA.	
BREAK-IN	SERVICE BOX (PIT)	○	TYPE "POD" - 12 3/4", PRECAST, 1 1/4" DIA. BOLTS, 28" DIA.	
SPLICE	24" PRECAST PIT	△	TYPE "E" - 9 9/16" SCREW TYPE	
SAW-CUT LOOPS	30" PRECAST PIT	△	TYPE "F" - 9 9/16"	
PREFORMED LOOPS	36" PRECAST PIT	△	TYPE "G" - 8 1/8", 1 1/4" DIA. BOLTS, 89mm PROJ.	
	REMOVAL	↖	TYPE "GS" - 8 1/8", 1 1/4" DIA. BOLTS, 76mm PROJ.	
			TYPE "H" - 9 7/8" SCREW TYPE	
			TYPE "I" - 7 3/4"	
			TYPE "J" - 10 5/8", 1 1/4" DIA. BOLTS	
			TYPE "K" - 10 5/8", PRECAST, 1 1/4" DIA. BOLTS	
			TYPE "L" - 6", 5/8" DIA. BOLTS	
			TYPE "PM" - 8 1/8", PRECAST, 5/8" DIA. BOLTS	

EXISTING	LEGEND	PROPOSED	EXISTING	LEGEND	PROPOSED	EXISTING	LEGEND	PROPOSED
150 WM	WATERMAIN	150 WM	PROPERTY LINE	PROPERTY LINE	PROPERTY LINE	TELEPHONE	TELEPHONE	TELEPHONE
○	HYDRANT	○	ROADWAY	ROADWAY	ROADWAY	○	TELEPHONE	TELEPHONE
○	VALVE	○	SIDEWALK	SIDEWALK	SIDEWALK	○	COMMUNICATION	COMMUNICATION
○	300 SEWER	○	CURB & CURB RAMP	CURB & CURB RAMP	CURB & CURB RAMP	○	WOOD POLE	WOOD POLE
○	MANHOLE	○	WARNING TILE	WARNING TILE	WARNING TILE	○	STREET LIGHT	STREET LIGHT
○	CATCH BASIN	○	SLOPE	SLOPE	SLOPE	○	BANNER POLE	BANNER POLE
○	CURB INLET	○	CULVERT	CULVERT	CULVERT	○	RAILWAY POLE	RAILWAY POLE
○	HYDRO	○	BUILDING	BUILDING	BUILDING	○	GUY-WIRE	GUY-WIRE
○	GAS	○	TREE	TREE	TREE	○	FENCE	FENCE
○		○				○	GUARDRAIL	GUARDRAIL

UNDERGROUND STRUCTURES

UNDERGROUND STRUCTURES ID	DATE (YYYYMMDD)

WATER & WASTE REVIEW ID

NOTE: LOCATIONS OF UNDERGROUND STRUCTURES AS SHOWN ARE BASED ON THE BEST INFORMATION AVAILABLE. BUT NO GUARANTEE IS GIVEN THAT ALL EXISTING UTILITIES ARE SHOWN OR THAT THE GIVEN LOCATIONS ARE EXACT. CONFIRMATION OF EXISTENCE AND EXACT LOCATION OF ALL SERVICES MUST BE OBTAINED FROM THE INDIVIDUAL UTILITIES BEFORE PROCEEDING WITH CONSTRUCTION.

CONSTRUCTION REVISIONS

NO.	REVISION	DATE (YYYYMMDD)	BY
A	PRELIMINARY DESIGN		

ACCOUNTS:

WT PENDING

DESIGNED BY:

R.S.

DRAWN BY:

R.S.

CHECKED BY:

APPROVED BY:

ENGINEER'S SEAL:

PRELIMINARY

NOT FOR CONSTRUCTION

THE CITY OF WINNIPEG
PUBLIC WORKS DEPARTMENT
TRANSPORTATION DIVISION

PEDESTRIAN CORRIDOR
BALMORAL ST. & ST. MARY AVE.

UNITS: ALL DIMENSIONS ARE IN METERS UNLESS OTHERWISE NOTED

DRAWING NUMBER:
S-1892

V:\Staff\Engineering\Transportation\Balmoral & St. Mary St. 1892.dwg