

- NOTES:
1. ALL WORK AND MATERIALS TO BE IN ACCORDANCE WITH THE LATEST REVISION OF THE CITY OF WINNIPEG STANDARD CONSTRUCTION SPECIFICATIONS.
 2. CONTRACTOR TO CONFIRM THE LOCATION OF ALL UTILITIES/SERVICES IN THE FIELD PRIOR TO CONSTRUCTION.
 3. ALL ROADWAY DIMENSIONS SHOWN ARE TO BACK OF CURB.
 4. RENEW CURB AND SIDEWALK AS IDENTIFIED BY CONTRACT ADMINISTRATOR.
 5. CONSTRUCT 200mm REINFORCED CONCRETE ALLEY APPROACHES AND 200mm REINFORCED CONCRETE COMMERCIAL APPROACHES WITH 70mm OF GRANULAR A BASE, 300mm-50mm GRANULAR A SUB-BASE, AND SEPARATION/FILTRATION GEOTEXTILE FABRIC AS DIRECTED BY CONTRACT ADMINISTRATOR.
 6. ALL PRIVATE WALKWAYS TO BE ADJUSTED/RENEWED TO NEW SIDEWALK OR TOP OF CURB ELEVATION, AS REQUIRED.
 7. ADJUST MH FRAMES, CB RIMS, VALVES, CURB STOPS AND HYDRANTS TO NEW GRADES, AS REQUIRED.
 8. MODIFIED BARRIER CURB TO BE CONSTRUCTED AT ALL INTERSECTION RADII AND BACK LANE RADII.
 9. ALL EXISTING LONG WATER SERVICES TO BE INSULATED AS PER SD-018 AND E14, AS REQUIRED.
 10. CONTRACTORS TO TAKE PRECAUTIONARY STEPS TO PROTECT EXISTING TREES WITHIN THE LIMITS OF CONSTRUCTION FROM DAMAGE FROM CONSTRUCTION ACTIVITIES AS OUTLINED IN THE SPECIFICATIONS.
 11. ALL BOULEVARDS TO BE SODDED UNLESS OTHERWISE NOTED.
 12. UTILITY MANHOLE ISOLATION DIMENSIONS TO BE ADJUSTED BY CONTRACT ADMINISTRATOR AFTER VAULTS HAVE BEEN EXPOSED DURING EXCAVATION.

EXISTING	LEGEND-PLAN	PROPOSED	EXISTING	LEGEND-PLAN	PROPOSED	EXISTING	LEGEND-PROFILE	PROPOSED
---	WATER MAIN	---	---	IRON BAR	---	---	---	---
---	LAND DRAINAGE SEWER	---	---	HYDRO POLE & LIGHT STANDARD	---	---	---	---
---	WASTE WATER SEWER	---	---	LIGHT STANDARD OR TRAFFIC SIGNAL	---	---	---	---
---	HYDRO	---	---	HYDRO POLE	---	---	---	---
---	BELL/MTS	---	---	CURB RAMP	---	---	---	---
---	GAS	---	---	DETECTABLE WARNING SURFACE TILE	---	---	---	---
---	SIGNALS	---	---	EDGE OF SIDEWALK	---	---	---	---
---	MANHOLE	---	---	FENCE	---	---	---	---
---	CATCH BASIN	---	---	PROPERTY LINE	---	---	---	---
---	CURB INLET	---	---	EDGE OF ASPHALT	---	---	---	---
---	UTILITIES ADJUSTED	---	---	EDGE OF CONCRETE	---	---	---	---
---	PLUG	---	---	MODIFIED BARRIER CURB	---	---	---	---
---	HYDRANT	---	---	BARRIER CURB	---	---	---	---
---	VALVE	---	---	BARRIER CURB AND GUTTER	---	---	---	---
---	CURB STOP	---	---	CONC SIDEWALK	---	---	---	---
---	GROUND GRADE	---	---	CONCRETE SLAB	---	---	---	---
---	PAVEMENT GRADE	---	---	ASPHALT	---	---	---	---
---	ANCHOR	---	---	MILLED SURFACE	---	---	---	---
---	#11 CIVIC ADDRESS	---	---	PAVEMENT REPAIR FABRIC	---	---	---	---

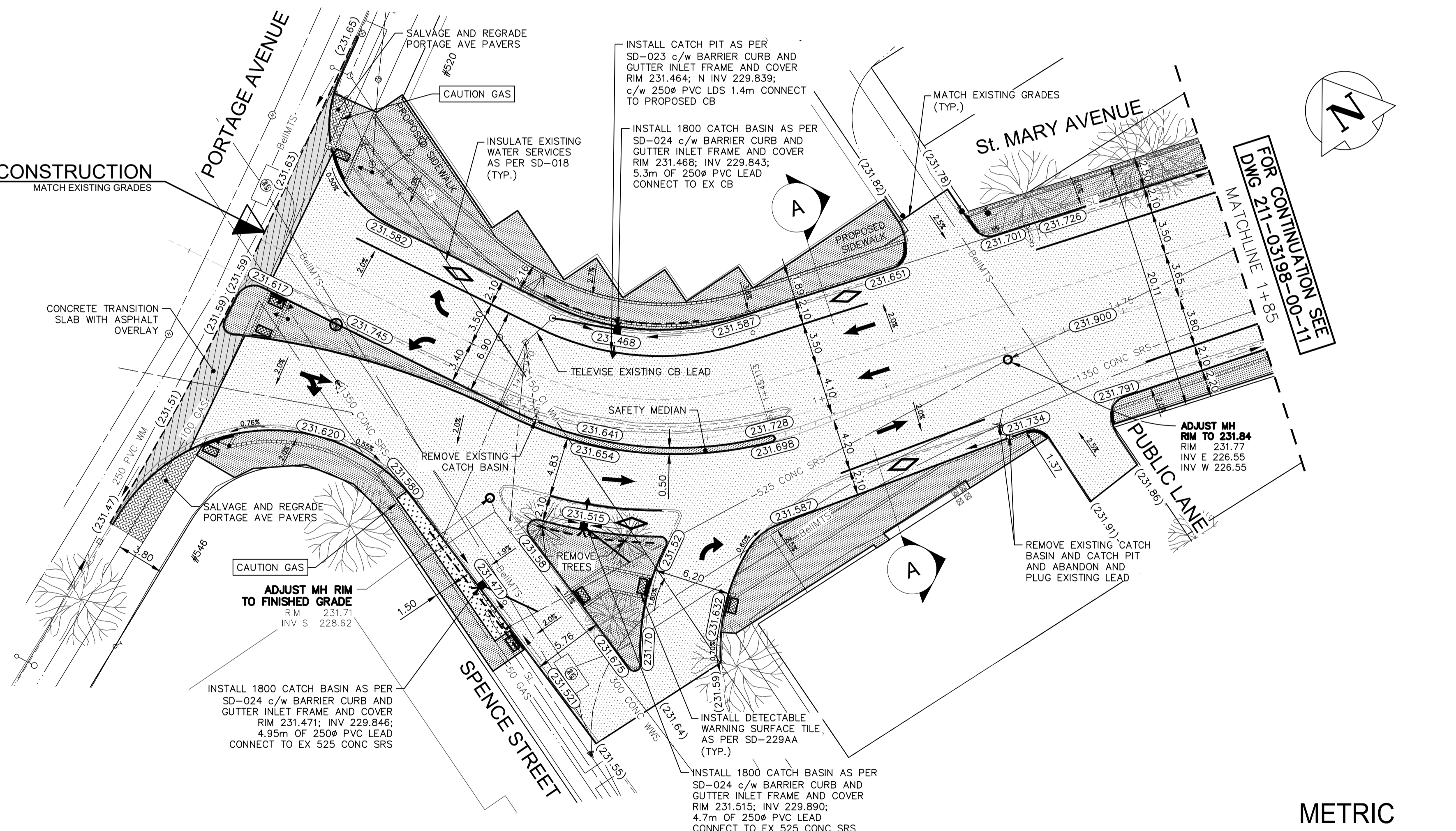

EXISTING	LEGEND-PLAN	PROPOSED	EXISTING	LEGEND-PROFILE	PROPOSED
---	WATER MAIN	---	---	IRON BAR	---
---	LAND DRAINAGE SEWER	---	---	HYDRO POLE & LIGHT STANDARD	---
---	WASTE WATER SEWER	---	---	LIGHT STANDARD OR TRAFFIC SIGNAL	---
---	HYDRO	---	---	HYDRO POLE	---
---	BELL/MTS	---	---	CURB RAMP	---
---	GAS	---	---	DETECTABLE WARNING SURFACE TILE	---
---	SIGNALS	---	---	EDGE OF SIDEWALK	---
---	MANHOLE	---	---	FENCE	---
---	CATCH BASIN	---	---	PROPERTY LINE	---
---	CURB INLET	---	---	EDGE OF ASPHALT	---
---	UTILITIES ADJUSTED	---	---	EDGE OF CONCRETE	---
---	PLUG	---	---	MODIFIED BARRIER CURB	---
---	HYDRANT	---	---	BARRIER CURB	---
---	VALVE	---	---	BARRIER CURB AND GUTTER	---
---	CURB STOP	---	---	CONC SIDEWALK	---
---	GROUND GRADE	---	---	CONCRETE SLAB	---
---	PAVEMENT GRADE	---	---	ASPHALT	---
---	ANCHOR	---	---	MILLED SURFACE	---
---	#11 CIVIC ADDRESS	---	---	PAVEMENT REPAIR FABRIC	---

LOCATIONS APPROVED UNDERGROUND STRUCTURES		G.S.M. TOP NUT OF FIRE HYDRANT AT ELEV.	
SIGNED BY:	DATE:	H	
SUPV UG STRUCTURES		G	
		F	
		E	
		D	
		C	
		B	
		A	
		NO.	

DESIGNED BY		CHECKED BY	
MV/SS		SS	
DRAWN BY		APPROVED BY	
SB		SM	
HORIZ. SCALE		RELEASED FOR CONSTRUCTION	
1:250		---	
VERTICAL SCALE		DATE	
1:10		AUGUST 2021	

FOR TENDER PURPOSES ONLY
NOT FOR CONSTRUCTION

WSP Canada Inc.
1600 Buffalo Place
Winnipeg, MB R3T 6B8
t. 204.477.6650
f. 204.474.2864
www.wsp.com

THE CITY OF WINNIPEG
PUBLIC WORKS DEPARTMENT
ENGINEERING SERVICES DIVISION

2021-2022 PIONEER, WILLIAM STEPHENSON,
COLONY & ST. MARY RENEWALS PROJECT

ST. MARY AVENUE - PLAN AND PROFILE
CONCRETE RECONSTRUCTION
STA. 0+99.49 TO STA. 1+85

CITY DRAWING NUMBER: P-3546-10
SHEET 10 OF 19
TENDER NO. 807-2021