

**LEGEND**

- ELECTRICAL OUTLET
- ENTRANCE/EXIT
- NO. OF STALLS IN EACH ROW/COLUMN
- CURRENTLY NOT MANAGED BY WPA
- LIGHT
- CHAIN LINK FENCE
- POST AND CHAIN FENCE
- G GARBAGE
- CB CATCH BASIN
- DECIDUOUS TREE
- GRASS
- UNMARKED STALLS
- MARKED STALLS

- S1** CITY OF WINNIPEG TELEPHONE: 311 UNAUTHORIZED PARKING PROHIBITED
- S2** MANAGEMENT OF THE WINNIPEG MARKET 311
- S4** PROTECTING YOUR PARKED VEHICLE VALUABLES OUT OF SIGHT? AM I BEING DRIVEN AWAY? DOORS LOCKED? MP!
- S6** DR. HOOK TOWING 95-485 UNAUTHORIZED PARKING PROHIBITED
- S11** DR. HOOK TOWING 95-485 UNAUTHORIZED PARKING PROHIBITED
- S13** ASSIGNED
- S53** ASSIGNED
- S56** ASSIGNED
- S352** WARNING THE STALL IS RESERVED FOR SECURITY
- S567** EMERGENCY EXIT DO NOT BLOCK



| LOT # 2 - 601 AIKINS ST. | EST. TOTALS | HANDICAP | WPA RSVD | STAFF | VISITORS | UPDATED          |
|--------------------------|-------------|----------|----------|-------|----------|------------------|
| MARKED                   | 12          | 1        |          | 12    |          | 2010.08.03 (MHo) |
| UNMARKED                 | 4           |          |          | 4     |          |                  |

ALLARD AVE.

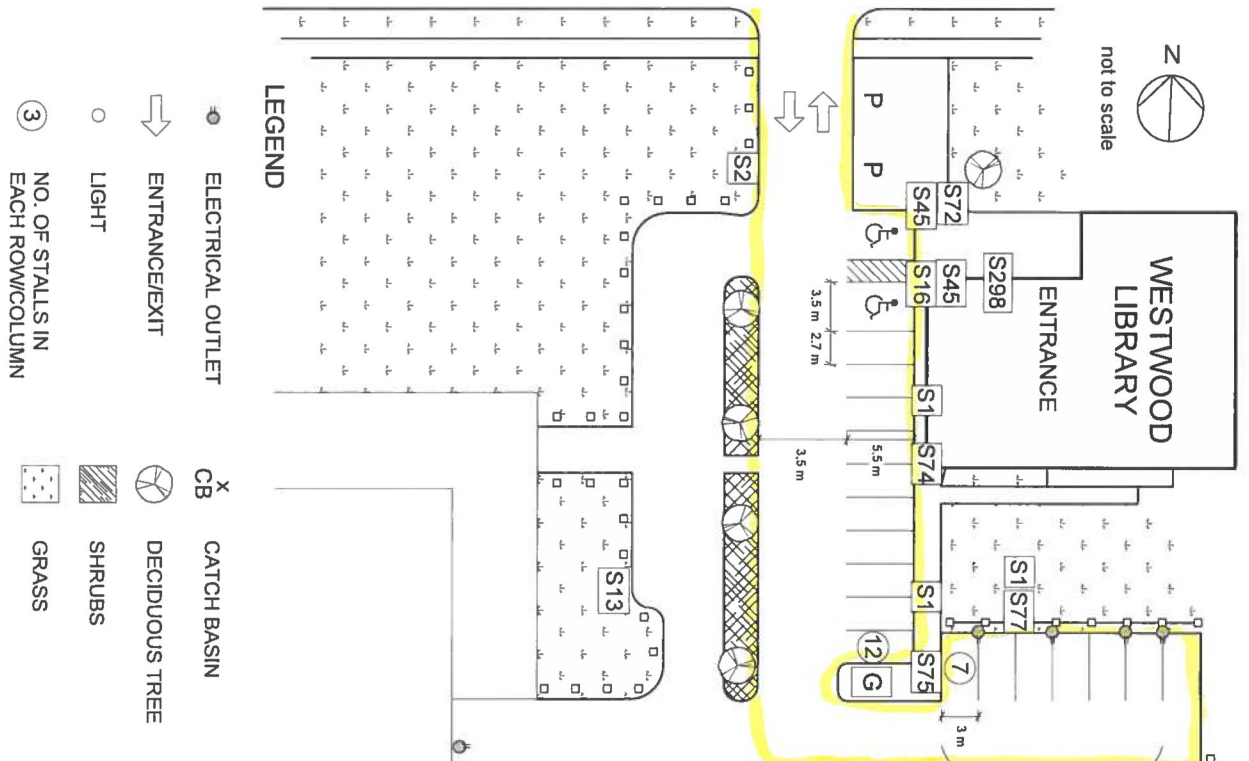

| LOT # 3<br>66 ALLARD AVE. | EST. TOTALS | HANDICAP | WPA RSVD | STAFF | VISITORS | UPDATED            |
|---------------------------|-------------|----------|----------|-------|----------|--------------------|
|                           | 19          | 2        |          | 6     | 11       | 2010.07.30<br>M.Ho |

**S1** CITY OF VANCOUVER  
TELEPHONE: 311  
UNAUTHORIZED  
PARKING  
PROHIBITED

**S2** THE ROBERT  
CAMBERGER  
TRUST  
PARKING  
APPLICANT  
311

**S4** PROTECTING YOUR  
PARKED VEHICLE  
VALUES OUT OF SIGHT?  
ANTI-THEFT DEVICE ONLY  
DOORS LOCKED?  
MPI

**S13**

**S16** IDLE FREE  
ZONE  
HEALTHY  
COMMUNITIES  
DON'T IDLE

**S45**

**S72** LIBRARY PATRONS  
ONLY

**S74** CITY OF VANCOUVER  
LIBRARY VISITOR  
PARKING ONLY

**S75** LIBRARY PATRONS  
ONLY

**S77** EMPLOYEE PARKING  
STALLS 1-6

**S298** CAUTION  
  
SURFACES MAY BE  
SLIPPERY

**S1**

**S2**

**S4**

**S13**

**S16**

**S45**

**S72**

**S74**

**S75**

**S77**

**S298**

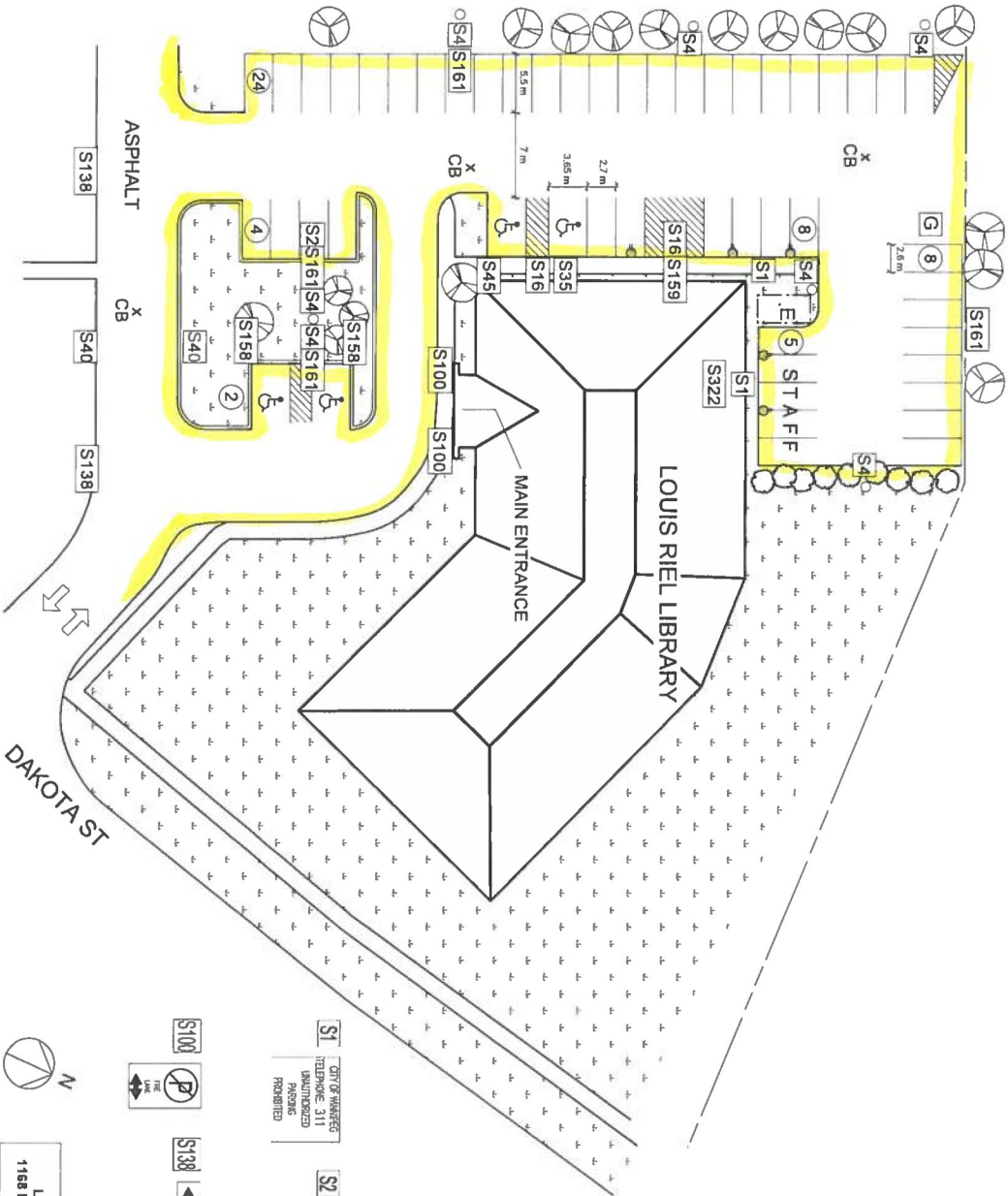

**LEGEND**

- ⊙ ELECTRICAL OUTLET
- ⇨ ENTRANCE/EXIT
- ③ NO. OF STALLS IN EACH ROW/COLUMN
- LIGHT
- X CATCH BASIN
- CB ELECTRICAL BOX
- ⊙ DECIDUOUS TREE
- ⊙ SHRUB
- ⊙ GRASS
- ▭ MARKED STALLS
- G GARBAGE
- CHAIN LINK FENCE

- S1 CITY OF WINNIPEG TELEPHONE 311 UNBUNDLED PROGRAM PROVIDED
- S2 "SUSANAH" FIRE AND LIFE SAFETY SYSTEM
- S4 PROTECTING FROM VALUABLES OUT OF SIGHT (ANTI-THEFT DEVICE) DOORS LOCKED 24H
- S16 ROLE FREE 2.1M CLEARANCE DOORWAYS
- S35 LIBRARY PATRON PARKING ONLY STATIONEMENT RESERVE FOR SUSCEPTIBLE LIBRARIANS
- S40 EMPLOYEE PARKING STALLS 1-4
- S100
- S138
- S158
- S159
- S161
- S322



|                             |          |          |       |          |
|-----------------------------|----------|----------|-------|----------|
| LOT # 22<br>1168 DAKOTA ST. |          |          |       |          |
| EST. TOTALS                 | HANDICAP | WPA RSVD | STAFF | VISITORS |
| 51                          | 4        |          | 4     | 43       |
| UPDATED                     |          |          |       |          |
| 2010.07.02                  |          |          |       |          |
| M.Ho                        |          |          |       |          |

LEGEND

- S1 CITY OF VANCOUVER UNPAVING/PAVED PARKING REQUESTED
- S4 PROTECTIVE TOWER (VALUABLES OUT OF SIGHT AND HEFT REMOVE OR DOORS LOCKED) LIFT
- S9
- S16 IDEE FREE HEALTHY COMMUNITIES DON'T DILE
- S45
- S133
- S159
- S160 EDIT ONEE PARKING STALLS 1-6
- S164 ARRETEZ LE MOTEUR (LIBRARIES VE HONORING ASPH/INT)
- S192 CITY OF VANCOUVER NO PARKING THIS SIDE
- S193 ADDITIONAL VISITOR PARKING AT WEST END OF LIBRARY
- S194 LIBRARY VISITOR ONLY STATIONNEMENT RESERVE AUX USAGERS DE LA BIBLIOTHEQUE
- S196 CITY OF VANCOUVER NO PARKING
- S197 ADDITIONAL LIBRARY PARKING
- S199 ST VITAL LIBRARY STAFF PARKING STALLS 1-6
- S200
- S201 LIBRARY VISITOR PARKING PARALLEL ONLY
- S276 STOP
- S323
- S324
- S194 LIBRARY VISITOR ONLY STATIONNEMENT RESERVE AUX USAGERS DE LA BIBLIOTHEQUE
- S196 CITY OF VANCOUVER NO PARKING
- S197 ADDITIONAL LIBRARY PARKING
- S199 ST VITAL LIBRARY STAFF PARKING STALLS 1-6
- S200
- S201 LIBRARY VISITOR PARKING PARALLEL ONLY
- S276 STOP
- S323
- S324

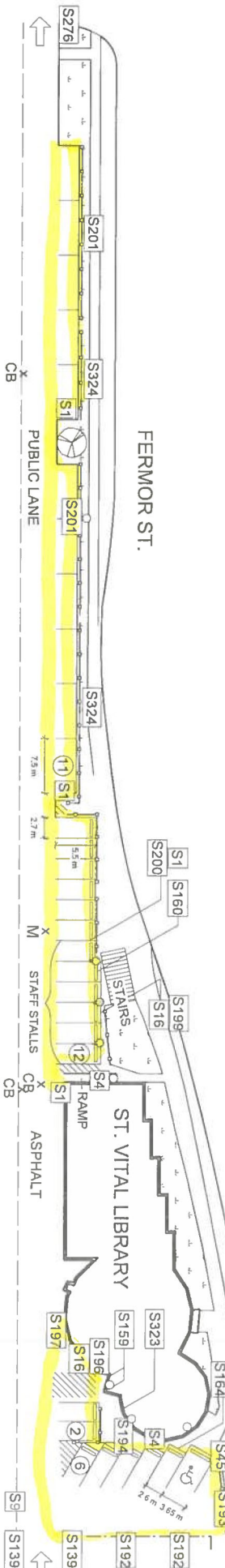

| LOT # 29<br>6 FERMOR ST. | EST. TOTALS | HANDICAP | WPA RSVD | STAFF | VISITORS   | UPDATED |
|--------------------------|-------------|----------|----------|-------|------------|---------|
|                          | 31          | 1        | 6        | 24    | 2010.07.30 | M.Ho    |

not to scale

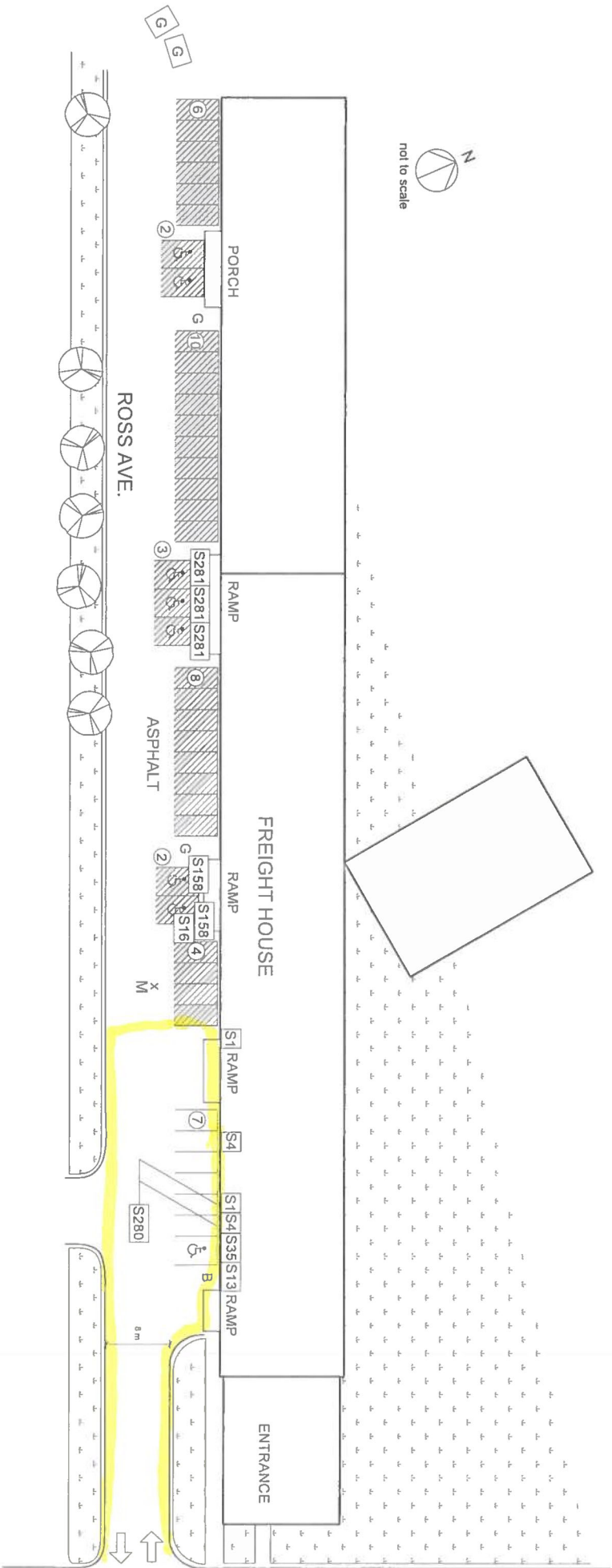

- LEGEND**
- ↔ ENTRANCE/EXIT
  - ⊞ GRASS
  - ⊞ BIKE RACK
  - ⊞ GARBAGE
  - ⊞ MANHOLE
  - ⊞ DECIDUOUS TREE
  - ⊞ MARKED STALLS
  - ⊞ NO. OF STALLS IN EACH ROW/COLUMN
  - ⊞ GARBAGE CURRENTLY NOT MANAGED BY WPA

S1 CITY WORKERS  
PHONE: 311  
UNLICENSED  
PERSONS  
PROHIBITED

S4 PROTECTIVE TONE  
PARKED VEHICLE  
VALUERS OUT OF SIGHT  
MINIMUM 10 FEET  
DOORS LOCKED  
M

S13

S16 IDEEFREE  
HEALTHY  
COGNITIVE  
OBTAINABLE

S35

S158

S280  
P  
STAFF PARKING  
RESERVED  
24 HRS













S281

⊞ HANDICAP ONLY

| LOT #40<br>200 ISABEL ST. | EST. TOTALS | HANDICAP | WPA RSVD | STAFF | VISITORS | UPDATED<br>2010.07.30<br>M/Ho |
|---------------------------|-------------|----------|----------|-------|----------|-------------------------------|
|                           | 7           | 1        |          | 2     | 4        |                               |

ISABEL ST.

**LEGEND**

-  ELECTRICAL OUTLET
-  ENTRANCE/EXIT
-  NO. OF STALLS IN EACH ROW/COLUMN
-  LIGHT
-  GARBAGE
-  CATCH BASIN
-  DECIDUOUS TREE
-  CONIFEROUS TREE
-  GRASS
-  WOODEN FENCE
-  CHAIN LINK FENCE
-  MARKED STALLS

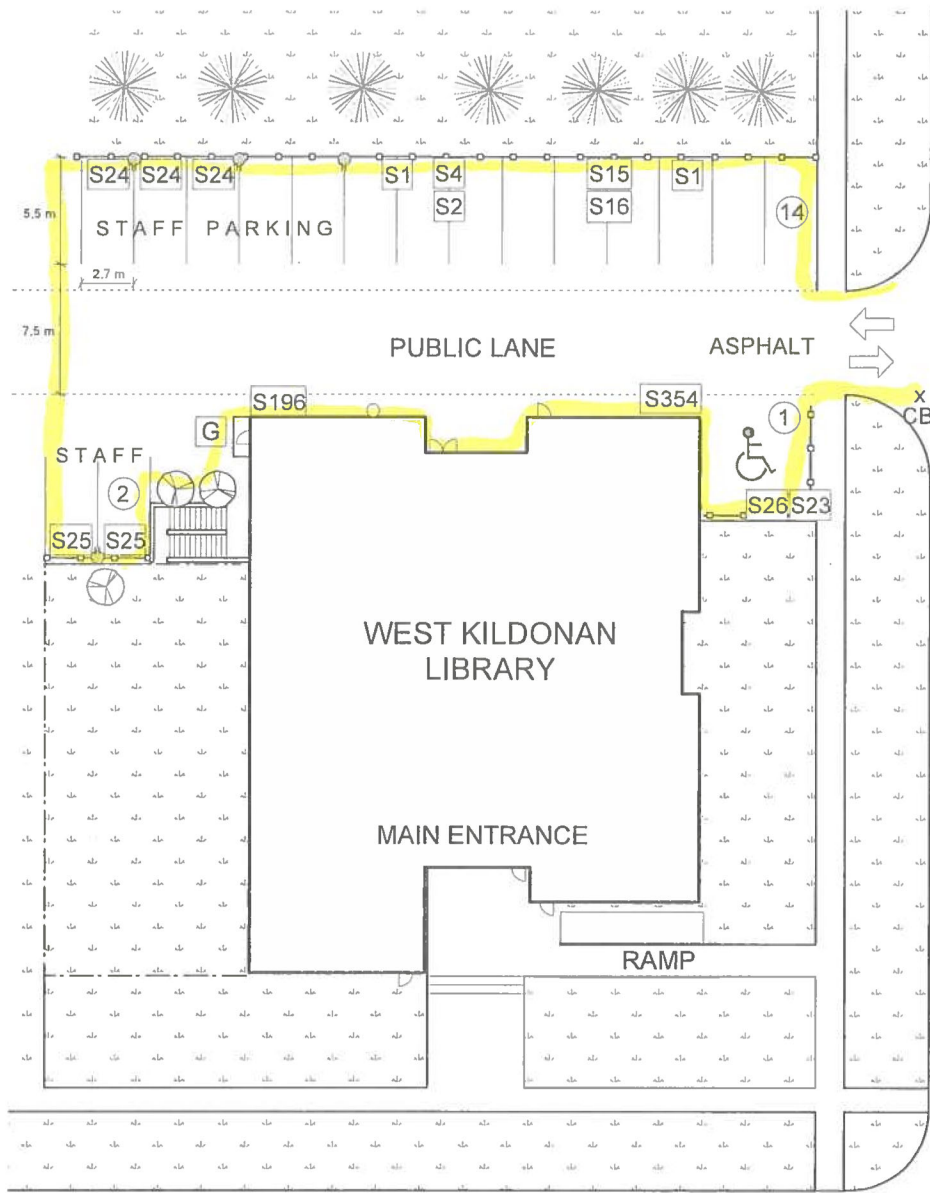

JEFFERSON AVE.

**S1** CITY OF WINNIPEG  
TELEPHONE 311  
UNAUTHORIZED  
PARKING  
PROHIBITED

**S2** THIS PROPERTY  
ADMINISTERED  
BY THE  
WINNIPEG  
PARKING  
AUTHORITY  
311

**S4** PROTECTING YOUR  
PARKED VEHICLE  
VALUABLES OUT OF SIGHT?  
ANTI-THEFT DEVICE ON?  
DOORS LOCKED?  
MPI

**S15** WEST KILDONAN  
LIBRARY  
VISITOR PARKING  
← STALLS 14 →

**S16** IDLE FREE  
ZONE  
  
HEALTHY  
COMMUNITIES  
DON'T IDLE

**S23** 

**S24** STAFF PARKING  
ONLY

**S25** LIBRARY  
STAFF PARKING  
ONLY

**S26** ONE VEHICLE ONLY

**S196** CITY OF WINNIPEG  
TELEPHONE 311  
NO  
PARKING  
←

**S354** CITY OF WINNIPEG  
TELEPHONE 311  
NO  
PARKING  
→



| LOT # 41<br>365 JEFFERSON AVE. | EST. TOTALS | HANDICAP | WPA RSVD | STAFF | VISITORS | UPDATED            |
|--------------------------------|-------------|----------|----------|-------|----------|--------------------|
|                                | 17          | 1        |          | 7     | 9        | 2010.06.28<br>M.Ho |

**LEGEND**

- ELECTRICAL OUTLET
- ENTRANCE/EXIT
- NO. OF STALLS IN EACH ROW/COLUMN
- LIGHT
- CHAIN LINK FENCE
- FIRE HYDRANT
- CATCH BASIN
- DECIDUOUS TREE
- CONIFEROUS TREE
- SHRUBS/FLOWER BED
- GRASS
- MARKED STALLS
- GARBAGE
- ELECTRICAL BOX
- BIKE RACK

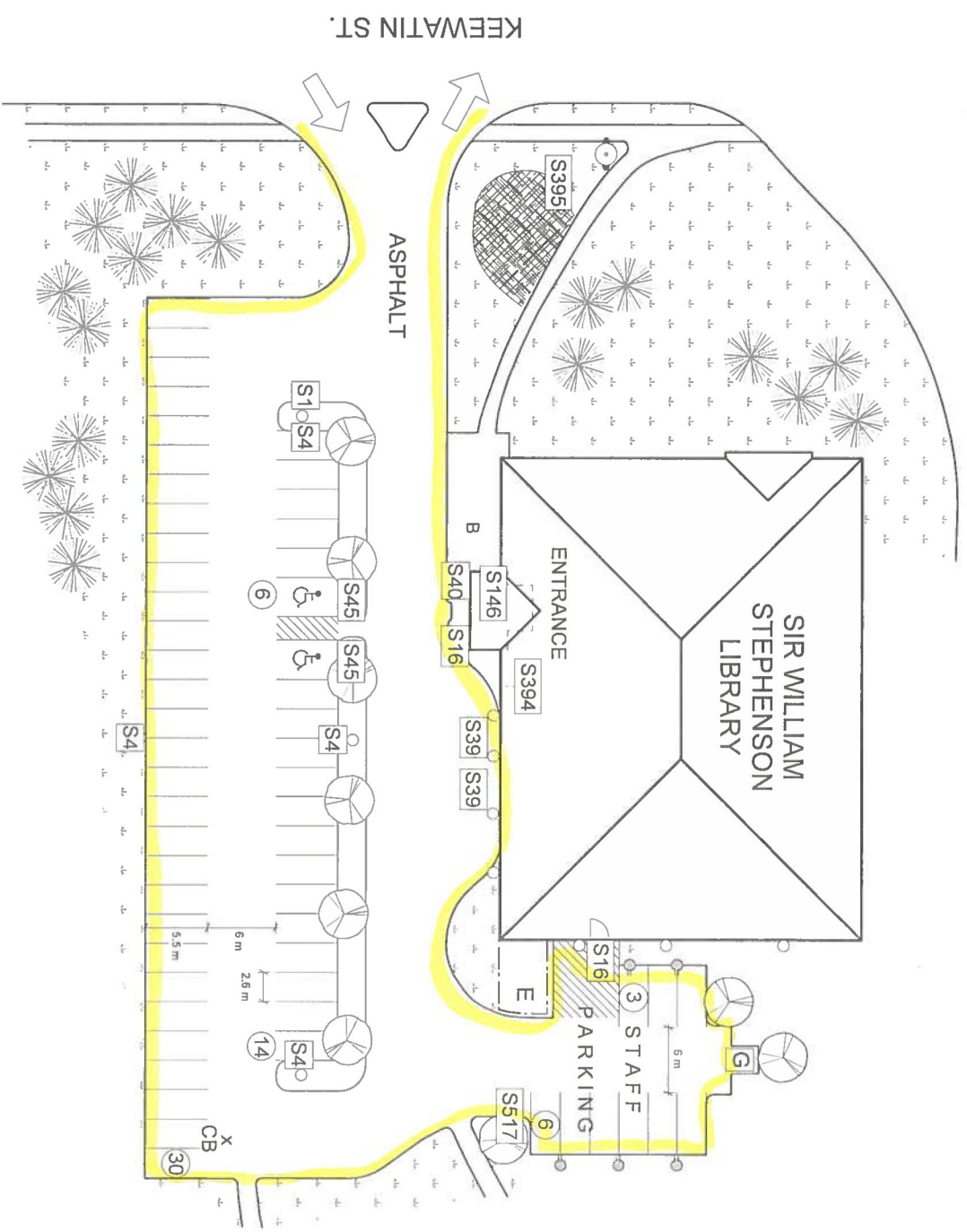

- S1** CITY OF VANCOUVER TELEPHONE: 311 UNAUTHORIZED PARKING PROHIBITED
- S4** PROTECTING YOUR PARKED VEHICLE: VALUABLES OUT OF SIGHT? AIR FRESHENER? DEVICE ON? DOORS LOCKED? AHA!
- S16** IDLE FREE ZONE: HEALTHY COMMUNITIES DON'T IDLE
- S39** [Symbol]
- S40** [Symbol]
- S45** [Symbol]
- S146** AREA MONITORED BY SURVEILLANCE CAMERA
- S394** [Symbol]
- S395** Sir William Stephenson LIBRARY
- S517** [Symbol]
- P** STAFF ONLY



|                             |  |             |          |          |       |            |         |
|-----------------------------|--|-------------|----------|----------|-------|------------|---------|
| LOT #42<br>765 KEEWATIN ST. |  | EST. TOTALS | HANDICAP | WPA RSVD | STAFF | VISITORS   | UPDATED |
|                             |  | 59          | 2        | 9 WPA    | 48    | 2010.07.30 | M.Ho    |

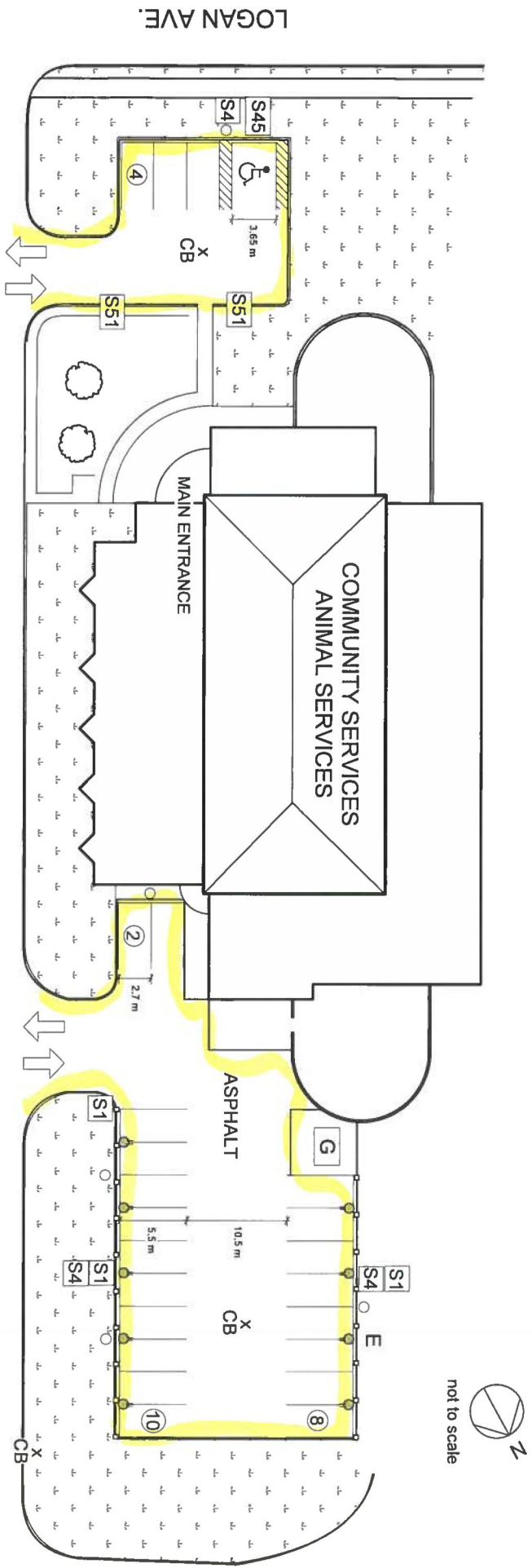

**LEGEND**

- ELECTRICAL OUTLET
- WOODEN FENCE
- G GARBAGE
- CITY OF WINNIPEG TELEPHONE: 311 UNAUTHORIZED PARKING PROHIBITED
- CB CATCH BASIN
- E ELECTRICAL BOX
- SHRUB
- MARKED STALLS
- GRASS
- LIGHT
- S4** PROTECTING YOUR PARKED VEHICLE. VALUABLES OUT OF SIGHT? ANTI-THEFT DEVICE ON? DOORS LOCKED? #1
- S45**
- S51**

| LOT # 45<br>1057 LOGAN AVE. | EST. TOTALS | HANDICAP | WPA RSVD | STAFF | VISITORS | UPDATED            |
|-----------------------------|-------------|----------|----------|-------|----------|--------------------|
|                             | 24          | 1        |          | 20    | 3        | 2010.06.15<br>M.Ho |



# LEGEND

- S1 CITY OF WAINWEGG TELEPHONE: 311 UNAUTHORIZED PARKING PROHIBITED
- S2 UNPAVED DRIVEWAY LIMITED PARKING ASSESSMENT S11
- S4 PROTECTING YOUR PARKED VEHICLE VALUABLES OUT OF SIGHT? ANTI-THEFT DEVICE ON? DOORS LOCKED? MP1
- S11 DR. HOOK TOWING 656-4685 UNAUTHORIZED PARKING PROHIBITED
- S16 IDLE FREE ZONE 15 MIN HEALTHY COMMUNITIES DON'T IDLE
- S35 HANDICAPED PARKING
- S41 HANDICAPED PARKING
- S42 HANDICAPED PARKING
- S87 HANDICAPED PARKING
- S88 HANDICAPED PARKING
- S100 NO PARKING FIRE LANE
- S129 NO PARKING BETWEEN SCISS
- S130 NO PARKING BETWEEN SCISS
- S414 Fort Rouge Leisure Centre Osborne Avenue 42 Osborne Street
- S1 ELECTRICAL OUTLET
- S2 ENTRANCE/EXIT
- S3 NO. OF STALLS IN EACH ROW/COLUMN
- S4 LIGHT
- S5 WOODEN FENCE
- CB CATCH BASIN
- DECIDUOUS TREE
- SHRUB
- GRASS
- MARKED STALLS

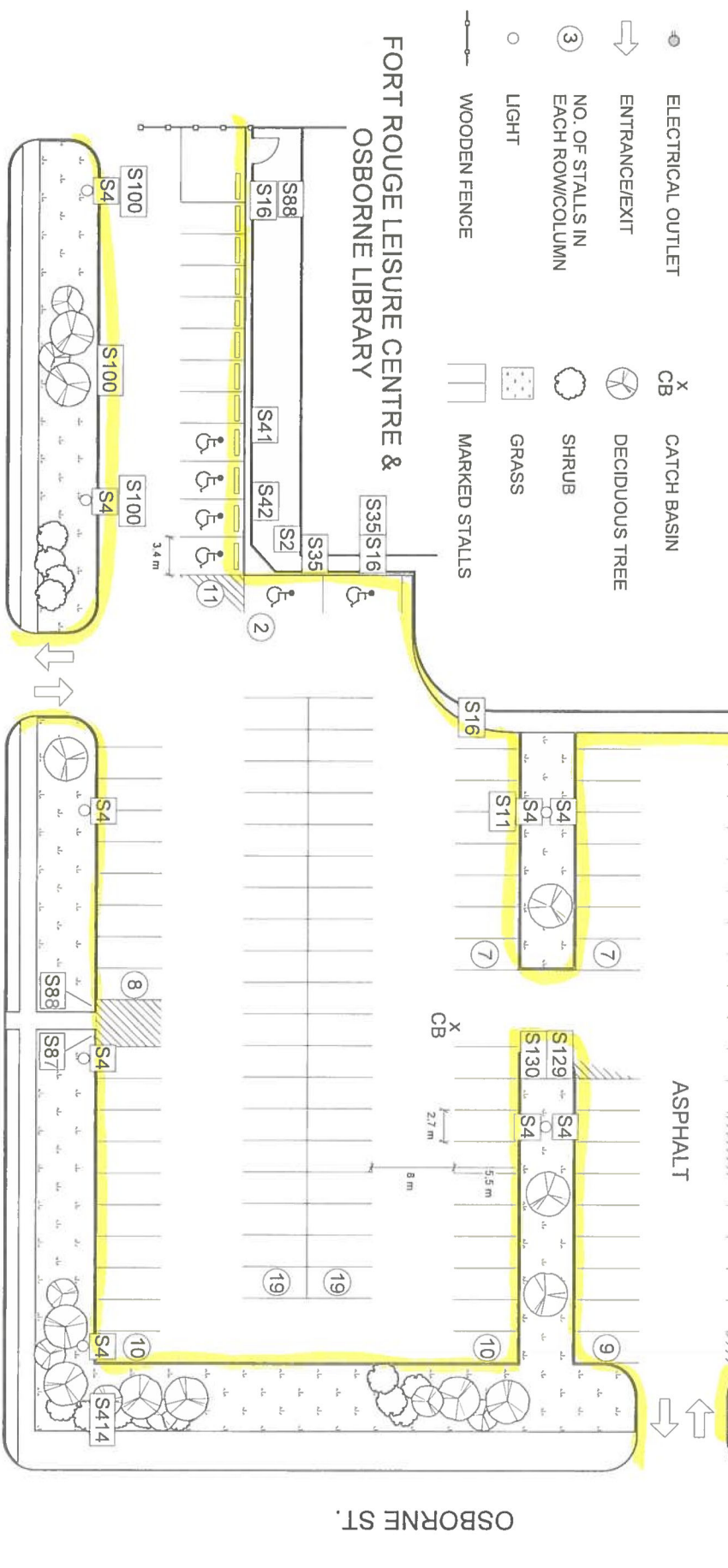

## FORT ROUGE LEISURE CENTRE & OSBORNE LIBRARY



| LOT #62         | EST. TOTALS | HANDICAP | WPA RSVLD | STAFF | VISITORS | UPDATED         |
|-----------------|-------------|----------|-----------|-------|----------|-----------------|
| 625 OSBORNE ST. | 119         | 6        |           |       | 113      | 2010.09.07 M.Ho |

not to scale

- LEGEND**
- LIGHT
  - E ELECTRICAL BOX
  - ⊖ ELECTRICAL OUTLET
  - ③ NO. OF STALLS IN EACH ROW/COLUMN
  - ⇨ ENTRANCE/EXIT
  - ⊗ DECIDUOUS TREE
  - ▨ SHRUBS
  - GRASS
  - WOODEN FENCE
  - ⊕ FIRE HYDRANT
  - M MANHOLE
  - X CATCH BASIN
  - ▭ MARKED STALLS

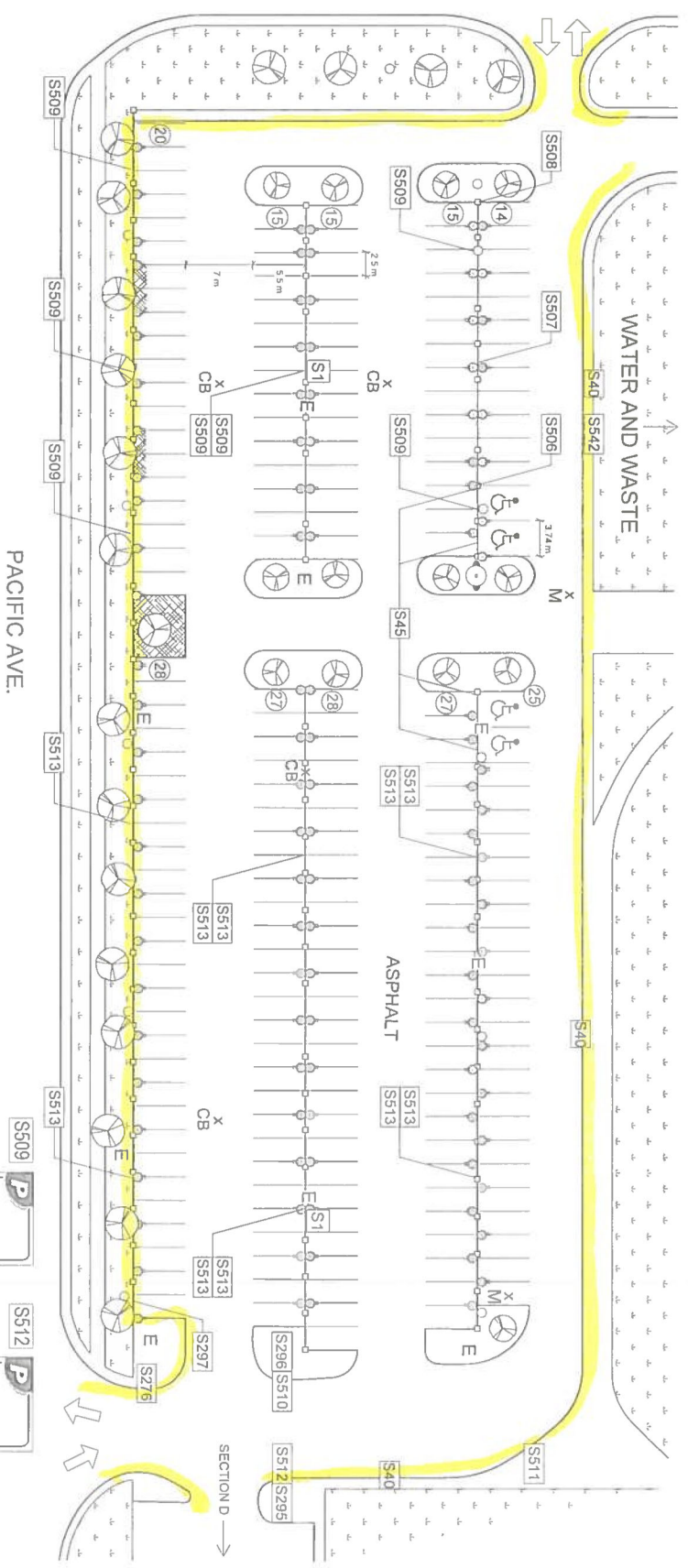

DIRTY WHEELS  
RESPONSE 311  
LAUNDRIZED  
PARKING  
PROHIBITED

Public Works Department  
Service des travaux publics  
1155 Pacific Avenue  
1155 Avenue Public

Water and Waste Department  
Service des eaux et des déchets  
1192 Pacific Avenue  
1192 Avenue Public

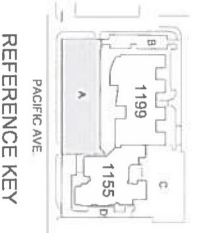

STOP

|   |             |          |          |       |          |                                |
|---|-------------|----------|----------|-------|----------|--------------------------------|
| LOT # 63<br>1155/1199 PACIFIC AVE.<br>SECTION A | EST. TOTALS | HANDICAP | WPA RSVD | STAFF | VISITORS | UPDATED<br>2010.07.26<br>M.H.o |
|   | 214         | 4        |          | 198   | 12       |                                |

- S511 P VISITOR PARKING  
VISITOR PARKING  
WHERE ARE BEST CAR
- S510 P VISITOR PARKING  
VISITOR PARKING  
VISITOR PARKING ONLY
- S509 P ASSIGNED PARKING  
WATER AND WASTE  
ONLY
- S512 P VISITOR PARKING  
PUBLIC WORKS ONLY
- S513 P ASSIGNED PARKING  
PUBLIC WORKS ONLY
- S442 P VISITORS  
PLEASE  
RELEASE  
YOUR CAR  
AT RECEPTION

- S40 P VISITOR PARKING
- S295 P VISITOR PARKING
- S45 P VISITOR PARKING
- S296 P RESERVED  
PARKING
- S506 P VISITOR PARKING  
ONLY
- S507 P VISITOR PARKING  
ONLY
- S509 P VISITOR PARKING  
ONLY
- S508 P VISITOR PARKING  
ONLY
- S297 P VISITOR PARKING  
ONLY
- S510 P VISITOR PARKING  
ONLY
- S511 P VISITOR PARKING  
ONLY
- S512 P VISITOR PARKING  
ONLY
- S513 P VISITOR PARKING  
ONLY
- S442 P VISITOR PARKING  
ONLY

PACIFIC AVE.

SECTION D →

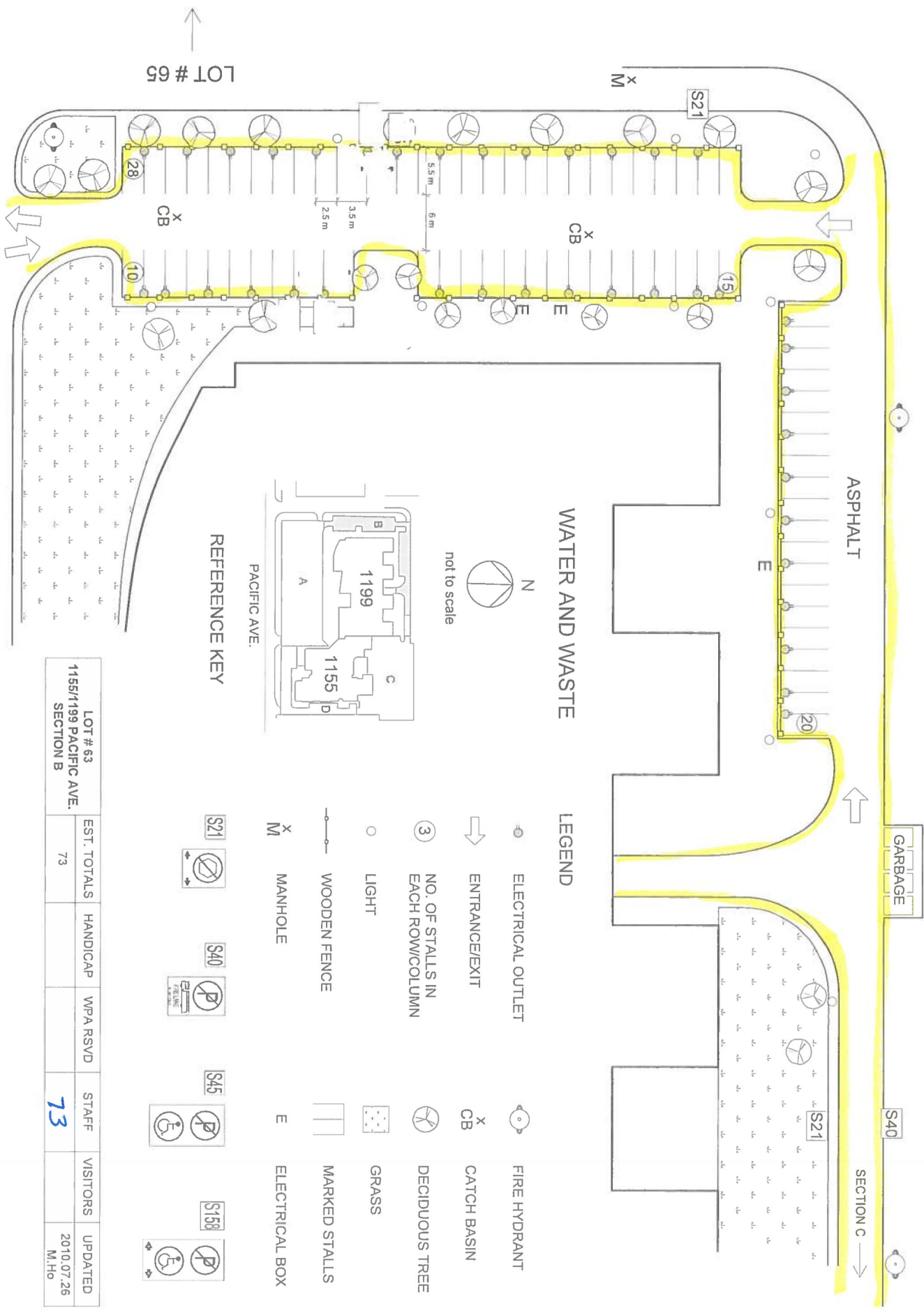

LOT # 63

S21

28

CB

2.5m

3.5m

5.5m

6m

CB

E

E

E

E

E

E

E

E

E

E

E

E

E

E

E

E

E

E

E

E

E

E

E

E

E

E

E

E

E

E

E

E

E

E

E

E

E

E

E

E

E

E

E

E

E

E

E

E

E

E

E

E

E

E

E

E

E

E

E

E

E

E

E

E

E

E

E

E

E

E

E

E

E

E

E

E

E

E

E

E

E

E

E

E

E

E

E

E

E

E

E

E

E

E

E

E

E

E

E

E

E

E

E

E

E

E

E

E

E

E

E

E

E

E

E

E

E

E

E

E

E

E

E

E

E

E

E

E

E

E

E

E

E

E

E

E

E

E

E

E

E

E

E

E

E

E

E

E

E

E

E

E

E

E

E

E

E

E

E

E

E

E

E

E

E

ASPHALT

GARBAGE

S40

SECTION C

S21

S40

S45

S158

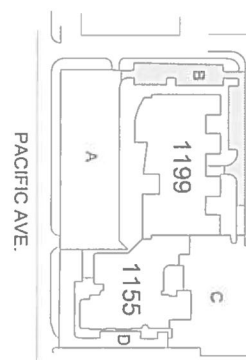

PACIFIC AVE.

REFERENCE KEY



not to scale

WATER AND WASTE

LEGEND

- ELECTRICAL OUTLET
- ENTRANCE/EXIT
- NO. OF STALLS IN EACH ROW/COLUMN
- LIGHT
- WOODEN FENCE
- MANHOLE
- FIRE HYDRANT
- CATCH BASIN
- DECIDUOUS TREE
- GRASS
- MARKED STALLS
- ELECTRICAL BOX

|   |                   |          |          |             |          |                               |
|---|-------------------|----------|----------|-------------|----------|-------------------------------|
| LOT # 63<br>1155/1199 PACIFIC AVE.<br>SECTION B | EST. TOTALS<br>73 | HANDICAP | WPA RSVD | STAFF<br>73 | VISITORS | UPDATED<br>2010.07.26<br>M.Ho |
|---|-------------------|----------|----------|-------------|----------|-------------------------------|



LEGEND

- LIGHT
- FIRE HYDRANT
- DECIDUOUS TREE
- ELECTRICAL OUTLET
- CATCH BASIN
- CONIFEROUS TREE
- ➔ ENTRANCE/EXIT
- E ELECTRICAL BOX
- ▭ MARKED STALLS
- WOODEN FENCE
- GRASS
- ③ NO. OF STALLS IN EACH ROW/COLUMN

S1 CITY OF WINNIPEG  
TELEPHONE 311  
UNAUTHORIZED  
PARKING  
PROHIBITED

S21

S158

S295

S506

VISITOR PARKING ONLY

S507

VISITOR PARKING ONLY

S508

VISITOR PARKING ONLY

S512

VISITOR PARKING PUBLIC WORKS ONLY

S513

ASSIGNED PARKING PUBLIC WORKS ONLY

S515

PLEASE REGISTER AT RECEPTION

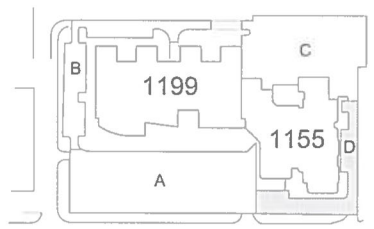

PACIFIC AVE.  
REFERENCE KEY

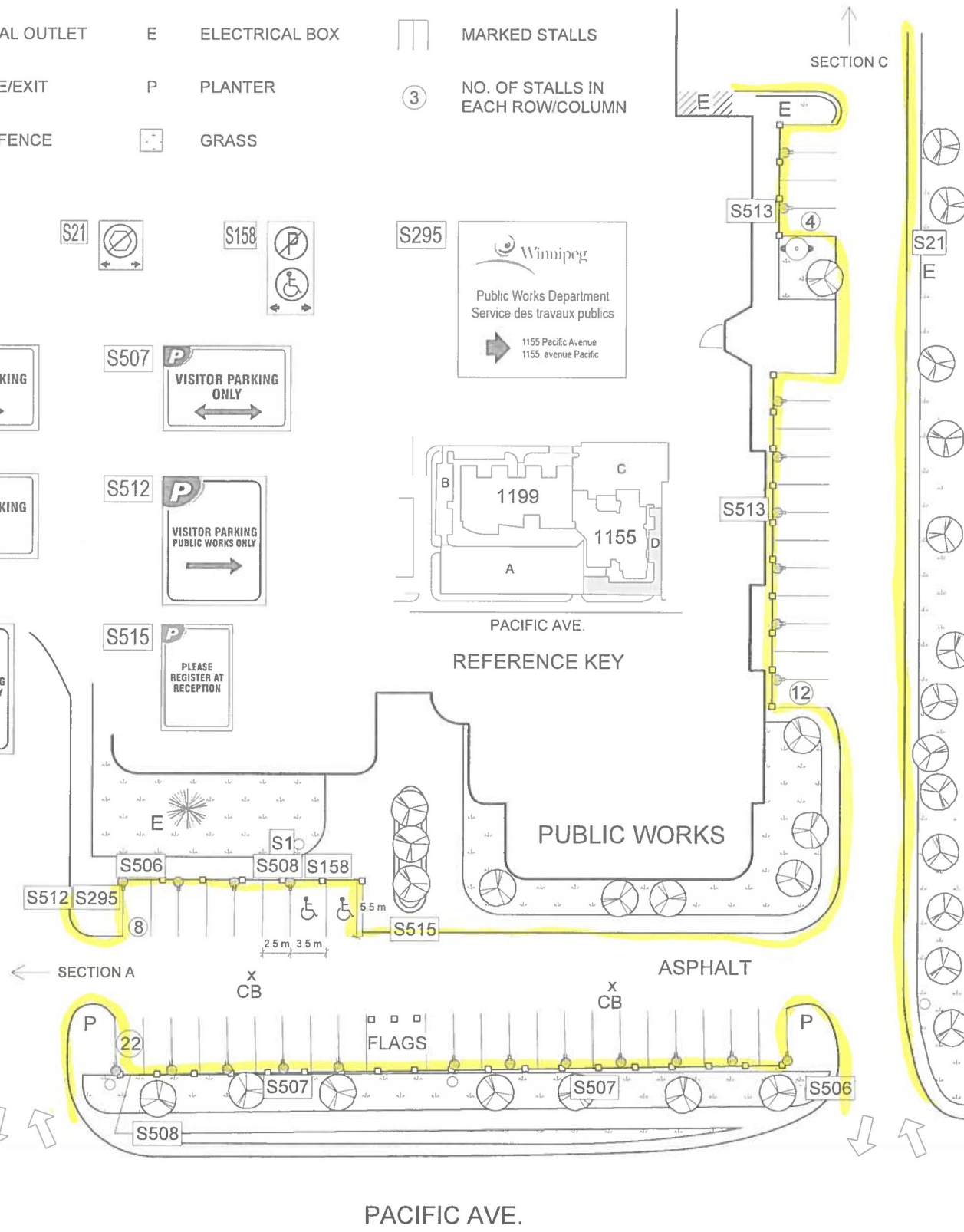

| LOT # 63<br>1155/1199 PACIFIC AVE.<br>SECTION D | EST. TOTALS | HANDICAP | WPA RSVD | STAFF | VISITORS | UPDATED            |
|---|-------------|----------|----------|-------|----------|--------------------|
|   | 46          | 2        |          | 16    | 28       | 2010.07.26<br>M.Ho |

LOT # 63

PACIFIC AVE.

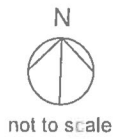
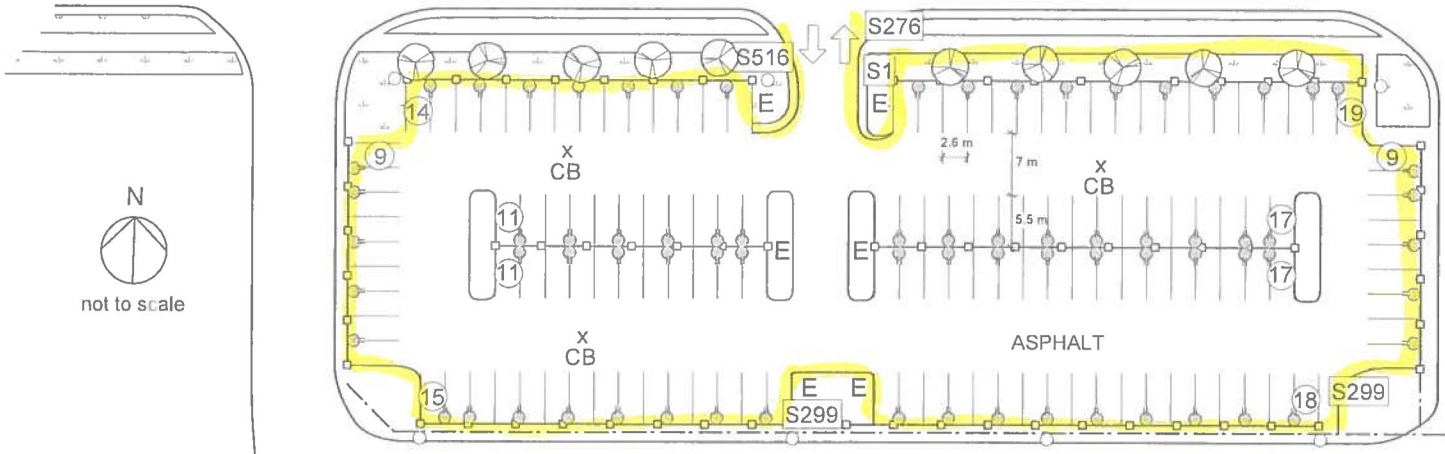

LEGEND

- LIGHT
- E ELECTRICAL BOX
- ⊙ ELECTRICAL OUTLET
- ➡ ENTRANCE/EXIT
- ③ NO. OF STALLS IN EACH ROW/COLUMN
- ⊙ DECIDUOUS TREE
- X CB CATCH BASIN
- WOODEN FENCE
- - - CHAIN LINK FENCE
- ▨ GRASS
- ▭ MARKED STALLS

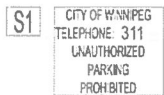

| LOT # 64<br>1220 PACIFIC AVE. | EST. TOTALS | HANDICAP | WPA RSVD | STAFF | VISITORS | UPDATED            |
|-------------------------------|-------------|----------|----------|-------|----------|--------------------|
|                               | 140         |          |          | 140   |          | 2010.06.17<br>M.Ho |



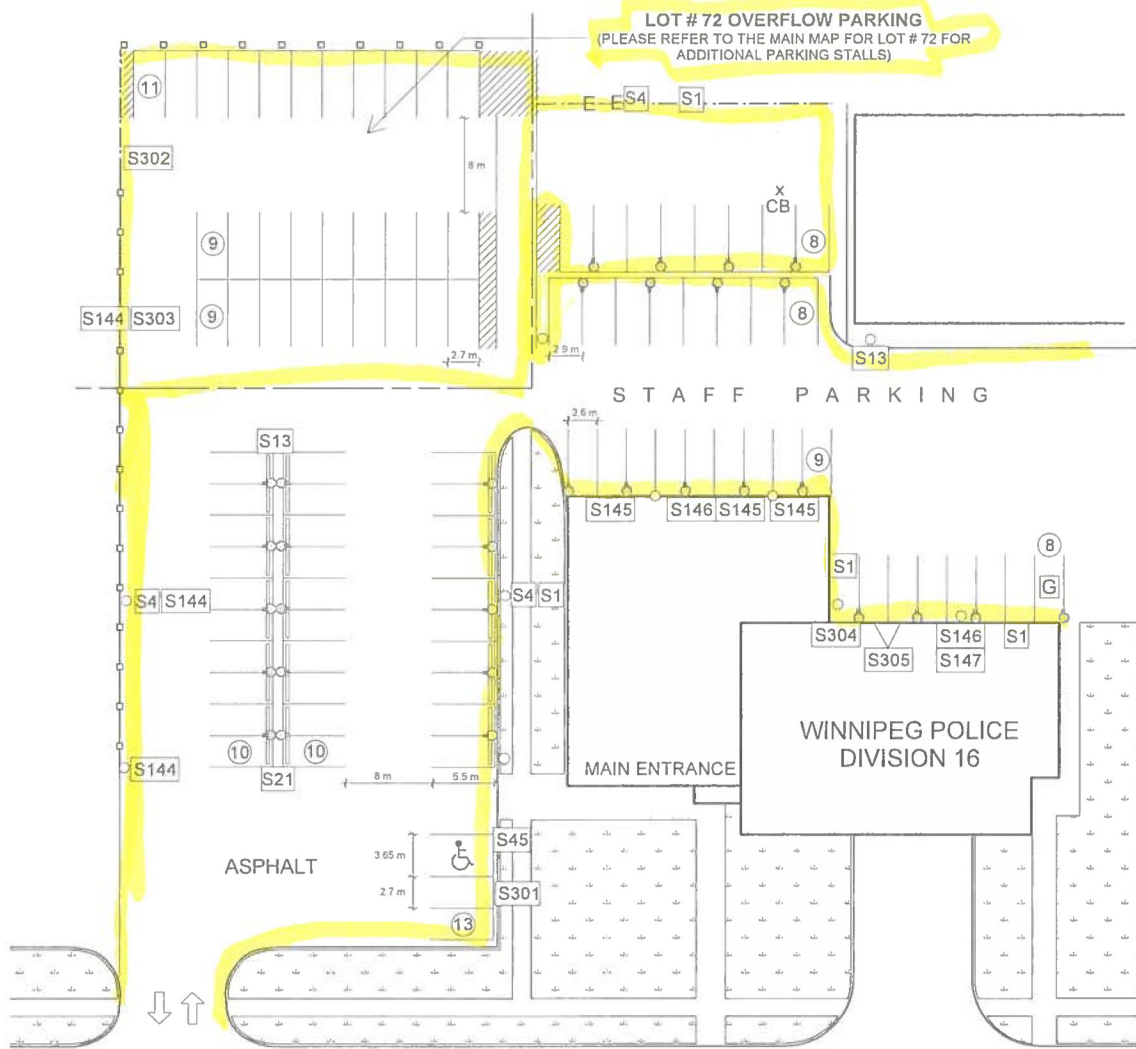

PEMBINA HWY.

LEGEND

- ⊙ ELECTRICAL OUTLET      G GARBAGE      —•— WOODEN FENCE      [ ] GRASS
- ⇨ ENTRANCE/EXIT      E ELECTRICAL BOX      ◻ ◻ WOODEN POSTS      [ ] MARKED STALLS
- ③ NO. OF STALLS IN EACH ROW/COLUMN      X CB CATCH BASIN      — — — CHAIN LINK FENCE      ○ LIGHT

S1 CITY OF WINNIPEG TELEPHONE 311 UNAUTHORIZED PARKING PROHIBITED

S4 PROTECT AS YOUR PARKED VEHICLE. VALUABLES OUT OF SIGHT? ANTI-THEFT DEVICE ON? DOORS LOCKED? UP!

S13 [P] [No Left Turn]

S21 [No Left Turn]

S45 [P] [Handicap]

S144 NO PARKING

S145 POLICE STAFF ONLY

S146 AREA MONITORED BY SURVEILLANCE CAMERA

S147 POLICE PARKING ONLY

S301 CITY OF WINNIPEG POLICE DEPARTMENT CUSTOMER PARKING

S302 THIS AREA RESERVED CITY OF WINNIPEG COMMUNITY SERVICES LIONS POOL & LIBRARY VISITORS PLEASE RECORD YOUR LICENSE PLATE AT THE LIBRARY AND POOL FRONT COUNTERS

S303 [P] LIBRARY OVERFLOW PARKING ALL VEHICLES MUST REGISTER

S304 POLICE ONLY NO PUBLIC ACCESS

S305 CRUISER CARS

| LOT #                         | EST. TOTALS | HANDICAP | WPA RSVD | STAFF | VISITORS | UPDATED            |
|-------------------------------|-------------|----------|----------|-------|----------|--------------------|
| LOT # 71<br>1350 PEMBINA HWY. | 66          | 1        |          | 33    | 32       | 2010.07.26<br>M.Ho |
| LOT # 72<br>1360 PEMBINA HWY. | 29          |          |          |       | 29       | 2010.08.12<br>M.Ho |



not to scale



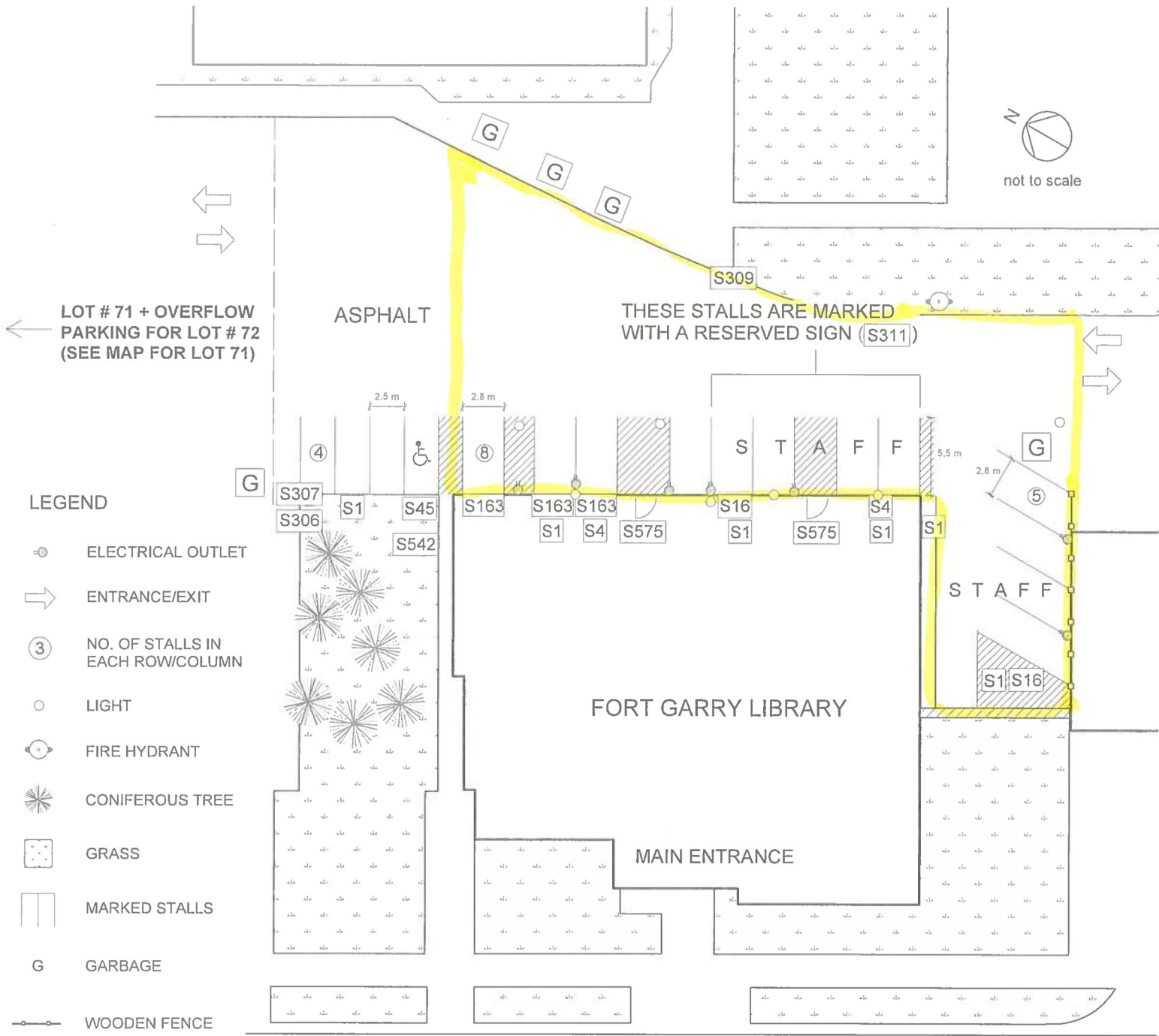

**LEGEND**

- ELECTRICAL OUTLET
- ENTRANCE/EXIT
- NO. OF STALLS IN EACH ROW/COLUMN
- LIGHT
- FIRE HYDRANT
- CONIFEROUS TREE
- GRASS
- MARKED STALLS
- GARBAGE
- WOODEN FENCE

PEMBINA HWY.

**S1**

CITY OF WINNIPEG  
TELEPHONE, 311  
UNAUTHORIZED  
PARKING  
PROHIBITED

**S4**

PROTECTING YOUR  
PARKED VEHICLE  
VALUABLES OUT OF SIGHT?  
ANTI-THEFT DEVICE ON?  
DOORS LOCKED?  
MPI

**S16**

IDLE FREE  
ZONE  
  
HEALTHY  
COMMUNITIES  
DON'T IDLE

**S45**

**S163**

LIBRARY  
VISITOR PARKING

**S306**

LIBRARY  
PATRON  
PARKING  
ONLY

**S307**

CITY OF WINNIPEG  
DISTRICT 6  
POLICE VEHICLE  
PARKING ONLY

**S309**

LOADING  
MON - FRI  
SEPT - JUNE

**S311**

RESERVED  
LIBRARY EMPLOYEES

**S542**

VISITORS  
PLEASE  
REGISTER  
YOUR PLATE  
AT RECEPTION

**S575**

FIRE  
EXIT

| LOT # 72<br>1360 PEMBINA HWY. | EST. TOTALS | HANDICAP | WPA RSVD | STAFF | VISITORS | UPDATED            |
|-------------------------------|-------------|----------|----------|-------|----------|--------------------|
|                               | 17          | 1        |          | 9     | 7        | 2010.07.06<br>M.Ho |

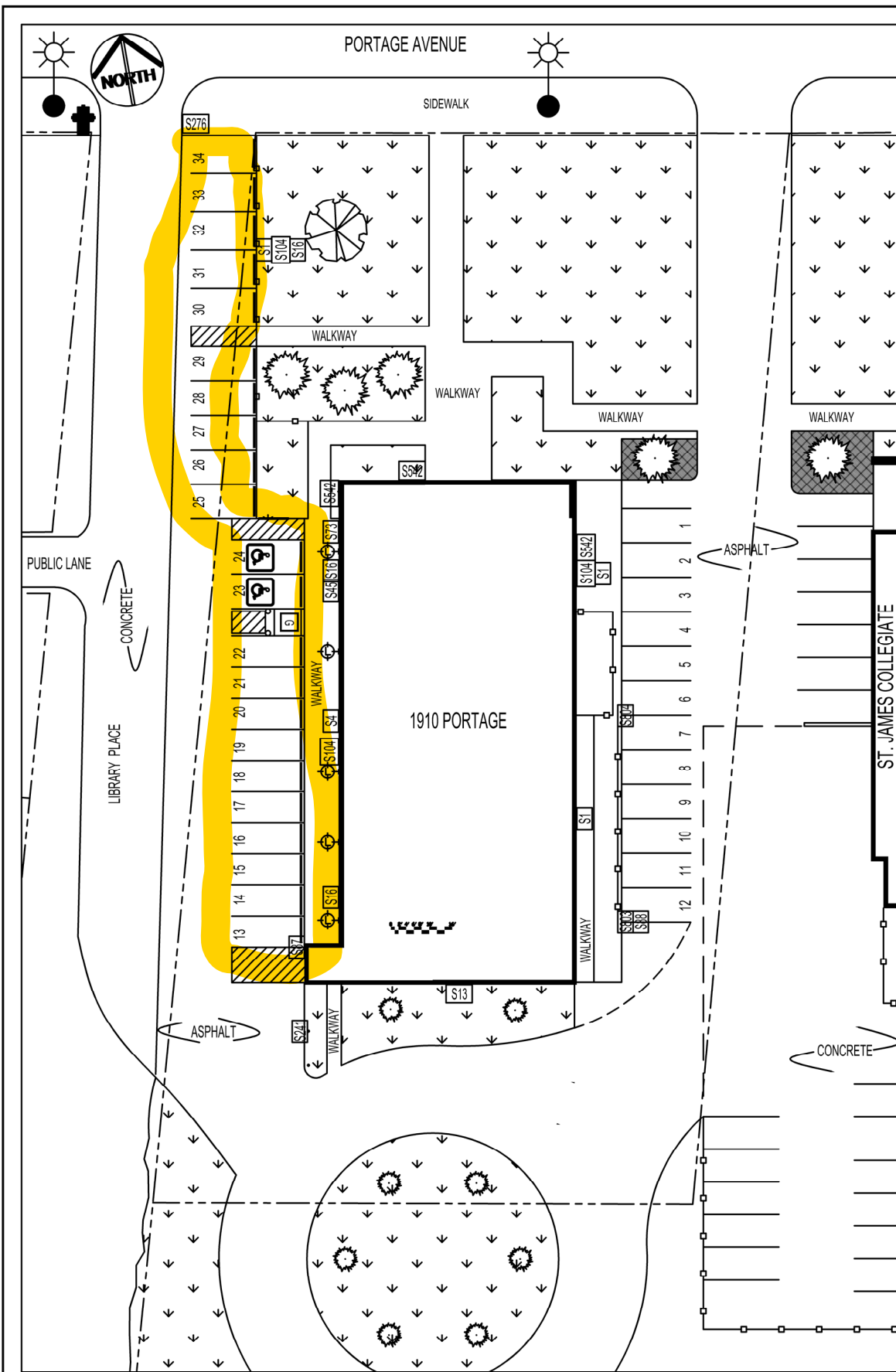

| LEGEND |               |
|--------|---------------|
|        | STREET LIGHT  |
|        | FIRE HYDRANT  |
|        | PARKING LIGHT |
|        | GARBAGE       |

**S1** CITY OF WINNIPEG  
PHONE: 311  
**UNAUTHORIZED  
PARKING  
PROHIBITED**

**S4** PROTECTING YOUR  
PARKED VEHICLE  
VALUABLES OUT OF SIGHT?  
ANTI-THEFT DEVICE ON?  
DOORS LOCKED?  
MPI

**S13**

**S16** IDLE FREE  
ZONE  
  
HEALTHY COMMUNITIES  
DON'T IDLE

**S45**

**S73**

**S87**

**S88**

**S104** LIBRARY  
VISITOR PARKING  
ONLY

**S241**

**S542**

**S276** STOP

**S470** LIBRARY STAFF  
PARKING  
ONLY

**S803**

**S804**

| No:          | REVISION/DESCRIPTION   | BY      | DATE         |
|--------------|--|---------|--------------|
| 1            | UPDATED ENTIRE LOT TO INCLUDE THE NEW BUS LOOP, ADDED THE NEW STALLS AND SIGNS | P.D     | SEP 25, 2015 |
| TOTAL STALLS | STAFF  | VISITOR | ACCESS.      |
| 34           | 6  | 26      | 2            |

THE CITY OF WINNIPEG  
PLANNING, PROPERTY AND DEVELOPMENT  
DEPARTMENT MUNICIPAL ACCOMMODATIONS DIVISION  
3-65 GARRY STREET

ST. JAMES LIBRARY  
ENLARGE SITE PLAN  
WPA LOT#76  
1910 PORTAGE AVENUE

DRAWN: PDT APPROVED: SCALE: N.T.S DATE: SEP 25, 2018 PROJECT: 2016-105 MAXIMO: LB-08, SP-82 DRAWING: C1

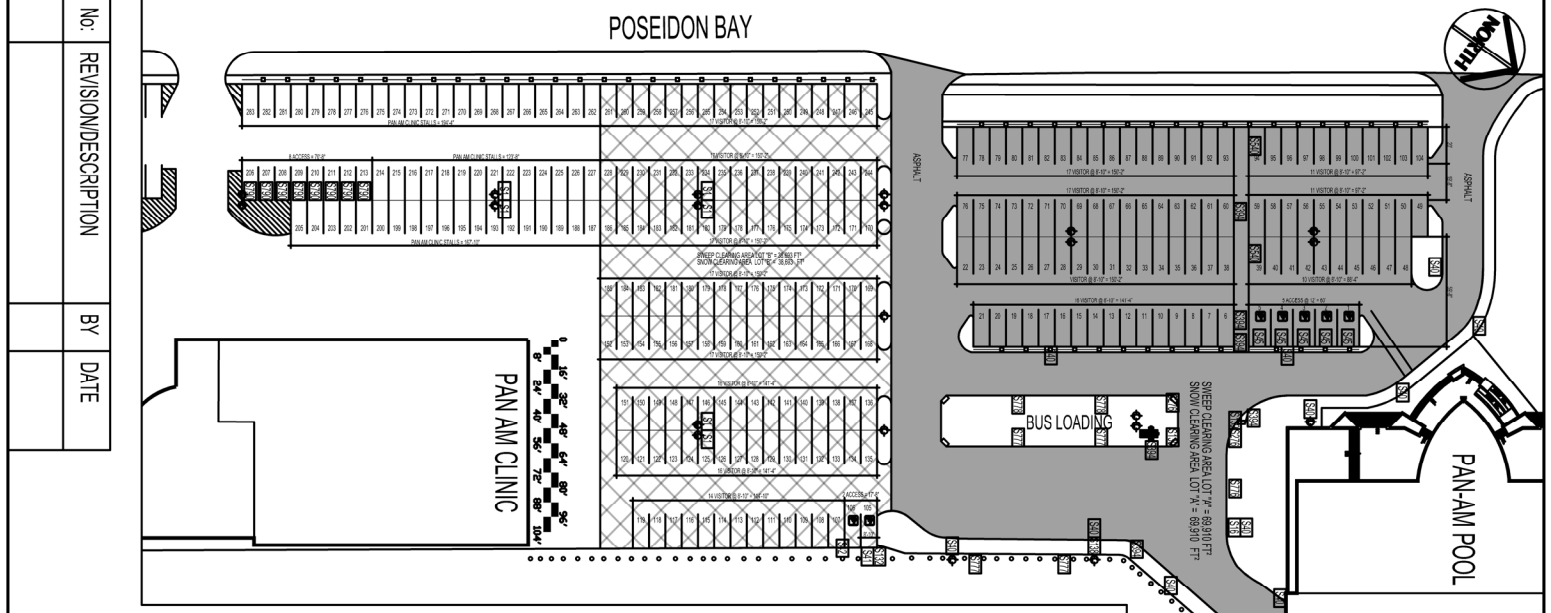

| TOTAL STALLS "A" | VISITOR | STAFF | WPA | RSVD | MARKED | UNMARKED | ACCESSIBILITY |
|------------------|---------|-------|-----|------|--------|----------|---------------|
| 126              | 101     | 0     | 6   | 0    | 0      | 9        |               |
| TOTAL STALLS "B" | VISITOR | STAFF | WPA | RSVD | MARKED | UNMARKED | ACCESSIBILITY |
| 132              | 0       | 0     | 0   | 0    | 0      | 2        |               |

SWEEP CLEARING AREA LOT "A" = 89,910 FT<sup>2</sup>  
SNOW CLEARING AREA LOT "A" = 89,910 FT<sup>2</sup>  
SWEEP CLEARING AREA LOT "B" = 38,693 FT<sup>2</sup>  
SNOW CLEARING AREA LOT "B" = 38,693 FT<sup>2</sup>

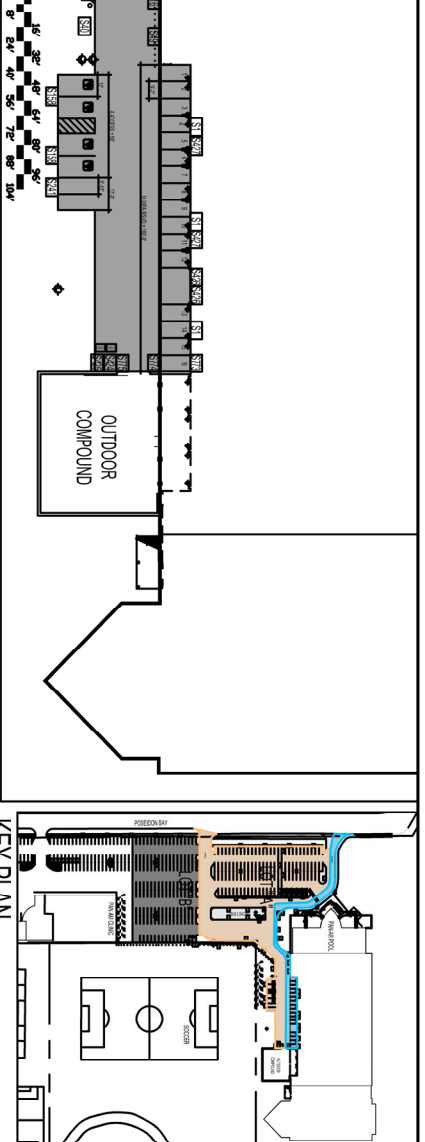
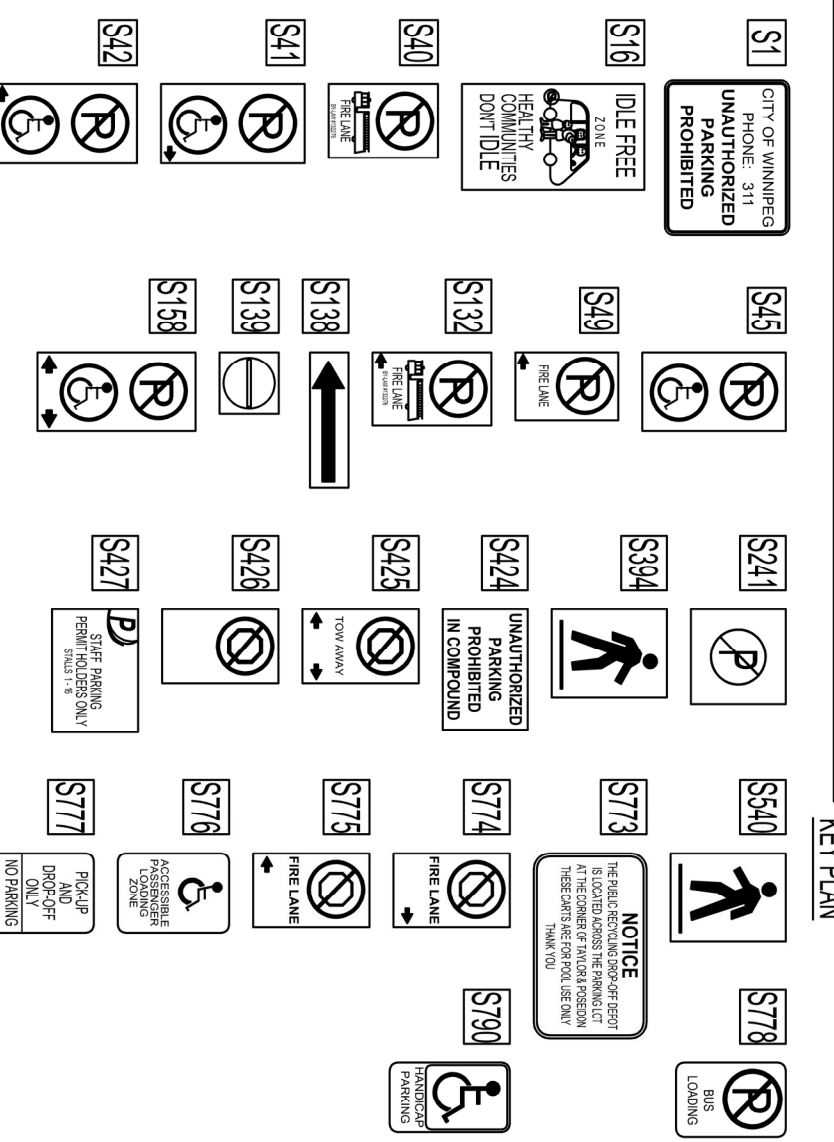

|                          |    |      |
|--------------------------|----|------|
| NO: REVISION/DESCRIPTION | BY | DATE |
|                          |    |      |

THE CITY OF WINNIPEG  
PLANNING, PROPERTY AND DEVELOPMENT  
DEPARTMENT MUNICIPAL ACCOMMODATIONS DIVISION  
3-65 GARRY STREET  
WINNIPEG, S4S 0G7  
DRAWN: DTA  
APPROVED: [Signature]  
SCALE: N.T.S.  
DATE: 2017.02.03  
PROJECT: 2016-106  
MAXIMUM: P1-13 to -17, SP-85  
DRAWING: C2

| Symbol | Description           |
|--------|-----------------------|
| ⊕      | WATER VALVE           |
| ⊙      | MANHOLE               |
| ⊚      | CATCH BASIN           |
| ⊛      | WATER METER W/VALVE   |
| ⊜      | FIRE HYDRANT          |
| ⊝      | GAS METER             |
| ⊞      | GAS VALVE W/ SHUT-OFF |
| ⊟      | HYDRO PILE W/LIGHT    |
| ⊠      | STREET/PROPERTY LIGHT |
| ⊡      | LIGHT                 |
| ⊢      | DUPLEX RECEPTACLE     |
| ⊣      | HYDRO PILE            |
| ⊤      | ELECTRICITY METER     |
| ⊥      | ELECTRICITY PANEL     |
| ⊦      | PARKING FENCE         |
| ⊧      | TREE                  |
| ⊨      | GRASS                 |

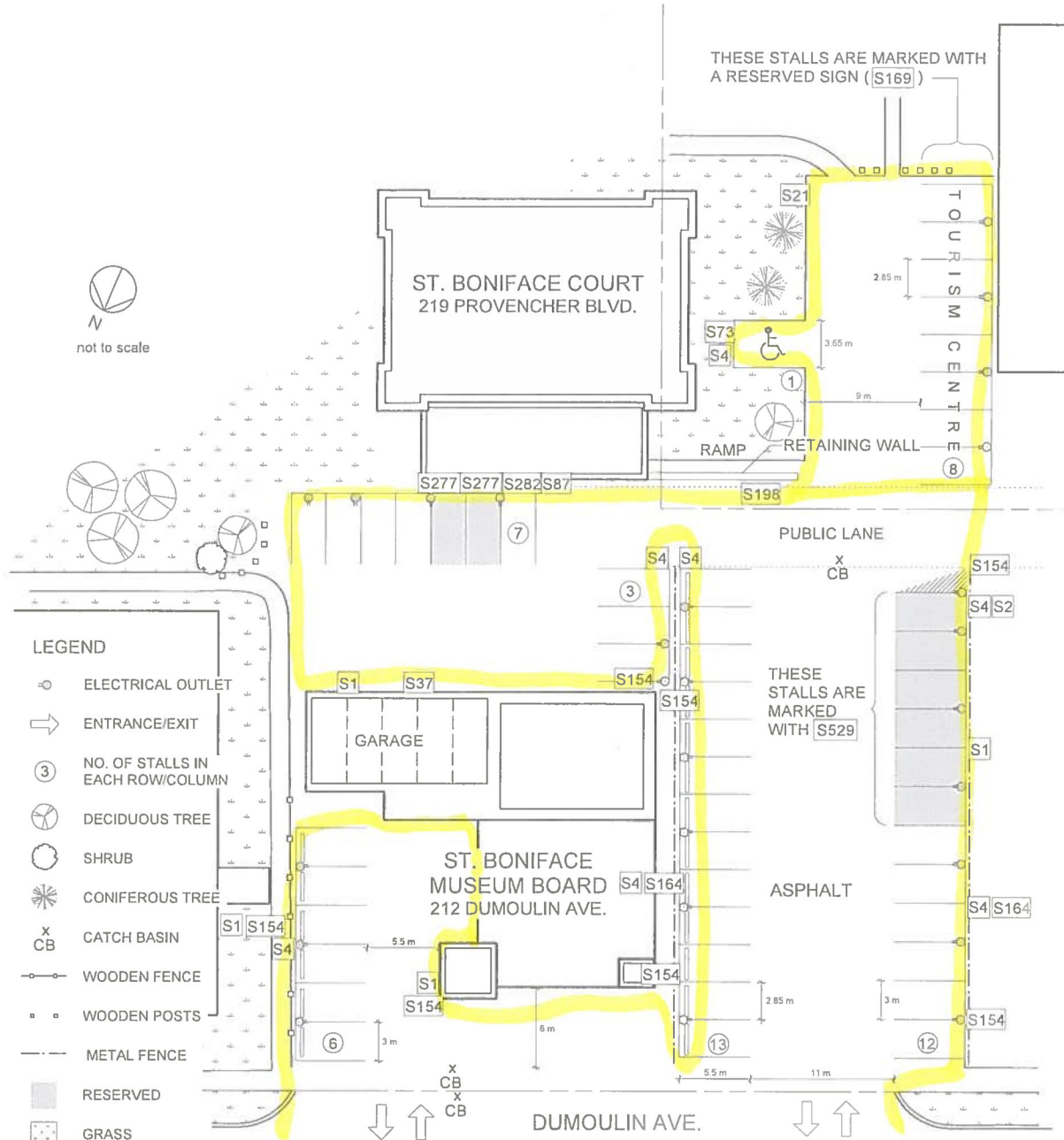

**LEGEND**

- ELECTRICAL OUTLET
- ENTRANCE/EXIT
- NO. OF STALLS IN EACH ROW/COLUMN
- DECIDUOUS TREE
- SHRUB
- CONIFEROUS TREE
- CATCH BASIN
- WOODEN FENCE
- WOODEN POSTS
- METAL FENCE
- RESERVED
- GRASS
- MARKED STALLS

S1 CITY OF WINNIPEG TELEPHONE 311 UNAUTHORIZED PARKING PROHIBITED

S2 USE PARKING SPACES RESERVED BY THE TRUCK PARKING ACTIVITY 311

S4 PROTECTING YOUR PARKED VEHICLE VALUABLES OUT OF SIGHT? ANTI-THEFT DEVICE ON! DOORS LOCKED? 311

S21

S37 CITY OF WINNIPEG NO PARKING

S73

S87

S154 VILLE DE WINNIPEG 311 PROPRIÉTÉ PRIVÉE STATIONNEMENT INTERDIT SANS AUTORISATION

S164 ARRÊTEZ LE MOTEUR LES CELLULES NE S'ARRÊTENT PAS AUTOMATIQUÉMENT

S169 RESERVED - 24 HOURS

S198 CITY OF WINNIPEG TELEPHONE (988-2219) NO PARKING

S277 This stall is already RESERVED 6 AM - 9 PM 7 days a week. Visitez votre site sur 311

S282 SMALL CAR ONLY

S529 MSBA 24 Hour Reserved

| LOT #                            | EST. TOTALS | HANDICAP | WPA RSVD | STAFF | VISITORS | UPDATED            |
|----------------------------------|-------------|----------|----------|-------|----------|--------------------|
| LOT # 83<br>219 PROVENCHER BLVD. | 9           | 1        |          | 8     |          | 2010.08.05<br>M.Ho |
| LOT # 84<br>212 DUMOULIN AVE.    | 41          |          | 8        | 14    | 19       | 2010.07.28<br>M.Ho |

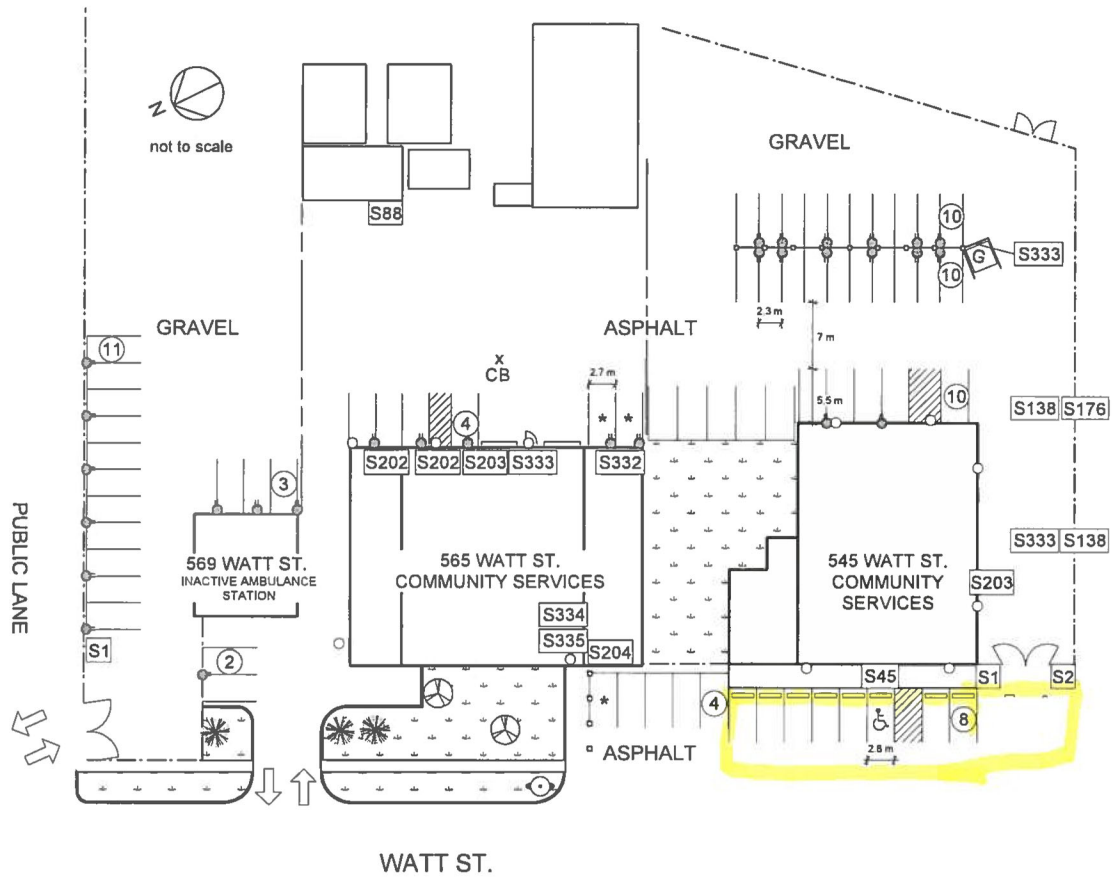

**LEGEND**

- ELECTRICAL OUTLET
- ENTRANCE/EXIT
- NO. OF STALLS IN EACH ROW/COLUMN
- LIGHT

- FIRE HYDRANT
- CATCH BASIN
- DECIDUOUS TREE
- CONIFEROUS TREE
- GRASS

- CHAIN LINK FENCE
- WOODEN FENCE
- WOODEN POSTS
- MARKED STALLS
- GARBAGE

| LOT #                             | EST. TOTALS | HANDICAP | WPA RSVD | STAFF | VISITORS | UPDATED            |
|-----------------------------------|-------------|----------|----------|-------|----------|--------------------|
| <b>LOT # 102<br/>545 WATT ST.</b> | 38          | 1        |          | 30    | 7        | 2010.07.28<br>M.Ho |
| <b>LOT # 103<br/>565 WATT ST.</b> | 8           |          |          | 4     | 4        | 2010.06.30<br>M.Ho |
| <b>LOT # 104<br/>569 WATT ST.</b> | 15          |          |          | 14    | 2        | 2010.06.30<br>M.Ho |

\* 3 STALLS ARE FOR FOREMEN (NOT INCLUDED IN STALL COUNT)

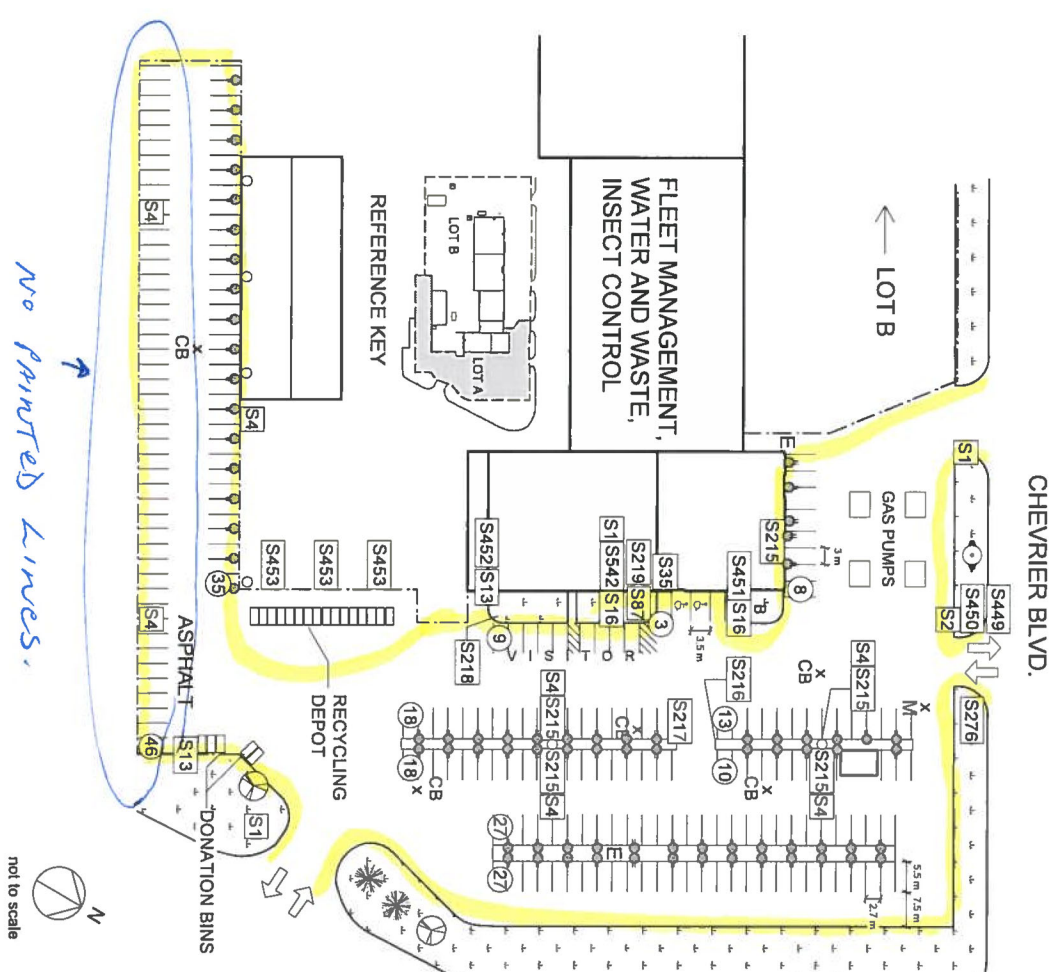

CHEVRIER BLVD.

WAVERLEY ST.

LEGEND

- ELECTRICAL OUTLET
- ⇨ ENTRANCE/EXIT
- ③ NO. OF STALLS IN EACH ROW/COLUMN
- LIGHT
- CHAIN LINK FENCE
- X CB CATCH BASIN
- CONIFEROUS TREE
- FIRE HYDRANT
- GRASS
- ▭ MARKED STALLS
- B BIKE RACK
- E ELECTRICAL BOX
- X M MANHOLE

- S4 PROTECTIVE TOUR VEHICLE (WHEELS COVERED, SEAT BELT DOORS LOCKED) LIFT
- S13 KID FREE ZONE (NO SMOKING, NO ALCOHOL, NO DRUGS, NO WEAPONS, NO GAMING, NO LOUDEST MUSIC, NO BICYCLES, NO SKATEBOARDS, NO SCOOTERS)
- S16 KID FREE ZONE (NO SMOKING, NO ALCOHOL, NO DRUGS, NO WEAPONS, NO GAMING, NO LOUDEST MUSIC, NO BICYCLES, NO SKATEBOARDS, NO SCOOTERS)
- S35 KID FREE ZONE (NO SMOKING, NO ALCOHOL, NO DRUGS, NO WEAPONS, NO GAMING, NO LOUDEST MUSIC, NO BICYCLES, NO SKATEBOARDS, NO SCOOTERS)
- S87 KID FREE ZONE (NO SMOKING, NO ALCOHOL, NO DRUGS, NO WEAPONS, NO GAMING, NO LOUDEST MUSIC, NO BICYCLES, NO SKATEBOARDS, NO SCOOTERS)
- S215 AUTHORIZED EMPLOYEE PARKING ONLY
- S449 THREE HOUR 1.0 km/h

- S450 RECYCLING CENTRE
- S451 PUBLIC ENQUIRIES + COMPLAINTS + MAKE OUT-PARK CENTRE (FOR THE PUBLIC) (FOR THE PUBLIC) (FOR THE PUBLIC)
- S452 (USE OF) USE OF BUILDING
- S453 NO DUMPING (DO NOT DUMP ANY WASTE OR DEBRIS IN THIS AREA)
- S442 VISITORS PLEASE REGISTER AT RECEPTION

| LOT # 105<br>1539 WAVERLEY ST.<br>(LOT A) | EST. TOTALS | HANDICAP | WPA RSV'D | STAFF | VISITORS | UPDATED            |
|---|-------------|----------|-----------|-------|----------|--------------------|
|   | 214         | 2        |           | 202   | 10       | 2010.07.27<br>M.Ho |

No Painted Lines.



WILLIAM AVE.

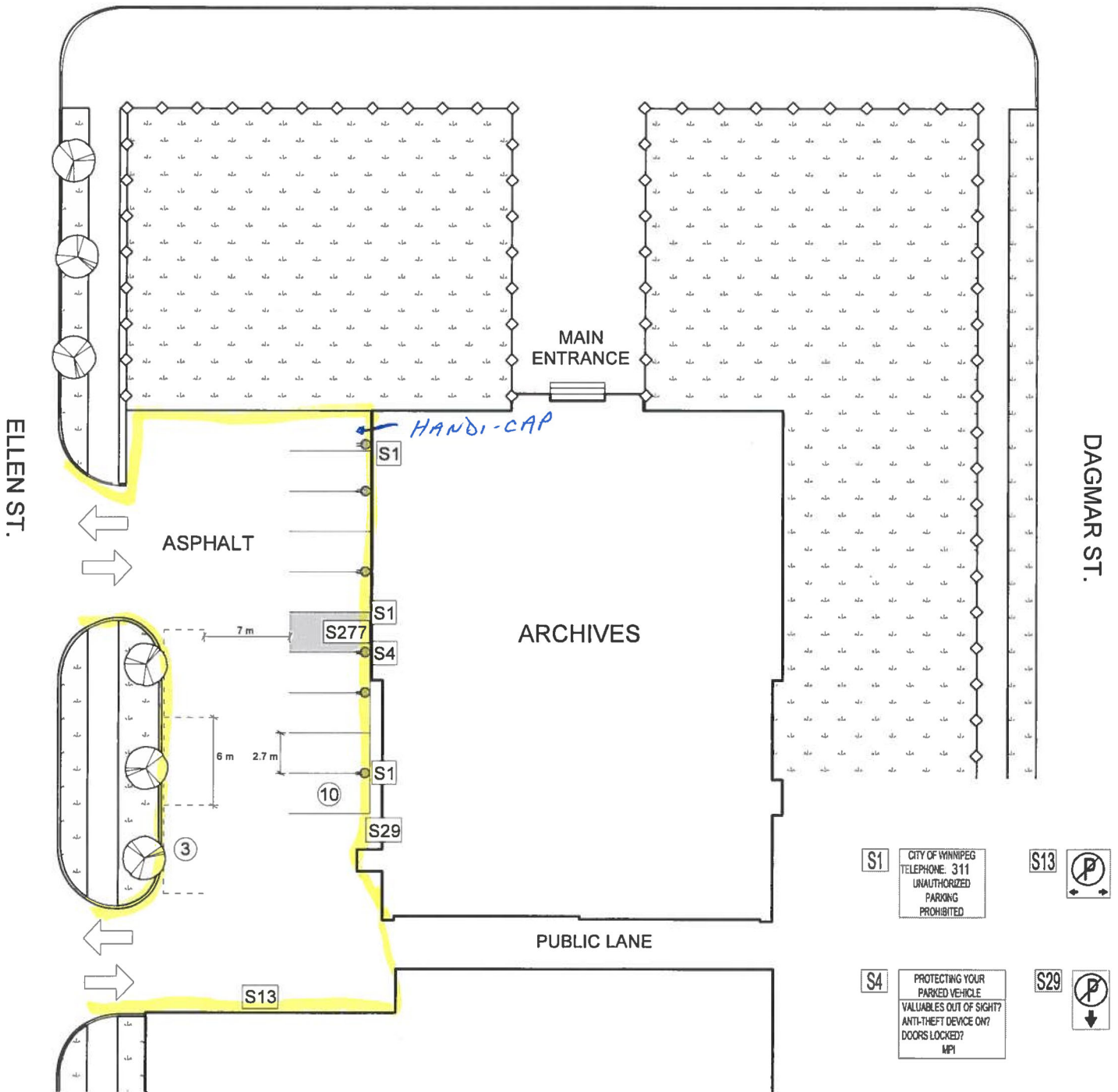

LEGEND

- ELECTRICAL OUTLET
- WROUGHT IRON FENCE
- UNMARKED STALLS
- ENTRANCE/EXIT
- NO. OF STALLS IN EACH ROW/COLUMN
- MARKED STALLS
- DECIDUOUS TREE
- GRASS
- RESERVED

**S1** CITY OF WINNIPEG  
TELEPHONE: 311  
UNAUTHORIZED  
PARKING  
PROHIBITED

**S13**

**S4** PROTECTING YOUR  
PARKED VEHICLE  
VALUABLES OUT OF SIGHT?  
ANTI-THEFT DEVICE ON?  
DOORS LOCKED?  
MPI

**S29**

**S277**

This stall absolutely  
**RESERVED**  
6 AM - 6 PM  
Weekdays Only  
Visitors welcome  
at all other times.

| LOT # 108 - 380 WILLIAM AVE. | EST. TOTALS | HANDICAP | WPA RSVD | STAFF | VISITORS | UPDATED            |
|------------------------------|-------------|----------|----------|-------|----------|--------------------|
| MARKED                       | 10          |          | 1        | 9     |          | 2010.07.27<br>M.Ho |
| UNMARKED                     | 3           |          |          | 3     |          |                    |



not to scale

LEGEND

- LIGHT
- GRASS
- x CB CATCH BASIN
- ◻ MARKED STALLS
- ◻ UNMARKED STALLS
- ➔ ENTRANCE/EXIT
- FIRE HYDRANT
- ③ NO. OF STALLS IN EACH ROW/COLUMN
- CHAIN-LINK FENCE
- B BIKE RACK
- E ELECTRICAL BOX
- G GARBAGE
- ☀ CONIFEROUS TREE
- ☼ DECIDUOUS TREE
- Ⓜ PAY STATIONS & NO. #1111

NOTE:

THE UNMARKED STALLS INDICATED HERE ARE CURRENTLY UNAVAILABLE FOR PARKING.

HOWEVER, THEY SERVE AS POTENTIAL PARKING IN THE FUTURE IF AND WHEN THE TRAILERS ARE MOVED ELSEWHERE.

S1 CITY OF WINNIPEG TELEPHONE 311 UNAUTHORIZED PARKING PROHIBITED

S4 PROTECTING YOUR PARKED VEHICLE VALUABLES OUT OF SIGHT? ANTI-THEFT DEVICE ON? DOORS LOCKED? MP1

S13

S131 S45

S272 **The Forks** OVERFLOW CUSTOMER PARKING While Visiting at The Forks 3 Hour Maximum Limit 7 Days a Week 24/7 UNAUTHORIZED PARKING PROHIBITED

S276 STOP

S273 **P** Winnipeg Parking Authority LOT # (number) (name) PERMIT OR PAYMENT REQUIRED 24 HOURS METER: 6AM - 6PM \$1.00 PER 1 HR(S) DAILY: 6AM - 6PM \$8.00 DAILY MAX EVENINGS: 6PM - 6 AM \$1.00 PER HR / \$8.00 MAX To purchase a monthly permit please contact the Winnipeg Parking Authority Please purchase Hourly Permit from the machine and display face up on your vehicle dash

S274 **P** Winnipeg Parking Authority LOT # (number) (name) PUBLIC PARKING 24 HOURS Please purchase Hourly Permit from the machine and display face up on your vehicle dash

| LOT # 117 - 106 WATER AVE. | EST. TOTALS | HANDICAP | WPA RSVD | STAFF | VISITORS | UPDATED    |
|----------------------------|-------------|----------|----------|-------|----------|------------|
| MARKED                     | 580         | 3        |          |       | 577      | 2010.08.05 |
| UNMARKED                   | 11          |          |          |       | 11       | M.Ho       |





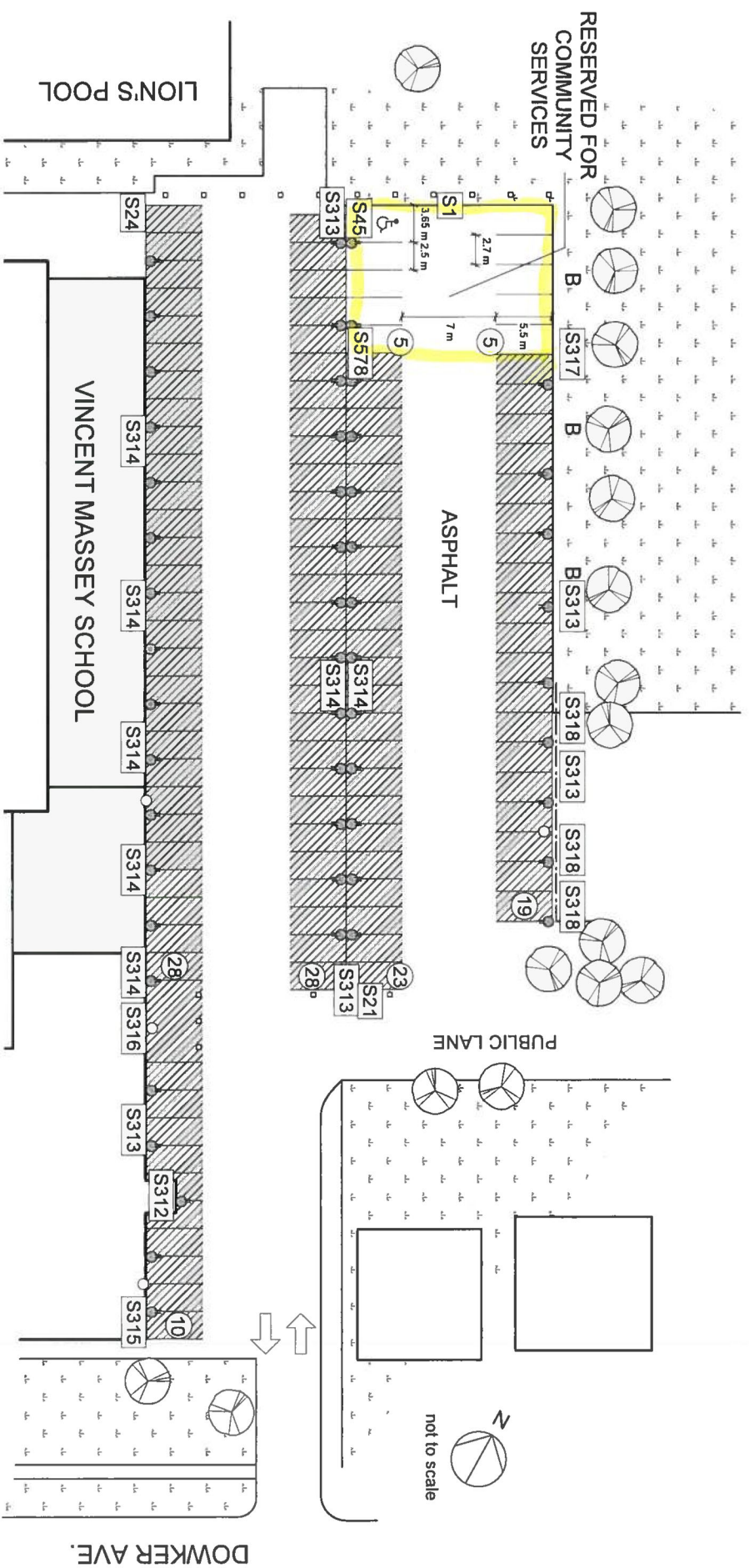

**LEGEND**

- ELECTRICAL OUTLET
- ENTRANCE/EXIT
- LIGHT
- NO. OF STALLS IN EACH ROW/COLUMN
- DECIDUOUS TREE
- MARKED STALLS
- BASKETBALL HOOP
- CHAIN LINK FENCE
- WOODEN POSTS
- CURRENTLY NOT MANAGED BY WPA
- GRASS

- S1 CITY OF WINNIPEG TELEPHONE 311 UNAUTHORIZED PARKING PROHIBITED
- S21
- S24 START/PARK ONLY
- S45
- S312 STAFF PARKING ONLY TOW AWAY ENFORCED
- S313 RESERVED PARKING
- S314 RESERVED PARKING
- S315 RESERVED PARKING
- S317 RESERVED PARKING
- S318 RESERVED PARKING
- S319 RESERVED PARKING
- S321
- S324
- S332
- S335
- S336
- S337
- S338
- S339
- S340
- S341
- S342
- S343
- S344
- S345
- S346
- S347
- S348
- S349
- S350
- S351
- S352
- S353
- S354
- S355
- S356
- S357
- S358
- S359
- S360
- S361
- S362
- S363
- S364
- S365
- S366
- S367
- S368
- S369
- S370
- S371
- S372
- S373
- S374
- S375
- S376
- S377
- S378
- S379
- S380
- S381
- S382
- S383
- S384
- S385
- S386
- S387
- S388
- S389
- S390
- S391
- S392
- S393
- S394
- S395
- S396
- S397
- S398
- S399
- S400

**NO TRESPASSING**  
 Between 10 PM & 6 AM  
 Public School Act 231 (2) (B)  
 Pembina Trails School Division  
 By-Law No.20

Pembina Trails School Division  
**UNAUTHORIZED PARKING PROHIBITED DURING NORMAL SCHOOL HOURS**  
 VISITORS PLEASE REPORT TO THE WPA OFFICE

COMMUNITY SERVICES  
**VISITOR PARKING**  
 ALL VISITORS MUST REPORT TO THE WPA OFFICE

| LOT # 122<br>969 DOWKER AVE. | EST. TOTALS | HANDICAP | WPA RSVD | STAFF | VISITORS | UPDATED         |
|------------------------------|-------------|----------|----------|-------|----------|-----------------|
|                              | 10          | 1        |          | 5     | 4        | 2010.07.27 M.Ho |

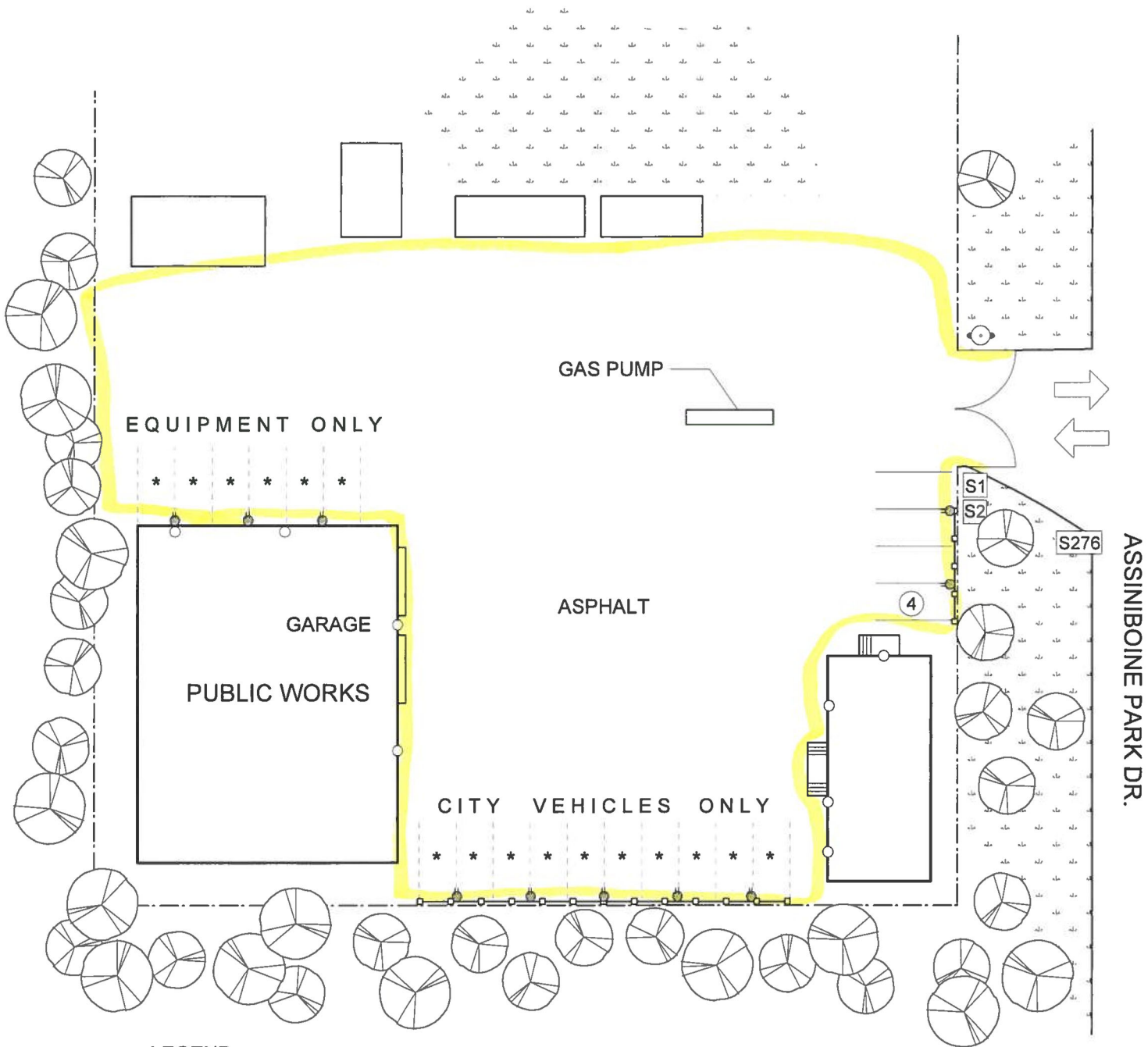

**LEGEND**

-  ELECTRICAL OUTLET
-  ENTRANCE/EXIT
-  NO. OF STALLS IN EACH ROW/COLUMN
-  LIGHT
-  CHAIN LINK FENCE
-  MARKED STALLS
-  WOODEN FENCE
-  FIRE HYDRANT
-  DECIDUOUS TREE
-  GRASS
-  CITY OF WINNIPEG TELEPHONE: 311 UNAUTHORIZED PARKING PROHIBITED
-  THIS PROPERTY IS MONITORED BY THE WINNIPEG PARKING AUTHORITY 311
-  S276
-  STOP

| LOT # 123<br>735 ASSINIBOINE PARK DR. | EST. TOTALS | HANDICAP | WPA RSVD | STAFF | VISITORS | UPDATED            |
|---------------------------------------|-------------|----------|----------|-------|----------|--------------------|
|                                       | 4           |          |          | 4     |          | 2010.07.27<br>M.Ho |

\* 16 STALLS FOR EQUIPMENT AND CITY VEHICLES (NOT INCLUDED IN STALL COUNT)



not to scale

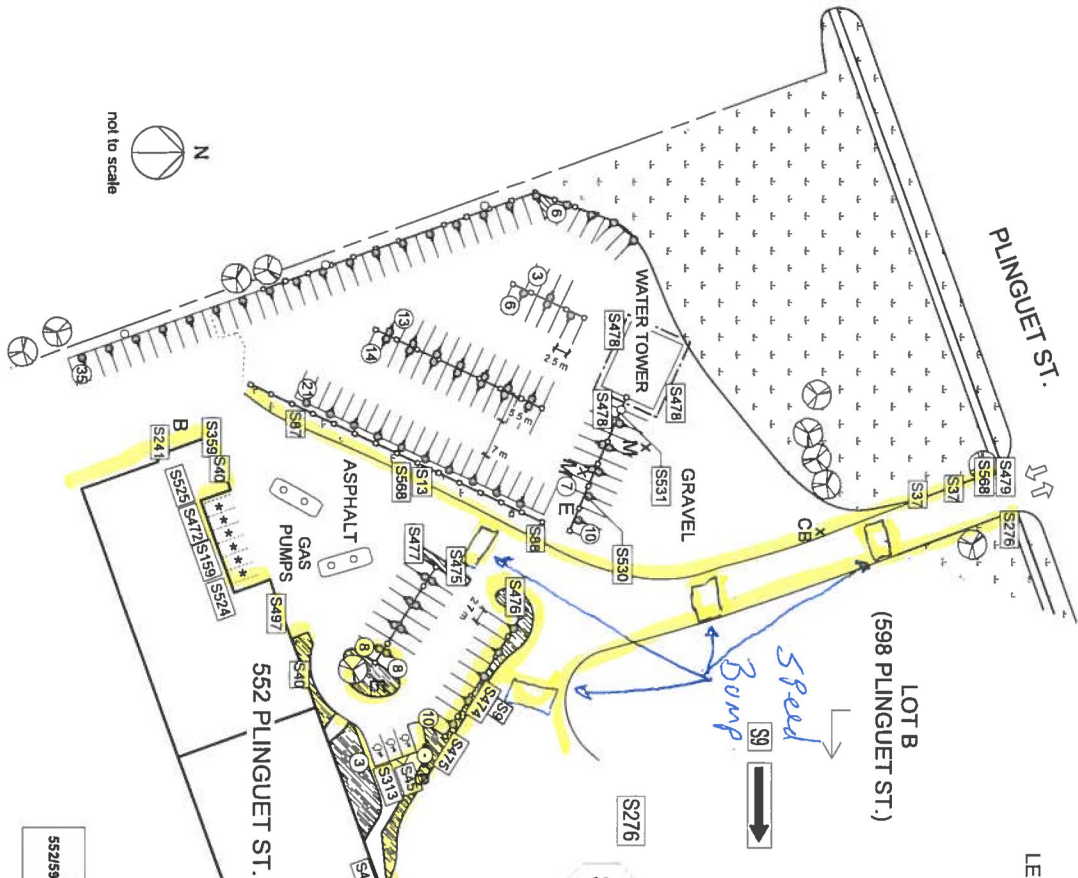

**LEGEND**

- ELECTRICAL OUTLET
- ⇨ ENTRANCE/EXIT
- ③ NO. OF STALLS IN EACH ROW/COLUMN
- LIGHT
- CHAIN LINK FENCE
- WOODEN FENCE
- FIRE HYDRANT
- X MANHOLE
- ⊗ DECIDUOUS TREE
- ▨ SHRUBS/PLANTERS
- ▨ GRASS
- X CB CATCH BASIN
- ▨ MARKED STALLS
- G GARBAGE
- B BIKE RACK
- E ELECTRICAL BOX

| LOT # 124<br>552598 PLINGUET ST.<br>(LOT A) | EST. TOTALS | HANDICAP | WPA RSVD | STAFF | VISITORS | UPDATED            |
|---|-------------|----------|----------|-------|----------|--------------------|
|   | 144         | 3        |          | 129   | 12       | 2010.07.29<br>M.Ho |

\* 6 STALLS FOR SUPERINTENDENT AND EMERGENCY PERSONNEL. (NOT INCLUDED IN STALL COUNT)

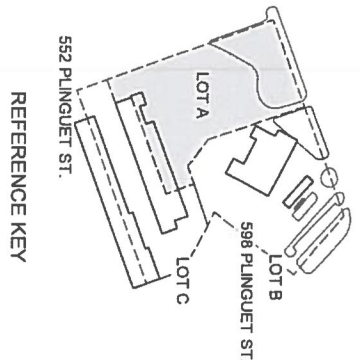

**REFERENCE KEY**

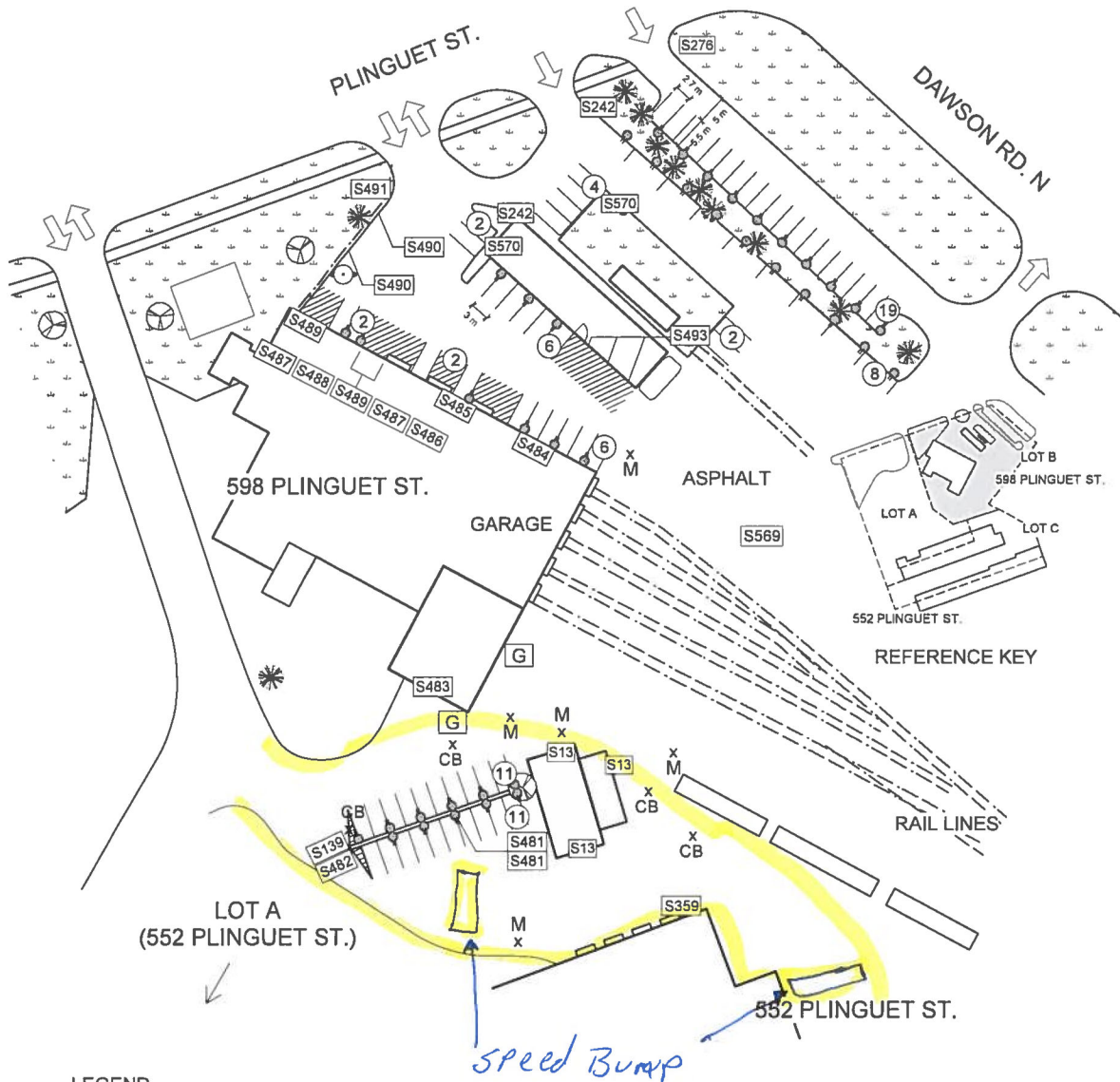

**LEGEND**

- ⦿ ELECTRICAL OUTLET
- ➔ ENTRANCE/EXIT
- ③ NO. OF STALLS IN EACH ROW/COLUMN
- LIGHT
- ⦿ FIRE HYDRANT
- ⊙ DECIDUOUS TREE
- ⊙ CONIFEROUS TREE
- ⊙ GRASS
- ▭ MARKED STALLS
- CHAIN LINK FENCE
- G GARBAGE
- x M MANHOLE
- x CB CATCH BASIN

S13 S139 S242 S276 S359 S481 S482   
 S483 S484 S485 S486 S487 S488   
 S489 S490 S491 S493 S569 S570



| LOT # 124<br>552/598 PLINGUET ST.<br>(LOT B) | EST. TOTALS | HANDICAP | WPA RSVD | STAFF | VISITORS | UPDATED            |
|--|-------------|----------|----------|-------|----------|--------------------|
|  | 73          |          |          | 67    | 6        | 2010.07.29<br>M.Ho |

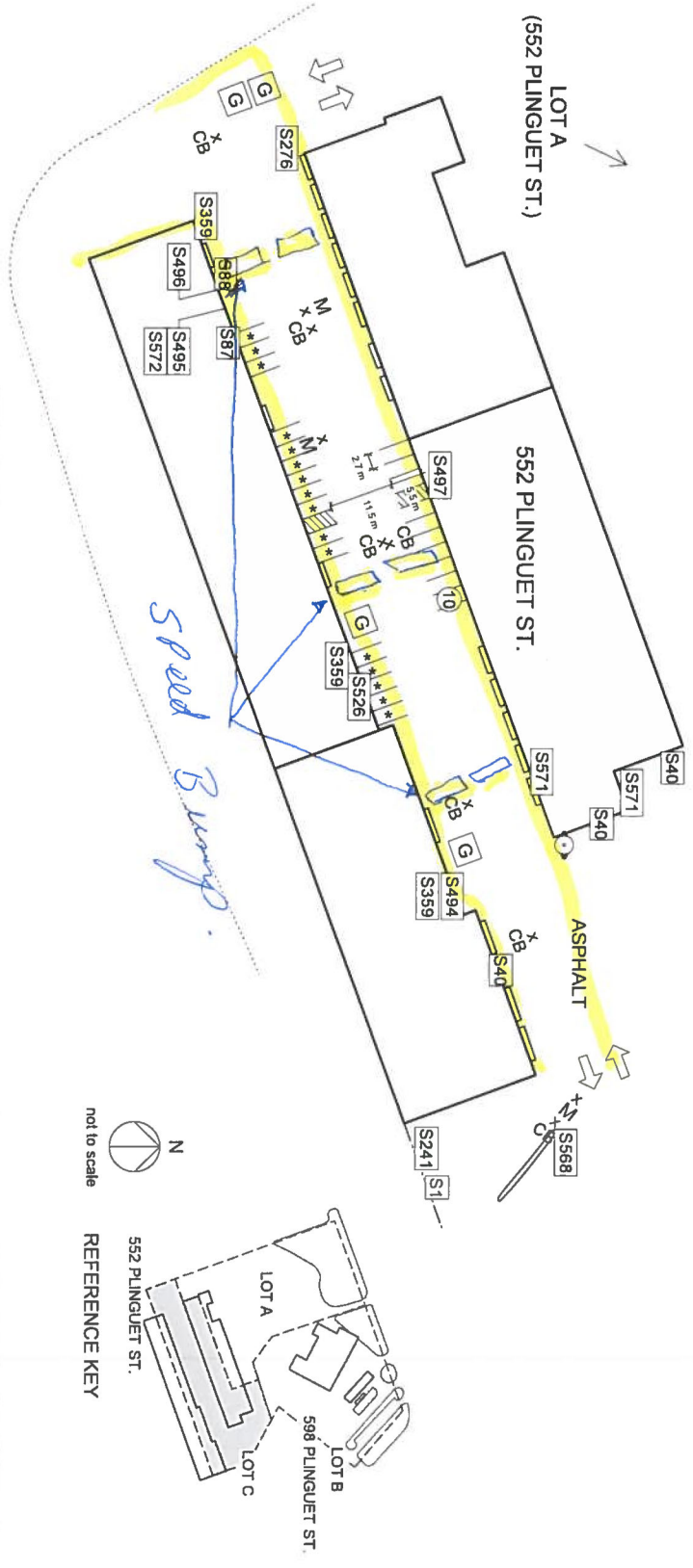

**LEGEND**

- CHAIN LINK FENCE
- ELECTRICAL OUTLET
- ⇨ ENTRANCE/EXIT
- ③ NO. OF STALLS IN EACH ROW/COLUMN
- X CB CATCH BASIN
- G GARBAGE
- M MANHOLE
- ⊙ FIRE HYDRANT
- ▭ MARKED STALLS

|  |  |   |  |  |  |  |
|--|--|---|--|--|--|--|
| <b>S1</b><br>CITY OF BURGESS<br>TELEPHONE 311<br>UNLAWFUL<br>PARKING<br>PROHIBITED | <b>S40</b><br>NO PARKING<br>BETWEEN SIGNS<br>WATER FILLING<br>STATION  | <b>S87</b><br>EMPLOYEES<br>ONLY         | <b>S241</b><br>CUSTOMER PARKING<br>ONLY                              | <b>S276</b><br>STOP  | <b>S359</b><br>THIS AREA PROTECTED BY<br>CAMERA AND<br>SILENT ALARM<br>24HR SURVEILLANCE | <b>S494</b><br>STORES<br>RECEIVING<br>552 Ringroad |
| <b>S495</b><br>THIS WATER<br>IS<br>NOT FOR<br>DRINKING                             | <b>S496</b><br>NO PARKING<br>BETWEEN SIGNS<br>WATER FILLING<br>STATION | <b>S241</b><br>CUSTOMER PARKING<br>ONLY | <b>S568</b><br>WASHBAY<br>FOR<br>WATER AND WASTE<br>VEHICLES<br>ONLY | <b>S571</b><br>WASHBAY<br>FOR<br>WATER AND WASTE<br>VEHICLES<br>ONLY | <b>S572</b><br>CAUTION<br>HOT COMBUSTION<br>GAS AROUND<br>STAND PIPE                     |  |

| LOT # 124<br>552/598 PLINGUET ST.<br>(LOT C) | EST. TOTALS | HANDICAP | WPA RSVD | STAFF | VISITORS | UPDATED<br>2010.07.29<br>M.Ho |
|--|-------------|----------|----------|-------|----------|-------------------------------|
|  | 10          |          |          | 10    |          |                               |

\* 16 STALLS FOR LOADING AND CITY VEHICLES (NOT INCLUDED IN STALL COUNT)

lot # 128 960 Thomas

