

PROJECT
NORTH

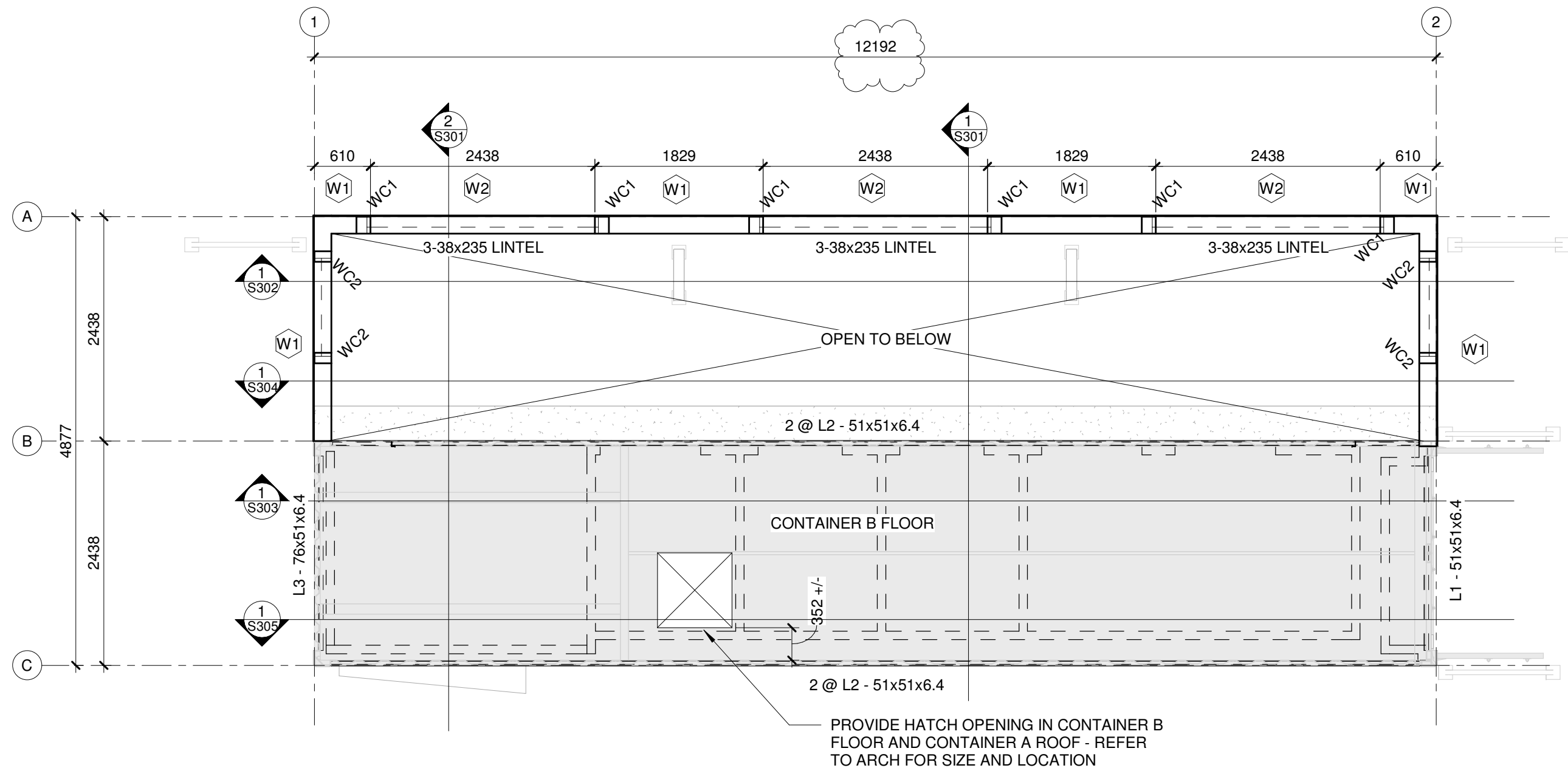

**ENGINEERS
GEOLOGISTS
MANITOBA**

Certificate of Authorization
SWP Projects Ltd.
No. 6036 Expiry: April 30, 2021

PROVINCE OF MANITOBA
D. R. POOLE
03-18-2021
Member
24613
REGISTERED PROFESSIONAL ENGINEER

PLATE LEGEND

- PL1 - 150x200x13 CONTAINER STACK CONNECTOR PLATE WELDED TO CORNER CASTINGS
- PL2 - 190x108x6.4 END FRAME OPENING CLOSURE
- PL3 - 300x135x6.4 SIDE RAIL FORKLIFT TUNNEL CLOSURE
- PL4 - 150x150x16 WELD PLATE C/W 2 - 10mm DIA NELSON STUDS x 75mm LONG
- PL5 - 6mm WELDED PLATE WINDOW FRAME ASSEMBLY - CONFIRM DIMENSIONS WITH ARCH AND WINDOW SUPPLIER. PROVIDE 50 MM BENT PLATE RETURN LIP ON INTERIOR SIDE, 4mm STRAP ANCHORS @ 600 O/C FOR EMBEDMENT TO BLOCK WALL - TYP.

SPECIFIED DESIGN LOADS
LIVE LOAD 3.6 kPa
DEAD LOAD
CONTAINER - TARE WEIGHT NOT TO EXCEED 4018 kg (9000 lb)



SWP PROJECTS LTD.
678 MAIN STREET - 2ND FLR WINNIPEG, MB R3B 1E4
(P) 204.586.3636
(C) 204.330.2611
(E) david@totalprojectmgmt.ca

715 MAIN STREET PUBLIC TOILET
THE CITY OF WINNIPEG
BID OPPORTUNITY 54-2021

No.	Description	Date
1	ISSUED FOR CONSTRUCTION	21-03-04
2	ROOF REVISION	21-03-18

2nd LEVEL FRAMING PLAN		S103
Project number	20-104	
Date	2021-03-18	
Drawn by	DP	
Checked by	DP	
Scale 1 : 50		