

MATCHLINE STATION 0+470

PROFILE VIEW

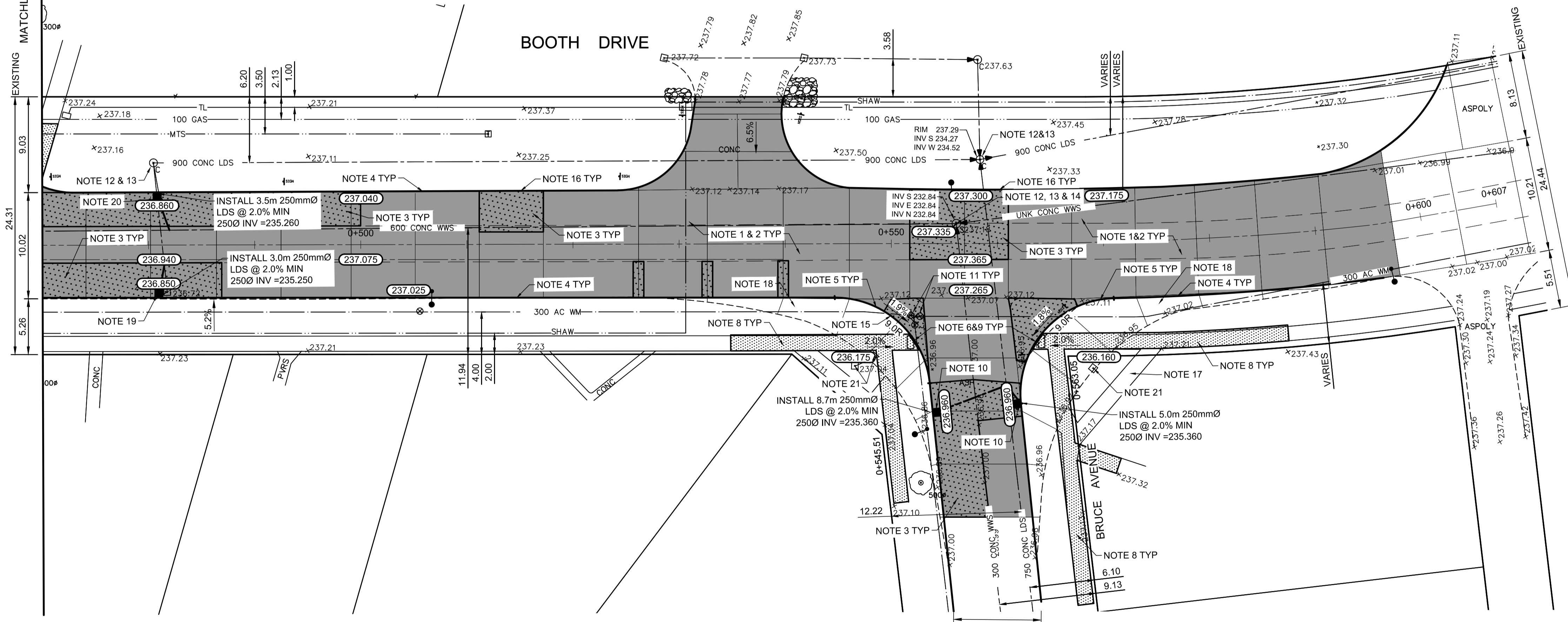

- REFERENCE NOTES:**
- A. PAVEMENT DIMENSIONS ARE TO BACK OF CURB
 - B. BASELINE IS CENTRE LINE ROADWAY
 - C. PROPERTY LINES OBTAINED FROM CITY OF WINNIPEG L.B.I.S. AND NO SCALE FACTOR WAS APPLIED
- REFER TO AECOM FIELD BOOK NO. 5050

- CONSTRUCTION NOTES**
1. PLANE EXISTING ASPHALT PAVEMENT
 2. CONSTRUCT NEW ASPHALT PAVEMENT OVERLAY TYPE 1A (85mm AVG. THICKNESS)
 3. REMOVE EXISTING CONCRETE AND CONSTRUCT NEW 200mm DOWELED CONCRETE PAVEMENT c/w 85mm ASPHALTIC OVERLAY
 4. CONSTRUCT NEW CONCRETE BARRIER CURB (100mm REVEAL HT. DOWELED)
 5. CONSTRUCT NEW CONCRETE MODIFIED BARRIER CURB (150mm REVEAL HT. DOWELED)
 6. CONSTRUCT NEW CONCRETE CURB RAMP (10-12mm HT. REVEAL SEPARATE)
 7. CONSTRUCT NEW 100mm CONCRETE SIDEWALK
 8. RENEW EXISTING 100mm CONCRETE SIDEWALK
 9. INSTALL DETECTABLE SURFACE WARNING TILE
 10. INSTALL NEW CURB AND GUTTER INLET c/w CATCH BASIN (SD-024) AND CONNECT TO 750 CONCRETE LDS
 11. ADJUST EXISTING WATER VALVE TO GRADE
 12. ADJUST EXISTING CATCH BASIN / MANHOLE TO GRADE
 13. REMOVE EXISTING FRAME AND COVER AND PLACE NEW STANDARD MANHOLE FRAME AND COVER (AP-007 / AP-008)
 14. INSTALL NEW CAST IRON RISER RING
 15. CONSTRUCT NEW MODIFIED BARRIER CURB (150mm REVEAL HT. INTEGRAL)
 16. REMOVE EXISTING CURB AND CONSTRUCT NEW BARRIER CURB (100mm REVEAL HT. SEPARATE)
 17. REMOVE EXISTING SIDEWALK
 18. REMOVE EXISTING CONCRETE PAVEMENT AND BARRIER CURB
 19. INSTALL NEW CURB AND GUTTER INLET c/w CATCH BASIN (SD-024) AND CONNECT TO EXISTING LEAD
 20. INSTALL NEW CURB AND GUTTER INLET c/w CATCH BASIN (SD-024) AND CONNECT TO 600 CONCRETE WWS
 21. REMOVE EXISTING CATCH BASIN/ CATCH PIT AND PLUG LEAD

ENGINEERS GEOSCIENTISTS MANITOBA
 Certificate of Authorization
 AECOM Canada Ltd.
 No. 4671 Date: _____

METRIC
 WHOLE NUMBERS INDICATE MILLIMETRES
 DECIMALIZED NUMBERS INDICATE METRES

150 mm W.M.	WATERMAIN	150 mm W.M.	HYDRO	— x —	PROFILE
Hydrant	HYDRANT	Hydrant	M.T.S.	West Gutter	WEST GUTTER
Valve	VALVE	Valve	CONCRETE	East Gutter	EAST GUTTER
300mm L.D.S.	LAND DRAINAGE SEWER	300mm L.D.S.	ASPHALT	W Property Line	W PROPERTY LINE
250mm W.W.S.	WASTEWATER SEWER	250mm W.W.S.	PROPERTY LINE	E Property Line	E PROPERTY LINE
Manhole	MANHOLE	Manhole	SURVEY BAR		
Catch Basin	CATCH BASIN	Catch Basin	ELEVATION (235.750)		
Catch Pit	CATCH PIT	Catch Pit	TREE		
Junctions	JUNCTIONS	Junctions	SIDEWALK RAMP		
Culvert	CULVERT	Culvert	CONCRETE SIDEWALK		
Gas	GAS	Gas	FENCE		
EXISTING	LEGEND - PLAN	PROPOSED	EXISTING	LEGEND - PLAN	PROPOSED
EXISTING	LEGEND - PROFILE	PROPOSED	EXISTING	LEGEND - PROFILE	PROPOSED

LOCATION APPROVED UNDERGROUND STRUCTURES

SUPV. U/G STRUCTURES COMMITTEE DATE

NOTE:
 LOCATION OF UNDERGROUND STRUCTURES AS SHOWN ARE BASED ON THE BEST INFORMATION AVAILABLE. BUT NO GUARANTEE IS GIVEN THAT ALL EXISTING UTILITIES ARE SHOWN OR THAT THE GIVEN LOCATIONS ARE EXACT. CONFIRMATION OF EXISTENCE AND EXACT LOCATION OF ALL SERVICES MUST BE OBTAINED FROM THE INDIVIDUAL UTILITIES BEFORE PROCEEDING WITH CONSTRUCTION.

B.M. 24-N.E. COR BOOTH DR. & MEADOWLARK PL., ELEV. T.B.T. IN MOST SLY. CONC. FOUNDATION OF BRUCE JR. HIGH SCHOOL NO. 333 BOOTH DR., 0.5m W. & 0.2m BELOW BRICK OF S.E. COR. SCHOOL ELEVATION: 238.678

AECOM

DESIGNED BY: JA CHECKED BY: BC/RC
 DRAWN BY: JA APPROVED BY: _____
 HOR. SCALE: 1:250 ORIGINAL SIGNED BY: _____
 VERTICAL: 1:10

ISSUED FOR 100% REVIEW 04/17/20 BC
 NO. REVISIONS DATE BY DATE 2020/02/14 DATE

ENGINEER'S SEAL
 PROVINCE OF MANITOBA
R. T. CUNNINGHAM
 Member 24711
 REGISTERED PROFESSIONAL ENGINEER

THE CITY OF WINNIPEG
 PUBLIC WORKS DEPARTMENT
 ENGINEERING DIVISION

2020 RESIDENTIAL STREET RENEWAL PROGRAM

BOOTH DRIVE - PORTAGE AVENUE TO STURGEON ROAD
 ASPHALT PAVEMENT REHABILITATION
 STATION 0+430 TO STATION 0+590

CITY DRAWING NUMBER SHEET 13 OF 19