

NOTES:
 THESE DRAWINGS SHALL NOT BE SCALED. CONSULT WITH CLIENT AND DESIGNER ON ANY CONCERNS.
 SUBMISSION OF SITE MARKUPS, AS-BUILTS, OPERATING & MAINTENANCE MANUALS AND OTHER SUPPORTING DOCUMENTS TO CLIENT ARE MANDATORY AT THE COMPLETION OF THIS PROJECT.
 THE CONTRACTOR SHALL VISIT THE SITE AND SATISFY HIMSELF ALL DIMENSIONS, DATUM, AND DETAILED INFORMATION SHOWN ARE CORRECT.
 ALL PRODUCTS AND MATERIALS TO BE USED AND INSTALLED SHALL CONFORM WITH MANUFACTURERS SPECIFICATIONS, APPLICABLE CODES AND AUTHORITY HAVING JURISDICTION.

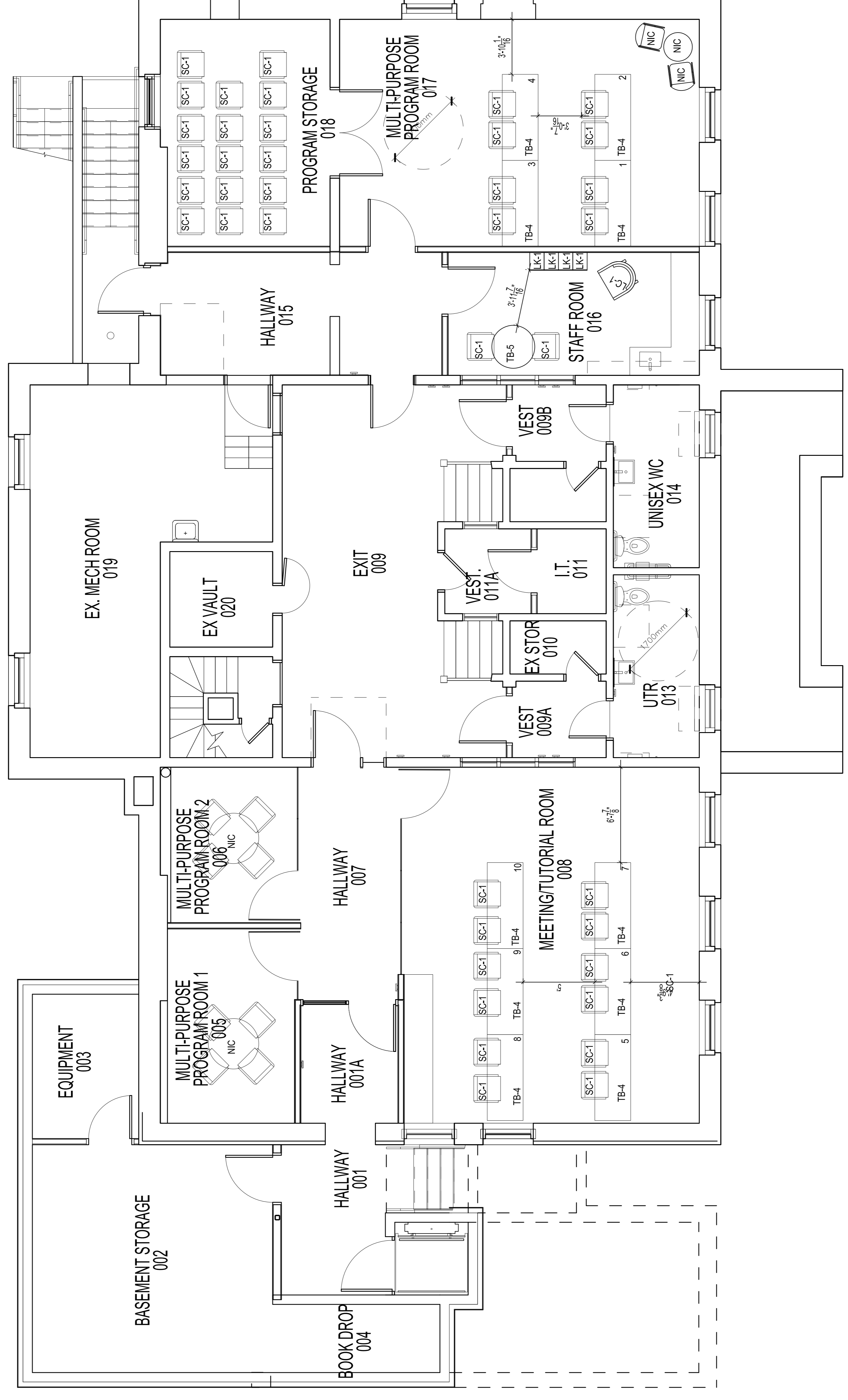

BASEMENT FLOOR PLAN -
 SCALE: 1/4"=1'-0"

No.	REVISION/DESCRIPTION	BY	DATE

DRAWN	JVF	CHECKED	JVF	DESIGNED	JVF	APPROVED	JVF
DATE	2019.02.08	USER	JVF	APPROVAL	JVF		

THE CITY OF WINNIPEG
 PLANNING, PROPERTY, AND
 DEVELOPMENT DEPARTMENT
 Winnipeg
 MUNICIPAL ACCOMMODATIONS DIVISION
 3-65 GARRY STREET, R3C 4K4

PROJECT
 ST JOHNS LIBRARY

FURNITURE PLAN
 600 SALTER STREET

SHEET TITLE
 BASEMENT FLOOR PLAN