

WINNIPEG TRANSIT 2018 STRUCTURAL AND ROOFING REPAIRS 1520 MAIN STREET WINNIPEG, MANITOBA

DRAWING INDEX

STRUCTURAL DRAWINGS

S0.1	DRAWING INDEX, SITE PLAN AND GENERAL NOTES
S2.1	ROOF PLAN
S4.1	SECTIONS AND DETAILS
S5.1	TYPICAL SECTIONS AND DETAILS
S5.2	TYPICAL SECTIONS AND DETAILS

PRIME CONSULTANT



Crosier Kilgour & Partners Ltd.

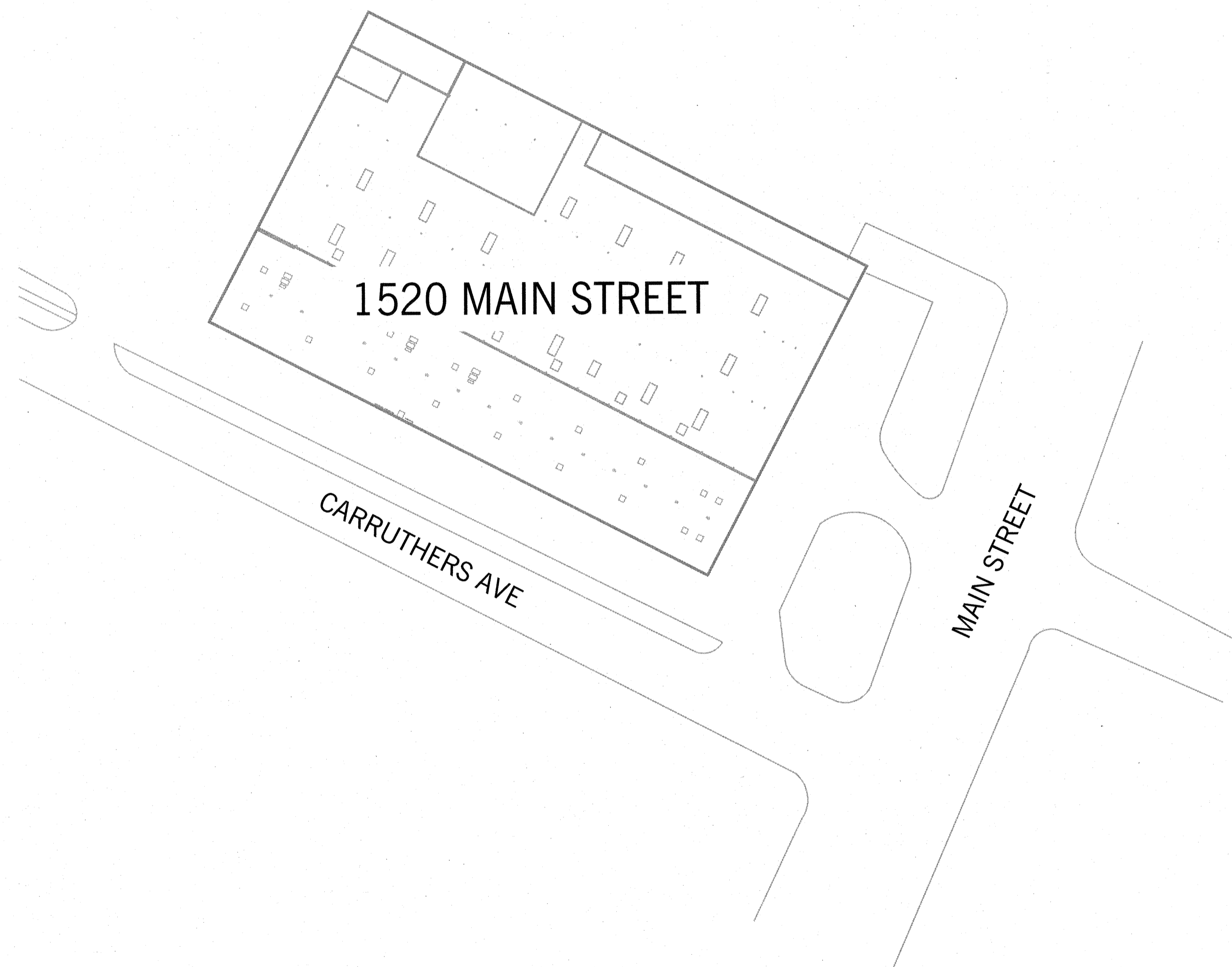

 **SITE PLAN**
N.T.S.

GENERAL NOTES

- STRUCTURAL DESIGN BASED ON THE MANITOBA BUILDING CODE 2011 EDITION.
- SEISMIC SITE CLASSIFICATION: NOT APPLICABLE
- DO NOT SCALE DRAWINGS.
- ALL DIMENSIONS ARE TO BE VERIFIED WITH THE EXISTING SITE CONDITIONS PRIOR TO CONSTRUCTION.
- THESE STRUCTURAL DRAWINGS SHOW THE COMPLETED STRUCTURE AND DO NOT INDICATE ALL COMPONENTS NECESSARY FOR SAFETY DURING CONSTRUCTION. THE GENERAL CONTRACTOR SHALL BE SOLELY RESPONSIBLE FOR SAFETY ON AND AROUND THE JOBSITE DURING CONSTRUCTION.

STRUCTURAL STEEL

- THE STRUCTURAL STEEL FABRICATOR'S ENGINEER SHALL BE RESPONSIBLE FOR LOCATING AND DESIGNING PROVISIONS FOR ALL TEMPORARY FALL PROTECTION SYSTEMS REQUIRED DURING CONSTRUCTION TO MEET MANITOBA WORKPLACE HEALTH AND SAFETY REGULATIONS.
- STRUCTURAL STEEL TO CONFORM TO CSA-640.21, "STRUCTURAL QUALITY STEELS" AND CSA-640.20 "GENERAL REQUIREMENTS FOR ROLLED OR WELDED STRUCTURAL QUALITY STEEL".
- ALL ROLLED OR STEEL STRUCTURAL SECTIONS SHALL BE C40.21-50W. ALL HOLLOW STRUCTURAL SECTIONS TO BE C40.21-50W CLASS C. ALL ANGLES, CHANNELS AND PLATES SHALL BE C40.21-44W.
- FABRICATION AND ERECTION OF STRUCTURAL STEEL SHALL BE PERFORMED IN ACCORDANCE WITH CAN/CSA S16-14, "STEEL STRUCTURES FOR BUILDINGS".
- ALL WELDING SHALL CONFORM TO THE LATEST EDITION OF CSA W59, "WELDED STEEL CONSTRUCTION". FABRICATORS SHALL BE PROPERLY CERTIFIED IN ACCORDANCE WITH CSA W47.1, "CERTIFICATION OF COMPANIES FOR FUSION WELDING OF STEEL STRUCTURES".
- ALL BOLTED CONNECTIONS TO USE A325 HIGH STRENGTH BOLTS. MINIMUM CONNECTION SHALL CONSIST OF 2 BOLTS.
- STEEL RECEIVING FINISH PAINTING TO HAVE ONE COAT OF CISC/CPMA 2-75 QUICK DRYING GREY SHOP PRIMER. STEEL TO BE CLEANED IN CONFORMANCE WITH SSPC-SP7. STEEL TO BE FINISH PAINTED WITH TWO COATS OF SAFETY YELLOW TO MATCH EXISTING COLUMNS.
- ANCHOR BOLTS TO BE MINIMUM GRADE ASTM A307.
- FABRICATOR TO NOTIFY ENGINEER OF ANY PROPOSED MEMBER SUBSTITUTIONS AND CHANGED CONNECTION DETAILS.
- STRUCTURAL STEEL SUPPLIER IS TO SUBMIT ENGINEERING DRAWINGS BEARING THE SEAL OF A PROFESSIONAL ENGINEER REGISTERED IN THE PROVINCE OF MANITOBA COVERING THE DESIGN OF CONNECTIONS, TO THE PROJECT DESIGN ENGINEER FOR REVIEW PRIOR TO FABRICATION. CONNECTION DESIGN TO INCLUDE FOR ALL ADJUSTABLE CONNECTIONS REQUIRED TO SUIT FABRICATION AND ERECTION PROCEDURES AND TOLERANCES.

METAL DECK

- NEW ROOF DECK SHALL MATCH EXISTING ROOF DECK PROFILE AND HAVE A MINIMUM NOMINAL THICKNESS OF 20 GA. CONFIRM WITH CONTRACT ADMINISTRATOR PRIOR TO ORDERING.
- DECK SHALL BE MINIMUM GRADE A WITH A MINIMUM GALVANIZED ZINC COATING TO Z275.
- DECK SHALL BE ARC SPOT WELDED TO BEARING SUPPORTS AT 12 IN. O/C. WELDS SHALL BE 3/4 IN. DIAMETER.
- SIDE LAPS SHALL BE MECHANICALLY FASTENED (BUTTON-PUNCHED) AT 24 IN. ON-CENTRE.
- TOUCH UP DECK WITH ZINC RICH PAINT WHERE ZINC COATING HAS BEEN BURNED BY WELDING.

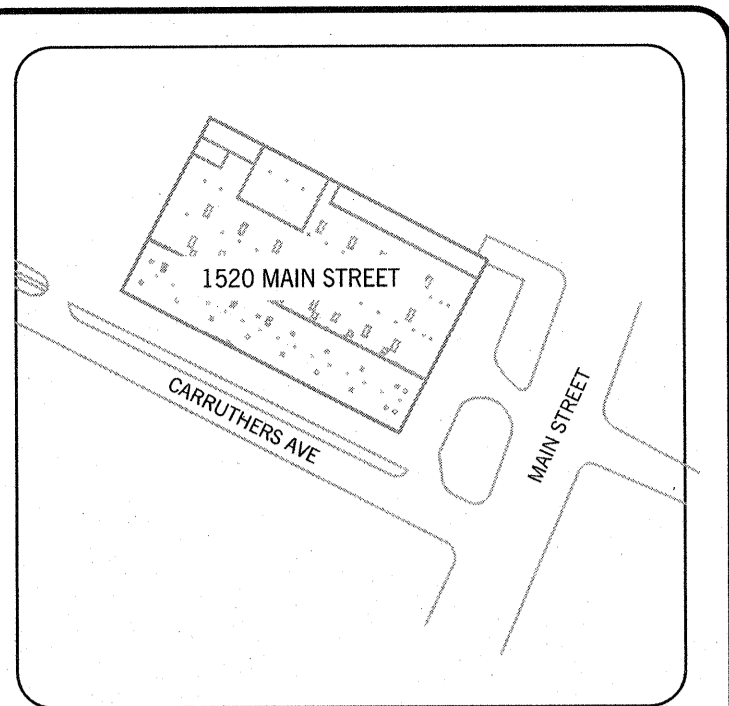

 **KEY PLAN**
N.T.S.

The General Contractor shall check & verify all dimensions and report any errors or omissions to the designers.

No.	Date	Issue/Revision	By
0	2018-06-04	ISSUED FOR CONSTRUCTION	IM



Consultant

300-275 Carlton Street
Winnipeg, Manitoba R3C 5R6
T 204-943-7501
F 204-943-7507



**Crosier Kilgour
& Partners Ltd.**
CONSULTING STRUCTURAL ENGINEERS

Project
WINNIPEG TRANSIT
2018 STRUCTURAL AND ROOFING REPAIRS

1520 MAIN STREET
WINNIPEG, MANITOBA

Sheet Title
**DRAWING INDEX, SITE PLAN,
AND GENERAL NOTES**

File: 2018-0145 Date: 2018-06-04

Design: IM Drawn: DNM

Revision: 0 Sheet No. S0.1