

CHAINAGE ALONG WEST GUTTER LINE

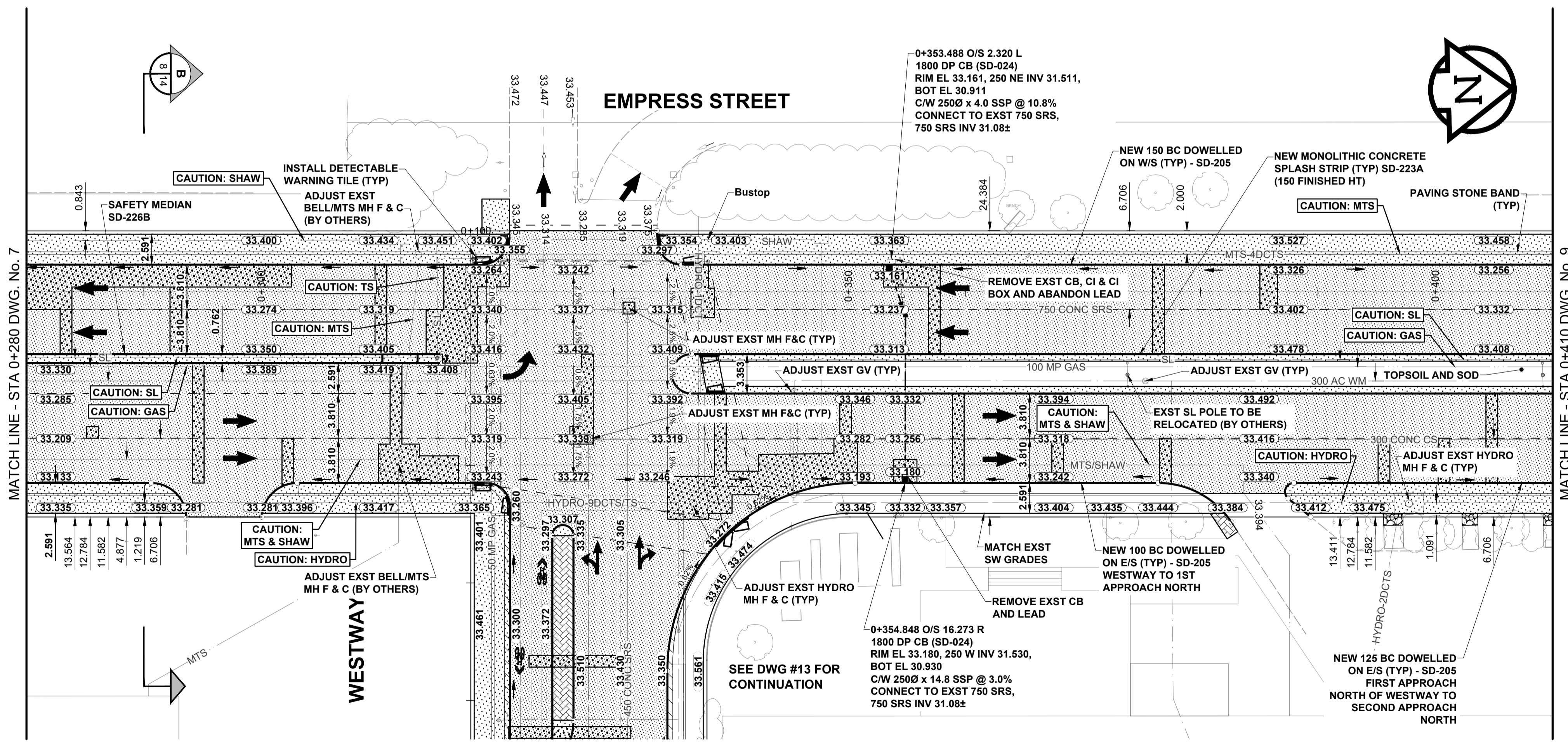

- NOTES**
- ADJUST MH AND CB RIMS TO NEW GRADES.
  - CONTRACTOR TO REGRADE/RENEW EXST PRIVATE SIDEWALKS TO LIMITS AS SHOWN. SIDEWALKS TO BE RENEWED WITH CONCRETE UNLESS NOTED OTHERWISE.
  - CONTRACTOR TO TAKE PRECAUTIONARY STEPS AS OUTLINED IN THE SPECIFICATIONS TO PROTECT EXISTING TREES WITHIN THE LIMITS OF CONSTRUCTION FROM DAMAGE FROM CONSTRUCTION ACTIVITIES.
  - MODIFIED BARRIER CURB TO BE CONSTRUCTED AT ALL INTERSECTION RADII, BACK LANE RADII AND BULLNOSES.
  - CONTRACTOR TO CONFIRM THE LOCATION OF ALL UTILITIES/SERVICES IN THE FIELD PRIOR TO CONSTRUCTION.
  - ADD 200.000m TO ABBREVIATED ELEVATIONS TO OBTAIN GEODETIC ELEVATIONS.
  - CB SD-024 OFFSETS ARE DIMENSIONED TO BOC. CB SD-025 OFFSETS ARE DIMENSIONED O/C.
  - ALL DIMENSIONS TO BACK OF CURB AND THEORETICAL BACK OF CURB.

**SECTION LEGEND**

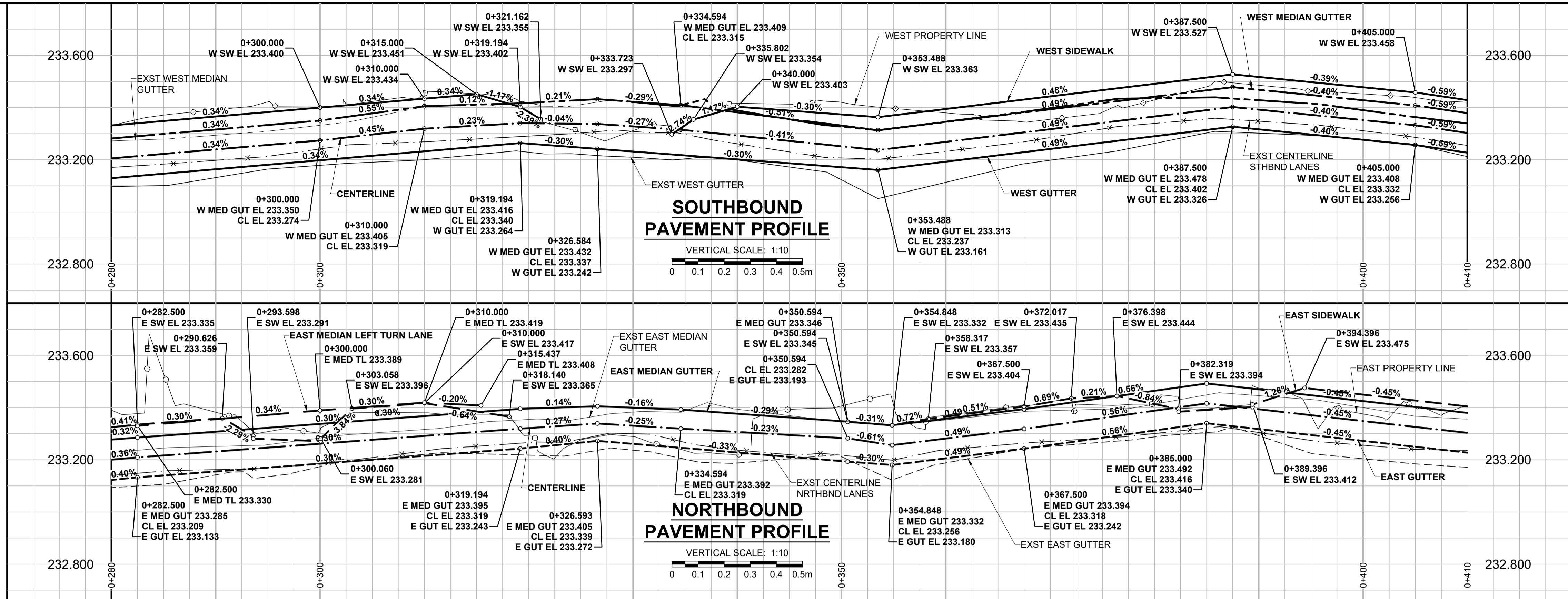
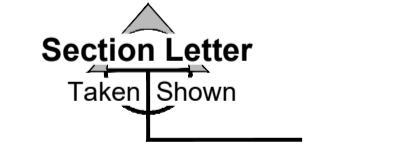

**ENGINEERS GEOSCIENTISTS MANITOBA**  
Certificate of Authorization  
**MORRISON HERSHFIELD**  
No. 1736

BID OPPORTUNITY No. 38-2018

**METRIC**  
WHOLE NUMBERS INDICATE MILLIMETRES  
DECIMALIZED NUMBERS INDICATE METRES

EXISTING	NEW	EXISTING	NEW	EXISTING	NEW	EXISTING	NEW

**LOCATION APPROVED UNDERGROUND STRUCTURES**

DATE: \_\_\_\_\_

**NOTE:** LOCATION OF UNDERGROUND STRUCTURES AS SHOWN ARE BASED ON THE BEST INFORMATION AVAILABLE BUT NO GUARANTEE IS GIVEN THAT ALL EXISTING UTILITIES ARE SHOWN OR THAT THE GIVEN LOCATIONS ARE EXACT. CONFIRMATION OF EXISTENCE AND EXACT LOCATION OF ALL SERVICES MUST BE OBTAINED FROM THE INDIVIDUAL UTILITIES BEFORE PROCEEDING WITH CONSTRUCTION.

ISSUED FOR TENDER	18/03/09	RPB
ISSUED FOR CLIENT REVIEW	18/01/31	RPB
REVISIONS	YY/MM/DD	BY

**MORRISON HERSHFIELD**

DESIGNED BY: RPB  
CHECKED BY: WRJ

DRAWN BY: DID  
APPROVED BY: BWB

RELEASED FOR CONSTRUCTION

HOR SCALE: 1:250  
VERT SCALE: 1:10

DATE: 18/03/09

PROFESSIONAL'S SEAL

PROVINCE OF MANITOBA

**R.P. BRUCE**

REGISTERED PROFESSIONAL ENGINEER

CONSULTANT FILE NAME: W160034-8-Empress-Rehab-PP-8.dwg

**THE CITY OF WINNIPEG**  
PUBLIC WORKS DEPARTMENT  
ENGINEERING DIVISION

**2018 REGIONAL STREET REHABILITATION**  
EMPRESS STREET  
PORTAGE AVENUE TO JACK BLICK AVENUE;  
WESTWAY AND EASTWAY

**EMPRESS STREET**  
HORIZONTAL AND VERTICAL ALIGNMENT  
STA 0+280 TO STA 0+410

CITY DRAWING NUMBER: P-3494-8  
SHEET 8 OF 14  
DRAWING No. 8 REV B