

- NOTES:**
- ALL WORK AND MATERIALS TO BE IN ACCORDANCE WITH THE LATEST REVISION OF THE CITY OF WINNIPEG STANDARD CONSTRUCTION SPECIFICATION.
 - CONTRACTOR TO CONFIRM THE LOCATION OF ALL UTILITIES/SERVICES IN THE FIELD PRIOR TO CONSTRUCTION.
 - CONTRACTOR TO AVOID DAMAGE TO EXISTING TREES WITHIN THE LIMITS OF THE ALLEY RIGHT OF WAY AS OUTLINED IN THE BID OPPORTUNITY.
 - HYDRO POLES AND ANCHORS REQUIRING TEMPORARY SUPPORT TO BE DONE AT THE EXPENSE OF THE CONTRACTOR AS REQUIRED.
 - WHERE UNSTABLE SUB-GRADES ARE ENCOUNTERED, ADDITIONAL EXCAVATION/SUB-BASE AND INSTALLATION OF GEOTRIP TO BE DETERMINED BY THE CONTRACT ADMINISTRATOR AND CONSTRUCTED IN ACCORDANCE W/ CW-310.
 - PROPOSED ELEVATIONS GIVEN ARE FOR EDGE OF PAVEMENT.
 - ISOLATE EXISTING HYDRO POLES AS PER SD-228C.
 - RENEW CURB AND SIDEWALK AS DIRECTED BY THE CONTRACT ADMINISTRATOR.
 - MODIFIED BARRIER CURBS TO BE CONSTRUCTED AT ALL BACK LANE RADII.
 - ALL EXISTING PRIVATE APPROACHES TO BE RENEWED AS DIRECTED BY THE CONTRACT ADMINISTRATOR.
 - ADJUSTMENTS TO PROPOSED CROSSFALL, WHERE REQUIRED, ARE TO BE DETERMINED BY THE CONTRACT ADMINISTRATOR TO SUIT EXISTING DRIVEWAYS, APPROACHES, ETC.
 - ALL BOULEVARD RESTORATION TO BE SODDED UNLESS OTHERWISE NOTED.
 - INSTALLATION OF LIP CURBS AND THEIR LIMITS THROUGH PRIVATE APPROACHES TO BE DETERMINED BY THE CONTRACT ADMINISTRATOR.
 - REMOVE, ADJUST, AND SUPPLY PRECAST SIDEWALK BLOCKS AS DIRECTED BY THE CONTRACT ADMINISTRATOR.

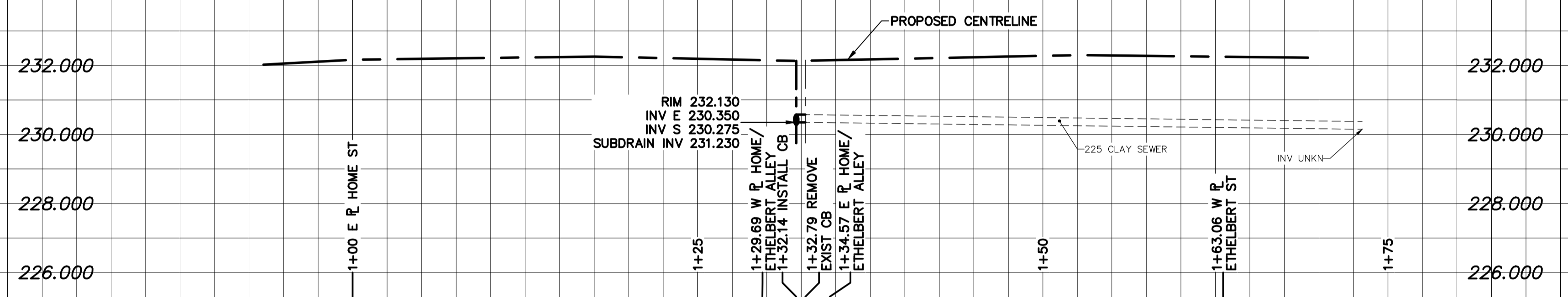

NOTE: CHAINAGES SHOWN ARE ALONG C/L OF RIGHT-OF-WAY

THERE SHALL BE NO INCREASE IN CUMULATIVE PEAK FLOW ENTERING CS AND/OR SRS SYSTEMS AS A RESULT OF CONSTRUCTION WORKS SHOWN.



PHASE 1
PRESTON AVENUE

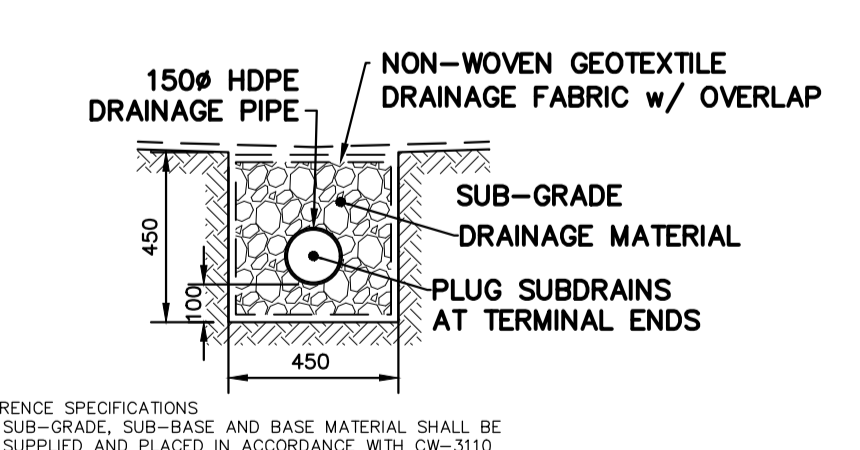
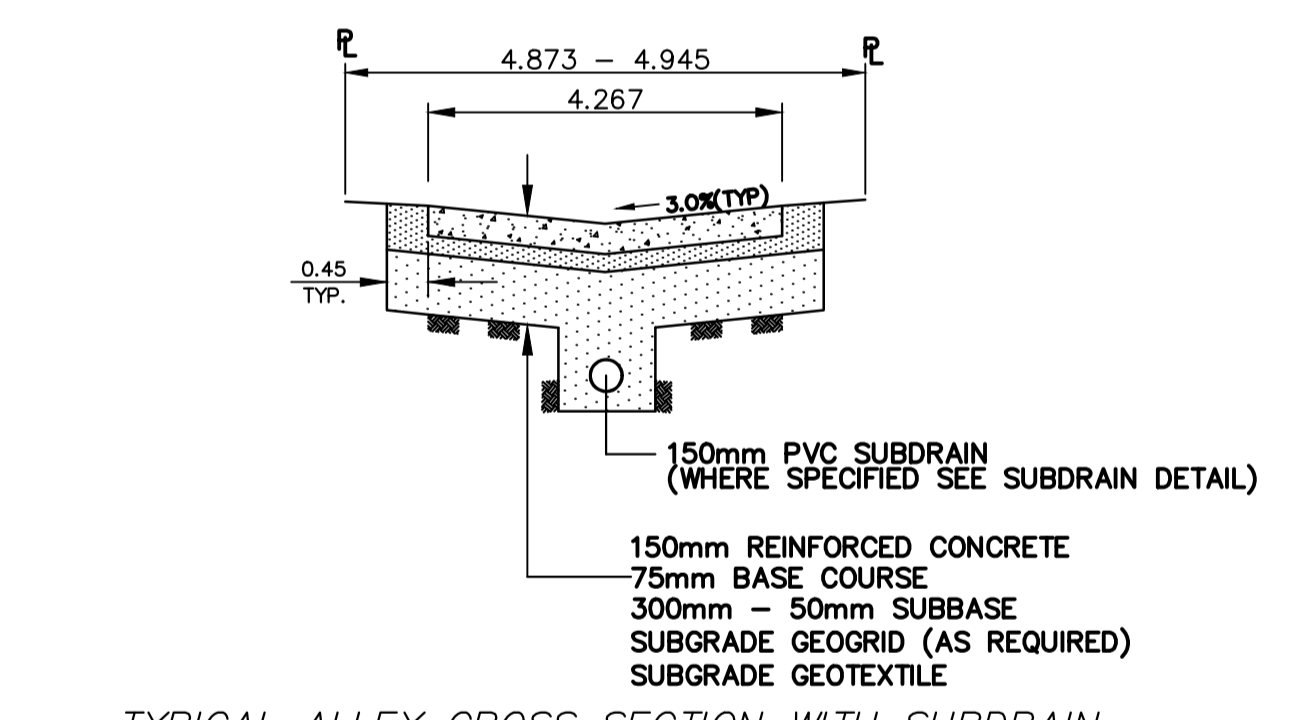
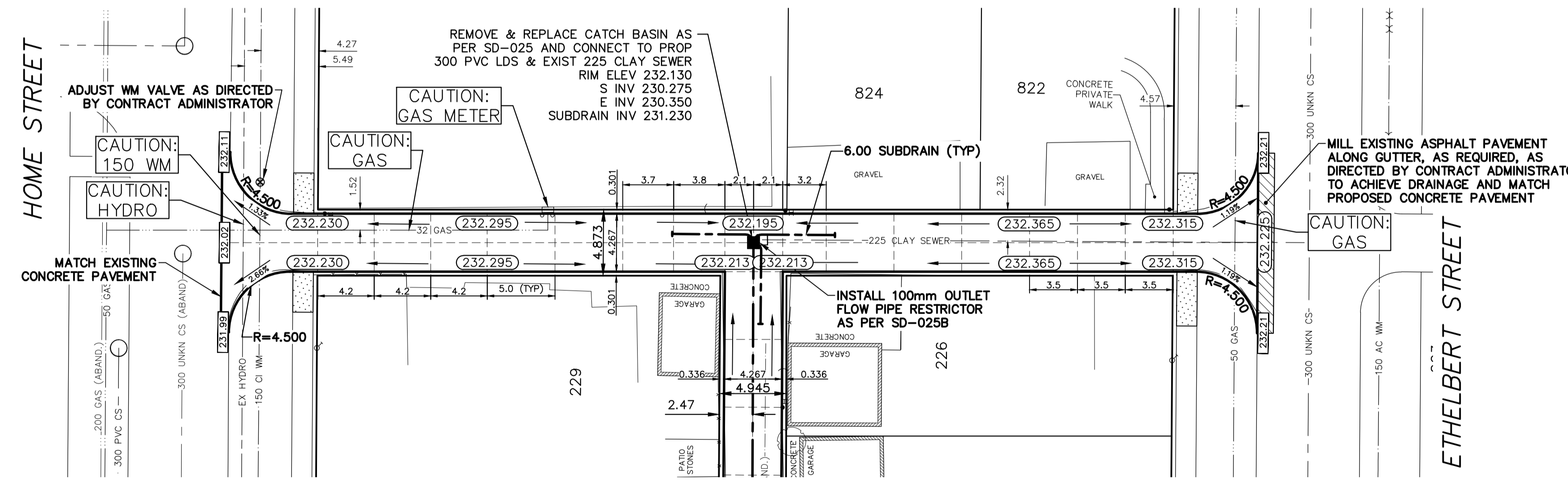
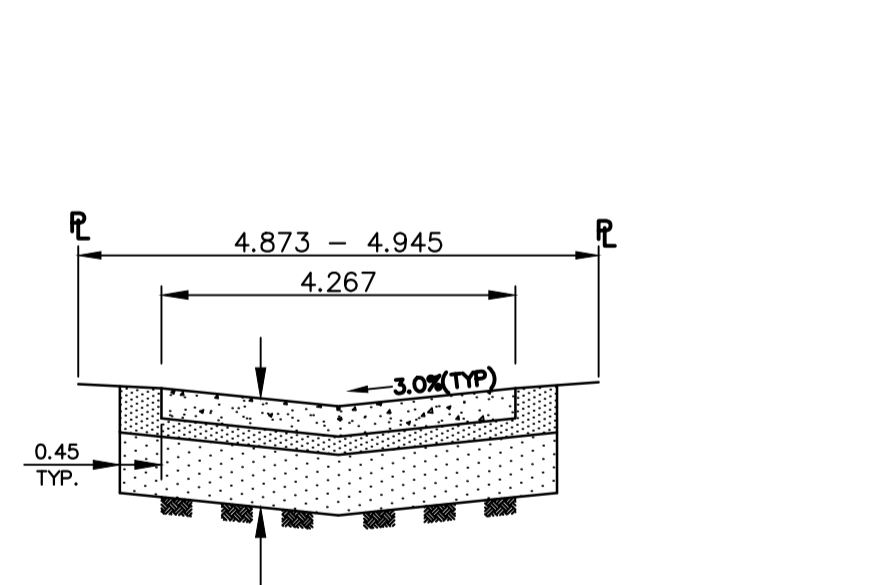

- REFERENCE SPECIFICATIONS:
- SUB-GRADE, SUB-BASE AND BASE MATERIAL SHALL BE SUPPLIED AND PLACED IN ACCORDANCE WITH CW-310.
 - INSTALLATION OF SUBDRAINS SHALL BE IN ACCORDANCE WITH CW-310.
 - DRAINAGE GEOTEXTILE FABRIC AND DRAINAGE PIPE SHALL CONFORM TO "APPROVED PRODUCTS FOR SURFACE WORKS"

**ENGINEERS
GEOSCIENTISTS
MANITOBA**
Certificate of Authorization
WSP Canada Group Limited
No. 6657

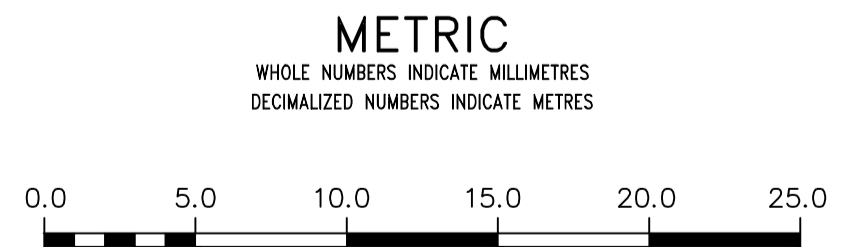

FOR CONTINUATION SEE
DWG 17M-02283-00-40

WATERMAIN	M.T.S.	CONCRETE/ASPHALT	WATERMAIN	150 MM	LOCATION APPROVED
HYDRANT	CONCRETE/ASPHALT	SIDEWALK	VALVE	300 LDS	UNDERGROUND STRUCTURES
VALVE	CONCRETE/ASPHALT	CURB RAMP	LAND DRAINAGE SEWER	250 WWS	
CURB STOP	CONCRETE/ASPHALT	ELEVATIONS	WASTE WATER SEWER	300 LDS	
LAND DRAINAGE SEWER	CONCRETE/ASPHALT	PROPERTY LINE	CENTERLINE	250 WWS	
WASTE WATER SEWER	CONCRETE/ASPHALT	SURVEY BAR	SOUTH & EAST GUTTER		
CB LEAD	CONCRETE/ASPHALT	HYDRO POLE	NORTH & WEST GUTTER		
MANHOLE	CONCRETE/ASPHALT	STREET LIGHT	S & E GARAGE PAD		
CATCH BASIN	CONCRETE/ASPHALT	JOINTS	N & W GARAGE PAD		
GAS	CONCRETE/ASPHALT	ASPHALT REPAIR			
HYDRO	CONCRETE/ASPHALT				
EXISTING	LEGEND - PLAN	PROPOSED	EXISTING	LEGEND - PROFILE	PROPOSED

LOCATION APPROVED UNDERGROUND STRUCTURES

SUPV. COMMITTEE	U/G STRUCTURES	DATE

NOTE:
LOCATION OF UNDERGROUND STRUCTURES AS SHOWN ARE BASED ON THE BEST INFORMATION AVAILABLE BUT NO GUARANTEE IS GIVEN THAT ALL EXISTING UTILITIES ARE SHOWN OR THAT THE GIVEN LOCATIONS ARE EXACT. CONFIRMATION OF EXISTENCE AND EXACT LOCATION OF ALL SERVICES MUST BE OBTAINED FROM THE INDIVIDUAL UTILITIES BEFORE PROCEEDING WITH CONSTRUCTION.

B.M. ELEV.	NO.	REVISIONS	DATE	BY

wsp
111-83 Lombard Avenue
Winnipeg, Manitoba
R3B 3B1 Canada
Phone: 204-943-3178
Fax: 204-943-4948
wsp.com

DESIGNED BY: K.G.
CHECKED BY: R.H.
DRAWN BY: D.R./K.G.
APPROVED BY: S.M.
HOR. SCALE: 1:250
VERT. SCALE: AS SHOWN
JANUARY 2018

NOT FOR CONSTRUCTION

CONSULTANT DRAWING NO.
17M-02283-00-41

Winnipeg THE CITY OF WINNIPEG
PUBLIC WORKS DEPARTMENT

2018 ALLEY RENEWALS
PRESTON AVE ALLEY
FROM HOME STREET TO ETHELBERG STREET
CONCRETE PAVEMENT

CITY DRAWING NO.
SHEET 3 OF 3
BID OPPORTUNITY
29-2018