

KILLARNEY AVENUE

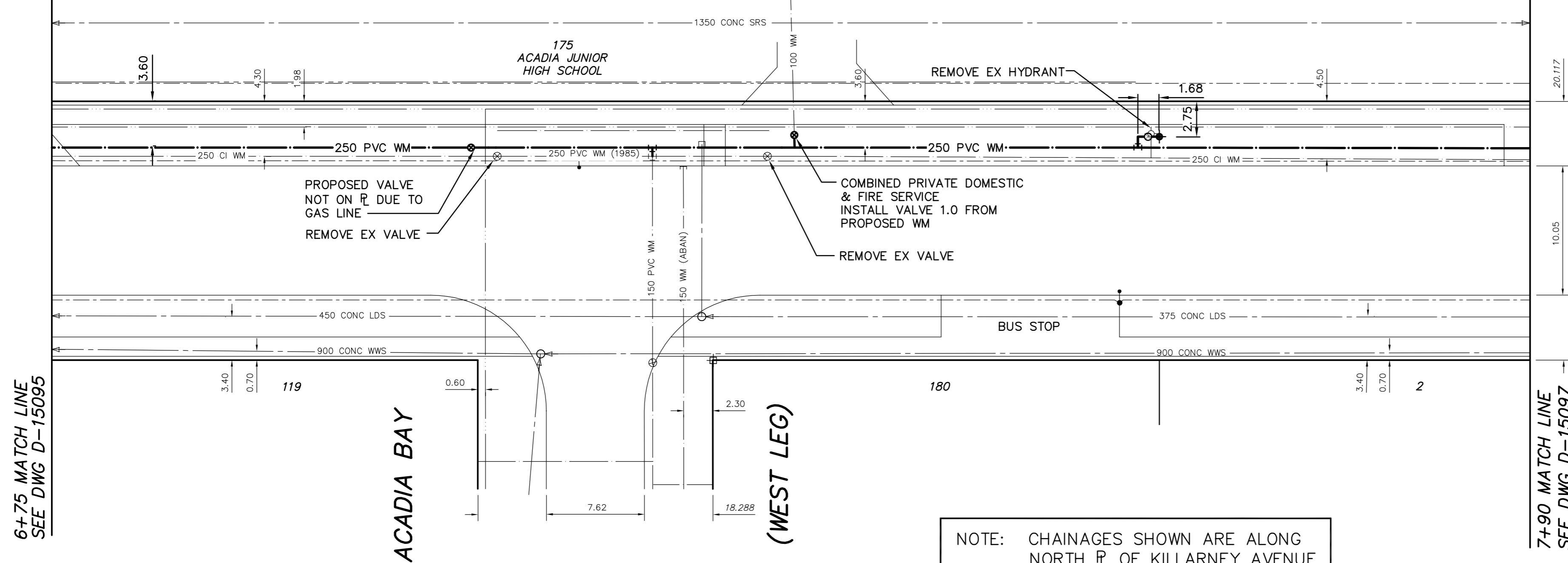

6+75 MATCH LINE
SEE DWG D-15095

7+90 MATCH LINE
SEE DWG D-15097

NOTE: CHAINAGES SHOWN ARE ALONG NORTH P OF KILLARNEY AVENUE

NOTE: ALL VALVES TO BE INSTALLED COUNTERCLOCKWISE TO CLOSE

WATER SERVICE INFORMATION

ADDRESS	SIZE (mm) MATERIAL (STREET)	SIZE (mm) MATERIAL (PROP.)	SHORT & LONG MEASUREMENT	CORP. LOCATION	REMARKS
119 ACADIA BAY RESIDENTIAL	UNKNOW	UNKNOW	8.5 N/SHL 7.9 SSL KILLARNEY	0.6 N OF S/C	SERVICED OFF ACADIA
175 KILLARNEY AVE COMMERCIAL	150	150	UNKNOW	UNKNOW	-
180 KILLARNEY AVE RESIDENTIAL	UNKNOW	UNKNOW	5.8 N/SHL 9.8 SSL KILLARNEY	0.6 N OF S/C	SERVICED OFF ACADIA
2 ACADIA BAY RESIDENTIAL	UNKNOW	UNKNOW	7.0 N/SHL 9.1 SSL KILLARNEY	1.2 N OF S/C	SERVICED OFF ACADIA

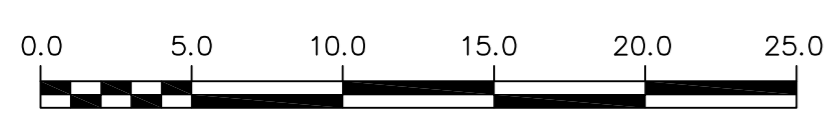

METRIC
WHOLE NUMBERS INDICATE MILLIMETRES
DECIMALIZED NUMBERS INDICATE METRES



WARNING
IF POWER EQUIPMENT OR EXPLOSIVES ARE TO BE USED FOR EXCAVATION ON THIS PROJECT THE CONTRACTOR MUST:
1) NOTIFY THE GAS COMPANY OF THE PROPOSED LOCATION OF EXCAVATION.
2) TAKE PRECAUTION TO AVOID DAMAGE TO GAS COMPANY INSTALLATIONS.
SEE PROVINCIAL REGULATION 210/72 FOR DETAILS

LOCATION APPROVED UNDERGROUND STRUCTURES
SUPPLY U/G STRUCTURES COMMITTEE DATE
NOTE:
LOCATION OF UNDERGROUND STRUCTURES AS SHOWN ARE BASED ON THE BEST INFORMATION AVAILABLE BUT NO GUARANTEE IS GIVEN THAT ALL EXISTING UTILITIES ARE SHOWN OR THAT THE GIVEN LOCATIONS ARE EXACT. CONFIRMATION OF EXISTENCE AND EXACT LOCATION OF ALL SERVICES MUST BE OBTAINED FROM THE INDIVIDUAL UTILITIES BEFORE PROCEEDING WITH CONSTRUCTION.

B.M. ELEV.		CONSTRUCTION COMPLETION DATE: YYYY MM DD	
0	ISSUED FOR TENDER	18/04/17	KJM
NO.	REVISIONS	DATE	BY

TETRA TECH

DESIGNED BY: MAL	CHECKED BY: TRC
DRAWN BY: GMD	APPROVED BY: KJM
SCALE: HORIZONTAL 1:250 VERTICAL 1:50	RELEASED FOR CONSTRUCTION: KAS ZUREK
DATE: 2018 04 16	DATE: 18/04/16

ENGINEER'S SEAL
ORIGINAL DRAWING REVISION "0" SEALED BY
K.J. McRAE
18/04/16
CONSULTANT DRAWING NUMBER
1800120500-DWG-C0011

THE CITY OF WINNIPEG
WATER AND WASTE DEPARTMENT
ENGINEERING DIVISION
2018 WATERMAIN RENEWALS
CONTRACT 8
KILLARNEY AVENUE
38m EAST OF GREYFRIARS ROAD TO
64m EAST OF ACADIA BAY (WEST LEG)

SHEET 11 OF 17
CITY DRAWING NUMBER
D-15096