

P:\2018\1800598\Local Streets Program\18-PP-05000\_CAD\07\_Sheets\PAET A1 1800598-Kernaghan-PP-05.dwg Last Saved: 3/26/2018 12:27 PM by diane Plotted: 3/26/2018 12:57 PM by Dave Lane

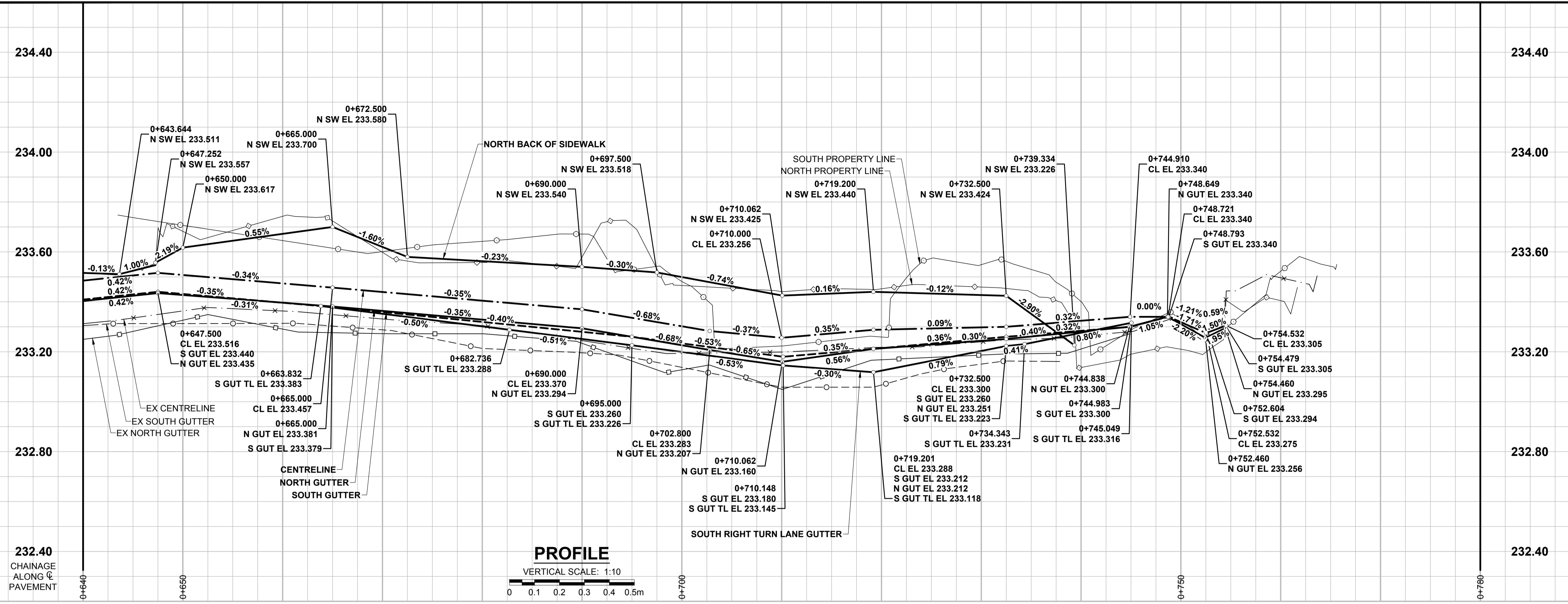

- NOTES**
- ADJUST MH AND CB RIMS TO NEW GRADES.
  - LAMP STANDARDS, HYDRO POLES, AND ANCHORS THAT REQUIRE TEMPORARY SUPPORT, REMOVAL OR REPLACEMENT TO BE DONE SO AT THE EXPENSE OF THE CONTRACTOR AS NECESSARY.
  - CONTRACTOR TO REGRADE/RENEW EXISTING PRIVATE SIDEWALKS TO LIMITS AS SHOWN. SIDEWALKS TO BE RENEWED WITH CONCRETE UNLESS NOTED OTHERWISE.
  - CONTRACTOR TO TAKE PRECAUTIONARY STEPS TO PROTECT EXISTING TREES WITHIN THE LIMITS OF CONSTRUCTION FROM DAMAGE FROM CONSTRUCTION ACTIVITIES AS OUTLINED IN THE SPECIFICATIONS.
  - CONTRACTOR TO CONFIRM THE LOCATION OF ALL UTILITIES/SERVICES IN THE FIELD PRIOR TO CONSTRUCTION.
  - MODIFIED BARRIER CURB TO BE USED AT ALL INTERSECTION RADII, BACK LANE RADII AND BULLNOSES.
  - CONTRACTOR TO OVERLAY DRIVEWAYS TO ENSURE POSITIVE DRAINAGE TO NEW STREET GRADES. FINAL LIMITS TO BE DETERMINED IN THE FIELD BY CONTRACT ADMINISTRATOR.
  - CB SD-023 & SD-024 OFFSETS ARE DIMENSIONED TO BOC. CB SD-025 OFFSETS ARE DIMENSIONED OIC.
  - REFER TO BID OPPORTUNITY FOR DETAILS REGARDING TRAFFIC MANAGEMENT.
  - ADD 200.000 m TO ABBREVIATED ELEVATIONS TO OBTAIN GEODETIC ELEVATIONS.

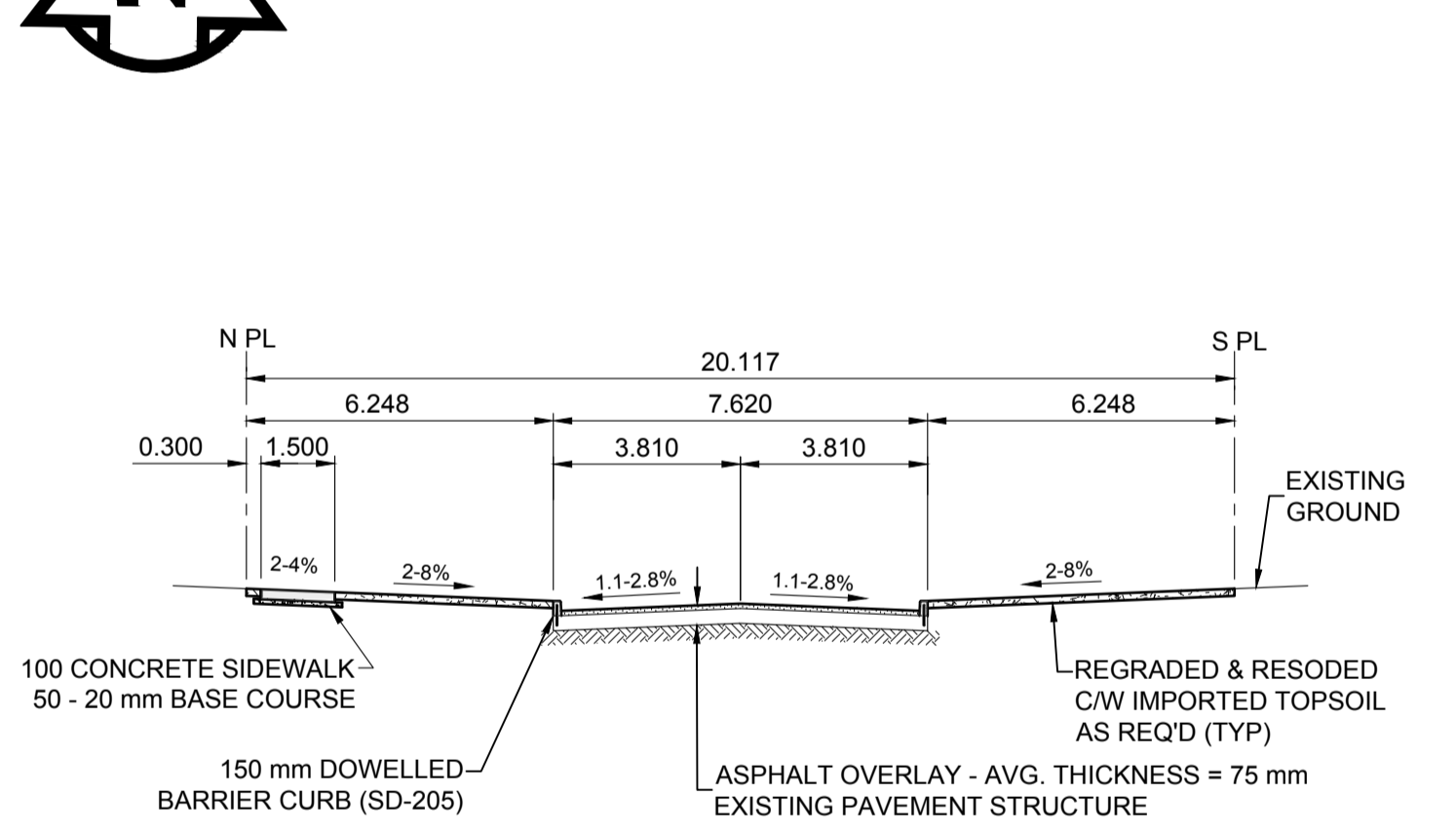
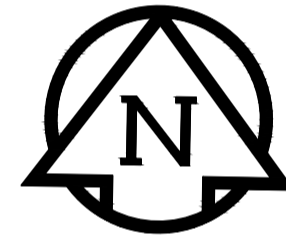
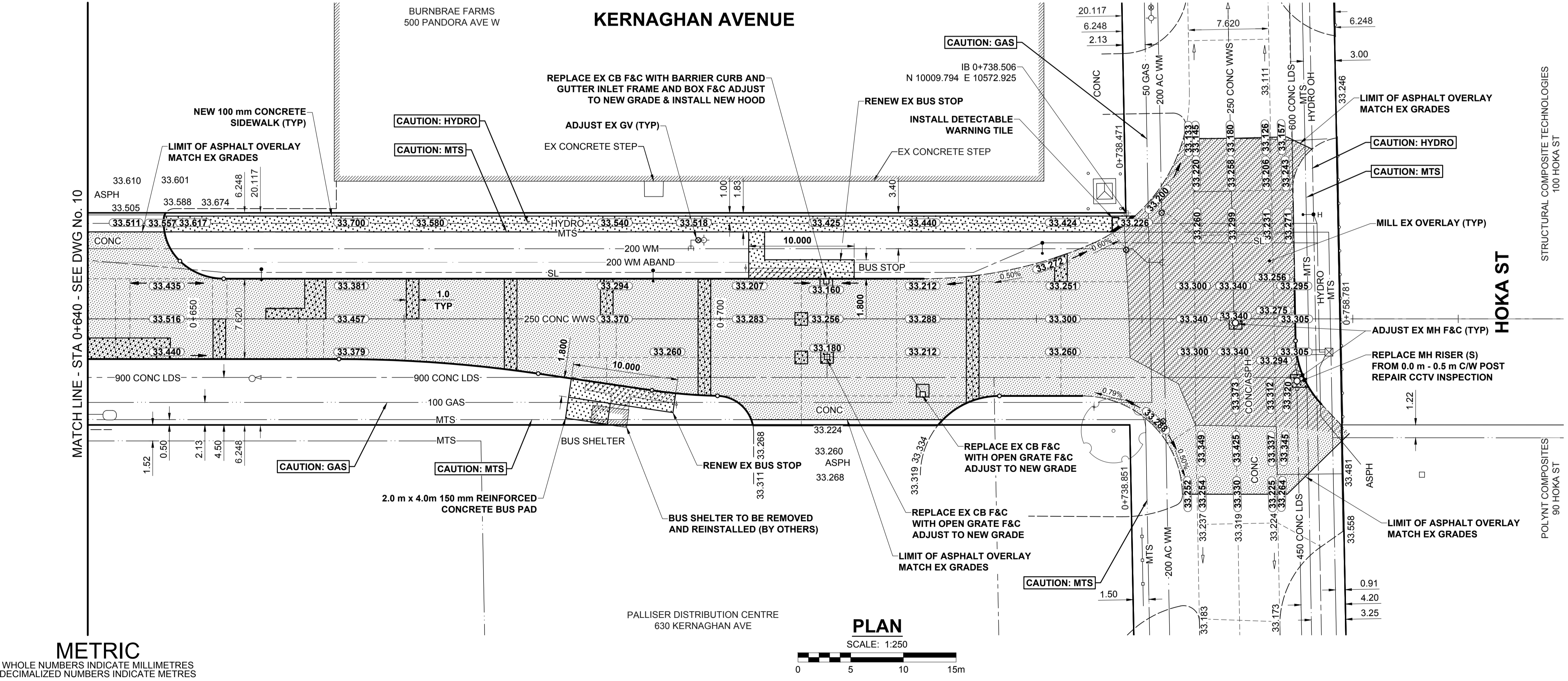

**TYPICAL PAVEMENT SECTION**  
ASPHALT REHABILITATION  
SCALE: NTS

**METRIC**  
WHOLE NUMBERS INDICATE MILLIMETRES  
DECIMALIZED NUMBERS INDICATE METRES

	GAS		MANHOLE		CONCRETE PAVEMENT
	MTS HANDWELL/PEDESTAL		CATCH BASIN/CATCH PIT		CONC SIDEWALK/MEDIAN
	HYDRO HANDWELL/CABINET		CURB INLET WITH BOX		ASPHALT PAVEMENT
	CATV/FIBRE OPTIC		TREE		PAVING STONE
	TRAFFIC SIGNALS/PIT		TEST HOLE		GRAVEL
	LAND DRAINAGE SEWER		PROPERTY LINE		RAMP CURB
	SANITARY/COMBINED SEWER		SURVEY BAR		PLANING/REMOVAL
	CB LEAD/SSP/DCP		FENCE		
	WATERMAIN		BOC/EDGE OF PAVEMENT		
	SUBDRAIN		ELEVATION (33.333)		
	DITCH		TRAFFIC SIGN		
	EXISTING		LEGEND - PLAN		EXISTING
	NEW		LEGEND - PLAN		NEW

**LOCATION APPROVED**  
UNDERGROUND STRUCTURES

SUPR. U/G STRUCTURES COMMITTEE DATE

**NOTE:**  
LOCATION OF UNDERGROUND STRUCTURES AS SHOWN ARE BASED ON THE BEST INFORMATION AVAILABLE BUT NO GUARANTEE IS GIVEN THAT ALL EXISTING UTILITIES ARE SHOWN OR THAT THE GIVEN LOCATIONS ARE EXACT. CONFIRMATION OF EXISTENCE AND EXACT LOCATION OF ALL SERVICES MUST BE OBTAINED FROM THE INDIVIDUAL UTILITIES BEFORE PROCEEDING WITH CONSTRUCTION.

BM 30-003	Tilt in W. Conc. foundation of Transcona Public Safety Building, Plessis Rd. & Pandora Ave., 1.7 m S. of N.W. Cor. of Bldg.	ELEV 234.065 m												
<table border="1"> <tr> <th>No.</th> <th>REVISIONS</th> <th>DATE</th> <th>BY</th> </tr> <tr> <td>B</td> <td>ISSUED FOR TENDER</td> <td>18/03/27</td> <td>RPB</td> </tr> <tr> <td>A</td> <td>ISSUED FOR CLIENT REVIEW</td> <td>18/02/09</td> <td>RPB</td> </tr> </table>			No.	REVISIONS	DATE	BY	B	ISSUED FOR TENDER	18/03/27	RPB	A	ISSUED FOR CLIENT REVIEW	18/02/09	RPB
No.	REVISIONS	DATE	BY											
B	ISSUED FOR TENDER	18/03/27	RPB											
A	ISSUED FOR CLIENT REVIEW	18/02/09	RPB											

	<b>MORRISON HERSHFIELD</b>
DESIGNED BY	RPB
CHECKED BY	WRJ
DRAWN BY	KMB
APPROVED BY	BWB
RELEASED FOR CONSTRUCTION	
HOR SCALE	1:250
VERT SCALE	1:10
DATE	18/02/01

PROFESSIONAL'S SEAL

**PRELIMINARY DRAWING**

NOT TO BE USED FOR CONSTRUCTION

CONSULTANT FILE NAME  
1800598-Kernaghan-PP-05.dwg

**THE CITY OF WINNIPEG**  
PUBLIC WORKS DEPARTMENT  
ENGINEERING DIVISION

**2018 LOCAL STREETS PACKAGE**  
**KERNAGHAN AVENUE**  
**PLESSIS RD TO HOKA ST**  
REHABILITATION  
PAVING AND GRADING  
STA 0+640 TO HOKA ST

CITY DRAWING NUMBER: N/A  
SHEET 11 OF 18  
DRAWING No. 11

BID OPPORTUNITY No. 123-2017

