

ISO A1 - 594mm x 841mm

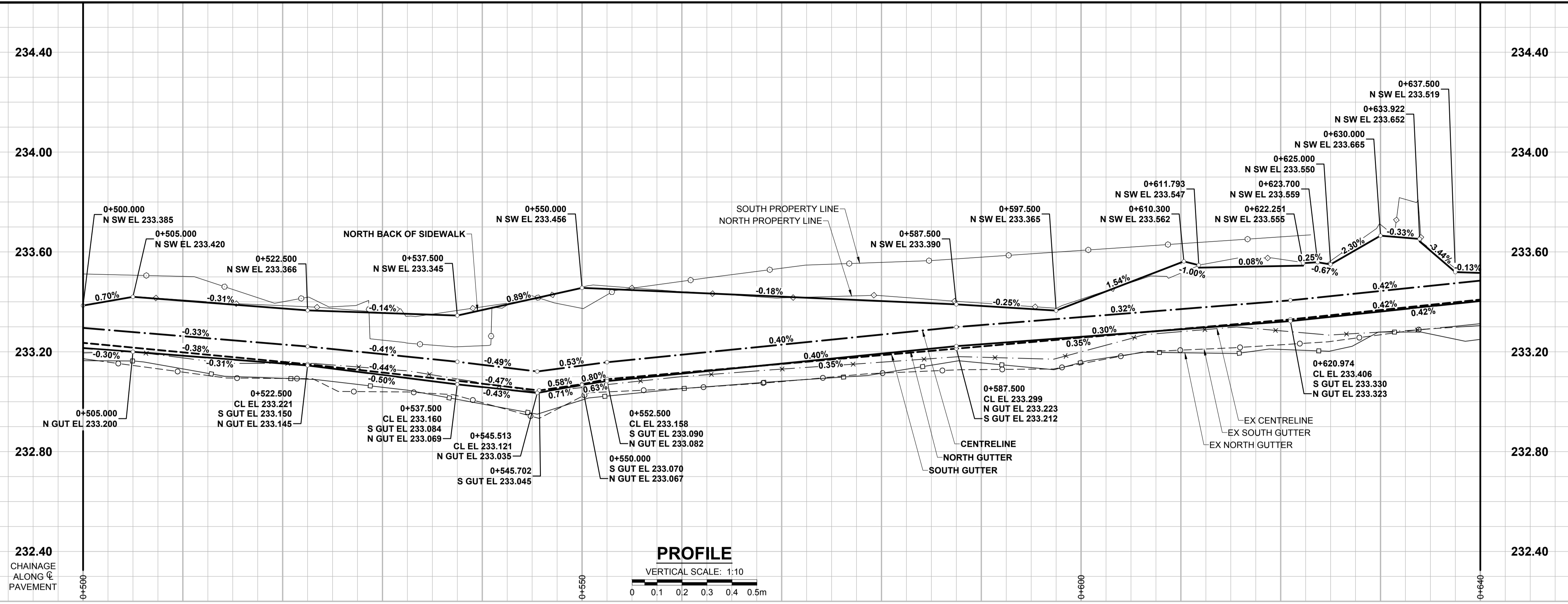

- NOTES**
- ADJUST MH AND CB RIMS TO NEW GRADES.
 - LAMP STANDARDS, HYDRO POLES, AND ANCHORS THAT REQUIRE TEMPORARY SUPPORT, REMOVAL OR REPLACEMENT, TO BE DONE SO AT THE EXPENSE OF THE CONTRACTOR AS NECESSARY.
 - CONTRACTOR TO REGRADE/RENEW EXISTING PRIVATE SIDEWALKS TO LIMITS AS SHOWN. SIDEWALKS TO BE RENEWED WITH CONCRETE UNLESS NOTED OTHERWISE.
 - CONTRACTOR TO TAKE PRECAUTIONARY STEPS TO PROTECT EXISTING TREES WITHIN THE LIMITS OF CONSTRUCTION FROM DAMAGE FROM CONSTRUCTION ACTIVITIES AS OUTLINED IN THE SPECIFICATIONS.
 - CONTRACTOR TO CONFIRM THE LOCATION OF ALL UTILITIES/SERVICES IN THE FIELD PRIOR TO CONSTRUCTION.
 - MODIFIED BARRIER CURB TO BE USED AT ALL INTERSECTION RADII, BACK LANE RADII AND BULLNOSES.
 - CONTRACTOR TO OVERLAY DRIVEWAYS TO ENSURE POSITIVE DRAINAGE TO NEW STREET GRADES. FINAL LIMITS TO BE DETERMINED IN THE FIELD BY CONTRACT ADMINISTRATOR.
 - CB SD-023 & SD-024 OFFSETS ARE DIMENSIONED TO BOC. CB SD-025 OFFSETS ARE DIMENSIONED OIC.
 - REFER TO BID OPPORTUNITY FOR DETAILS REGARDING TRAFFIC MANAGEMENT.
 - ADD 200.000 m TO ABBREVIATED ELEVATIONS TO OBTAIN GEODETIC ELEVATIONS.

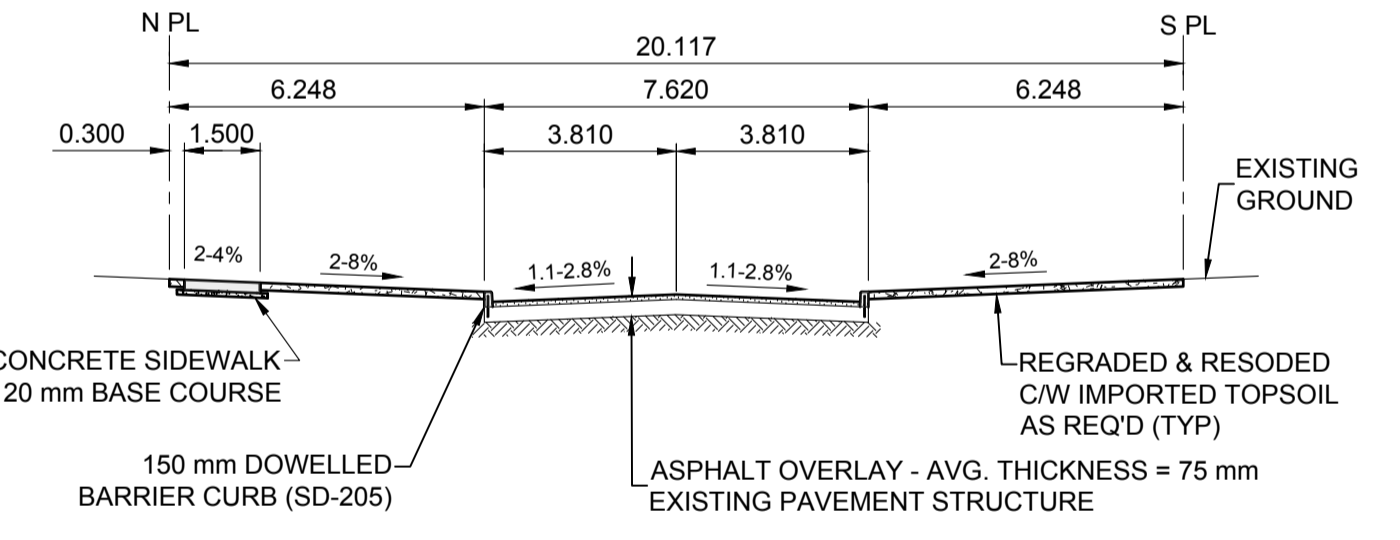
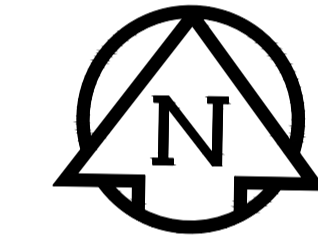
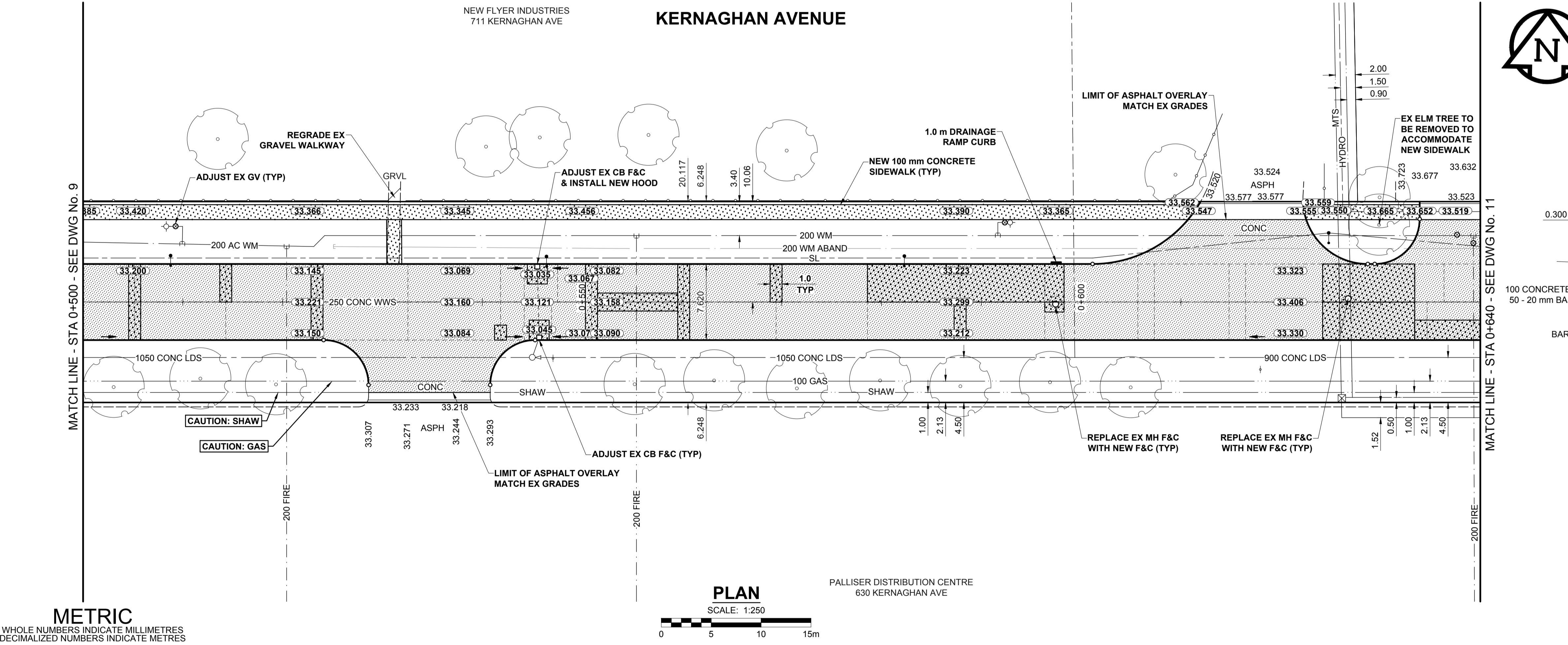

TYPICAL PAVEMENT SECTION
ASPHALT REHABILITATION
SCALE: NTS

METRIC
WHOLE NUMBERS INDICATE MILLIMETRES
DECIMALIZED NUMBERS INDICATE METRES

---	GAS	○	MANHOLE	●	CONCRETE PAVEMENT	▨	LOCATION APPROVED
---○---	MTS HANDWELL/PEDESTAL	□	CATCH BASIN/CATCH PIT	■	CONC SIDEWALK/MEDIAN	▩	UNDERGROUND STRUCTURES
---○---	HYDRO HANDWELL/CABINET	△	CURB INLET WITH BOX	▲	ASPHALT PAVEMENT	▨	
---	CATV/FIBRE OPTIC	○	TREE	○	PAVING STONE	▨	
---	TRAFFIC SIGNALS/PIT	⊕	TEST HOLE	⊕	GRAVEL	▨	
---	LAND DRAINAGE SEWER	⊕	PROPERTY LINE	---	RAMP CURB	▨	
---	SANITARY/COMBINED SEWER	⊕	SURVEY BAR	---	PLANING/REMOVAL	▨	
---	CB LEAD/SSP/DCP	⊕	FENCE	---	BOC/EDGE OF PAVEMENT	---	
---	WATERMAIN	---	BOC/EDGE OF PAVEMENT	---	ELEVATION	(33.333)	
---	SUBDRAIN	---	ELEVATION	(33.333)	TRAFFIC SIGN	---	
---	DITCH	---	TRAFFIC SIGN	---			
---	EXISTING	---	LEGEND - PLAN	---	EXISTING	---	
---	NEW	---	LEGEND - PLAN	---	NEW	---	

LOCATION APPROVED
UNDERGROUND STRUCTURES

DATE: _____

NOTE:
LOCATION OF UNDERGROUND STRUCTURES AS SHOWN ARE BASED ON THE BEST INFORMATION AVAILABLE BUT NO GUARANTEE IS GIVEN THAT ALL EXISTING UTILITIES ARE SHOWN OR THAT THE GIVEN LOCATIONS ARE EXACT. CONFIRMATION OF EXISTENCE AND EXACT LOCATION OF ALL SERVICES MUST BE OBTAINED FROM THE INDIVIDUAL UTILITIES BEFORE PROCEEDING WITH CONSTRUCTION.

BM 30-003	ELEV 234.065 m	Toll. in W. Conc. foundation of Transcona Public Safety Building, Plessis Rd. & Pandora Ave., 1.7 m S. of N.W. Cor. of Bldg.
B	ISSUED FOR TENDER	18/03/27 RPB
A	ISSUED FOR CLIENT REVIEW	18/02/09 RPB
No.	REVISIONS	YY/MM/DD BY

DESIGNED BY	RPB	CHECKED BY	WRJ
DRAWN BY	KMB	APPROVED BY	BWB
HOR SCALE	1:250	RELEASED FOR CONSTRUCTION	
VERT SCALE	1:10	DATE	18/02/01

PRELIMINARY DRAWING

NOT TO BE USED FOR CONSTRUCTION

CONSULTANT FILE NAME
1800598-Kernaghan-PP-04.dwg

THE CITY OF WINNIPEG
PUBLIC WORKS DEPARTMENT
ENGINEERING DIVISION

2018 LOCAL STREETS PACKAGE
KERNAGHAN AVENUE
PLESSIS RD TO HOKA ST
REHABILITATION
PAVING AND GRADING
STA 0+500 TO STA 0+640

CITY DRAWING NUMBER: N/A
SHEET 10 OF 18
DRAWING No. 10

BID OPPORTUNITY No. 123-2017

P:\2018\1800598\Local Streets Program (18-05-05000_CAD)\07_Sheets\PAET A1 1800598-Kernaghan-PP-04.dwg Last Saved: 3/26/2018 12:28 PM by diane P:\2018\1800598-Kernaghan-PP-04.dwg