

ISO A1 - 594mm x 841mm

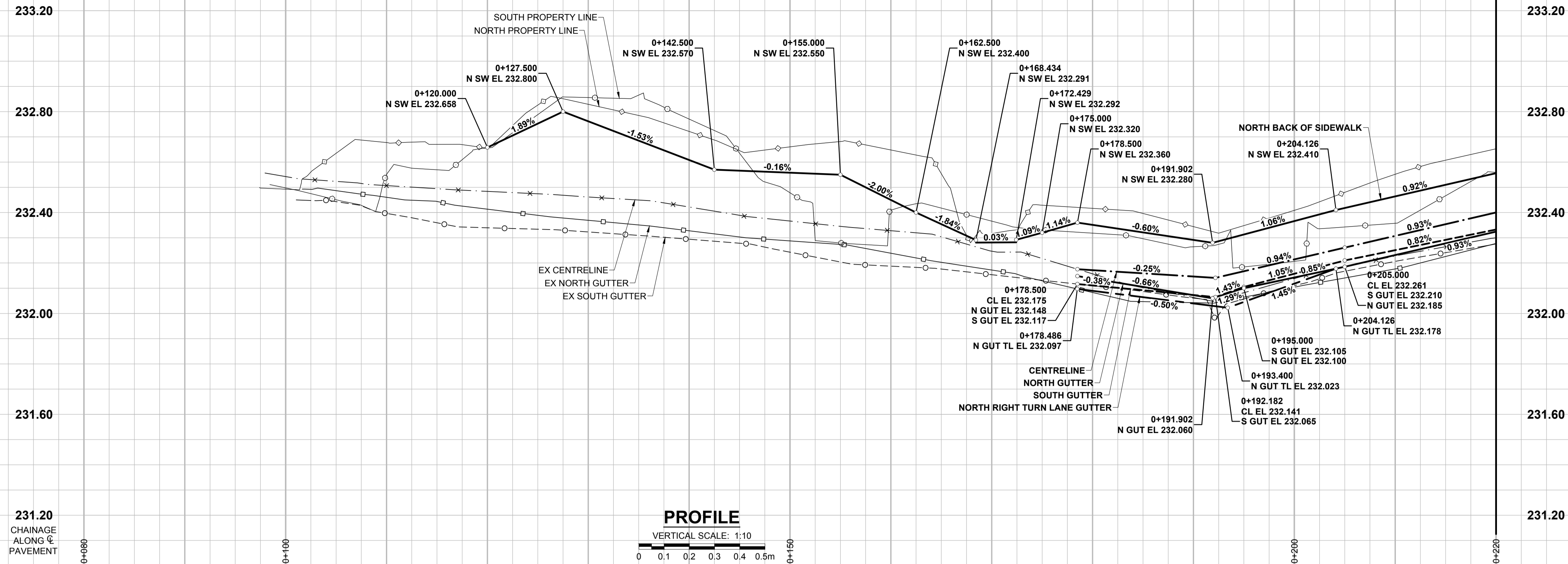

- NOTES**
- ADJUST MH AND CB RIMS TO NEW GRADES.
  - LAMP STANDARDS, HYDRO POLES, AND ANCHORS THAT REQUIRE TEMPORARY SUPPORT, REMOVAL OR REPLACEMENT, TO BE DONE SO AT THE EXPENSE OF THE CONTRACTOR AS NECESSARY.
  - CONTRACTOR TO REGRADE/RENEW EXISTING PRIVATE SIDEWALKS TO LIMITS AS SHOWN. SIDEWALKS TO BE RENEWED WITH CONCRETE UNLESS NOTED OTHERWISE.
  - CONTRACTOR TO TAKE PRECAUTIONARY STEPS TO PROTECT EXISTING TREES WITHIN THE LIMITS OF CONSTRUCTION FROM DAMAGE FROM CONSTRUCTION ACTIVITIES AS OUTLINED IN THE SPECIFICATIONS.
  - CONTRACTOR TO CONFIRM THE LOCATION OF ALL UTILITIES/SERVICES IN THE FIELD PRIOR TO CONSTRUCTION.
  - MODIFIED BARRIER CURB TO BE USED AT ALL INTERSECTION RADII, BACK LANE RADII AND BULLNOSES.
  - CONTRACTOR TO OVERLAY DRIVEWAYS TO ENSURE POSITIVE DRAINAGE TO NEW STREET GRADES. FINAL LIMITS TO BE DETERMINED IN THE FIELD BY CONTRACT ADMINISTRATOR.
  - CB SD-023 & SD-024 OFFSETS ARE DIMENSIONED TO BOC. CB SD-025 OFFSETS ARE DIMENSIONED OIC.
  - REFER TO BID OPPORTUNITY FOR DETAILS REGARDING TRAFFIC MANAGEMENT.
  - ADD 200.000 m TO ABBREVIATED ELEVATIONS TO OBTAIN GEODETIC ELEVATIONS.

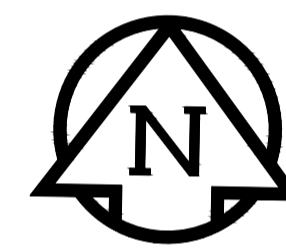
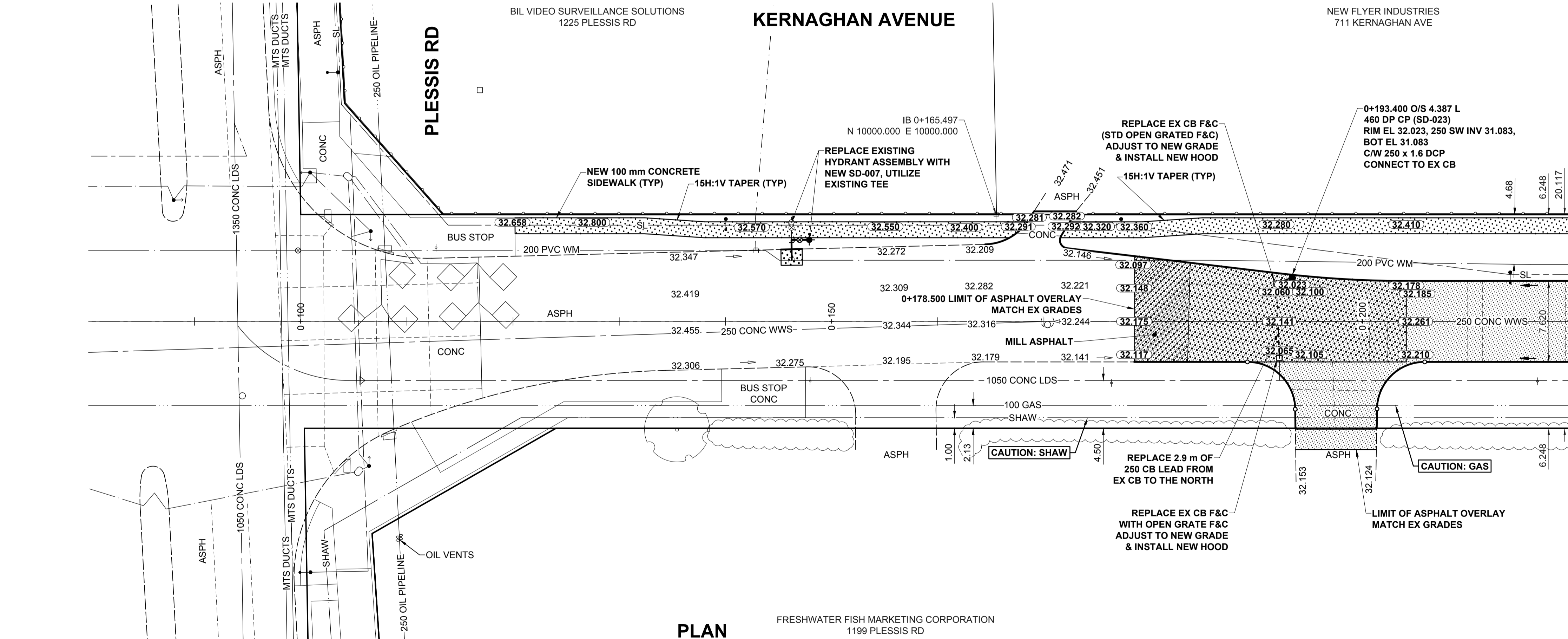

MATCH LINE - STA 0+220 - SEE DWG NO. 8

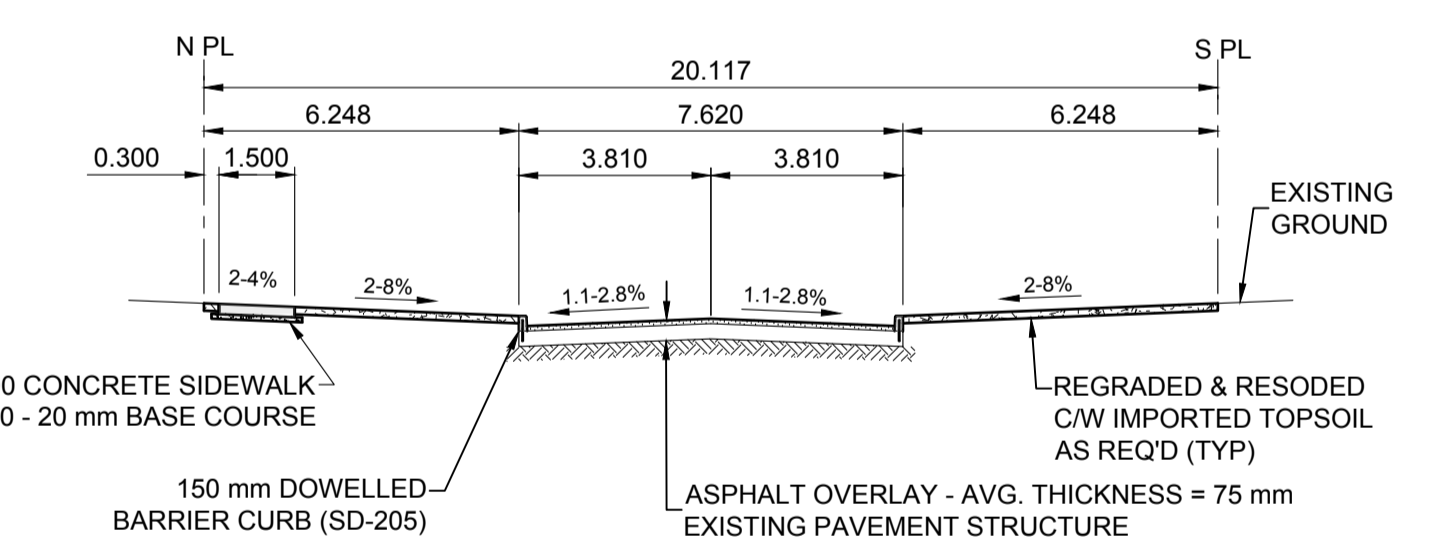

**TYPICAL PAVEMENT SECTION**  
ASPHALT REHABILITATION  
SCALE: NTS

**METRIC**  
WHOLE NUMBERS INDICATE MILLIMETRES  
DECIMALIZED NUMBERS INDICATE METRES

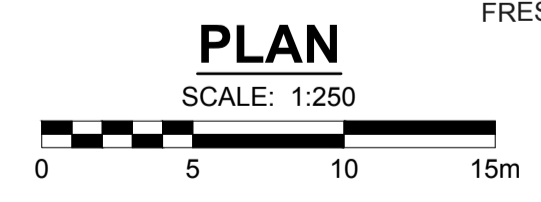

EXISTING	LEGEND - PLAN	NEW	EXISTING	LEGEND - PLAN	NEW	EXISTING	LEGEND - PLAN	NEW	
	GAS		MANHOLE		CONCRETE PAVEMENT		LOCATION APPROVED UNDERGROUND STRUCTURES		MTS HANDWELL/PEDESTAL
	HYDRO HANDWELL/CABINET		CATCH BASIN/CATCH PIT		CONC SIDEWALK/MEDIAN		SUPR. LIG STRUCTURES COMMITTEE		CATV/FIBRE OPTIC
	TRAFFIC SIGNALS/PIT		TREE		ASPHALT PAVEMENT		<b>NOTE:</b> LOCATION OF UNDERGROUND STRUCTURES AS SHOWN ARE BASED ON THE BEST INFORMATION AVAILABLE BUT NO GUARANTEE IS GIVEN THAT ALL EXISTING UTILITIES ARE SHOWN OR THAT THE GIVEN LOCATIONS ARE EXACT. CONFIRMATION OF EXISTENCE AND EXACT LOCATION OF ALL SERVICES MUST BE OBTAINED FROM THE INDIVIDUAL UTILITIES BEFORE PROCEEDING WITH CONSTRUCTION.		LAND DRAINAGE SEWER
	SANITARY/COMBINED SEWER		TEST HOLE		PAVING STONE		DATE		CB LEAD/SSP/DCP
	WATERMAIN		PROPERTY LINE		GRAVEL		RAMP CURB		SUBDRAIN
	DITCH		SURVEY BAR		PLANING/REMOVAL		ELEVATION (33.333)		TRAFFIC SIGN
	LEGEND - PLAN		BOC/EDGE OF PAVEMENT		NEW		ELEVATION (33.333)		LEGEND - PLAN
	LEGEND - PLAN		FENCE		NEW		ELEVATION (33.333)		LEGEND - PLAN
	LEGEND - PLAN		BOC/EDGE OF PAVEMENT		EXISTING		ELEVATION (33.333)		LEGEND - PLAN
	LEGEND - PLAN		FENCE		NEW		ELEVATION (33.333)		LEGEND - PLAN

**LOCATION APPROVED UNDERGROUND STRUCTURES**

SUPR. LIG STRUCTURES COMMITTEE DATE

**NOTE:**  
LOCATION OF UNDERGROUND STRUCTURES AS SHOWN ARE BASED ON THE BEST INFORMATION AVAILABLE BUT NO GUARANTEE IS GIVEN THAT ALL EXISTING UTILITIES ARE SHOWN OR THAT THE GIVEN LOCATIONS ARE EXACT. CONFIRMATION OF EXISTENCE AND EXACT LOCATION OF ALL SERVICES MUST BE OBTAINED FROM THE INDIVIDUAL UTILITIES BEFORE PROCEEDING WITH CONSTRUCTION.

NO.	REVISIONS	DATE	BY
B	ISSUED FOR TENDER	18/03/27	RPB
A	ISSUED FOR CLIENT REVIEW	18/02/09	RPB

DESIGNED BY	CHECKED BY	DATE
RPB	WRJ	18/02/01
KMB	BWB	

PROFESSIONAL'S SEAL

**PRELIMINARY DRAWING**

NOT TO BE USED FOR CONSTRUCTION

CONSULTANT FILE NAME  
1800598-Kernaghan-PP-01.dwg

**THE CITY OF WINNIPEG**  
PUBLIC WORKS DEPARTMENT  
ENGINEERING DIVISION

**2018 LOCAL STREETS PACKAGE**  
**KERNAGHAN AVENUE**  
PLESSIS RD TO HOKA ST  
REHABILITATION  
PAVING AND GRADING  
PLESSIS RD TO STA 0+220

CITY DRAWING NUMBER: N/A  
SHEET 7 OF 18  
DRAWING No. 7

BID OPPORTUNITY No. 123-2017



P:\2018\1800598\Local Streets Program\18-PP-0000\_CADD\07\_Sheets\PAET A1 1800598-Kernaghan-PP-01.dwg - Last Saved: 3/26/2018 12:30 PM by diane - Plotted: 3/26/2018 12:55 PM by Dave Lane