

- CONSTRUCTION NOTES**
1. REMOVE CURB INLET AND INSTALL NEW CATCH PIT WITH CURB & GUTTER INLET FRAME (SD-023), AND CONNECT TO EXISTING CATCH BASIN (CW 2130)
 2. INSTALL NEW 1800 CATCHBASIN WITH CURB & GUTTER INLET (SD-024) CONNECT TO EXISTING CB LEAD AS PER CW 2130
 3. ABANDON EXISTING CATCH BASIN AS PER CW 2130
 4. REMOVE EXISTING AND CONSTRUCT NEW 100mm CONCRETE SIDEWALK (SD-228A)
 5. MILL EXISTING ASPHALT PAVEMENT
 6. LIMIT OF ASPHALT OVERLAY
 7. REMOVE EXISTING CONCRETE SIDEWALK
 8. INSTALL NEW 1800 CATCHBASIN WITH CURB & GUTTER INLET (SD-024) CONNECT TO 450 COMBINED SEWER WITH 250 PVC PIPE AS PER CW 2130
 9. REGRADE CONCRETE PAVERS

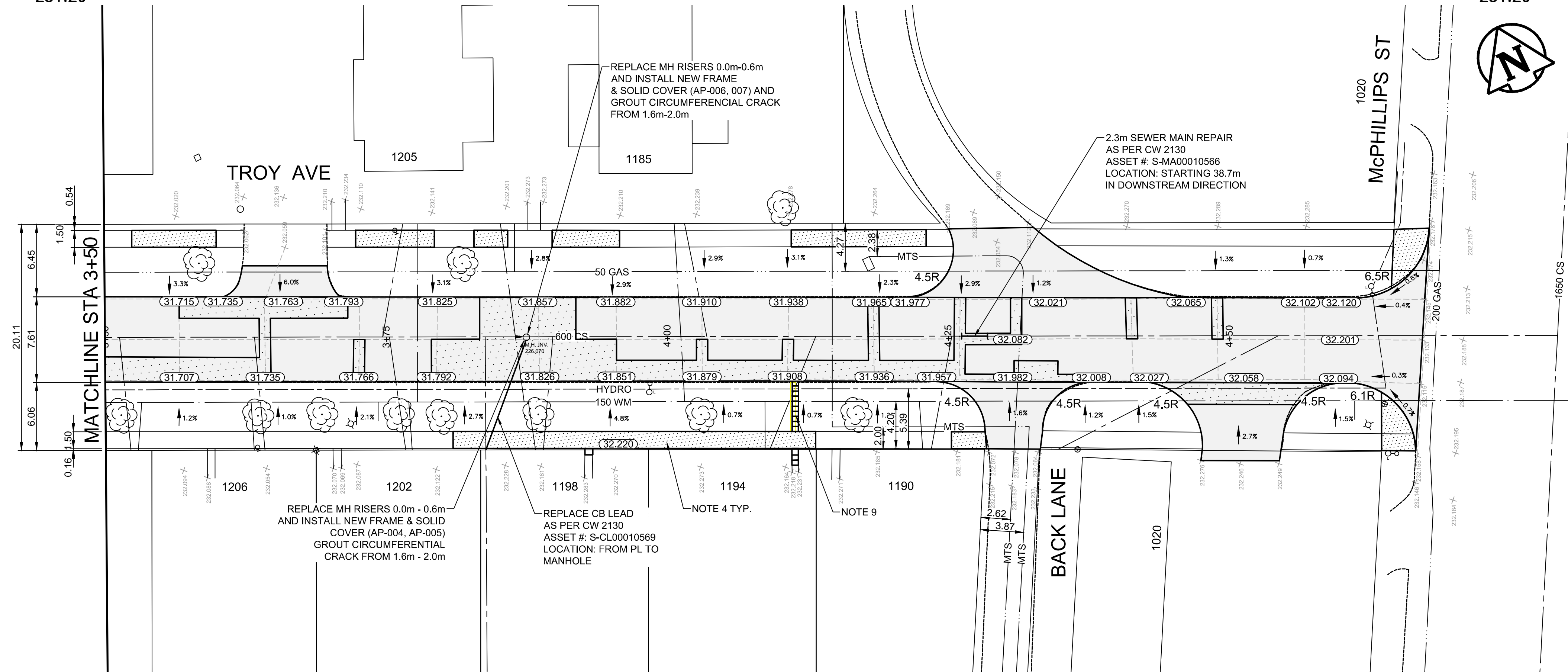

- GENERAL NOTES**
- A. PAVEMENT DIMENSIONS ARE TO BACK OF CURB
 - B. ALL CURB RADII UNDER 15.0m SHALL BE MODIFIED
 - C. ADD 200.000m TO ALL DESIGN ELEVATION TO OBTAIN GEODETIC ELEVATIONS
 - D. CURB REPLACEMENT AS DIRECTED BY CONTRACT ADMINISTRATOR
 - E. PAVEMENT REPAIRS SHOWN ARE ONLY A REPRESENTATIVE SAMPLE OF THE TENDERED QUANTITIES
 - F. ASPHALT TIE-INS ON APPROACHES TO BE DETERMINED IN THE FIELD BY THE CONTRACT ADMINISTRATOR
 - G. INSTALL DETECTIBLE WARNING SURFACE TILES AT CURB RAMPS AS PER CW 3326

PRELIMINARY
NOT TO BE USED FOR
CONSTRUCTION

METRIC
WHOLE NUMBERS INDICATE MILLIMETERS
DECIMALIZED NUMBERS INDICATE METERS

EXISTING	LEGEND - PLAN	PROPOSED	EXISTING	LEGEND - PLAN	PROPOSED	EXISTING	LEGEND - PROFILE	PROPOSED
⊕	HYDRANT	◆	---	LDS/WWS	---	▒	CONCRETE	▒
⊗	VALVE	●	---	WATERMAIN	---	▒	CONCRETE SIDEWALK	▒
○	CURB STOP	●	---	GAS	---	▒	ASPHALT	▒
○	MANHOLE	●	---	TRAFFIC SIGNALS	---	---	---	---
□	CATCH BASIN	■	---	HYDRO/STREET LIGHT	---	---	---	---
△	CURB INLET	▲	---	MTS	---	---	---	---
○	HYDRO POLE	●	---	CURB RENEWAL	---	---	---	---
○	LIGHT STANDARD	●	---	PROPERTY LINE	---	---	---	---
○	TRAFFIC SIGNAL POLE	●	---	RAMP CURB	---	---	---	---
+	SURVEY BAR	+	---	ELEVATIONS	(31.000)	---	---	---
⊕	GEODETIC BENCH MARK	⊕	---	TREE	---	---	---	---

LOCATION APPROVED

IB NW CORNER OF 1202 TROY AVE
231.989

ENGINEERING DIVISION
TECHNOLOGY SERVICES BRANCH
106 - 1155 PACIFIC AVE

DESIGNED BY: T.K. CHECKED BY: E.H.
DRAWN BY: A.T. APPROVED BY:

HOR. SCALE: 1 : 250
VERTICAL: 1 : 10
DATE: 2018/02/27

1. SUBMIT FOR PLAN APPROVAL 18/02/18 T.K.
NO. REVISIONS DATE BY

ENGINEERING DIVISION
TECHNOLOGY SERVICES BRANCH
106 - 1155 PACIFIC AVE

DESIGNED BY: T.K. CHECKED BY: E.H.
DRAWN BY: A.T. APPROVED BY:

HOR. SCALE: 1 : 250
VERTICAL: 1 : 10
DATE: 2018/02/27

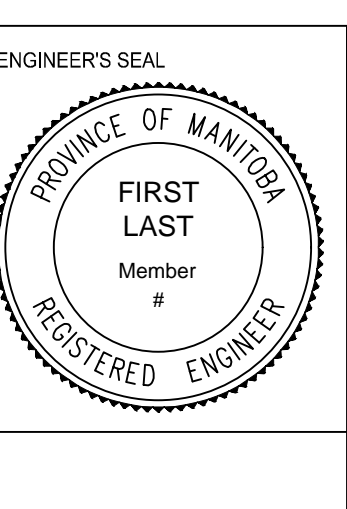

THE CITY OF WINNIPEG
PUBLIC WORKS DEPARTMENT

TROY AVE
FROM FIFE ST TO McPHILLIPS ST
ASPHALT OVERLAY AND ASSOCIATED WORKS
FROM STA. 3+50 TO STA. 4+67

CITY DRAWING NUMBER
SE-18-38
SHEET 33 OF 33

3

BID OPPORTUNITY NO. 1-2018