

STA 1+900.00 LOOKING EAST

NOTE:
LOCATIONS ARE APPROXIMATE AND FURTHER INVESTIGATION TO CONFIRM LOCATION MAYBE REQUIRED BY THE CONTRACTOR.

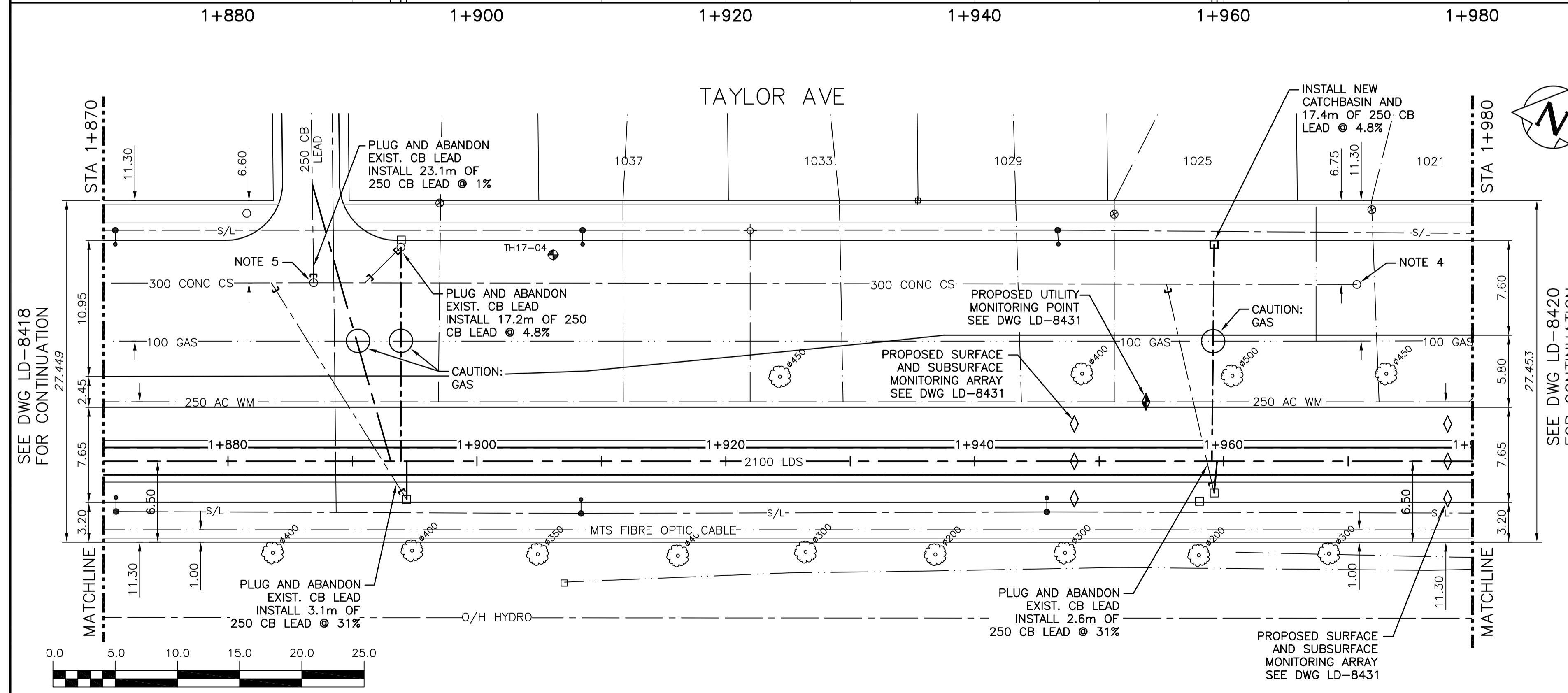

WARNING
IF POWER EQUIPMENT OR EXPLOSIVES ARE TO BE USED FOR EXCAVATION ON THIS PROJECT THE CONTRACTOR MUST:
1) NOTIFY THE GAS COMPANY OF THE PROPOSED LOCATION OF EXCAVATION.
2) TAKE PRECAUTION TO AVOID DAMAGE TO GAS COMPANY INSTALLATIONS.
SEE PROVINCIAL REGULATION 210/72 FOR DETAILS

PROPERTY LIMITS DELINEATION
DELINEATION OF PROPERTY LIMITS AS SHOWN ON THIS DRAWING DOES NOT REPRESENT A "LEGAL SURVEY". CH2M HILL MAKES NO REPRESENTATION OR WARRANTY AS TO THE ACCURACY OF PROPERTY LIMITS DELINEATED ON THIS DRAWING, NOR ON THE DIMENSIONAL ACCURACY OF DRAWING FEATURES RELATIVE TO THOSE PROPERTY LIMITS.

- CONSTRUCTION NOTES:**
- SEWER AND WATER SERVICES SHOWN ON DRAWING ARE APPROXIMATE ONLY.
 - LOCATION OF ALL SEWER AND WATER LINES TO BE CONFIRMED IN FIELD.
 - INSTALL NEW SEWER BY TRENCHLESS METHODS, UNLESS OTHERWISE NOTED.
 - TRAFFIC MANAGEMENT PLAN TO BE IMPLEMENTED AS PER SPECIFICATIONS DURING EACH PHASE OF CONTRACT.
 - REPLACE SLOTTED MANHOLE LID WITH SOLID LID.

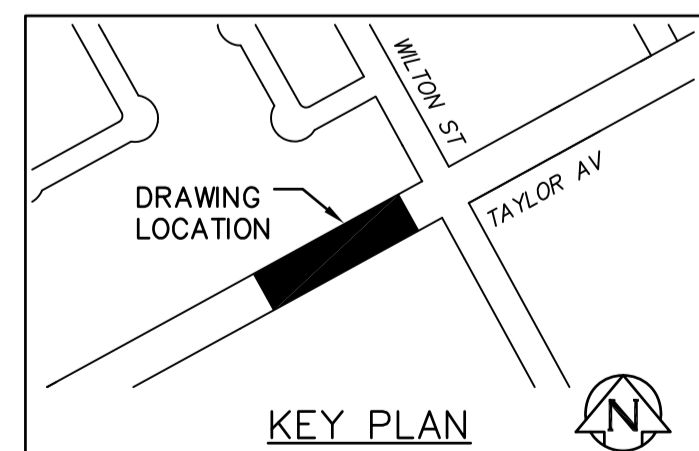

150 WM	WATER MAIN	150 WM	HYDRO	150 WM	WATER MAIN	150 WM
Hydrant	Hydrant	Hydrant	M.T.S.	Hydrant, Valve	Hydrant, Valve	Hydrant, Valve
Valve	Valve	Valve	CONCRETE	LAND DRAINAGE SEWER	LAND DRAINAGE SEWER	LAND DRAINAGE SEWER
300 LDS	LAND DRAINAGE SEWER	300 LDS	ASPHALT	WASTE WATER SEWER	WASTE WATER SEWER	WASTE WATER SEWER
250 WWS	WASTE WATER SEWER	250 WWS	SIDEWALK	CENTRELINE	CENTRELINE	CENTRELINE
Manhole	Manhole	Manhole	PLANNING	NORTH/WEST GUTTER	NORTH/WEST GUTTER	NORTH/WEST GUTTER
Catch Basin	Catch Basin	Catch Basin	PROPERTY LINE	SOUTH/EAST GUTTER	SOUTH/EAST GUTTER	SOUTH/EAST GUTTER
Curb Inlet	Curb Inlet	Curb Inlet	SURVEY BAR	N/W, S/E R'S	N/W, S/E R'S	N/W, S/E R'S
Bend	Bend	Bend	GAS			
Reducer	Reducer	Reducer	CURB STOP			
TEE	TEE	TEE	TEE			
EXISTING	LEGEND-PLAN	PROPOSED	EXISTING	LEGEND-PLAN	PROPOSED	EXISTING

LOCATION APPROVED UNDERGROUND STRUCTURES
SUPV. U/G STRUCTURES COMMITTEE DATE
NOTE:
LOCATION OF UNDERGROUND STRUCTURES AS SHOWN ARE BASED ON THE BEST INFORMATION AVAILABLE BUT NO GUARANTEE IS GIVEN THAT ALL EXISTING UTILITIES ARE SHOWN OR THAT THE GIVEN LOCATIONS ARE EXACT. CONFIRMATION OF EXISTENCE AND EXACT LOCATION OF ALL SERVICES MUST BE OBTAINED FROM THE INDIVIDUAL UTILITIES BEFORE PROCEEDING WITH CONSTRUCTION.

B	ISSUED FOR RFQ	11/2017	JBC
A	ISSUED FOR REVIEW	10/2017	
NO.	REVISIONS	DATE	BY

KGS GROUP CONSULTING ENGINEERS

DESIGNED BY: SDG
DRAWN BY: JBC
CHECKED BY: MD
APPROVED BY: [Signature]

HOR. SCALE: 1:250
VERTICAL: 1:50

RELEASED FOR CONSTRUCTION: [Signature]

ENGINEER'S SEAL

PRELIMINARY NOT FOR CONSTRUCTION

CONSULTANT DRAWING NO. C-245

THE CITY OF WINNIPEG WATER AND WASTE DEPARTMENT

PROJECT TITLE: COCKBURN AND CALROSSIE COMBINED SEWER RELIEF WORKS - CONTRACT 5
TAYLOR AVENUE FROM STA 1+870 TO STA 1+980

SHEET OF 8 OF 25
COMPUTER FILE NAME: C-245.dwg
CITY DRAWING NUMBER: LD-8419