

NOTES:

1. THIS DRAWING INDICATES THE PROPOSED STRUCTURAL SCOPE OF WORK AND HAS GENERALLY BEEN LISTED IN THE ANTICIPATED SEQUENCE OF CONSTRUCTION.
2. STAGING SHOWN ON THIS DRAWING IS SCHEMATIC IN NATURE AND IS SOLELY INTENDED TO GENERALLY PROVIDE GUIDANCE FOR STAGING THE STRUCTURAL WORKS AT A HIGH LEVEL. THIS DRAWING SHALL BE READ IN CONJUNCTION WITH THE TRAFFIC DETOUR STAGING DRAWINGS, CT-013 TO CT-016. THE CONTRACTOR IS ADVISED THAT THE STAGES SHOWN HERE DO NOT NECESSARILY CORRESPOND TO THE STAGES SHOWN ON THE TRAFFIC DETOUR STAGING DRAWINGS AND THEREFORE, THE STRUCTURAL WORKS MAY HAVE TO BE FURTHER STAGED IN ORDER TO COMPLETE THE WORKS.

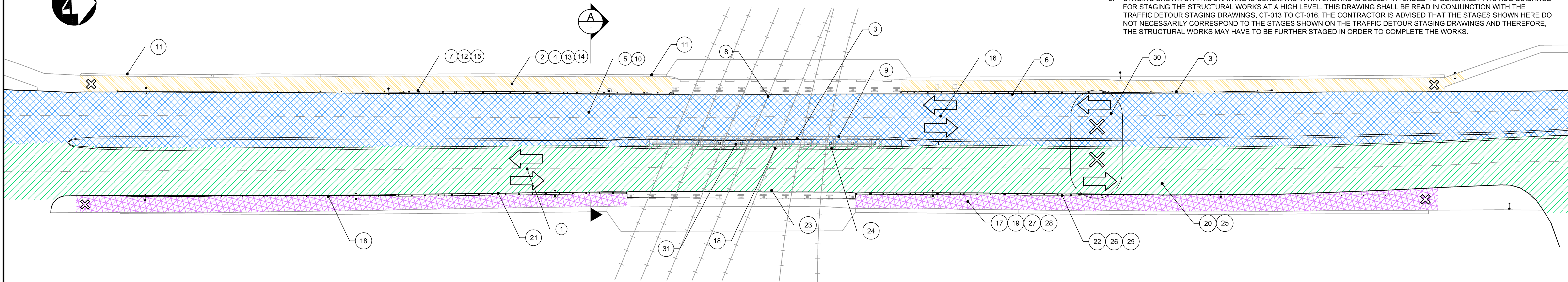

PLAN
1:350

PROPOSED WORKS - STAGE 1	REFERENCE DRAWING NUMBER
1 DIVERT TRAFFIC TO N/B LANES (ONE LANE EACH DIRECTION).	CT-014-015
2 CLOSE S/B SIDEWALK. REMOVE EXISTING PEDESTRIAN HANDRAIL. SALVAGE POSTS AND STORE PANELS FOR REINSTALLATION. NOTE: N/B SIDEWALK SHALL REMAIN OPEN.	CS-003-004
3 REMOVE AND SALVAGE EXISTING ALUMINUM BALANCE BARRIER.	CS-003-004
4 REMOVE PLAIN AND STRUCTURAL CONCRETE SIDEWALK AND EXCAVATE FILL BETWEEN WALLS WHERE SPECIFIED.	CS-003-004
5 REMOVE EXISTING ROADWAY AND EXCAVATE FOR NEW ROADWAY CONSTRUCTION. PARTIALLY REMOVE EXISTING MEDIAN.	CT-003-012
6 REPAIR NEWLY EXPOSED FACE OF SIDEWALK RETAINING WALL (WHERE REQUIRED).	CS-012
7 REMOVE NORTH AND SOUTH ENDS OF EXISTING SIDEWALK RETAINING WALL AS REQUIRED FOR NEW PARAPET WALLS.	CS-003-004
8 REPAIR EXISTING DRAINAGE INLET IN SIDEWALK PEDESTAL.	CS-014
9 NOTCH CPR PEDESTAL.	CS-007
10 CONSTRUCT NEW ROADWAY.	CT-003-012
11 REMOVE SOUTHWEST END OF LARGE SUBWAY WALL AND REPAIR SUBWAY WALL CAP WHERE SPECIFIED.	CS-003, 012
12 CONSTRUCT NEW CONCRETE PARAPET WALL/SIDEWALK C/W BIKE RAIL AND TRANSITIONS.	CS-008-009, 012
13 BACKFILL EXISTING SIDEWALK EXCAVATION WITH CELLULAR CONCRETE.	CS-012
14 CONSTRUCT NEW STRUCTURAL SIDEWALK.	CS-012
15 REINSTALL ALUMINUM PEDESTRIAN HANDRAIL C/W NEW BIKE RAIL THROUGHOUT. ANCHOR AND INSTALL NEW ALUMINUM PEDESTRIAN HANDRAIL ALONG SIDEWALK PEDESTAL THROUGH UNDERPASS.	CS-020-025

PROPOSED WORKS - STAGE 2	REFERENCE DRAWING NUMBER
16 DIVERT TRAFFIC TO NEWLY RECONSTRUCTED S/B LANES (ONE LANE EACH DIRECTION).	CT-016
17 CLOSE N/B SIDEWALK. REMOVE EXISTING PEDESTRIAN HANDRAIL. SALVAGE POSTS AND STORE PANELS FOR REINSTALLATION. NOTE: S/B SIDEWALK SHALL REMAIN OPEN.	CS-005-006
18 REMOVE AND SALVAGE EXISTING ALUMINUM BALANCE BARRIER.	CS-005-006
19 REMOVE PLAIN AND STRUCTURAL CONCRETE SIDEWALK AND EXCAVATE FILL BETWEEN WALLS WHERE SPECIFIED.	CS-005-006
20 REMOVE EXISTING ROADWAY AND EXCAVATE FOR NEW ROADWAY CONSTRUCTION. REMOVE REMAINDER OF EXISTING MEDIAN.	CT-003-012
21 REPAIR NEWLY EXPOSED FACE OF SIDEWALK RETAINING WALL (WHERE REQUIRED).	CS-012
22 REMOVE NORTH AND SOUTH ENDS OF EXISTING SIDEWALK RETAINING WALL AS REQUIRED FOR NEW TRAFFIC BARRIERS.	CS-005-006
23 REPAIR EXISTING DRAINAGE INLET IN SIDEWALK PEDESTAL.	CS-014
24 NOTCH CPR PEDESTAL.	CS-007
25 CONSTRUCT NEW ROADWAY.	CT-003-012
26 CONSTRUCT NEW CONCRETE PARAPET WALL/SIDEWALK C/W BIKE RAIL AND TRANSITIONS.	CS-010-012
27 BACKFILL EXISTING SIDEWALK EXCAVATION WITH CELLULAR CONCRETE.	CS-012
28 CONSTRUCT NEW STRUCTURAL SIDEWALK.	CS-012
29 REINSTALL ALUMINUM PEDESTRIAN HANDRAIL C/W NEW BIKE RAIL THROUGHOUT. ANCHOR AND INSTALL NEW ALUMINUM PEDESTRIAN HANDRAIL ALONG SIDEWALK PEDESTAL THROUGH UNDERPASS.	CS-020-025

PROPOSED WORKS - STAGE 3	REFERENCE DRAWING NUMBER
30 DIVERT N/B & S/B TRAFFIC TO NEWLY RECONSTRUCTED OUTERMOST LANES (ONE LANE EACH DIRECTION).	CT-017
31 CONSTRUCT NEW MEDIAN BARRIER.	CS-015-019

NOTE: STAGE 2 (DIVERSION OF TRAFFIC TO S/B LANES) SHALL NOT OCCUR UNTIL ALL STREET LIGHTING IS OPERATIONAL ALONG THE WEST SIDE.

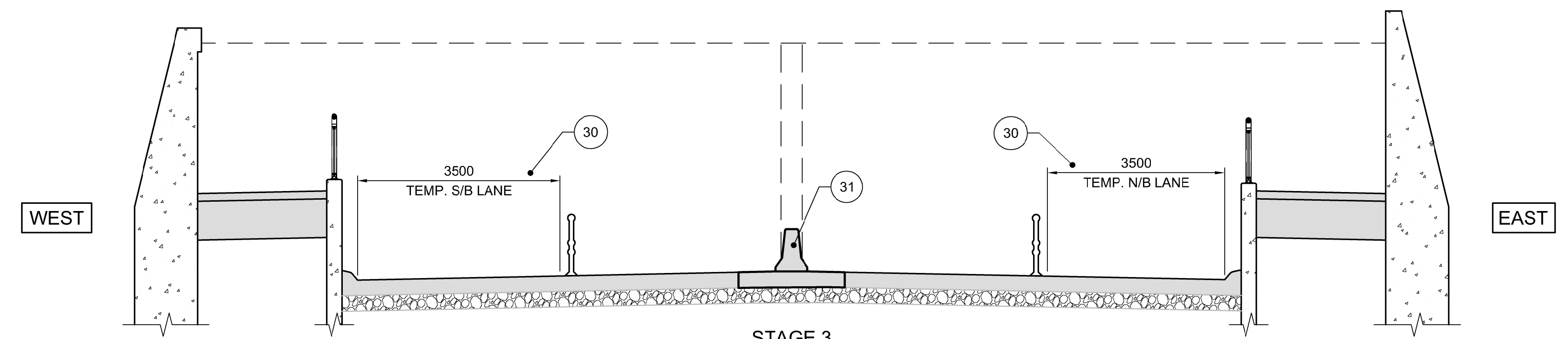
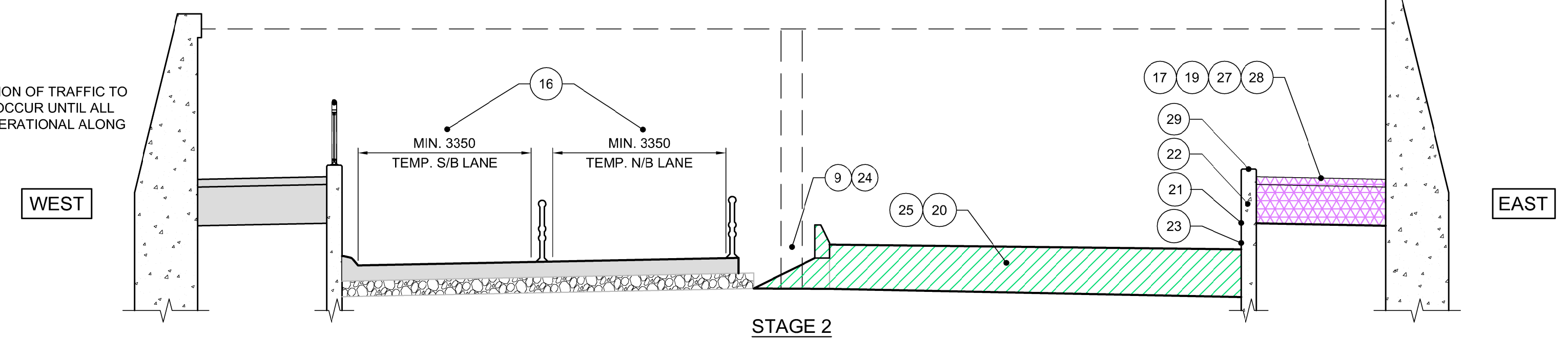
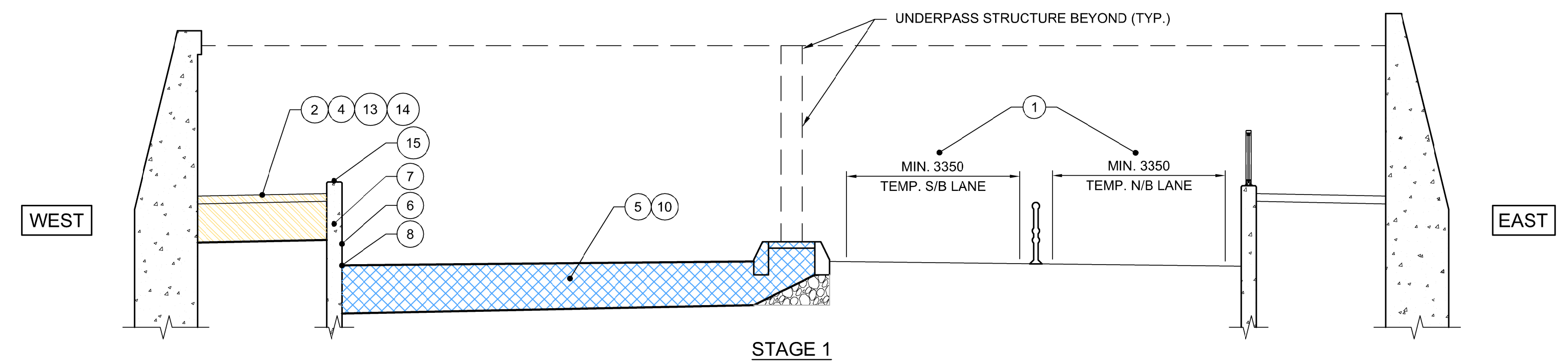

A SECTION
1:75



UNDERGROUND STRUCTURES SUPPLY U/G STRUCTURES DATE	B.M. ELEV.	DESIGNED BY DRA		ENGINEER'S SEAL	
		DRAWN BY KNL			
		CHECKED BY DRA		CONSULTANT PROJECT NUMBER 17-6152	CITY DRAWING NUMBER U212-18CS-002-R0 SHEET 002 OF 026
		APPROVED BY TJP			
LOCATION OF UNDERGROUND STRUCTURES AS SHOWN ARE BASED ON THE BEST INFORMATION AVAILABLE. BUT NO GUARANTEE IS GIVEN THAT ALL EXISTING UTILITIES ARE SHOWN OR THAT THE GIVEN LOCATIONS ARE EXACT. CONFIRMATION OF EXISTENCE AND EXACT LOCATION OF ALL SERVICES MUST BE OBTAINED FROM THE INDIVIDUAL UTILITIES BEFORE PROCEEDING WITH CONSTRUCTION.	0 ISSUED FOR TENDER 18/03/16 TJP NO. REVISIONS DATE BY	HOR. SCALE AS SHOWN VERTICAL AS SHOWN	DATE	2018 REGIONAL STREET RENEWAL PROJECT McPHILLIPS STREET RECONSTRUCTION AND UNDERPASS STRUCTURAL IMPROVEMENTS LOGAN AVENUE TO JARVIS AVENUE	CONSULTANT DRAWING NUMBER CS-002

G:\CAD\176152\Drawings\Structural\Contract\176152-COM-CON-PROPOSED STRUCTURAL WORKS AND CONSTRUCTION STAGING.dwg