

- CONSTRUCTION NOTES:**
- ALL DIMENSIONS ARE TO BACK OF CURB.
  - ISOLATE MISCELLANEOUS ITEMS IN NEW CONCRETE WORKS AS PER SD-228C.
  - LEGAL PLAN AND UNDERGROUND INFORMATION FROM CITY OF WINNIPEG LBIS.
  - CONTRACTOR TO TAKE PRECAUTIONARY STEPS TO AVOID DAMAGE FROM CONSTRUCTION ACTIVITIES TO TREES WITHIN THE LIMITS OF CONSTRUCTION.
  - LOCATION OF EXISTING SERVICES TO BE CONFIRMED IN THE FIELD BY THE CONTRACTOR.
  - CB LEADS TO BE INSTALLED AT MIN. 1.0% SLOPE OR AS DIRECTED BY CONTRACT ADMINISTRATOR.
  - ADJUST EXISTING CATCH BASINS AND MANHOLES AND ISOLATE AS PER SD-220A.
  - PROTECT EXISTING LEGAL PINS IN NEW PAVEMENT UTILIZING A WATER VALVE INSERT. GRIND OFF SYMBOL ON COVER.
  - CONCRETE PAVEMENT IN MINOR STREET APPROACHES, PRIVATE APPROACHES AND MEDIAN OPENINGS SHALL BE HAND PLACED WITH INTEGRAL CURB CONSTRUCTION (SD-203A OR SD-203B AS SPECIFIED). MAIN LINE CONCRETE PAVEMENT SHALL BE SLIP FORMED UNLESS OTHERWISE REQUIRED DUE TO TRAFFIC STAGING RESTRICTIONS.
  - INSTALL 150 mm SUB DRAIN IN BOTH DIRECTIONS OF CATCH BASINS WHERE INDICATED, ALONG PAVEMENT EDGE AS PER SD-245 AND CAP ENDS. SEE STAGING DRAWINGS FOR REMOVAL AND ADJUSTMENT PHASING

**FERMOR AVE EASTBOUND CONTROL LINE**

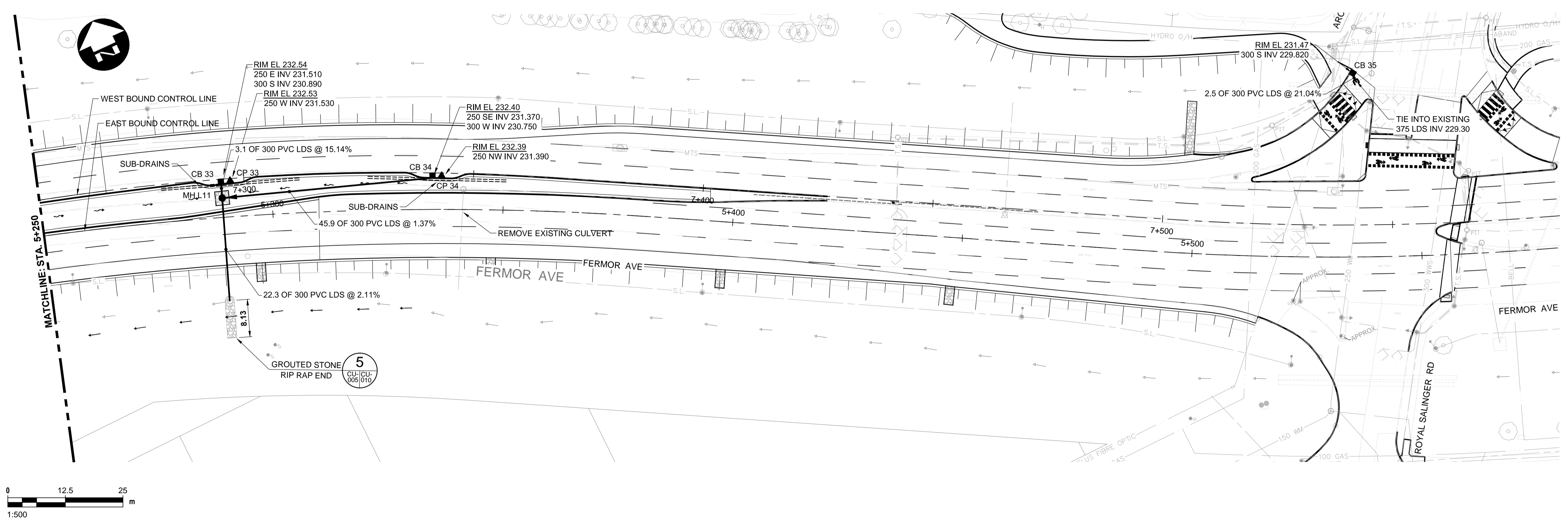
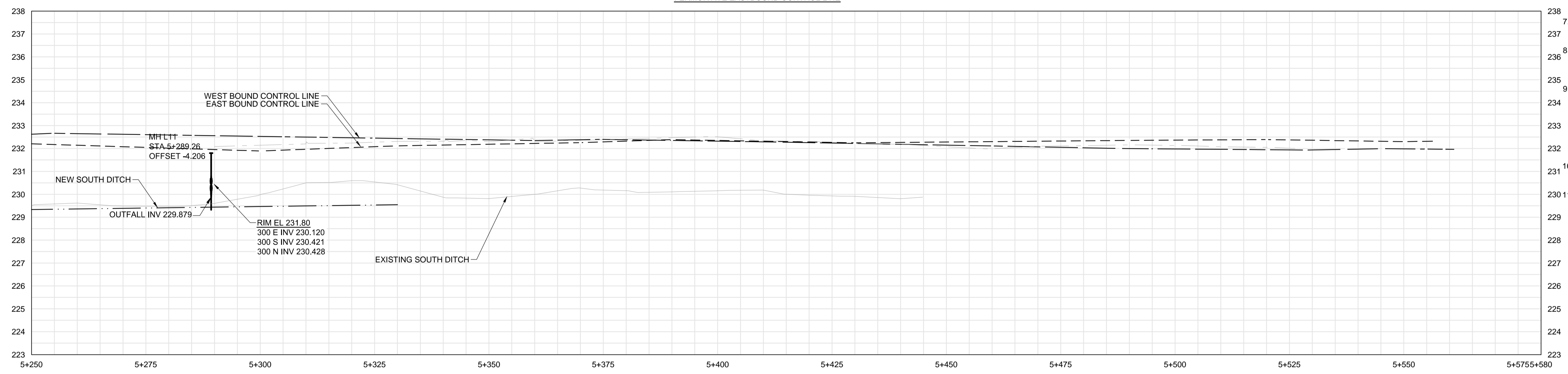

**METRIC**

WHOLE NUMBERS INDICATE MILLIMETRES  
DECIMAL NUMBERS INDICATE METRES

**WARNING**

- IF POWER EQUIPMENT OR EXPLOSIVES ARE TO BE USED FOR EXCAVATION ON THIS PROJECT THE CONTRACTOR MUST:
- NOTIFY THE GAS COMPANY OF THE PROPOSED LOCATION OF EXCAVATION.
  - TAKE PRECAUTION TO AVOID DAMAGE TO GAS COMPANY INSTALLATIONS SEE PROVINCIAL REGULATION 210/72 FOR DETAILS.
  - OBTAIN EXCAVATION PERMITS PRIOR TO CONSTRUCTION.

**APEGM**  
Certificate of Authorization  
**Dillon Consulting Limited (MB)**  
No. 1789 Date: 18/02/01

G:\CAD\175932\Drawings\Utilities\Contract\175932-CON-CU-LDS-PLAN-PROFILE-FERMOR.dwg

150 WM	WATERMAIN	150 WM	CONCRETE	150 WM	WATERMAIN	150 WM	WATERMAIN
300 LDS	HYDRANT	300 LDS	ASPHALT	300 LDS	LAND DRAINAGE SEWER	300 LDS	LAND DRAINAGE SEWER
250 WWS	VALVE	250 WWS	PLANING	250 WWS	WASTE WATER SEWER	250 WWS	WASTE WATER SEWER
100 GAS	MANHOLE	100 GAS	SIDEWALK	+	HYDRANT	+	HYDRANT
	CATCH BASIN	●	PAVING STONES	▨	VALVE	+	VALVE
	CURB INLET	▽	PARTIAL DEPTH REPAIR	▨	Q PROFILE	—	Q PROFILE
300 LDS	LAND DRAINAGE SEWER	300 LDS	PROPERTY LINE	—	NORTH/WEST GUTTER	—	NORTH/WEST GUTTER
250 WWS	WASTE WATER SEWER	250 WWS	DRAINAGE ARROW	→	SOUTH/EAST GUTTER	—	SOUTH/EAST GUTTER
HYDRO	HYDRO	HYDRO	CURB RAMP (SD-229C)	—	NORTH/WEST DITCH	—	NORTH/WEST DITCH
MTS	M.T.S.	MTS	DETECTABLE WARNING	—	SOUTH/EAST DITCH	—	SOUTH/EAST DITCH
100 GAS	GAS	100 GAS	SURFACE TILE (SD-229AA)	—			
EXISTING	LEGEND-PLAN	PROPOSED	EXISTING	LEGEND-PLAN	PROPOSED	EXISTING	LEGEND-PROFILE
							PROPOSED

UNDERGROUND STRUCTURES		B.M. ELEV.	DESIGNED BY	WPN
SUPV. U/G STRUCTURES	DATE		DRAWN BY	GLG
			CHECKED BY	WPN
			APPROVED BY	
			HOR. SCALE	1:500
			VERTICAL	1:50
0	ISSUED FOR TENDER	18/02/09	DATE	BY
NO.	REVISIONS	DATE	DATE	DATE

**DILLON CONSULTING**

RELEASED FOR CONSTRUCTION

DATE

ENGINEER'S SEAL

PROVINCE OF MANITOBA

REGISTERED PROFESSIONAL ENGINEER

**W.P. NAIRN**

CONSULTANT PROJECT NUMBER

17-5932

**THE CITY OF WINNIPEG**  
PUBLIC WORKS DEPARTMENT

**FERMOR AVENUE BRIDGE OVER SEINE RIVER**  
BRIDGE REHABILITATION, PEDESTRIAN-CYCLIST UNDERPASS STRUCTURE AND ROADWORKS FROM ST. ANNE'S ROAD TO ARCHIBALD STREET

FERMOR AVENUE - STA. 5+250 TO STA. 5+615.5 (PLAN-PROFILE)

CITY DRAWING NUMBER  
P-3489-2017-CU-006

SHEET 006 OF 11

CONSULTANT DRAWING NUMBER  
CU-006