

- CONSTRUCTION NOTES:**
- LEGAL PLAN AND UNDERGROUND INFORMATION FROM CITY OF WINNIPEG LBIS. CONTRACTOR TO VERIFY ALL UNDERGROUNDS IN THE FIELD.
  - ISOLATE MISCELLANEOUS ITEMS IN NEW CONCRETE WORKS AS PER SD-228C.
  - CONTRACTOR TO TAKE PRECAUTIONARY STEPS TO AVOID DAMAGE FROM CONSTRUCTION ACTIVITIES TO TREES WITHIN THE LIMIT OF CONSTRUCTION.
  - CONTRACTOR TO TAKE PRECAUTIONARY STEPS TO CONTROL EROSION BY USING STRAW WATTLES, AS REQUIRED.
  - LOCATION OF ALL EXISTING SERVICES TO BE CONFIRMED IN THE FIELD BY CONTRACTOR.
  - CONTRACTOR SHALL CONFIRM EXISTING LEAD INVERT ELEVATIONS PRIOR TO INSTALLATION.
  - ADJUST MH AND CB RIMS TO NEW GRADES.
  - REFER TO LAND DRAINAGE DRAWINGS FOR ADDITIONAL UNDERGROUND INFORMATION REGARDING MANHOLES, CATCH BASINS, CULVERT ELEVATIONS, AND OUTLET DETAILS.
  - REFER TO LANDSCAPE DRAWINGS FOR DETAILS ON ISLANDS, AND ADDITIONAL SURFACE WORK DETAILS.

**METRIC**

WHOLE NUMBERS INDICATE MILLIMETRES  
DECIMALIZED NUMBERS INDICATE METRES

**WARNING**

- IF POWER EQUIPMENT OR EXPLOSIVES ARE TO BE USED FOR EXCAVATION ON THIS PROJECT THE CONTRACTOR MUST:
- NOTIFY THE GAS COMPANY OF THE PROPOSED LOCATION OF EXCAVATION.
  - TAKE PRECAUTION TO AVOID DAMAGE TO GAS COMPANY INSTALLATIONS SEE PROVINCIAL REGULATION 210/72 FOR DETAILS.
  - OBTAIN EXCAVATION PERMITS PRIOR TO CONSTRUCTION.

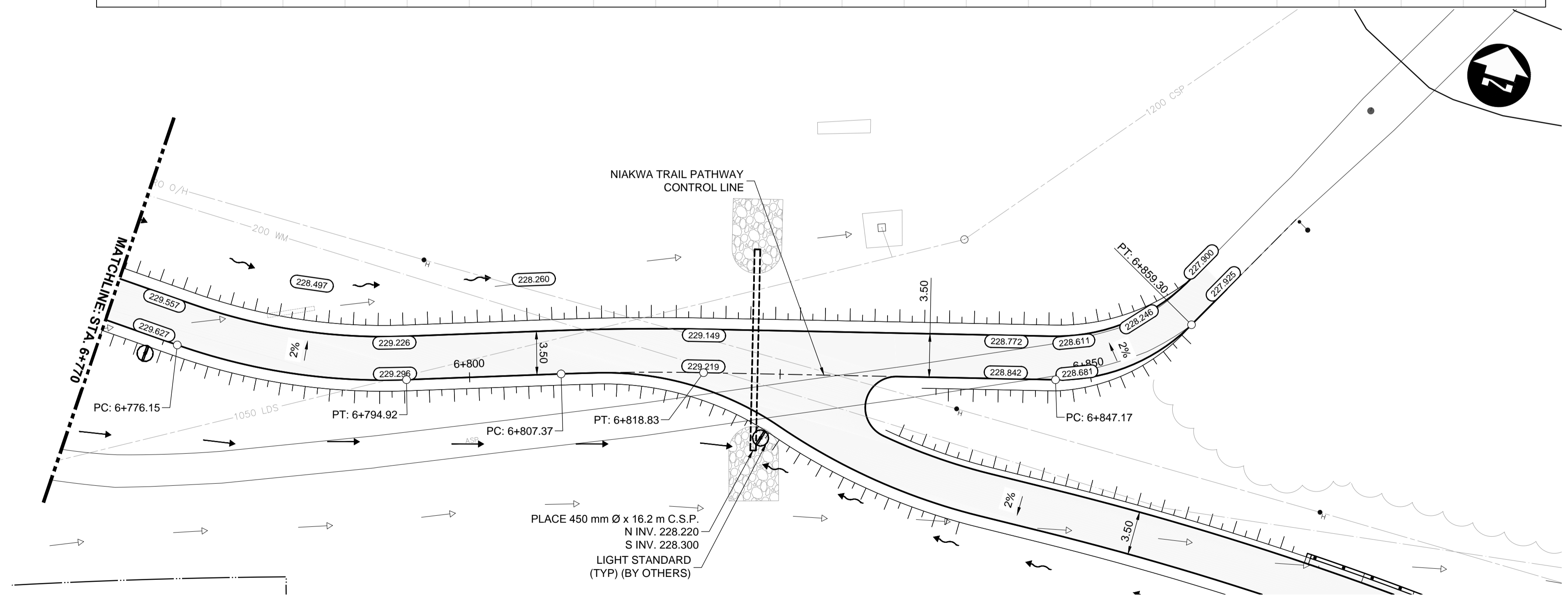

**APEGM**  
Certificate of Authorization  
**Dillon Consulting Limited (MB)**  
No. 1789 Date: 18/02/09

EXISTING	LEGEND-PLAN	PROPOSED	EXISTING	LEGEND-PLAN	PROPOSED	EXISTING	LEGEND-PROFILE	PROPOSED
150 WM	WATERMAIN	150 WM	CONCRETE	CONCRETE	CONCRETE	150 WM	WATERMAIN	150 WM
Hydrant	HYDRANT	Hydrant	ASPHALT	ASPHALT	ASPHALT	300 LDS	LAND DRAINAGE SEWER	300 LDS
Valve	VALVE	Valve	PLANING	PLANING	PLANING	250 WWS	WASTE WATER SEWER	250 WWS
Manhole	MANHOLE	Manhole	SIDEWALK	SIDEWALK	SIDEWALK	Hydrant	HYDRANT	Hydrant
Catch Basin	CATCH BASIN	Catch Basin	PAVING STONES	PAVING STONES	PAVING STONES	Valve	VALVE	Valve
Curb Inlet	CURB INLET	Curb Inlet	PARTIAL DEPTH REPAIR	PARTIAL DEPTH REPAIR	PARTIAL DEPTH REPAIR	C Profile	C PROFILE	C Profile
300 LDS	LAND DRAINAGE SEWER	300 LDS	PROPERTY LINE	PROPERTY LINE	PROPERTY LINE	North/West Gutter	NORTH/WEST GUTTER	North/West Gutter
250 WWS	WASTE WATER SEWER	250 WWS	DRAINAGE ARROW	DRAINAGE ARROW	DRAINAGE ARROW	South/East Gutter	SOUTH/EAST GUTTER	South/East Gutter
Hydro	HYDRO	Hydro	CURB RAMP (SD-229C)	CURB RAMP (SD-229C)	CURB RAMP (SD-229C)	North/West Ditch	NORTH/WEST DITCH	North/West Ditch
M.T.S.	M.T.S.	M.T.S.	DETECTABLE WARNING	DETECTABLE WARNING	DETECTABLE WARNING	South/East Ditch	SOUTH/EAST DITCH	South/East Ditch
100 GAS	GAS	100 GAS	SURFACE TILE (SD-229AA)	SURFACE TILE (SD-229AA)	SURFACE TILE (SD-229AA)			

**UNDERGROUND STRUCTURES**

SUPV. U/G STRUCTURES DATE

LOCATION OF UNDERGROUND STRUCTURES AS SHOWN ARE BASED ON THE BEST INFORMATION AVAILABLE, BUT NO GUARANTEE IS GIVEN THAT ALL EXISTING UTILITIES ARE SHOWN OR THAT THE GIVEN LOCATIONS ARE EXACT. CONFIRMATION OF EXISTENCE AND EXACT LOCATION OF ALL SERVICES MUST BE OBTAINED FROM THE INDIVIDUAL UTILITIES BEFORE PROCEEDING WITH CONSTRUCTION.

**B.M. ELEV.** SEE SHEET CT-001 FOR CONTROL POINT INFORMATION

0	ISSUED FOR TENDER	18/02/09	JNC
NO.	REVISIONS	DATE	BY

DESIGNED BY: JAT  
DRAWN BY: PMW  
CHECKED BY: JNC  
APPROVED BY: JNC  
HOR. SCALE: 1:250  
VERTICAL: 1:10

**DILLON CONSULTING**

RELEASED FOR CONSTRUCTION

DATE

ENGINEER'S SEAL  
PROVINCE OF MANITOBA  
REGISTERED PROFESSIONAL ENGINEER  
**J.N. CRANG**  
CONSULTANT PROJECT NUMBER  
17-5932

**THE CITY OF WINNIPEG**  
PUBLIC WORKS DEPARTMENT

**FERMOR AVENUE BRIDGE OVER SEINE RIVER**  
BRIDGE REHABILITATION, PEDESTRIAN-CYCLIST UNDERPASS STRUCTURE AND ROADWORKS FROM ST. ANNE'S ROAD TO ARCHIBALD STREET

FERMOR PATHWAY - STA. 0+195 TO END (PLAN-PROFILE)

CITY DRAWING NUMBER: P-3489-2017-CT-045  
SHEET 045 OF 067  
CONSULTANT DRAWING NUMBER: CT-045

G:\CAD\175932\Drawings\Roadworks\Contract\175932-CON-CT-PLAN-PROFILE-PATHWAYS.dwg