

FERMOR AVENUE EASTBOUND

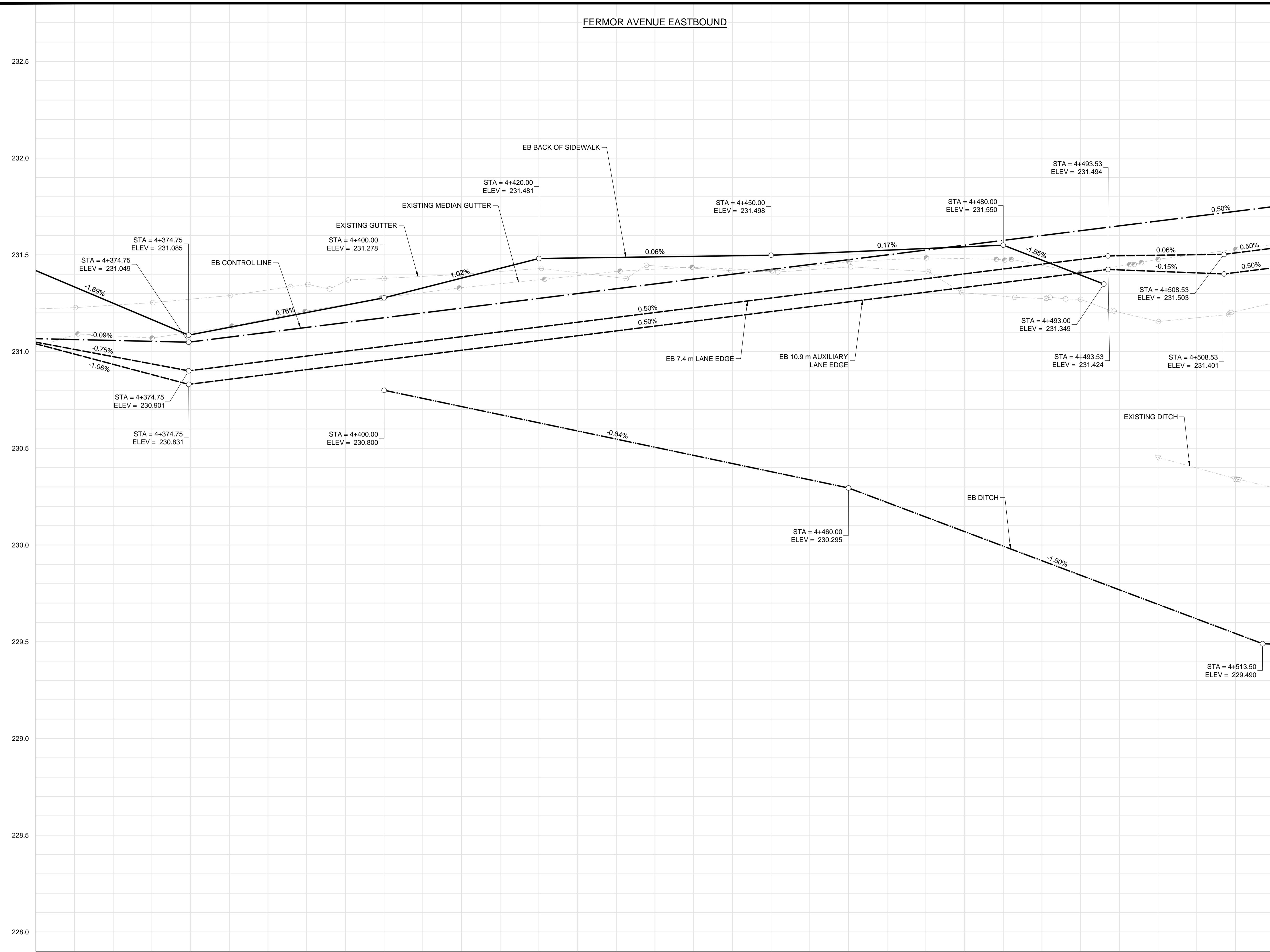

- CONSTRUCTION NOTES:**
- LEGAL PLAN AND UNDERGROUND INFORMATION FROM CITY OF WINNIPEG LBIS. CONTRACTOR TO VERIFY ALL UNDERGROUNDS IN THE FIELD.
 - ISOLATE MISCELLANEOUS ITEMS IN NEW CONCRETE WORKS AS PER SD-228C.
 - CONTRACTOR TO TAKE PRECAUTIONARY STEPS TO AVOID DAMAGE FROM CONSTRUCTION ACTIVITIES TO TREES WITHIN THE LIMIT OF CONSTRUCTION.
 - CONTRACTOR TO TAKE PRECAUTIONARY STEPS TO CONTROL EROSION BY USING STRAW WATTLES, AS REQUIRED.
 - LOCATION OF ALL EXISTING SERVICES TO BE CONFIRMED IN THE FIELD BY CONTRACTOR.
 - CONTRACTOR SHALL CONFIRM EXISTING LEAD INVERT ELEVATIONS PRIOR TO INSTALLATION.
 - ADJUST MH AND CB RIMS TO NEW GRADES.
 - REFER TO LAND DRAINAGE DRAWINGS FOR ADDITIONAL UNDERGROUND INFORMATION REGARDING MANHOLES, CATCH BASINS, CULVERT ELEVATIONS, AND OUTLET DETAILS.
 - REFER TO LANDSCAPE DRAWINGS FOR DETAILS ON ISLANDS, AND ADDITIONAL SURFACE WORK DETAILS.

METRIC

WHOLE NUMBERS INDICATE MILLIMETRES
DECIMALIZED NUMBERS INDICATE METRES

WARNING

- IF POWER EQUIPMENT OR EXPLOSIVES ARE TO BE USED FOR EXCAVATION ON THIS PROJECT THE CONTRACTOR MUST:
- NOTIFY THE GAS COMPANY OF THE PROPOSED LOCATION OF EXCAVATION.
 - TAKE PRECAUTION TO AVOID DAMAGE TO GAS COMPANY INSTALLATIONS SEE PROVINCIAL REGULATION 210/72 FOR DETAILS.
 - OBTAIN EXCAVATION PERMITS PRIOR TO CONSTRUCTION.



THE CITY OF WINNIPEG
PUBLIC WORKS DEPARTMENT

FERMOR AVENUE BRIDGE OVER SEINE RIVER
BRIDGE REHABILITATION, PEDESTRIAN-CYCLIST UNDERPASS STRUCTURE
AND ROADWORKS FROM ST. ANNE'S ROAD TO ARCHIBALD STREET

FERMOR AVENUE - STA. 4+355
TO 4+515 (EB PROFILE)

CITY DRAWING NUMBER: P-3489-2017-CT-015
SHEET 015 OF 067
CONSULTANT DRAWING NUMBER: CT-015

150 WM	WATERMAIN	150 WM	CONCRETE	150 WM	WATERMAIN	150 WM	WATERMAIN	150 WM	UNDERGROUND STRUCTURES SUPV. U/G STRUCTURES DATE	B.M. ELEV. SEE SHEET CT-001 FOR CONTROL POINT INFORMATION	DESIGNED BY	JAT	DILLON CONSULTING	ENGINEER'S SEAL PROVINCE OF MANITOBA REGISTERED PROFESSIONAL ENGINEER J.N. CRANG	THE CITY OF WINNIPEG PUBLIC WORKS DEPARTMENT FERMOR AVENUE BRIDGE OVER SEINE RIVER BRIDGE REHABILITATION, PEDESTRIAN-CYCLIST UNDERPASS STRUCTURE AND ROADWORKS FROM ST. ANNE'S ROAD TO ARCHIBALD STREET	CITY DRAWING NUMBER P-3489-2017-CT-015 SHEET 015 OF 067 CONSULTANT DRAWING NUMBER CT-015									
300 LDS	LAND DRAINAGE SEWER	300 LDS	ASPHALT	300 LDS	LAND DRAINAGE SEWER	300 LDS	LAND DRAINAGE SEWER	300 LDS			DRAWN BY	TJH					CHECKED BY	JNC	APPROVED BY	JNC	HOR. SCALE	1:250	RELEASED FOR CONSTRUCTION	DATE	18/02/09
250 WWS	WASTE WATER SEWER	250 WWS	PLANING	250 WWS	WASTE WATER SEWER	250 WWS	PLANING	250 WWS	NO.	REVISIONS	DATE	DATE	DATE	DATE	DATE	DATE	DATE	DATE	DATE	DATE	DATE	DATE	DATE	DATE	DATE
HYDRO	HYDRO	HYDRO	SIDEWALK	+	HYDRANT	+	SIDEWALK	+																	
100 GAS	GAS	100 GAS	PAVING STONES	+	VALVE	+	PAVING STONES	+																	
			PARTIAL DEPTH REPAIR	+	Q PROFILE	+	PARTIAL DEPTH REPAIR	+																	
			PROPERTY LINE	+	NORTH/WEST GUTTER	+	PROPERTY LINE	+																	
			DRAINAGE ARROW	+	SOUTH/EAST GUTTER	+	DRAINAGE ARROW	+																	
			CURB RAMP (SD-229C)	+	NORTH/WEST DITCH	+	CURB RAMP (SD-229C)	+																	
			DETECTABLE WARNING SURFACE TILE (SD-229AA)	+	SOUTH/EAST DITCH	+	DETECTABLE WARNING SURFACE TILE (SD-229AA)	+																	
EXISTING	LEGEND-PLAN	PROPOSED	EXISTING	LEGEND-PLAN	PROPOSED	EXISTING	LEGEND-PROFILE	PROPOSED																	

G:\CAD\175932\Drawings\Roadworks\Contract\175932-CON-CT-PLAN-PROFILE-FERMOR.dwg