

FERMOR AVENUE WESTBOUND

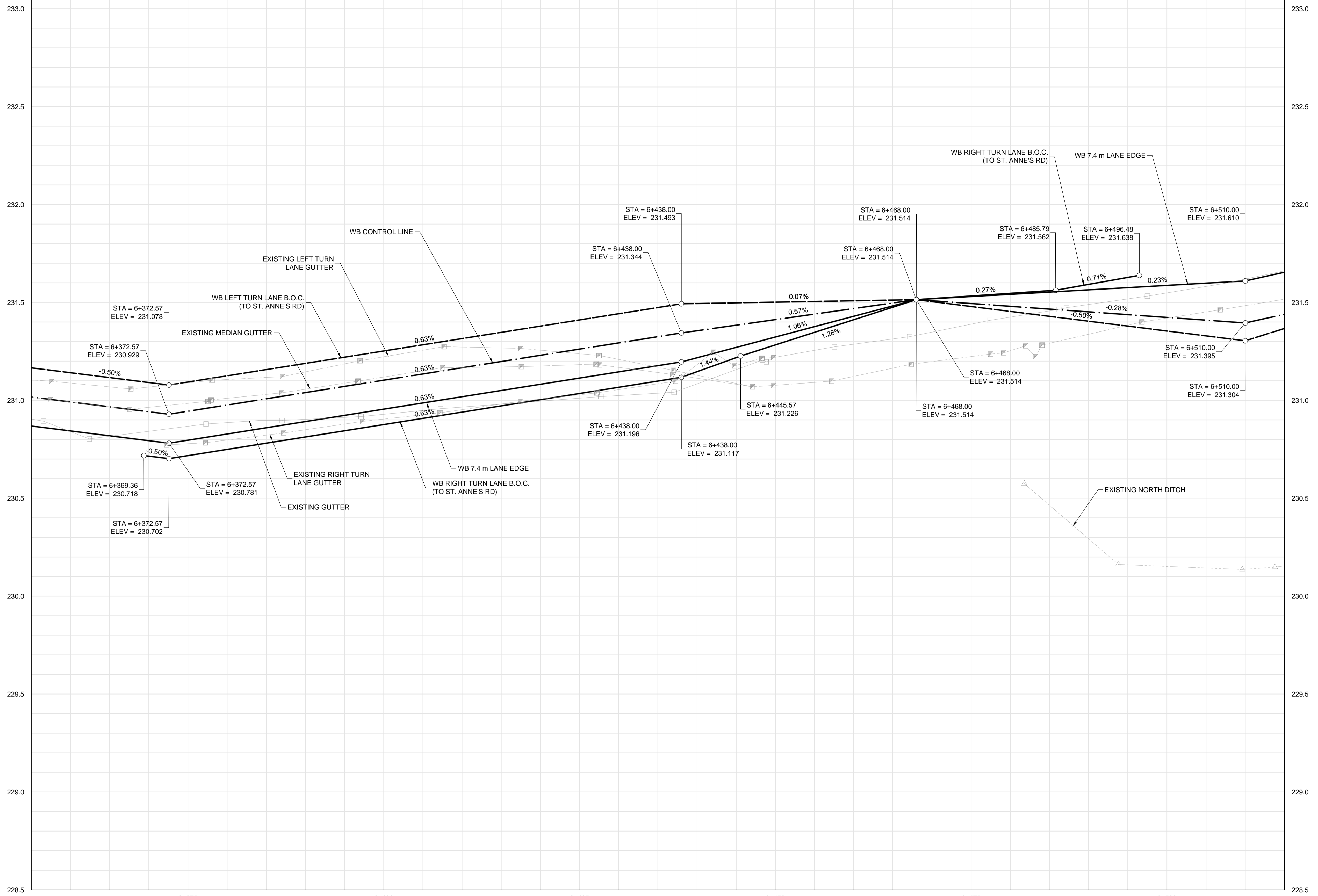

- CONSTRUCTION NOTES:**
- LEGAL PLAN AND UNDERGROUND INFORMATION FROM CITY OF WINNIPEG LBIS. CONTRACTOR TO VERIFY ALL UNDERGROUNDS IN THE FIELD.
  - ISOLATE MISCELLANEOUS ITEMS IN NEW CONCRETE WORKS AS PER SD-228C.
  - CONTRACTOR TO TAKE PRECAUTIONARY STEPS TO AVOID DAMAGE FROM CONSTRUCTION ACTIVITIES TO TREES WITHIN THE LIMIT OF CONSTRUCTION.
  - CONTRACTOR TO TAKE PRECAUTIONARY STEPS TO CONTROL EROSION BY USING STRAW WATTLES, AS REQUIRED.
  - LOCATION OF ALL EXISTING SERVICES TO BE CONFIRMED IN THE FIELD BY CONTRACTOR.
  - CONTRACTOR SHALL CONFIRM EXISTING LEAD INVERT ELEVATIONS PRIOR TO INSTALLATION.
  - ADJUST MH AND CB RIMS TO NEW GRADES.
  - REFER TO LAND DRAINAGE DRAWINGS FOR ADDITIONAL UNDERGROUND INFORMATION REGARDING MANHOLES, CATCH BASINS, CULVERT ELEVATIONS, AND OUTLET DETAILS.
  - REFER TO LANDSCAPE DRAWINGS FOR DETAILS ON ISLANDS, AND ADDITIONAL SURFACE WORK DETAILS.

**METRIC**

WHOLE NUMBERS INDICATE MILLIMETRES  
DECIMALIZED NUMBERS INDICATE METRES

**WARNING**

- IF POWER EQUIPMENT OR EXPLOSIVES ARE TO BE USED FOR EXCAVATION ON THIS PROJECT THE CONTRACTOR MUST:
- NOTIFY THE GAS COMPANY OF THE PROPOSED LOCATION OF EXCAVATION.
  - TAKE PRECAUTION TO AVOID DAMAGE TO GAS COMPANY INSTALLATIONS SEE PROVINCIAL REGULATION 210/72 FOR DETAILS.
  - OBTAIN EXCAVATION PERMITS PRIOR TO CONSTRUCTION.



**THE CITY OF WINNIPEG**  
PUBLIC WORKS DEPARTMENT

**FERMOR AVENUE BRIDGE OVER SEINE RIVER**  
BRIDGE REHABILITATION, PEDESTRIAN-CYCLIST UNDERPASS STRUCTURE AND ROADWORKS FROM ST. ANNE'S ROAD TO ARCHIBALD STREET

City Drawing Number: P-3489-2017-CT-014  
Sheet: 014 of 067  
Consultant Drawing Number: CT-014

FERMOR AVENUE - STA. 4+355 TO 4+515 (WB PROFILE)

**DILLON CONSULTING**

DESIGNED BY: JAT  
DRAWN BY: TJH  
CHECKED BY: JNC  
APPROVED BY: JNC

HOR. SCALE: 1:250  
VERTICAL: 1:10

RELEASED FOR CONSTRUCTION

CONSULTANT PROJECT NUMBER: 17-5932

NO.	REVISIONS	DATE	BY
0	ISSUED FOR TENDER	18/02/09	JNC

**UNDERGROUND STRUCTURES**

SUPV. U/G STRUCTURES DATE

LOCATION OF UNDERGROUND STRUCTURES AS SHOWN ARE BASED ON THE BEST INFORMATION AVAILABLE, BUT NO GUARANTEE IS GIVEN THAT ALL EXISTING UTILITIES ARE SHOWN OR THAT THE GIVEN LOCATIONS ARE EXACT. CONFIRMATION OF EXISTENCE AND EXACT LOCATION OF ALL SERVICES MUST BE OBTAINED FROM THE INDIVIDUAL UTILITIES BEFORE PROCEEDING WITH CONSTRUCTION.

LEGEND-PLAN	PROPOSED	EXISTING	LEGEND-PROFILE	PROPOSED	EXISTING
150 WM	WATERMAIN	150 WM	CONCRETE	150 WM	WATERMAIN
HYDRANT	HYDRANT	CONCRETE	ASPHALT	300 LDS	LAND DRAINAGE SEWER
VALVE	VALVE	CONCRETE	PLANING	250 WWS	WASTE WATER SEWER
MANHOLE	MANHOLE	CONCRETE	SIDEWALK	HYDRANT	HYDRANT
CATCH BASIN	CATCH BASIN	CONCRETE	PAVING STONES	VALVE	VALVE
CURB INLET	CURB INLET	CONCRETE	PARTIAL DEPTH REPAIR	Q PROFILE	Q PROFILE
300 LDS	LAND DRAINAGE SEWER	300 LDS	PROPERTY LINE	NORTH/WEST GUTTER	NORTH/WEST GUTTER
250 WWS	WASTE WATER SEWER	250 WWS	DRAINAGE ARROW	SOUTH/EAST GUTTER	SOUTH/EAST GUTTER
HYDRANT	HYDRANT	HYDRANT	CURB RAMP (SD-229C)	NORTH/WEST DITCH	NORTH/WEST DITCH
M.T.S.	M.T.S.	M.T.S.	DETECTABLE WARNING	SOUTH/EAST DITCH	SOUTH/EAST DITCH
100 GAS	GAS	100 GAS	SURFACE TILE (SD-229AA)		

G:\CAD\175932\Drawings\Roadworks\Contract\175932-CON-CT-PLAN-PROFILE-FERMOR.dwg