

SEE SHEETS CT-001 AND CT-002 FOR FERMOR CONTROL LINE DETAILS

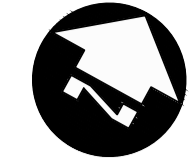

SEAGRIM CONTROL LINE						
SEGMENT	STATION (START)	STATION (END)	NORTHING (START)	EASTING (START)	NORTHING (END)	EASTING (END)
L32	2+000.000	2+010.236	5524339.245	636464.657	5524348.215	636459.726
C36	2+010.236	2+022.103	5524348.215	636459.726	5524358.441	636462.761
L33	2+022.103	2+040.459	5524358.441	636462.761	5524367.099	636478.948
L34	2+040.459	2+045.000	5524367.099	636478.948	5524369.291	636482.925

CURVE DATA						
#	R.	Δc	Tc	L.	L.C.	
C36	7.500	90°39'22"	7.586	11.867	10.667	

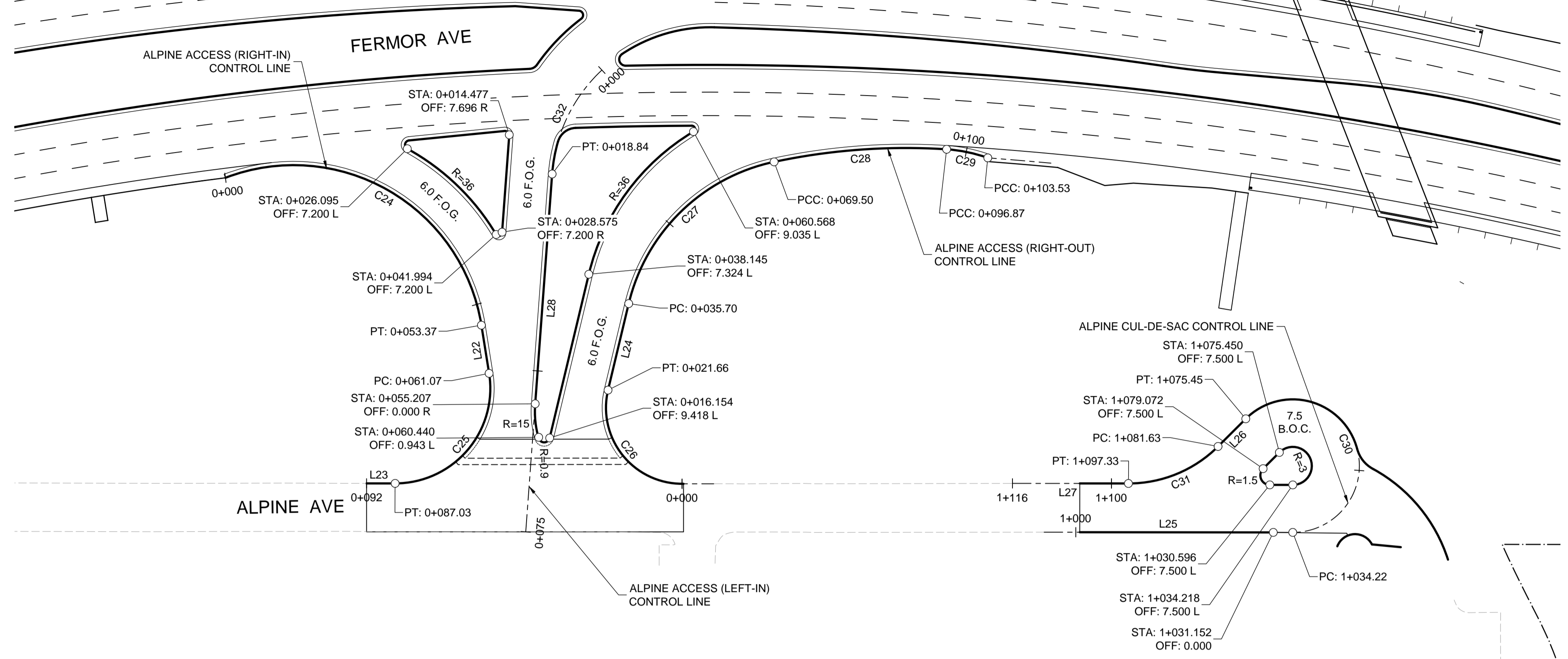
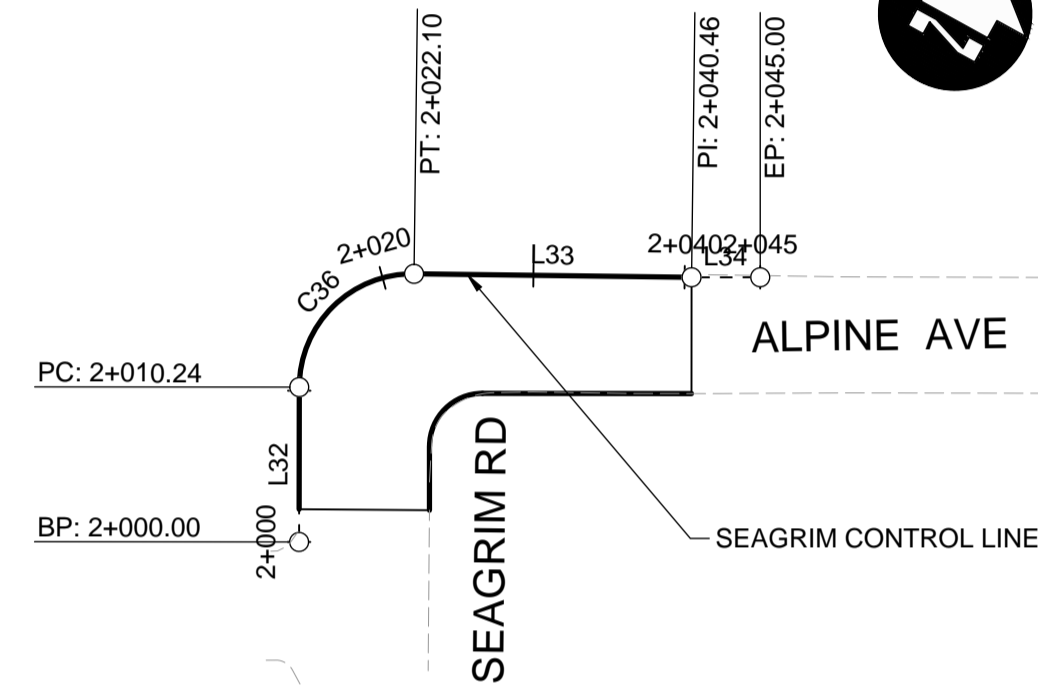

ALPINE ACCESS (RIGHT-IN)						
SEGMENT	STATION (START)	STATION (END)	NORTHING (START)	EASTING (START)	NORTHING (END)	EASTING (END)
C24	0+000.000	0+053.367	5524445.786	636522.087	5524444.897	636568.682
L22	0+053.367	0+061.067	5524444.897	636568.682	5524438.824	636573.418
C25	0+061.067	0+087.026	5524438.824	636573.418	5524416.455	636568.813
L23	0+087.026	0+091.529	5524416.455	636568.813	5524414.286	636564.867

ALPINE ACCESS (LEFT-IN)						
SEGMENT	STATION (START)	STATION (END)	NORTHING (START)	EASTING (START)	NORTHING (END)	EASTING (END)
C32	0+000.226	0+018.838	5524489.339	636565.894	5524471.184	636566.943
L28	0+018.838	0+075.475	5524471.184	636566.943	5524419.702	636590.550

ALPINE ACCESS (RIGHT-OUT)						
SEGMENT	STATION (START)	STATION (END)	NORTHING (START)	EASTING (START)	NORTHING (END)	EASTING (END)
C26	0+000.000	0+021.663	5524438.246	636608.482	5524445.565	636591.123
L24	0+021.663	0+035.697	5524445.565	636591.123	5524459.094	636587.392
C27	0+035.697	0+069.498	5524459.094	636587.392	5524489.759	636596.683
C28	0+069.498	0+096.871	5524489.759	636596.683	5524504.630	636619.562
C29	0+096.871	0+103.527	5524504.630	636619.562	5524506.578	636625.906

ALPINE AVENUE CUL-DE-SAC						
SEGMENT	STATION (START)	STATION (END)	NORTHING (START)	EASTING (START)	NORTHING (END)	EASTING (END)
L25	0+995.000	1+034.218	5524459.123	636662.200	5524478.016	636696.567
C30	1+034.218	1+075.450	5524478.016	636696.567	5524490.148	636681.427
L26	1+075.450	1+081.630	5524490.148	636681.427	5524484.213	636679.702
C31	1+081.630	1+097.328	5524484.213	636679.702	5524472.273	636670.137
L27	1+097.328	1+115.620	5524472.273	636670.137	5524463.456	636654.111

CURVE DATA						
#	R.	Δc	Tc	L.	L.C.	
C24	30.000	101°55'23"	36.996	53.367	46.603	
C25	15.000	99°09'20"	17.611	25.959	22.839	

CURVE DATA						
#	R.	Δc	Tc	L.	L.C.	
C32	25.000	42°39'21"	9.761	18.612	18.185	

CURVE DATA						
#	R.	Δc	Tc	L.	L.C.	
C26	12.000	103°26'00"	15.204	21.663	18.839	
C27	30.000	64°33'20"	18.949	33.801	32.041	
C28	100.000	15°41'00"	13.772	27.373	27.287	
C29	25.000	15°15'14"	3.348	6.656	6.636	

CURVE DATA						
#	R.	Δc	Tc	L.	L.C.	
C30	10.500	224°59'34"	25.354	41.232	19.402	
C31	20.000	44°58'20"	8.279	15.698	15.298	

ROYAL SALINGER CONTROL LINE						
SEGMENT	STATION (START)	STATION (END)	NORTHING (START)	EASTING (START)	NORTHING (END)	EASTING (END)
L36	1+000.000	1+072.453	5524366.134	637384.195	5524427.034	637423.446

ARCHIBALD CONTROL LINE						
SEGMENT	STATION (START)	STATION (END)	NORTHING (START)	EASTING (START)	NORTHING (END)	EASTING (END)
L39	1+070.000	1+096.570	5524424.755	637422.453	5524447.089	637436.847
C38	1+096.570	1+130.139	5524447.089	637436.847	5524473.556	637457.425
L40	1+130.139	1+147.442	5524473.556	637457.425	5524486.226	637469.209

CURVE DATA						
#	R.	Δc	Tc	L.	L.C.	
C38	190.000	10°07'23"	16.828	33.569	33.526	

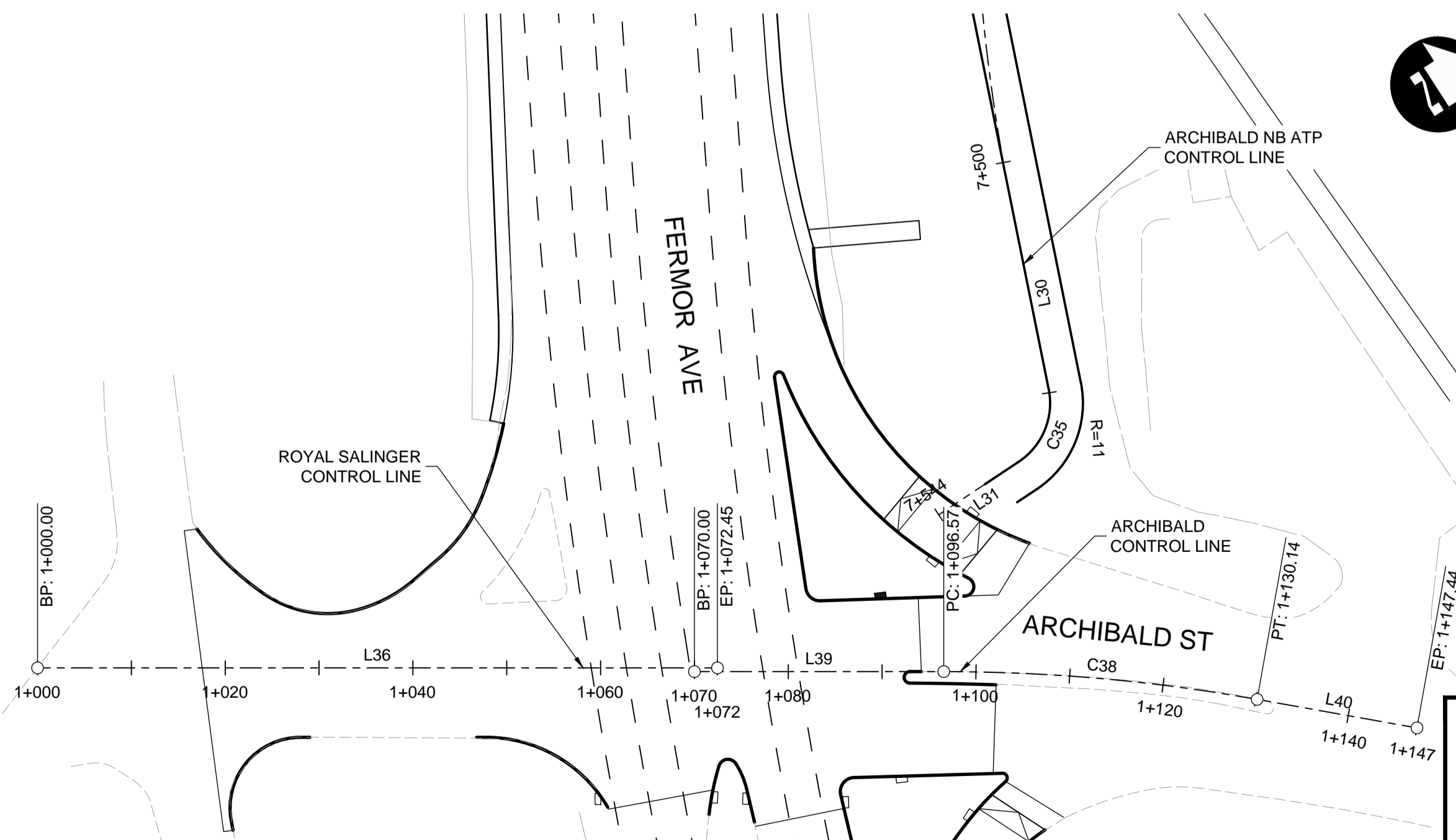

LEGEND
 B.O.C. = BACK OF CURB
 F.O.G. = FACE OF 600mm WIDE CURB AND GUTTER PAN

UNDERGROUND STRUCTURES		B.M. ELEV.	SEE SHEET CT-001 FOR CONTROL POINT INFORMATION
SUPV. U/G STRUCTURES	DATE		

DESIGNED BY	JAT
DRAWN BY	TJH
CHECKED BY	JNC
APPROVED BY	JNC
HOR. SCALE	1:500
VERTICAL	-
ISSUED FOR TENDER	18/02/09 JNC
NO. REVISIONS	DATE BY

RELEASED FOR CONSTRUCTION	DATE
---------------------------	------

ENGINEER'S SEAL
 PROVINCE OF MANITOBA
 REGISTERED PROFESSIONAL ENGINEER
J.N. CRANG
 CONSULTANT PROJECT NUMBER
 17-5932

THE CITY OF WINNIPEG
 PUBLIC WORKS DEPARTMENT
Winnipeg
 FERMOR AVENUE BRIDGE OVER SEINE RIVER
 BRIDGE REHABILITATION, PEDESTRIAN-CYCLIST UNDERPASS STRUCTURE
 AND ROADWORKS FROM ST. ANNE'S ROAD TO ARCHIBALD STREET
 CONTROL LINE GEOMETRY -
 ARCHIBALD AVENUE, ALPINE AVENUE,
 AND ROYAL SALINGER ROAD

CITY DRAWING NUMBER	P-3489-2017-CT-005
SHEET OF	005 OF 067
CONSULTANT DRAWING NUMBER	CT-005

APEGM
 Certificate of Authorization
Dillon Consulting Limited (MB)
 No. 1789 Date: 18/02/09

G:\CAD\175932\Drawings\Roadworks\Contract\175932-CON-CT-CONTROL-LINE-GEOMETRY-ALPINE.dwg