

P-ST ANNE-SB-BL-(DD)						
SEGMENT	STATION (START)	STATION (END)	NORTHING (START)	EASTING (START)	NORTHING (END)	EASTING (END)
L7	0+980.000	1+085.936	5524192.531	636322.747	5524286.106	636273.086
L8	1+085.936	1+164.000	5524286.106	636273.086	5524355.164	636236.685

P-ST ANNE-NB-BL-(DD)						
SEGMENT	STATION (START)	STATION (END)	NORTHING (START)	EASTING (START)	NORTHING (END)	EASTING (END)
L9	0+980.000	1+053.689	5524196.305	636329.852	5524261.964	636296.402
L10	1+053.689	1+165.000	5524261.964	636296.402	5524360.143	636243.951

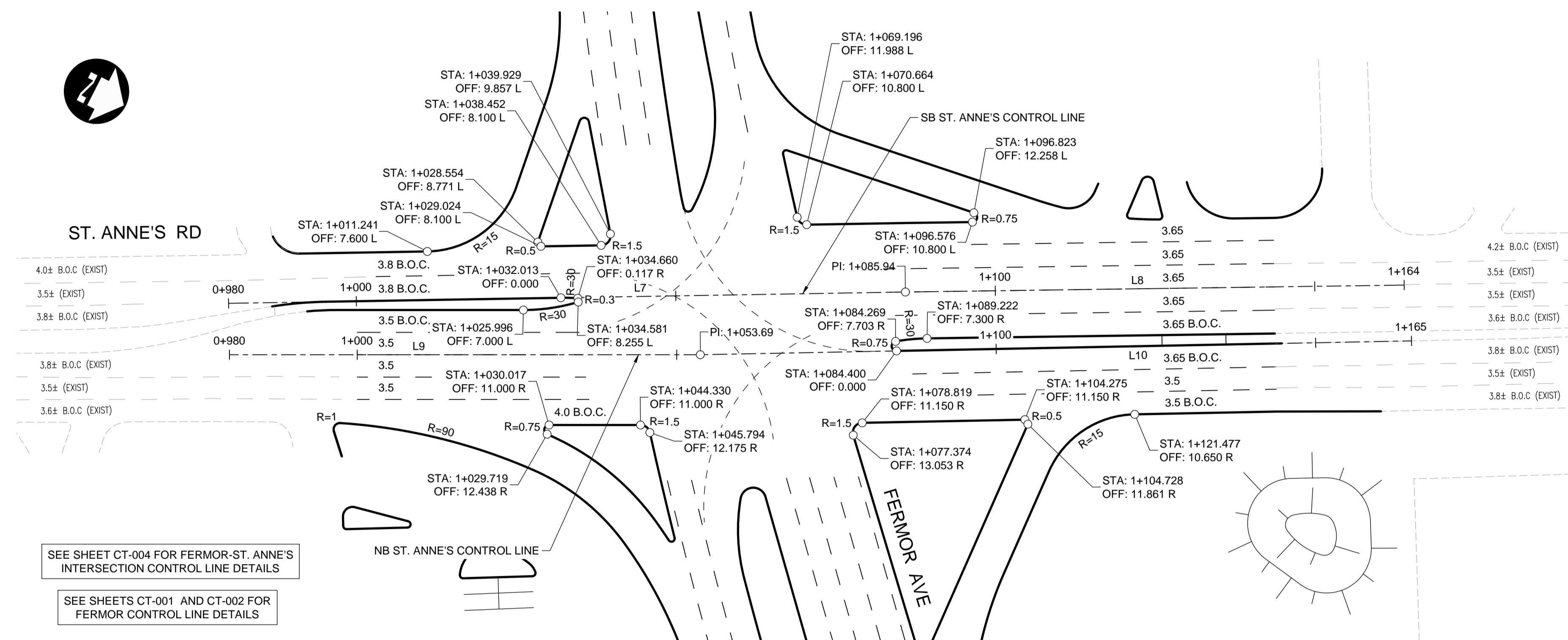

SEE SHEET CT-004 FOR FERMOR-ST. ANNE'S INTERSECTION CONTROL LINE DETAILS

SEE SHEETS CT-001 AND CT-002 FOR FERMOR CONTROL LINE DETAILS

LEGEND
 B.O.C. = BACK OF CURB
 F.O.G. = FACE OF 600mm WIDE CURB AND GUTTER PAN

APEGM
 Certificate of Authorization
Dillon Consulting Limited (MB)
 No. 1789 Date: 18/02/09

UNDERGROUND STRUCTURES SUPV. U/G STRUCTURES DATE	B.M. ELEV. SEE SHEET CT-001 FOR CONTROL POINT INFORMATION	DESIGNED BY JAT		ENGINEER'S SEAL 		FERMOR AVENUE BRIDGE OVER SEINE RIVER BRIDGE REHABILITATION, PEDESTRIAN-CYCLIST UNDERPASS STRUCTURE AND ROADWORKS FROM ST. ANNE'S ROAD TO ARCHIBALD STREET	CITY DRAWING NUMBER P-3489-2017-CT-003
		DRAWN BY TJH					SHEET OF 003 067
LOCATION OF UNDERGROUND STRUCTURES AS SHOWN ARE BASED ON THE BEST INFORMATION AVAILABLE, BUT NO GUARANTEE IS GIVEN THAT ALL EXISTING UTILITIES ARE SHOWN OR THAT THE GIVEN LOCATIONS ARE EXACT. CONFIRMATION OF EXISTENCE AND EXACT LOCATION OF ALL SERVICES MUST BE OBTAINED FROM THE INDIVIDUAL UTILITIES BEFORE PROCEEDING WITH CONSTRUCTION.	NO. REVISIONS DATE BY DATE	CHECKED BY JNC	RELEASED FOR CONSTRUCTION DATE	CONSULTANT PROJECT NUMBER 17-5932	CONTROL LINE GEOMETRY - ST. ANNE'S ROAD	CONSULTANT DRAWING NUMBER CT-003	
		APPROVED BY JNC					HOR. SCALE 1:500 VERTICAL -

G:\CAD\175932\Drawings\Roadworks\Contract\175932-CON-CT-CONTROL-LINE-GEOMETRY-STANNES.dwg