

**NOTES:**

1. REFER TO SHEET CS-063 FOR STANDARD JOINT DETAILS.
2. ALL EXPOSED EDGES TO BE CHAMFERED 20 mm UNLESS NOTED OTHERWISE.

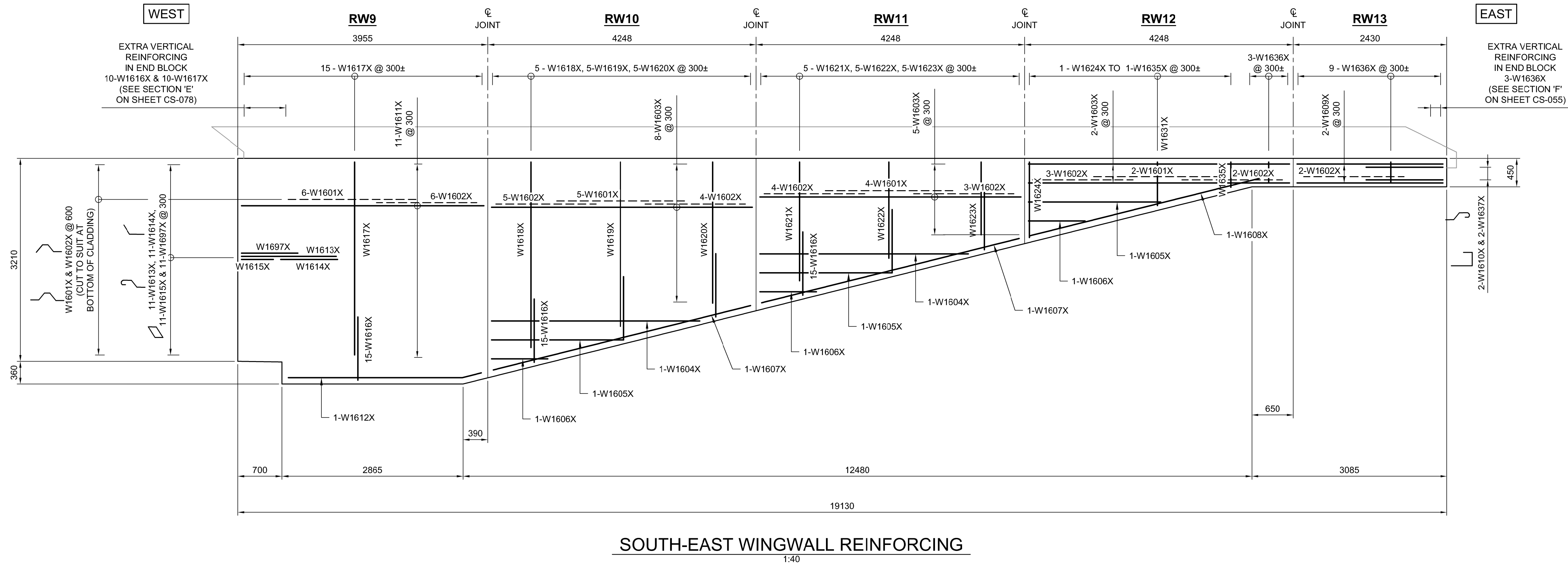

**CONCRETE CLADDING & COPING SCHEDULE FOR UNDERPASS SOUTH-EAST WINGWALL**

MK.	CONC. PANEL		CONC. END BLOCK		COPING REINFORCING
	REINFORCING	STUDS	REINFORCING	REINFORCING	
RW9	AS DETAILED	65 - MK."S1"	AS DETAILED	AS DETAILED	7-C1603X(5), 13-C1605X, 1-C1609X(1), 1-C1609X(2), 1-C1609X(3), 1-C1610X, 1-C1611X, 1-C1612X (SEE SECTION C ON SHEET CS-078)
RW10	AS DETAILED	62 - MK."S1"			7-C1603X(1), 15-C1605X (SEE TYPICAL ELEVATION ON SHEET CS-055)
RW11	AS DETAILED	44 - MK."S1"			7-C1603X(1), 15-C1605X (SEE TYPICAL ELEVATION ON SHEET CS-055)
RW12	AS DETAILED	22 - MK."S1"			7-C1603X(1), 15-C1605X (SEE TYPICAL ELEVATION ON SHEET CS-055)
RW13	AS DETAILED	9 - MK."S1"	AS DETAILED	AS DETAILED	7-C1603X(1), 15-C1605X, 1-C1606X, 1-C1607X(1), 1-C1607X(2), 1-C1607X(3), 1-C1608X (SEE DETAIL 7 ON SHEET CS-055)

NOTE: REFER TO SHEET CS-068 FOR PANEL LOCATIONS.

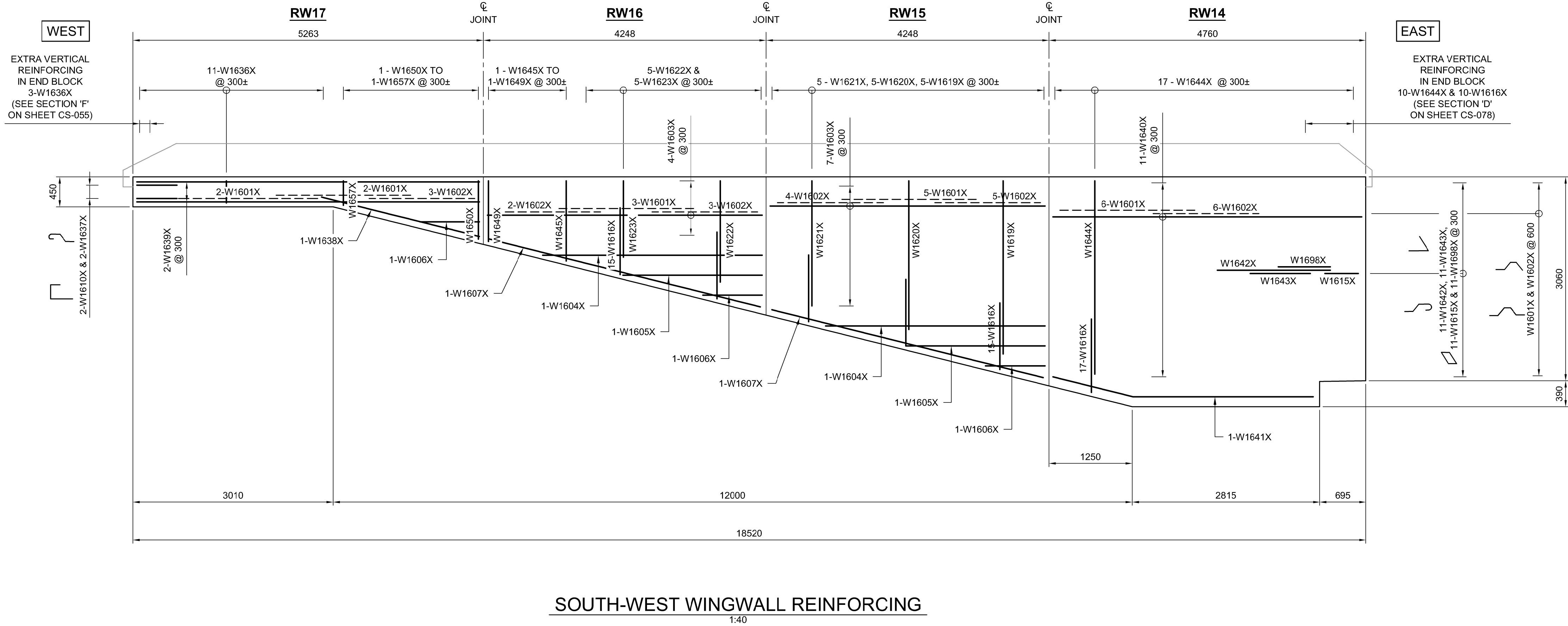

**CONCRETE CLADDING & COPING SCHEDULE FOR UNDERPASS SOUTH-WEST WINGWALL**

MK.	CONC. PANEL		CONC. END BLOCK		COPING REINFORCING
	REINFORCING	STUDS	REINFORCING	REINFORCING	
RW14	AS DETAILED	64 - MK."S1"	AS DETAILED	AS DETAILED	7-C1603X(7), 14-C1605X, 1-C1609X(1), 1-C1609X(2), 1-C1609X(3), 1-C1610X, 1-C1611X, 1-C1612X (SEE SECTION C ON SHEET CS-078)
RW15	AS DETAILED	56 - MK."S1"			7-C1603X(1), 15-C1605X (SEE TYPICAL ELEVATION ON SHEET CS-055)
RW16	AS DETAILED	37 - MK."S1"			7-C1603X(1), 15-C1605X (SEE TYPICAL ELEVATION ON SHEET CS-055)
RW17	AS DETAILED	23 - MK."S1"	AS DETAILED	AS DETAILED	7-C1603X(8), 16-C1605X, 1-C1606X, 1-C1607X(1), 1-C1607X(2), 1-C1607X(3), 1-C1608X (SEE DETAIL 7 ON SHEET CS-055)

NOTE: REFER TO SHEET CS-068 FOR PANEL LOCATIONS.

G:\CAD\175932\Drawings\Structural\Underpass\CON-CS-RETAINING WALL DETAILS 2.dwg



DESIGNED BY	DRA	CHECKED BY	SSR
DRAWN BY	CGC	APPROVED BY	MBL
HOR. SCALE	AS SHOWN	RELEASED FOR CONSTRUCTION	
VERTICAL	AS SHOWN		
ISSUED FOR TENDER	18/02/09	DRA	
NO. REVISIONS	DATE	BY	DATE
0			

ENGINEER'S SEAL  
PROVINCE OF MANITOBA  
D.R.C. AMORIM  
Member 33215  
REGISTERED PROFESSIONAL ENGINEER  
CONSULTANT PROJECT NUMBER  
17-5932

**THE CITY OF WINNIPEG**  
PUBLIC WORKS DEPARTMENT  
Winnipeg

**FERMOR AVENUE BRIDGE OVER SEINE RIVER**  
BRIDGE REHABILITATION, PEDESTRIAN-CYCLIST UNDERPASS STRUCTURE AND ROADWORKS FROM ST. ANNE'S ROAD TO ARCHIBALD STREET

CITY DRAWING NUMBER  
U-243-2017-CS-079  
SHEET 079 OF 100  
CONSULTANT DRAWING NUMBER  
CS-079

PEDESTRIAN-CYCLIST UNDERPASS  
WINGWALL DETAILS 2 OF 3