

STAGE 1A (2018)  
1:100

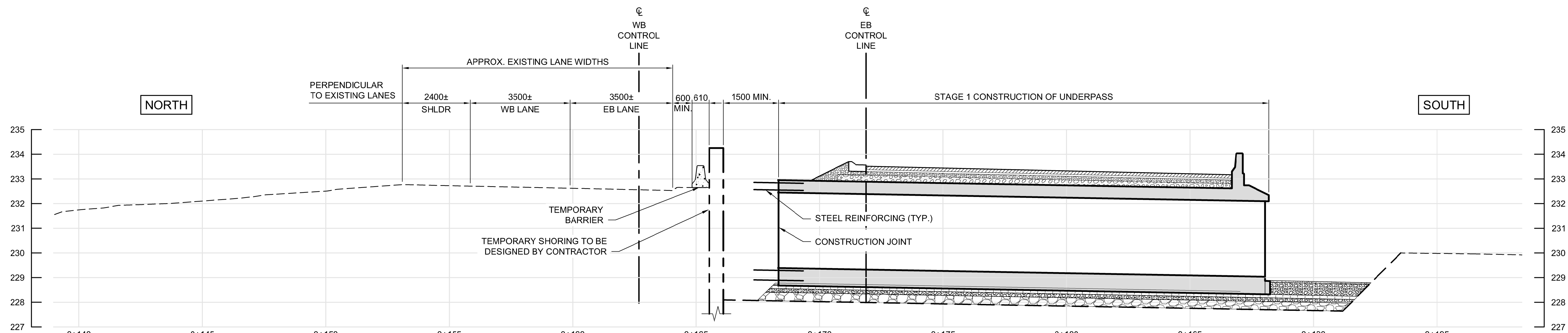

STAGE 1B (2018)  
1:100

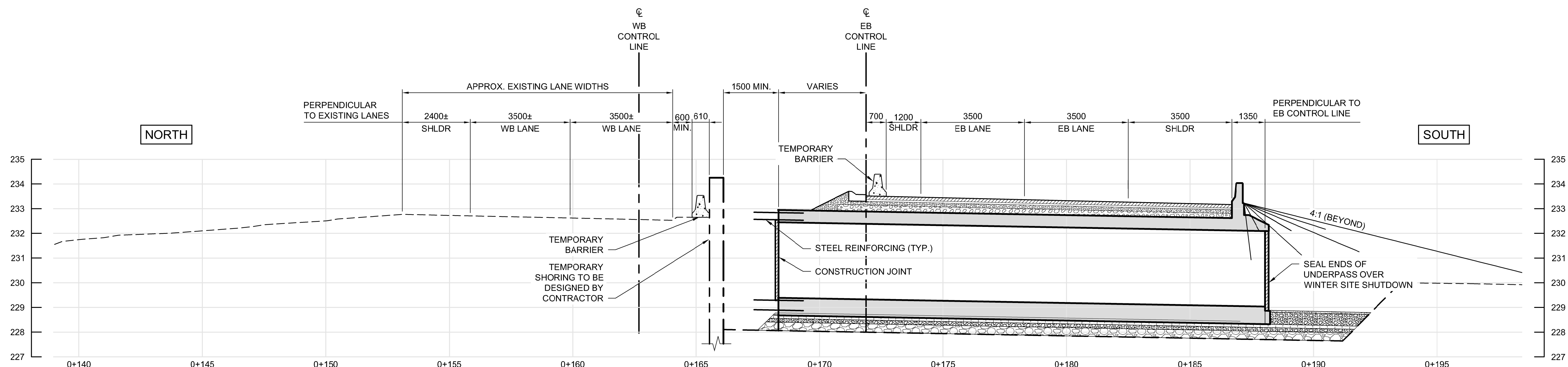

STAGE 1C - WINTER SITE SHUTDOWN (2018-2019)  
1:100

**NOTES:**

1. THE INTENT OF THIS DRAWING IS TO SHOW THE INTENDED CONSTRUCTION SEQUENCING FOR THE PROPOSED PEDESTRIAN-CYCLIST UNDERPASS.
2. THESE DRAWINGS SHALL BE READ IN CONJUNCTION WITH THE ROADWORKS STAGING DRAWINGS (CT-010 TO CT-021).
3. SEQUENCE OF WORK:
  - 3.1. **STAGE 1A (2018):** DIVERT TRAFFIC TO EXISTING WESTBOUND LANES TO ALLOW FOR STAGE 1 CONSTRUCTION. INSTALL TEMPORARY SHORING AS REQUIRED (DESIGN BY CONTRACTOR). EXCAVATE FOR STAGE 1 UNDERPASS CONSTRUCTION.
  - 3.2. **STAGE 1B (2018):** COMPLETE STAGE 1 UNDERPASS WORKS INCLUDING SOUTH SHEET PILE RETAINING WALL. BACKFILL AND COMPLETE ROADWORKS AS PER ROADWORKS STAGING DRAWINGS.
  - 3.3. **STAGE 1C - WINTER SITE SHUTDOWN (2018-2019):** INSTALL TEMPORARY PRECAST CONCRETE BARRIERS AND RESUME EASTBOUND TRAFFIC OVER NEWLY CONSTRUCTED STAGE 1 UNDERPASS AND WESTBOUND TRAFFIC ON EXISTING WESTBOUND LANES. ALL LANES TO REMAIN IN OPERATION OVER WINTER SITE SHUTDOWN.
  - 3.4. **STAGE 2A (2019):** DIVERT TRAFFIC TO EASTBOUND LANES OVER NEWLY CONSTRUCTED UNDERPASS. EXCAVATE FOR STAGE 2 UNDERPASS CONSTRUCTION. PLACE CONCRETE APPROACH SLAB AND COMPLETE ASPHALT PATHWAY ON THE SOUTH SIDE.
  - 3.5. **STAGE 2B (2019):** COMPLETE STAGE 2 UNDERPASS WORKS INCLUDING NORTH SHEET PILE RETAINING WALL. ADJUST TEMPORARY SHORING AS REQUIRED TO COMPLETE WORK AT UNDERPASS. PLACE CONCRETE APPROACH SLAB AND COMPLETE ASPHALT PATHWAY ON THE NORTH SIDE.
  - 3.6. **STAGE 2C (2019):** REMOVE REMAINING TEMPORARY SHORING AND RESTORE TRAFFIC TO FINAL PROPOSED CONFIGURATION.

G:\CAD\175932\Drawings\Structural\Underpass-CON-CS-STAGING.dwg



DESIGNED BY	DRA	CHECKED BY	SSR
DRAWN BY	CGC	APPROVED BY	MBL
HOR. SCALE	AS SHOWN	RELEASED FOR CONSTRUCTION	
VERTICAL SCALE	AS SHOWN		
ISSUED FOR TENDER	18/02/09	DRA	
NO. REVISIONS	DATE	BY	DATE
	2018/02/09	DRA	

**DILLON CONSULTING**

DESIGNED BY: DRA, CHECKED BY: SSR, APPROVED BY: MBL, RELEASED FOR CONSTRUCTION: 2018/02/09

ENGINEER'S SEAL  
PROVINCE OF MANITOBA  
**D.R.C. AMORIM**  
Member 33215  
REGISTERED PROFESSIONAL ENGINEER  
CONSULTANT PROJECT NUMBER: 17-5932

**THE CITY OF WINNIPEG PUBLIC WORKS DEPARTMENT**

**FERMOR AVENUE BRIDGE OVER SEINE RIVER**  
BRIDGE RE-HABILITATION, PEDESTRIAN-CYCLIST UNDERPASS STRUCTURE AND ROADWORKS FROM ST. ANNE'S ROAD TO ARCHIBALD STREET

PEDESTRIAN-CYCLIST UNDERPASS STAGES 1A, 1B & 1C

CITY DRAWING NUMBER: U-243-2017-CS-066  
SHEET 066 OF 100  
CONSULTANT DRAWING NUMBER: CS-066