

NOTE: ON NORTHEAST CURB
28 BARS @ 250 (MAX.)
(FROM WEST TO EAST)
15 - S1601S
1 - S1614S
1 - S1615S
1 - S1616S
10 - S1617S

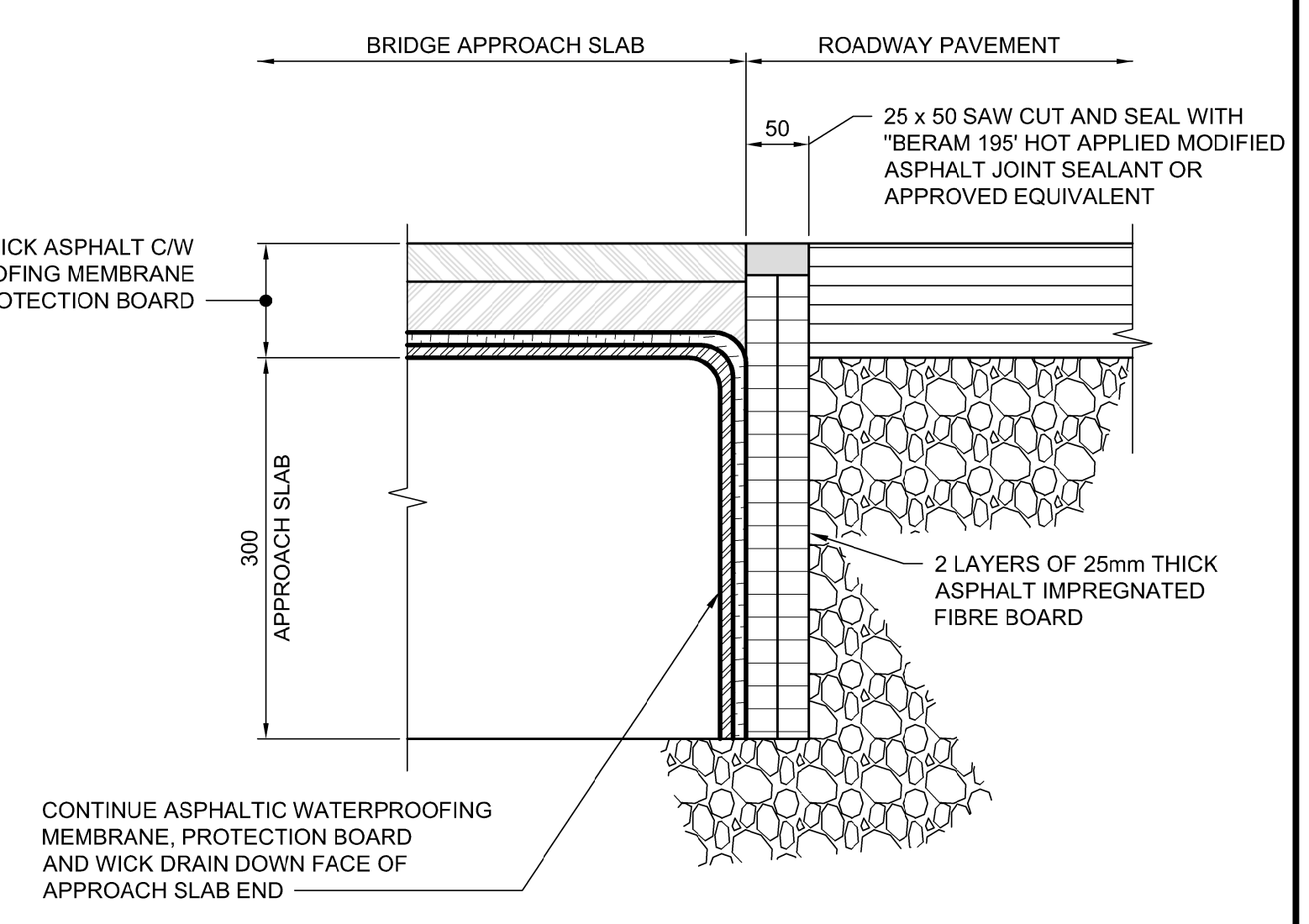
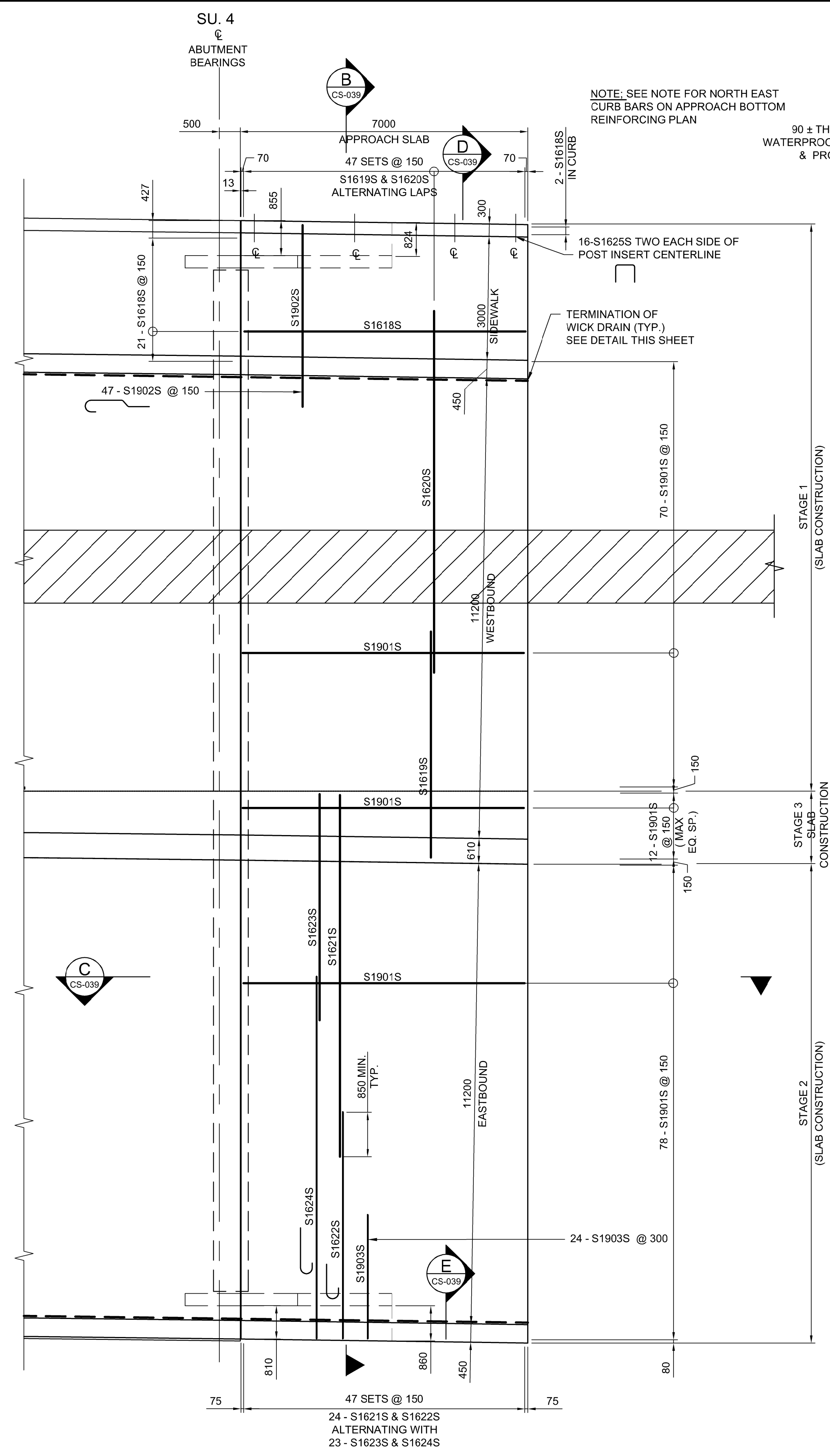

APPROACH PLAN
1:75

APEGM
Certificate of Authorization
Dillon Consulting Limited (MB)
No. 1789 Date: 2018/02/09

DESIGNED BY	MS	CHECKED BY	SSR
DRAWN BY	NBG / DB	APPROVED BY	MBL
HOR. SCALE	AS SHOWN	RELEASED FOR CONSTRUCTION	
VERTICAL	AS SHOWN		
ISSUED FOR TENDER	18/02/09	DRA	
NO. REVISIONS	DATE	BY	DATE
0			2018/02/09

ENGINEER'S SEAL
PROVINCE OF MANITOBA
D.R.C. AMORIM
Member 33215
REGISTERED PROFESSIONAL ENGINEER
CONSULTANT PROJECT NUMBER
17-5932

THE CITY OF WINNIPEG
PUBLIC WORKS DEPARTMENT

FERMOR AVENUE BRIDGE OVER SEINE RIVER
BRIDGE RE-ABILITATION, PEDESTRIAN-CYCLIST UNDERPASS STRUCTURE
AND ROADWORKS FROM ST. ANNE'S ROAD TO ARCHIBALD STREET

CITY DRAWING NUMBER
B-118-2017-CS-038

SHEET 038 OF 100

CONSULTANT DRAWING NUMBER
CS-038

APPROACH SLAB DETAILS 1
OF 2

G:\CAD\175932\Drawings\Structural\BRIDGE-CON-CS-APPROACH_SLAB_1.dwg