

**PLAN-SHOWING TOP SLAB TIE BACK**  
 1:30  
 NORTH WEST CORNER OF UNDERPASS STRUCTURE SHOWN  
 SOUTH EAST CORNER OF UNDERPASS STRUCTURE OPPOSITE HAND

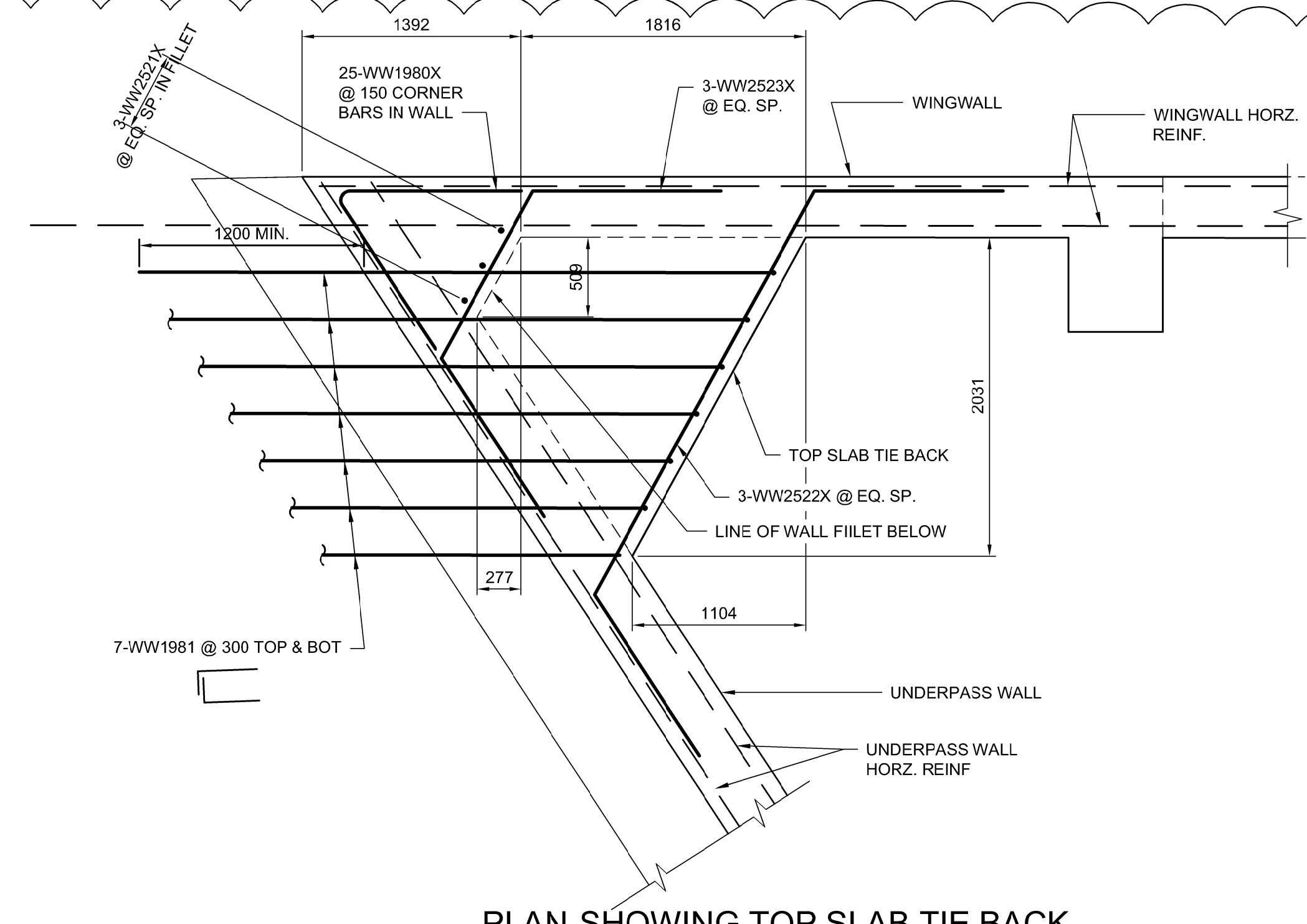

**PLAN-SHOWING TOP SLAB TIE BACK**  
 1:30  
 NORTH EAST CORNER OF UNDERPASS STRUCTURE SHOWN  
 SOUTH WEST CORNER OF UNDERPASS STRUCTURE OPPOSITE HAND

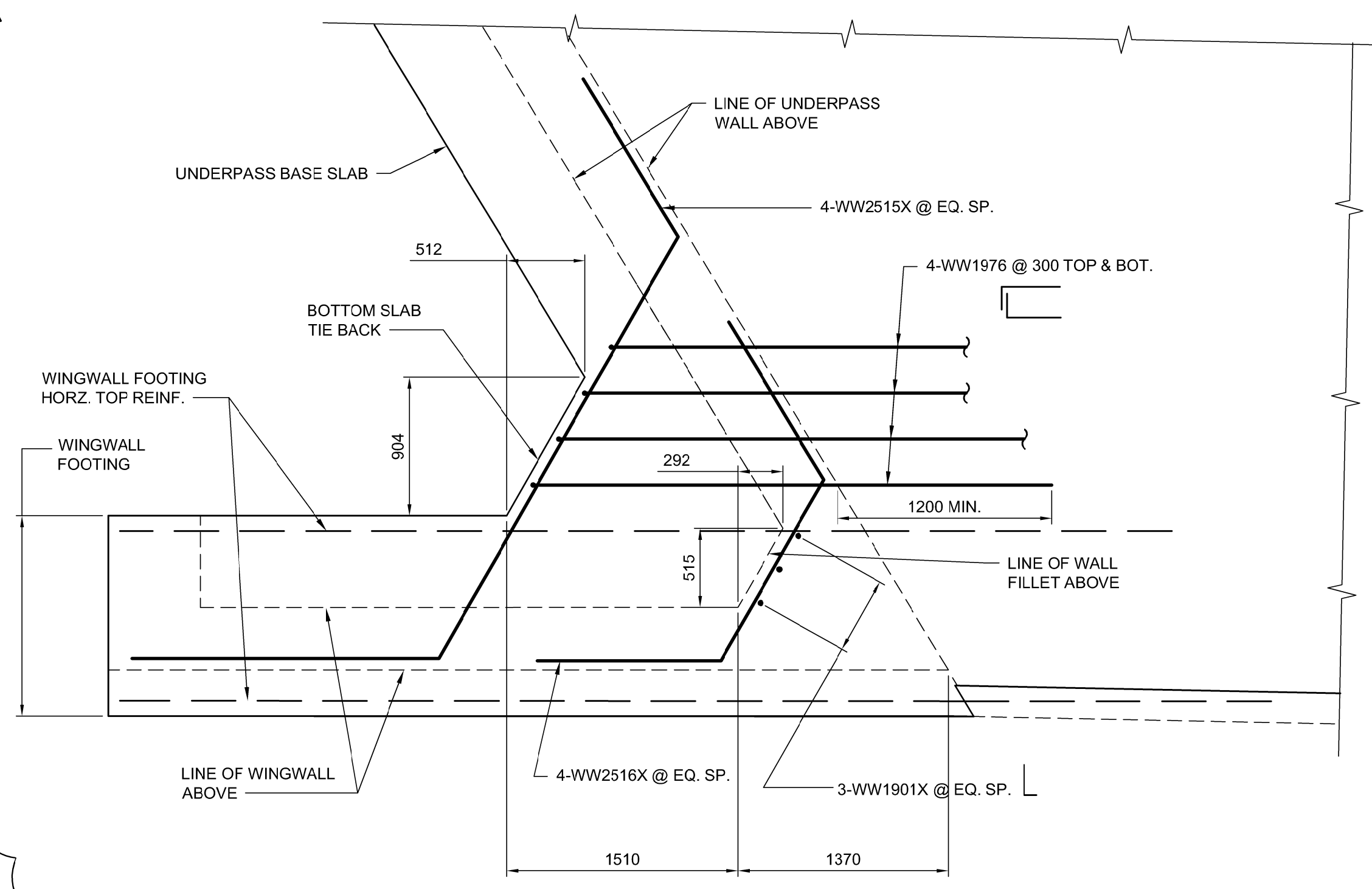

**PLAN-SHOWING BOTTOM SLAB TIE BACK**  
 1:30  
 SOUTH WEST CORNER OF UNDERPASS STRUCTURE SHOWN  
 NORTH EAST CORNER OF UNDERPASS STRUCTURE OPPOSITE HAND

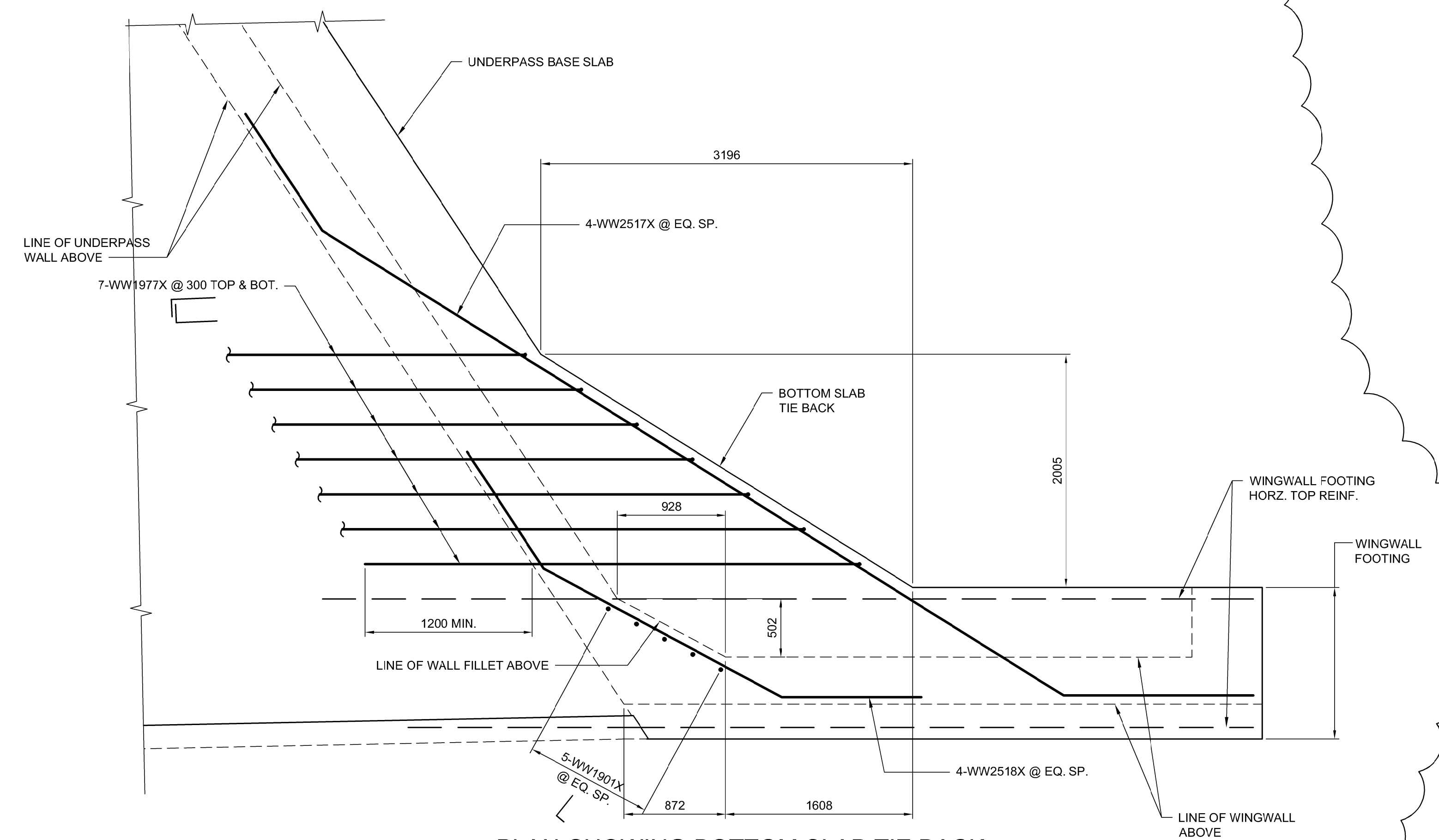

**PLAN-SHOWING BOTTOM SLAB TIE BACK**  
 1:30  
 SOUTH EAST CORNER OF UNDERPASS STRUCTURE SHOWN  
 NORTH WEST CORNER OF UNDERPASS STRUCTURE OPPOSITE HAND

G:\CAD\175932\Drawings\Structural\Underpass-CON-CS-RETAINING WALL DETAILS.dwg

1



NO.	REVISIONS	DATE	BY	DATE
1	ADDENDUM #5	18/03/16	DRA	
0	ISSUED FOR TENDER	18/02/09	DRA	

DESIGNED BY	DRA	CHECKED BY	SSR
DRAWN BY	NBG	APPROVED BY	MBL
HOR. SCALE	AS SHOWN	RELEASED FOR CONSTRUCTION	
VERTICAL SCALE	AS SHOWN	DATE	2018/02/09

ENGINEER'S SEAL  
 PROVINCE OF MANITOBA  
**D.R.C. AMORIM**  
 Member 33215  
 REGISTERED PROFESSIONAL ENGINEER  
 CONSULTANT PROJECT NUMBER  
 17-5932

**THE CITY OF WINNIPEG**  
 PUBLIC WORKS DEPARTMENT  
**Winnipeg**  
**FERMOR AVENUE BRIDGE OVER SEINE RIVER**  
 BRIDGE RE-ABILITATION, PEDESTRIAN-CYCLIST UNDERPASS STRUCTURE AND ROADWORKS FROM ST. ANNE'S ROAD TO ARCHIBALD STREET  
 PEDESTRIAN-CYCLIST UNDERPASS  
 WINGWALL DETAILS 3 OF 3  
 CITY DRAWING NUMBER  
 U-243-2017-CS-080  
 SHEET 080 OF 100  
 CONSULTANT DRAWING NUMBER  
 CS-080