

1 WALL SECTION
A5.1 SCALE: 1:10

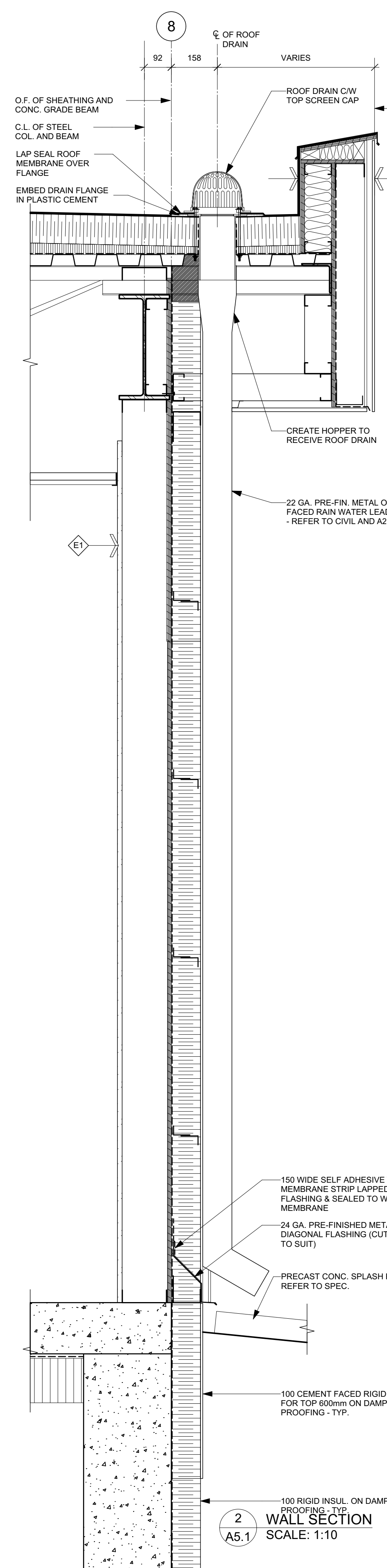

2 WALL SECTION
A5.1 SCALE: 1:10

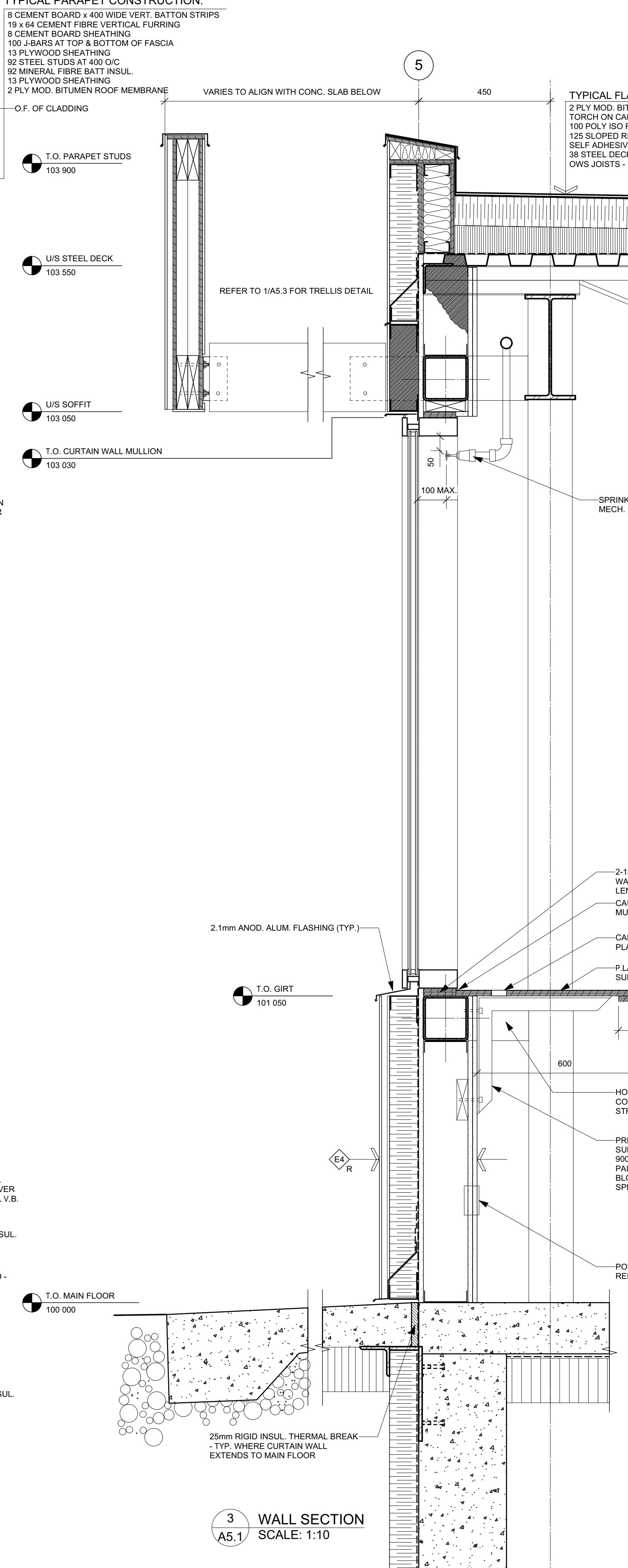

3 WALL SECTION
A5.1 SCALE: 1:10

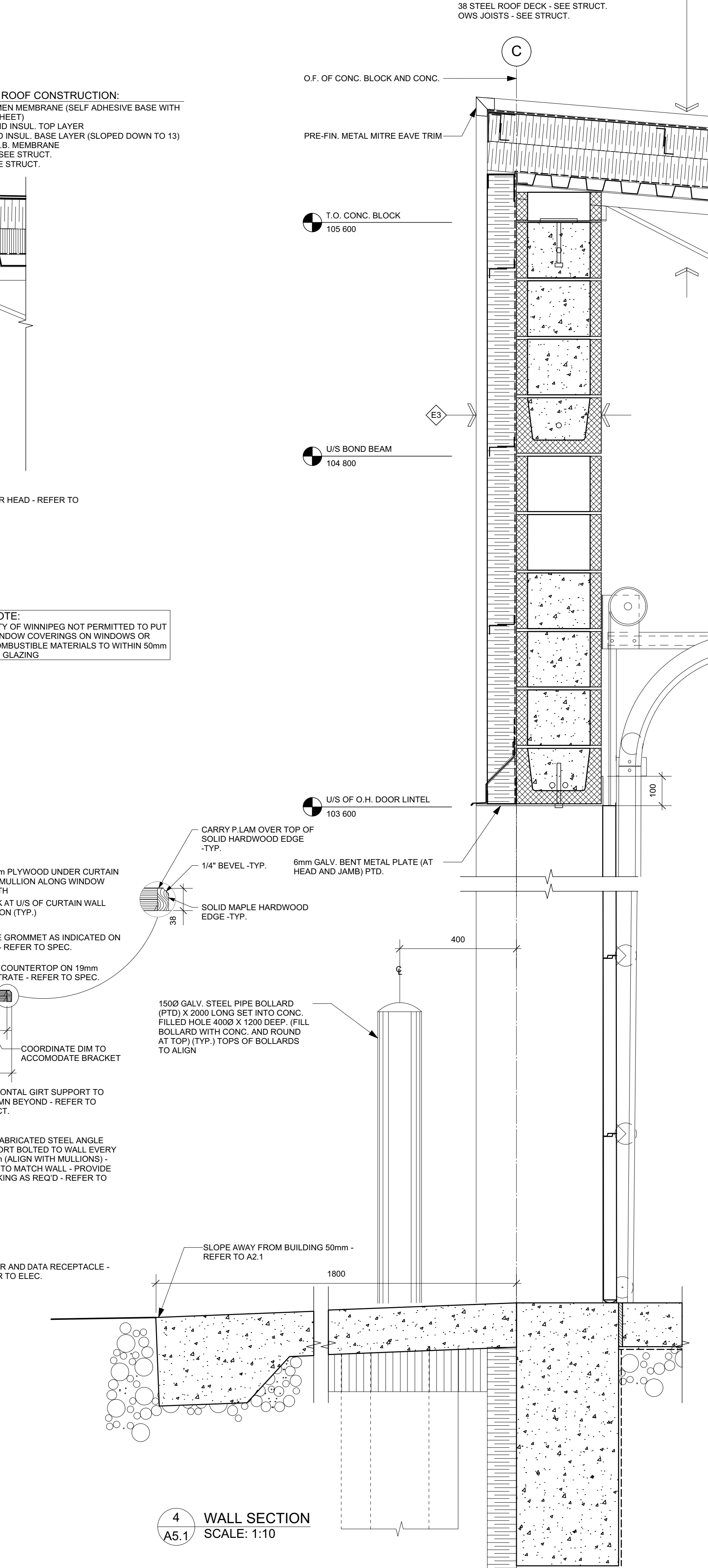

4 WALL SECTION
A5.1 SCALE: 1:10

TYPICAL PARAPET CONSTRUCTION:

- 8 CEMENT BOARD x 400 WIDE VERT. BATTON STRIPS
- 19 x 64 CEMENT FIBRE VERTICAL FURRING
- 6 CEMENT BOARD SHEATHING
- 100 J-BARS AT TOP & BOTTOM OF FASCIA
- 13 PLYWOOD SHEATHING
- 92 STEEL STUDS AT 600 O.C.
- 92 MINERAL FIBRE BATT INSUL.
- 13 PLYWOOD SHEATHING
- 2 PLY MOD. BITUMEN ROOF MEMBRANE

TYPICAL FLAT ROOF CONSTRUCTION:

- 2 PLY MOD. BITUMEN MEMBRANE (SELF ADHESIVE BASE WITH TORCH ON CAP SHEET)
- 100 POLY ISO RIGID INSUL. TOP LAYER
- 125 SLOPED RIGID INSUL. BASE LAYER (SLOPED DOWN TO 1%)
- SELF ADHESIVE V.B. MEMBRANE
- 38 STEEL DECK - SEE STRUCT.
- OWS JOISTS - SEE STRUCT.

TYPICAL METAL ROOF CONSTRUCTION:

- 22 GA. PRE-FINISHED STANDING SEAM METAL ROOF PANELS CW CONCEALED CLIPS & FASTENERS
- WEATHER RESISTANT BARRIER
- 100 Z-BARS AT 600 O.C.
- 100 RIGID INSUL.
- 100 Z-BARS AT 600 O.C.
- 100 RIGID INSUL.
- SELF ADHESIVE V.B. MEMBRANE
- 38 STEEL ROOF DECK - SEE STRUCT.
- OWS JOISTS - SEE STRUCT.

NOTE:
CITY OF WINNIPEG NOT PERMITTED TO PUT WINDOW COVERINGS ON WINDOWS OR COMBUSTIBLE MATERIALS TO WITHIN 50mm OF GLAZING

No.	DATE	REVISION / ISSUANCE
4	YY.MM.DD	-
3	YY.MM.DD	-
2	YY.MM.DD	-
1	YY.MM.DD	-
0	17.06.30	- ISSUED FOR CONSTRUCTION



x | architecture inc.
130 Fort Street, Suite 103 Winnipeg, Manitoba R3C 1C7 204 318 2010

Project: **KILDONAN PARK MAINTENANCE BUILDING**

Sheet Title: **WALL SECTIONS**

Project No. 1559
Date: JUNE 30, 2017
Sheet: **A5.1**