

NOTE: CHAINAGES SHOWN ARE ALONG E.P. OF KENSINGTON STREET

KENSINGTON STREET

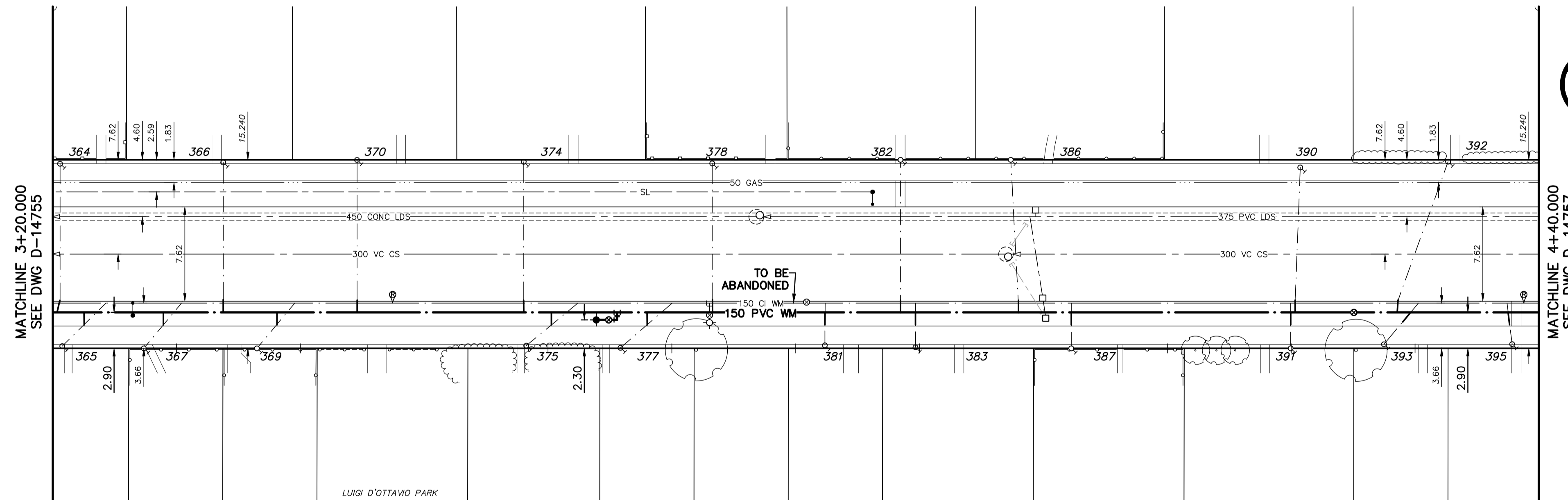

WATER SERVICE INFORMATION

ADDRESS	SIZE (mm) MATERIAL (STREET)	SIZE (mm) MATERIAL (PROP.)	SHORT & LONG MEASUREMENT	CORP. LOCATION	REMARKS
364 KENSINGTON ST	-	20	-	-	RECONNECT SERVICE
RESIDENTIAL	-	CU	-	-	-
365 KENSINGTON ST	-	20	1.22 SNHL	48.77 FROM HYD	RECONNECT SERVICE
RESIDENTIAL	-	CU	-	-	-
366 KENSINGTON ST	-	-	4.57 SNHL	-	RECONNECT SERVICE
RESIDENTIAL	-	-	-	-	-
367 KENSINGTON ST	-	20	0.61 NSHL	42.67 FROM HYD	RECONNECT SERVICE
RESIDENTIAL	-	CU	-	-	-
369 KENSINGTON ST	-	-	2.29 NSHL	33.53 FROM HYD	RECONNECT SERVICE
RESIDENTIAL	-	-	-	-	-
370 KENSINGTON ST	-	-	1.52 NSHL	-	RECONNECT SERVICE
RESIDENTIAL	-	-	-	-	-
374 KENSINGTON ST	-	-	0.91 NSHL	-	RECONNECT SERVICE
RESIDENTIAL	-	-	-	-	-
376 KENSINGTON ST	-	25	0.70 NSHL	10.67 FROM HYD	RECONNECT SERVICE
RESIDENTIAL	-	LEAD	-	-	-
377 KENSINGTON ST	-	20	1.0 NSHL	3.05 FROM HYD	RECONNECT SERVICE
RESIDENTIAL	-	CU	-	-	-
378 KENSINGTON ST	-	-	3.51 NSHL	-	RECONNECT SERVICE
RESIDENTIAL	-	-	-	-	-
381 KENSINGTON ST	20	20	2.6 NSHL	9.3 N HYD	RECONNECT SERVICE
RESIDENTIAL	CU	CU	-	-	-
382 KENSINGTON ST	-	-	4.48 SNHL	-	RECONNECT SERVICE
RESIDENTIAL	-	-	-	-	-
383 KENSINGTON ST	-	-	0.70 NSHL	-	RECONNECT SERVICE
RESIDENTIAL	-	-	-	-	-
386 KENSINGTON ST	-	-	0.31 SNHL	-	RECONNECT SERVICE
RESIDENTIAL	-	-	-	-	-
387 KENSINGTON ST	-	-	2.80 NSHL	-	RECONNECT SERVICE
RESIDENTIAL	-	-	-	-	-
390 KENSINGTON ST	-	25	2.13 NSHL	47.24 N HYD OPP 379 KENSINGTON ST	RECONNECT SERVICE
RESIDENTIAL	-	CU	-	-	-
391 KENSINGTON ST	20	20	3.9 SNHL	OPP SC	RECONNECT SERVICE
RESIDENTIAL	CU	CU	-	-	-
392 KENSINGTON ST	25	25	1.52 NSHL	54.86 S HYD OPP 409 KENSINGTON ST	RECONNECT SERVICE
RESIDENTIAL	CU	CU	55.47 S HYD OPP 409 KENSINGTON ST	-	-
393 KENSINGTON ST	-	-	1.52 NSHL	63.34 S HYD OPP 409 KENSINGTON ST	RECONNECT SERVICE
RESIDENTIAL	-	-	-	-	-
395 KENSINGTON ST	20	20	2.53 SNLL	-	RECONNECT SERVICE
RESIDENTIAL	CU	CU	-	-	-

* SERVICES TO BE RENEWED TO R. ALL OTHERS TO BE RECONNECTED



FOR INDEX SEE D-14739

NOTE: ALL VALVES TO BE INSTALLED COUNTER-CLOCKWISE TO CLOSE

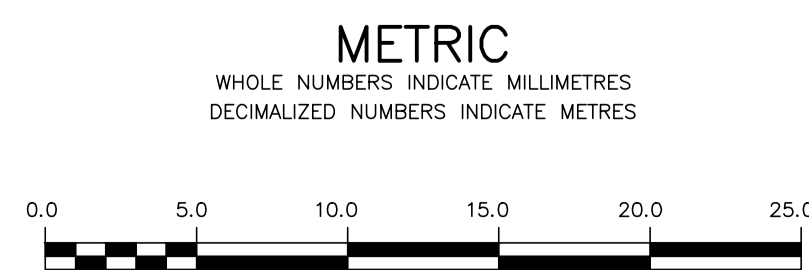

WARNING
IF POWER EQUIPMENT OR EXPLOSIVES ARE TO BE USED FOR EXCAVATION ON THIS PROJECT THE CONTRACTOR MUST:
1) NOTIFY THE GAS COMPANY OF THE PROPOSED LOCATION OF EXCAVATION.
2) TAKE PRECAUTION TO AVOID DAMAGE TO GAS COMPANY INSTALLATIONS.
SEE PROVINCIAL REGULATION 2107/2 FOR DETAILS

LOCATION APPROVED UNDERGROUND STRUCTURES
SUPV. U/G STRUCTURES COMMITTEE DATE
NOTE:
LOCATION OF UNDERGROUND STRUCTURES AS SHOWN ARE BASED ON THE BEST INFORMATION AVAILABLE BUT NO GUARANTEE IS GIVEN THAT ALL EXISTING UTILITIES ARE SHOWN OR THAT THE GIVEN LOCATIONS ARE EXACT. CONFIRMATION OF EXISTENCE AND EXACT LOCATION OF ALL SERVICES MUST BE OBTAINED FROM THE INDIVIDUAL UTILITIES BEFORE PROCEEDING WITH CONSTRUCTION.

B.M. 38-022	Century & King Edward St. in Island Median,
ELEV. 234.744	10ft. in 7.6 m Conc. pile, 14.97 E. of Cl. King Edward St., 18.65 m W. of Cl. Century St. & 11.58 m S. of Cl. N. Yield Lane.
NO.	REVISIONS
	DATE
	BY

DESIGNED BY	JKH	CHECKED BY	HAK
DRAWN BY	DML	APPROVED BY	BWB
SCALE:		RELEASED FOR CONSTRUCTION	KAS ZUREK
HORIZONTAL	1:250	DATE	2017 05 17
VERTICAL	1:50	DATE	2017 05 17

ENGINEER'S SEAL
ORIGINAL SIGNED BY H.A. KATZ
2017 05 17
CONSULTANT DRAWING NUMBER

THE CITY OF WINNIPEG
WATER AND WASTE DEPARTMENT
ENGINEERING DIVISION
2017 WATER MAIN RENEWALS
CONTRACT 9
KENSINGTON STREET
220 m N OF NELL AVENUE TO
64 m S OF SILVER AVENUE
SHEET 19 OF 21
CITY DRAWING NUMBER
D-14756