

NOTE: CHAINAGES SHOWN ARE ALONG  
E R OF QUAIL RIDGE ROAD

QUAIL RIDGE ROAD (EAST LEG)

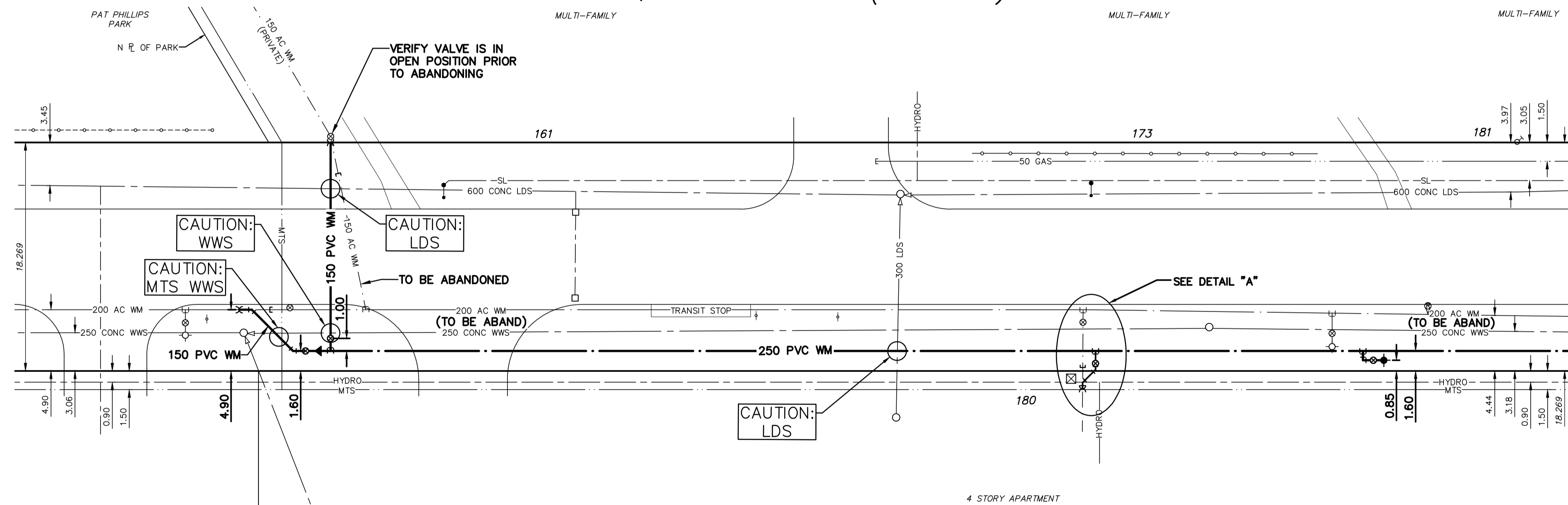

WATER SERVICE INFORMATION

ADDRESS	SIZE (mm) MATERIAL (STREET)	SIZE (mm) MATERIAL (PROP.)	SHORT & LONG MEASUREMENT	CORP. LOCATION	REMARKS
161 QUAIL RIDGE RD RESIDENTIAL	150 AC	150 AC	4.9 NSL OF PARK	2.8 N OF VALVE ON E PL 7.8 NSL OF PARK	RENEW SERVICE TO PL DOMESTIC AND FIRE SERVICE FOR 9 SEPARATE BLDGS.
173 QUAIL RIDGE RD RESIDENTIAL	-	-	-	-	COMMON SERVICE FOR #161 QUAIL RIDGE RD
180 QUAIL RIDGE RD RESIDENTIAL	150	150	65.8 NSL OF LOT	OPP. VALVE	DOMESTIC AND FIRE SERVICE LINE FOR BLDGS.
181 QUAIL RIDGE RD RESIDENTIAL	-	-	-	-	COMMON SERVICE FOR #161 QUAIL RIDGE RD

\* SERVICES TO BE RENEWED TO R. ALL OTHERS TO BE RECONNECTED

NITRILE GASKETS REQUIRED FOR  
JOINTS ON ALL WATER MAIN  
PIPE ON QUAIL RIDGE ROAD

METRIC

WHOLE NUMBERS INDICATE MILLIMETRES  
DECIMALIZED NUMBERS INDICATE METRES



**WARNING**  
IF POWER EQUIPMENT OR EXPLOSIVES  
ARE TO BE USED FOR EXCAVATION ON THIS  
PROJECT THE CONTRACTOR MUST:  
1) NOTIFY THE GAS COMPANY OF THE  
PROPOSED LOCATION OF EXCAVATION.  
2) TAKE PRECAUTION TO AVOID DAMAGE TO  
GAS COMPANY INSTALLATIONS.  
SEE PROVINCIAL REGULATION 210/72 FOR DETAILS

**LOCATION APPROVED**  
UNDERGROUND STRUCTURES  
SUPV. U/G STRUCTURES  
COMMITTEE DATE  
NOTE:  
LOCATION OF UNDERGROUND STRUCTURES AS  
SHOWN ARE BASED ON THE BEST INFORMATION  
AVAILABLE BUT NO GUARANTEE IS GIVEN THAT ALL  
EXISTING UTILITIES ARE SHOWN OR THAT THE GIVEN  
LOCATIONS ARE EXACT. CONFIRMATION OF  
EXISTENCE AND EXACT LOCATION OF ALL  
SERVICES MUST BE OBTAINED FROM THE INDIVIDUAL  
UTILITIES BEFORE PROCEEDING WITH CONSTRUCTION.

B.M. ELEV.	40-011 238.803	N. side Quail Ridge Rd., Tblt. In N. Conc. foundation of Spring Valley School, No. 81 Quail Ridge Rd., 2 m E. & 1.5 m below Tyndall Stone of N.W. Cor. of school.
NO.	REVISIONS	DATE BY

DESIGNED BY	JKH	CHECKED BY	HAK
DRAWN BY	DML	APPROVED BY	BWB
SCALE: HORIZONTAL VERTICAL	1:250 1:50	RELEASED FOR CONSTRUCTION	KAS ZUREK
DATE	2017 05 11	DATE	2017 05 17

**ENGINEERS  
GEO-SCIENTISTS**  
Certificate of Authorization  
MORRISON HERSHFIELD  
No. 1736

FOR INDEX SEE  
D-14739

NOTE: ALL VALVES TO BE INSTALLED  
CLOCKWISE TO CLOSE

ENGINEER'S SEAL  
ORIGINAL SIGNED  
BY H.A. KATZ  
2017 05 17  
CONSULTANT DRAWING NUMBER

**THE CITY OF WINNIPEG**  
WATER AND WASTE DEPARTMENT  
ENGINEERING DIVISION  
2017 WATER MAIN RENEWALS  
CONTRACT 9  
**QUAIL RIDGE ROAD (EAST LEG)**  
133 m N OF QUAIL RIDGE ROAD (S LEG) TO  
60 m S OF APPLE LANE  
SHEET 5 OF 21  
CITY DRAWING NUMBER  
**D-14742**