

**TYPICAL PAVEMENT SECTION**  
CONCRETE PAVEMENT STRUCTURE  
SCALE: NTS

CHAINAGE ALONG  
C OF R.O.W.

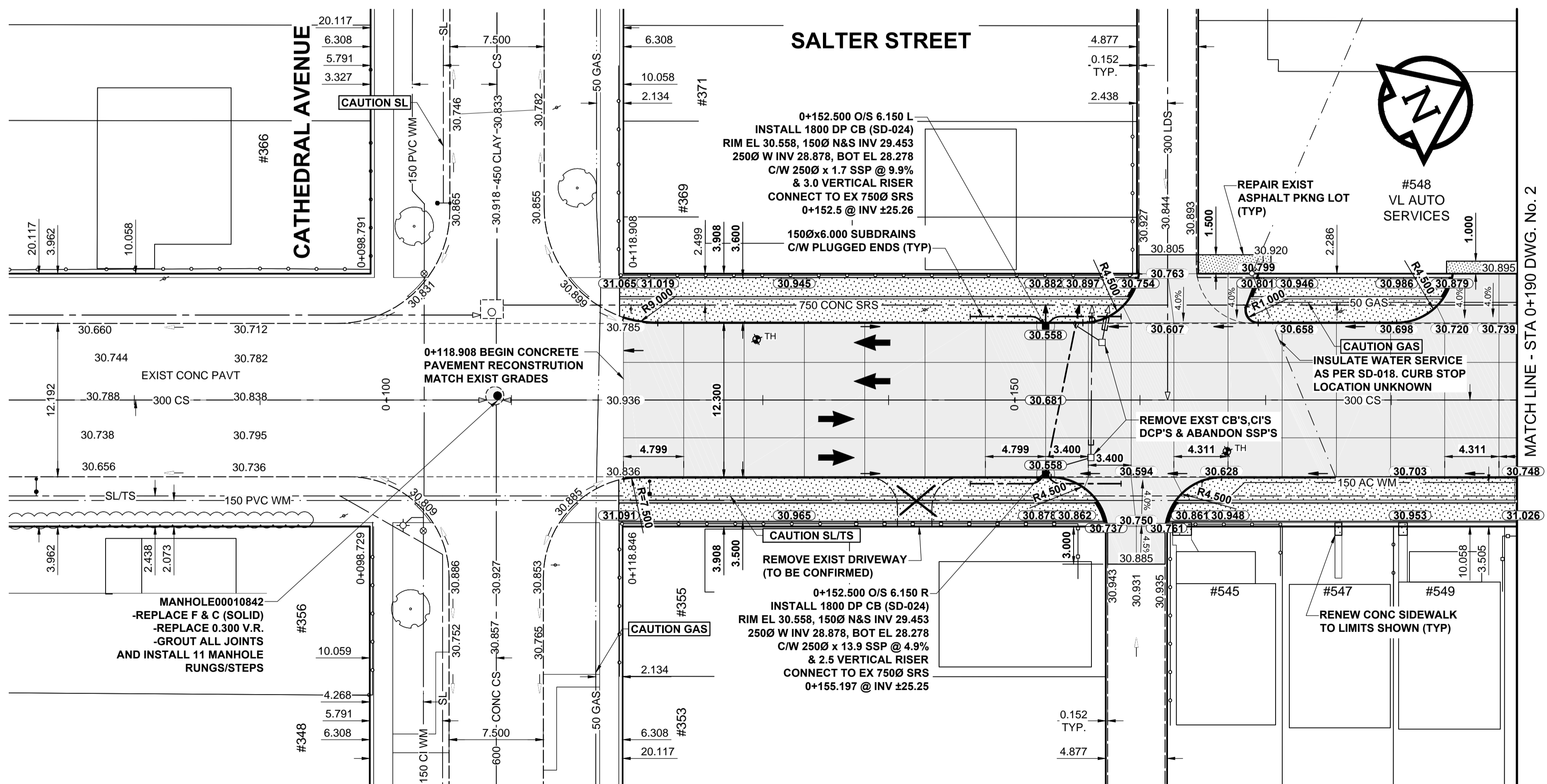

HORIZONTAL CONTROL POINTS-PROJECT COORDINATES					NAD83 DATUM		
CONTROL POINT	LOCATION	NORTHING	EASTING	ELEVATION	NORTHING	EASTING	ELEVATION
#1	SURVEY BAR @ W/P.L. SALTER AND S/P.L. BANNERMAN	9640.905	10051.600	230.845	5532166.729	634066.916	-
#2	10' OFFSET SURVEY BAR @ W/P.L. SALTER AND S/P.L. OF INKSTER	9914.559	10182.458	231.395	5532440.363	634197.792	-

NOTE: THE PROJECT DRAWINGS HAVE A SCALE FACTOR OF 1.000032968 APPLIED TO LBS INFORMATION TO MATCH LOCAL SURVEYED PROJECT COORDINATES

- NOTES**
- ADJUST MH AND CB RIMS TO NEW GRADES.
  - CONTRACTOR TO REGRADE/RENEW EXIST PRIVATE SIDEWALKS TO LIMITS AS SHOWN. SIDEWALKS TO BE RENEWED WITH CONCRETE UNLESS NOTED OTHERWISE.
  - CONTRACTOR TO TAKE PRECAUTIONARY STEPS, AS OUTLINED IN THE SPECIFICATIONS, TO PROTECT EXISTING TREES WITHIN THE LIMITS OF CONSTRUCTION FROM DAMAGE FROM CONSTRUCTION ACTIVITIES.
  - MODIFIED BARRIER CURB TO BE CONSTRUCTED AT ALL INTERSECTION RADII, BACK LANE RADII AND BULLNOSES.
  - CONTRACTOR TO CONFIRM THE LOCATION OF ALL UTILITIES/SERVICES IN THE FIELD PRIOR TO CONSTRUCTION.
  - ADD 200.000m TO ABBREVIATED ELEVATIONS TO OBTAIN GEODETIC ELEVATIONS.
  - CB SD-024 OFFSETS ARE DIMENSIONED TO BOC. CB SD-025 OFFSETS ARE DIMENSIONED O/C.
  - ALL DIMENSIONS TO BACK OF CURB.
  - ALL EXISTING LONG WATER SERVICES TO BE INSULATED (SD-018). REFER TO BID OPPORTUNITY FOR FURTHER REQUIREMENTS.
  - REFER TO C.O.W. WATERMAIN RENEWALS CONTRACT No.5 BID OPPORTUNITY 178-2017 FOR WATERMAIN RENEWAL INFORMATION. (NOT IN CONTRACT).

GEODETIC BENCHMARK-VERTICAL CONTROL POINTS		
GBM	LOCATION	ELEVATION
26-002	Tbtl. in 7.60m Conc. pile, 14.9m N. of S.L. of Inkster Boulevard & 5.0m E. of W.L. of Powers Street	231.050m



**METRIC**  
WHOLE NUMBERS INDICATE MILLIMETRES  
DECIMALIZED NUMBERS INDICATE METRES

EXISTING	LEGEND - PLAN	NEW	EXISTING	LEGEND - PLAN	NEW	EXISTING	LEGEND - PLAN	NEW
	GAS		MANHOLE		CONCRETE PAVEMENT		LOCATION APPROVED	
	MTS / PEDESTAL		CATCH BASIN / CATCH PIT		CONC SIDEWALK / MEDIAN		UNDERGROUND STRUCTURES	
	HYDRO / CABINET		CURB INLET WITH BOX		ASPHALT PAVEMENT		SUPR. U/G STRUCTURES	
	CATV / FIBRE OPTIC		TREE		PAVING STONE		DATE	
	TRAFFIC SIGNALS / PIT		TEST HOLE		GRAVEL		NOTE:	
	LAND DRAINAGE SEWER		PROPERTY LINE		RAMP CURB		LOCATION OF UNDERGROUND STRUCTURES	
	SANITARY/COMBINED SEWER		SURVEY BAR		PLANING / REMOVAL		UTILITIES ARE SHOWN OR THAT THE GIVEN LOCATIONS ARE EXACT. CONFIRMATION OF EXISTENCE AND EXACT LOCATION OF ALL SERVICES MUST BE OBTAINED FROM THE INDIVIDUAL UTILITIES BEFORE PROCEEDING WITH CONSTRUCTION.	
	CB LEAD / SSP / DCP		FENCE					
	WATER MAIN		BOC / EDGE OF PAVEMENT					
	SUBDRAIN		ELEVATION					
	DITCH		TRAFFIC SIGN					

BM 26-002	ELEV 231.050 m		
DESIGNED BY		WRJ	CHECKED BY
DRAWN BY		DID	APPROVED BY
BY			
B	ISSUED FOR TENDER	17/05/09	RPB
A	ISSUED FOR CLIENT REVIEW	17/04/19	RPB
No.	REVISIONS	YY/MM/DD	BY
HOR SCALE		1:250	
VERT SCALE		1:10	
DATE		17/05/09	
RELEASED FOR CONSTRUCTION			
DATE			

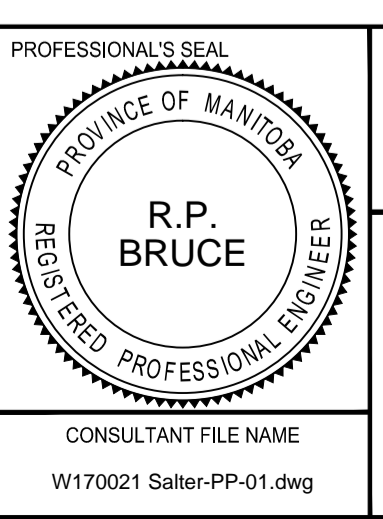

**THE CITY OF WINNIPEG**  
PUBLIC WORKS DEPARTMENT  
ENGINEERING DIVISION

2017 REGIONAL AND LOCAL STREET RENEWAL PROGRAM

**SALTER STREET RECONSTRUCTION**  
CATHEDRAL AVENUE TO INKSTER BOULEVARD  
HORIZONTAL AND VERTICAL ALIGNMENT  
STA 0+070 TO STA 0+190

CITY DRAWING NUMBER P-3481-1  
SHEET 1 OF 4  
DRAWING No. 1 REV B

CONSULTANT FILE NAME: W170021 Salter-PP-01.dwg

BID OPPORTUNITY No. 299-2017