

LINE/CURVE TABLE								
SEGMENT	RADIUS	LENGTH/CURVE LENGTH	TANGENT	DELTA Δ	START POINT	END POINT	START STATION	END STATION
C12	35.56	30.18	16.065	48°37'42"	N: 5534492.0376 E: 629193.7452	N: 5534518.5039 E: 629181.2191	0+400.00	0+430.18
L11		7.87			N: 5534518.5039 E: 629181.2191	N: 5534523.6476 E: 629175.2560	0+430.18	0+438.05

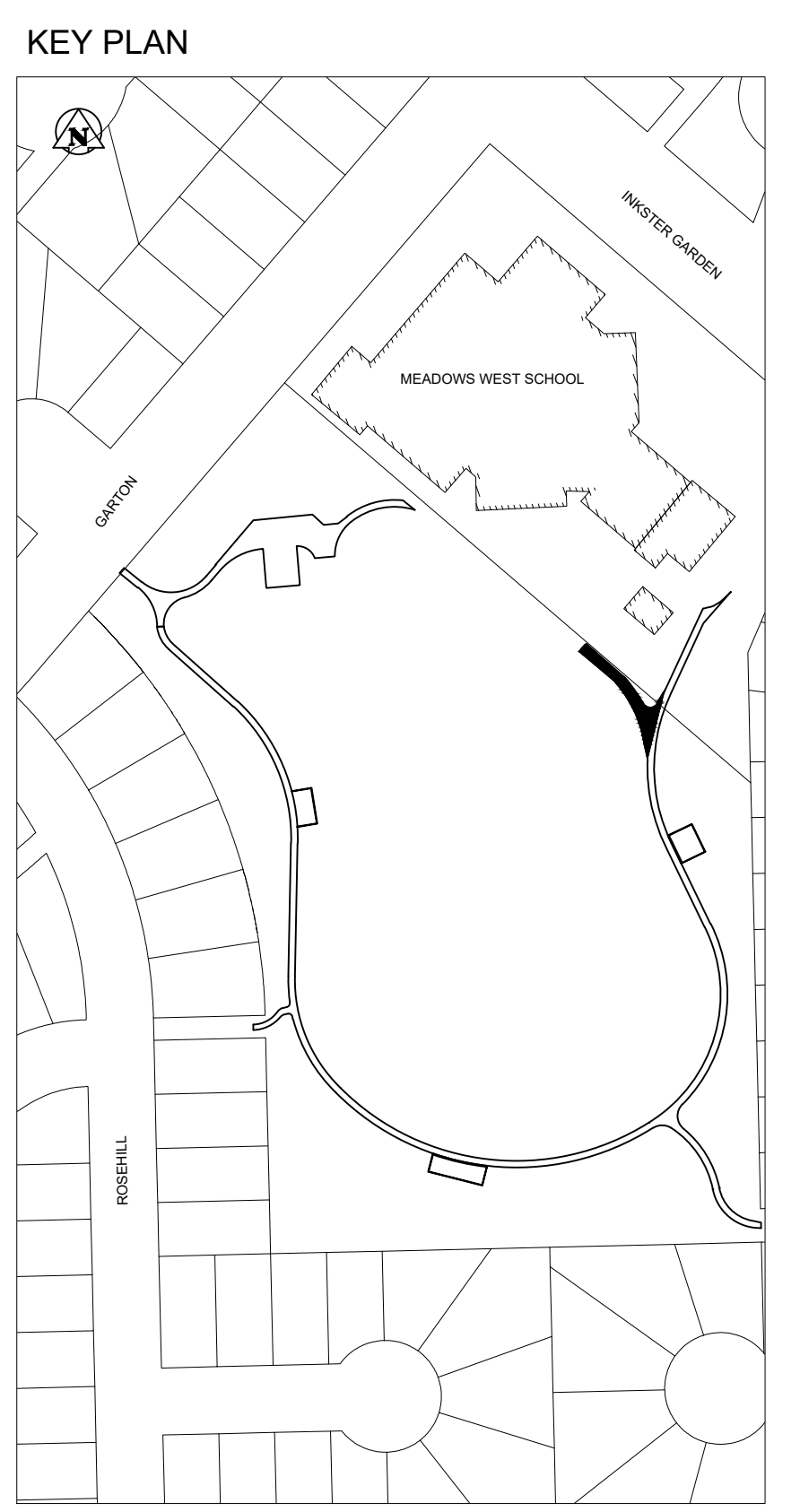
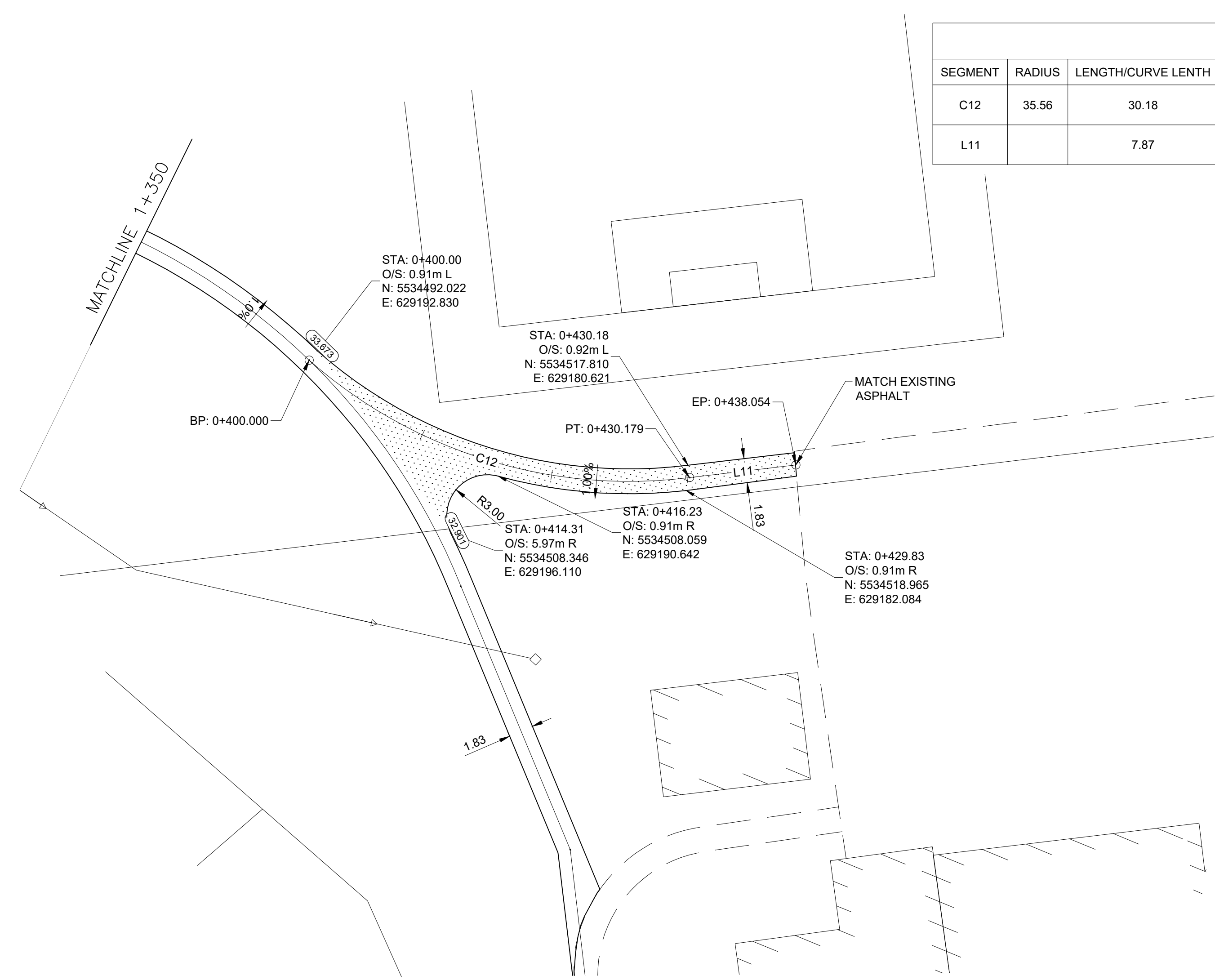

WARNING

IF POWER EQUIPMENT OR EXPLOSIVES ARE TO BE USED FOR EXCAVATION ON THIS PROJECT THE CONTRACTOR MUST:

1. NOTIFY THE GAS COMPANY OF THE PROPOSED LOCATION OF EXCAVATION.
2. TAKE PRECAUTION TO AVOID DAMAGE TO GAS COMPANY INSTALLATIONS SEE PROVINCIAL REGULATION 210/72 FOR DETAILS.
3. OBTAIN EXCAVATION PERMITS PRIOR TO CONSTRUCTION.

CHAINAGE MEASURED ALONG ϵ OF PATHWAY

- NOTES:**
1. THE CONTRACTOR SHALL OBTAIN ALL NECESSARY PERMITS, PAY ALL NECESSARY FEES AND GIVE ALL NECESSARY NOTICES.
 2. CONTRACTOR SHALL TAKE PRECAUTIONARY STEPS TO PROTECT EXISTING TREES WITHIN THE LIMITS OF ACTIVITIES AS OUTLINED IN THE SPECIFICATIONS
 3. CONTRACTOR TO CONFIRM THE LOCATION OF ALL UTILITIES/SERVICES IN THE FIELD PRIOR TO CONSTRUCTION THROUGHOUT THE PROJECT.
 4. THE CONTRACTOR SHALL PROVIDE CONSTRUCTION LAYOUT
 5. RESTORATION OF THE SITE TO EQUAL OR BETTER CONDITION TO BE COMPLETED IMMEDIATELY FOLLOWING CONSTRUCTION ACTIVITIES AT CONTRACTORS EXPENSE.
 6. SIDESLOPE TO BE 4:1 MAX. CONTRACTOR IS TO CONSTRUCT WHERE POSSIBLE TO MIN. SLOPE OF 10:1.

150 mm WM	WATERMAIN	150 mm WM	HYDRANT	MTS	GRANULAR	LIMIT OF ASPHALT	ASPHALT	ELEVATIONS	PROPERTY LINE	SURVEY BAR	CURB STOP	RAMP CURB	EXISTING	PROPOSED	EXISTING	LEGEND - PLAN	PROPOSED	EXISTING	LEGEND - PROFILE	PROPOSED
⊕	HYDRANT	⊕	VALVE	⊕	⊕	⊕	⊕	(99.892)	---	⊕	⊕	⊕	---	---	---	---	---	---	---	---
⊕	LAND DRAINAGE SEWER	⊕	WASTE WATER SEWER	⊕	⊕	⊕	⊕	---	---	---	---	---	---	---	---	---	---	---	---	---
⊕	MANHOLE	⊕	CATCH BASIN	⊕	⊕	⊕	⊕	---	---	---	---	---	---	---	---	---	---	---	---	---
⊕	CURB INLET	⊕	HYDRANT	⊕	⊕	⊕	⊕	---	---	---	---	---	---	---	---	---	---	---	---	---
⊕	LAMP STANDARD	⊕	GAS	⊕	⊕	⊕	⊕	---	---	---	---	---	---	---	---	---	---	---	---	---
---	LEGEND - PLAN	---	PROPOSED	---	---	---	---	---	---	---	---	---	---	---	---	---	---	---	---	---

UNDERGROUND STRUCTURES

SUPV. U/G STRUCTURES COMMITTEE DATE

NOTE:
LOCATION OF UNDERGROUND STRUCTURES AS SHOWN ARE BASED ON THE BEST INFORMATION AVAILABLE, BUT NO GUARANTEE IS GIVEN THAT ALL EXISTING UTILITIES ARE SHOWN OR THAT THE GIVEN LOCATIONS ARE EXACT. CONFIRMATION OF EXISTENCE AND EXACT LOCATION OF ALL SERVICES MUST BE OBTAINED FROM THE INDIVIDUAL UTILITIES BEFORE PROCEEDING WITH CONSTRUCTION.

B.M. CENTER OF MH AT STA 1+148 BEHIND 26 ROSE HILL WAY	ELEV. 232.107
DESIGNED BY	PRD
CHECKED BY	IL
DRAWN BY	PRD
APPROVED BY	SP
HOR. SCALE:	1 : 250
VERTICAL:	1 : 10
RELEASED FOR CONSTRUCTION	DATE
DATE	17/04/07
NO. REVISIONS	YYMMDD BY

URBAN DESIGN DIVISION
PARKS PLANNING & DEVELOPMENT

DESIGNED BY PRD CHECKED BY IL

DRAWN BY PRD APPROVED BY SP

HOR. SCALE: 1 : 250

VERTICAL: 1 : 10

RELEASED FOR CONSTRUCTION

DATE 17/04/07

PROFESSIONAL'S SEAL

PRELIMINARY

NOT FOR CONSTRUCTION

CONSULTANT PROJECT NUMBER

N/A

THE CITY OF WINNIPEG
PLANNING, PROPERTY & DEVELOPMENT DEPARTMENT

ROSEHILL PARK
FITNESS PATH

ROSEHILL PARK - 186 GARTON AVE.
HORIZONTAL & VERTICAL ALIGNMENT
STA 0+400 TO STA 0+438

BID OPPORTUNITY NUMBER
298-2017

SHEET 11 OF 12

CITY DRAWING NUMBER
R.28D11

V:\Design\Branch\Projects\2016_33_Rosehill_Paths\0300_drawing\0305_working\sheet_files\ROSEHILL-202-2017.dwg 4/7/2017 2:18 PM