

D SIZE 22" x 34" (559mm x 864mm)

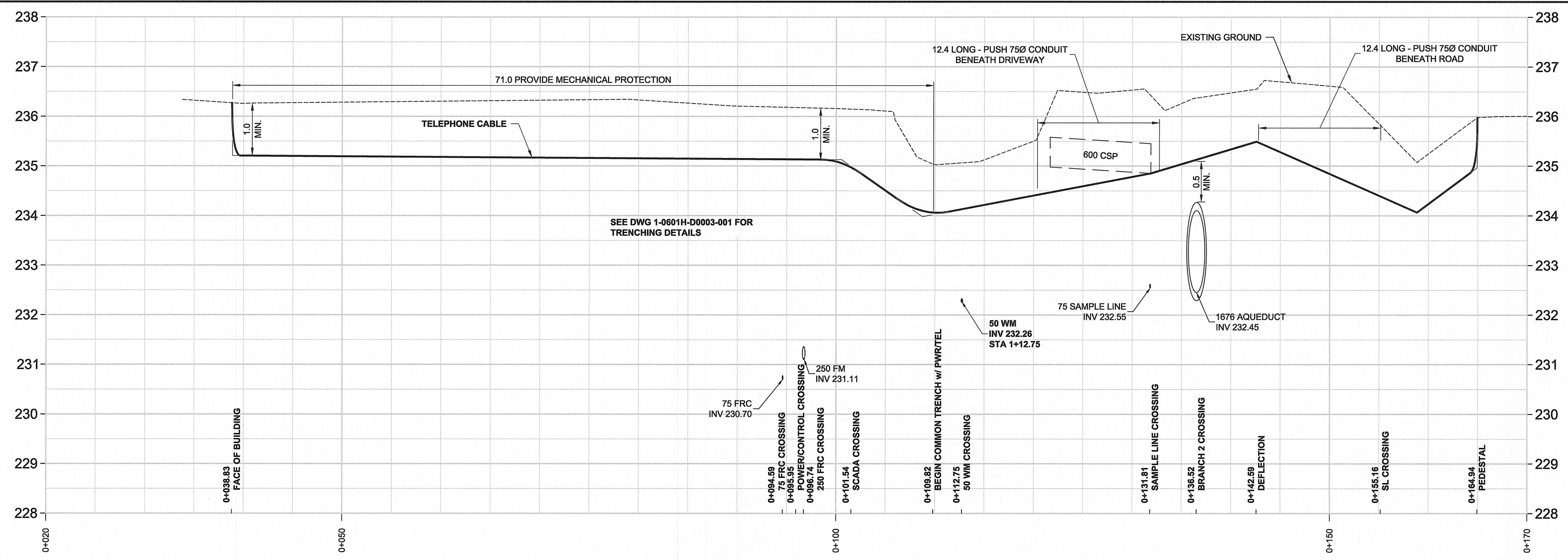

PLOT: 3/29/2017 3:20:31 PM

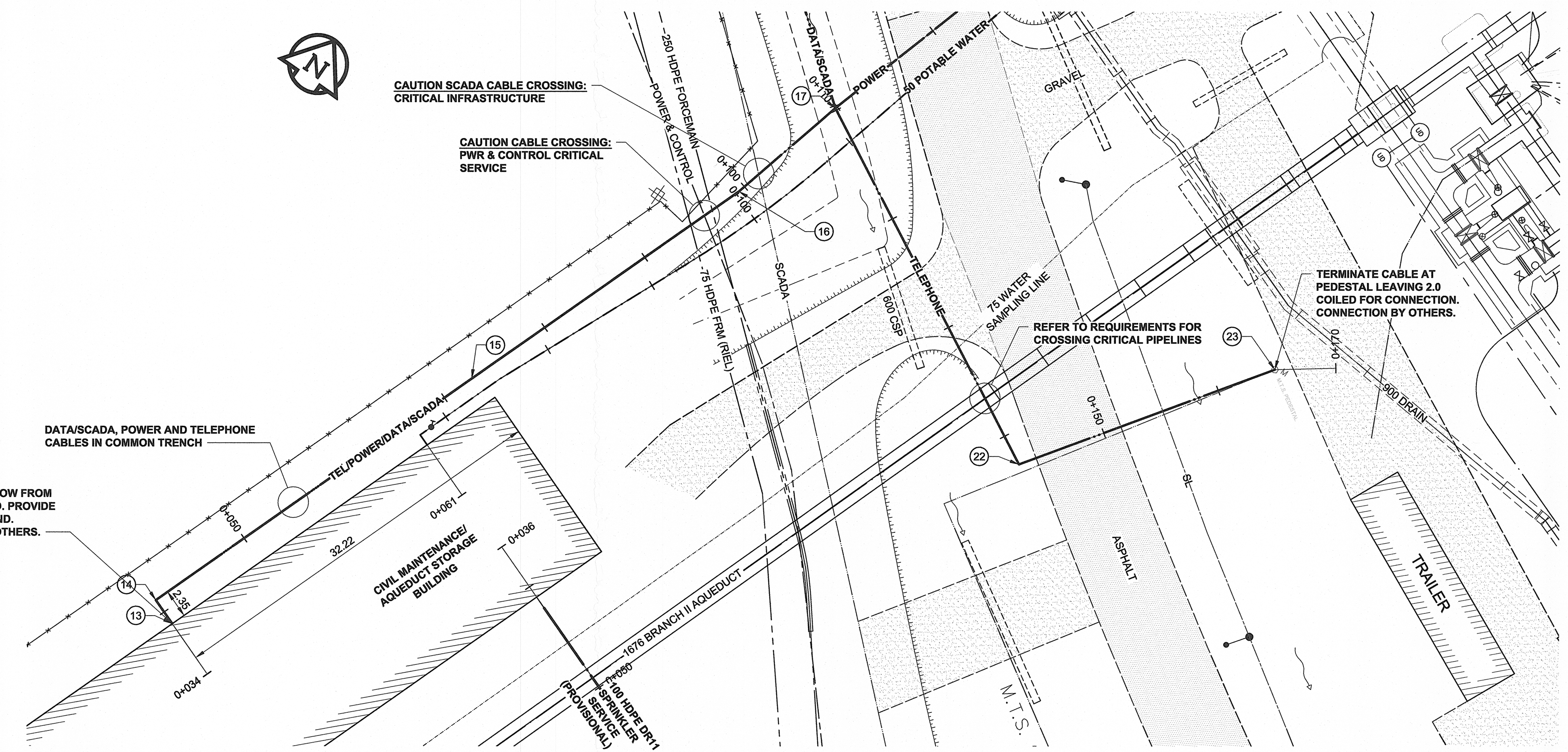

Coordinate Table			
Point #	Northing	Easting	Description
13	5523917.32	647668.38	SCADA/POWER/TELEPHONE PT 1
14	5523918.13	647666.17	SCADA/POWER/TELEPHONE PT 2
15	5523947.73	647677.06	SCADA/POWER/TELEPHONE PT 3
16	5523972.77	647686.27	SCADA/POWER/TELEPHONE PT 4
17	5523982.85	647688.88	SCADA/POWER/TELEPHONE PT 5
22	5523967.61	647717.89	TELEPHONE PT 6
23	5523985.94	647730.68	TELEPHONE PT 7

- NOTES:
- SOFT DIG AND EXPOSE ALL UTILITIES AT CROSSING POINTS PRIOR TO TRENCHING. ADJUST TRENCH ELEVATIONS AS DIRECTED WHERE NEW PLANT ELEVATION CONFLICTS WITH EXISTING.
  - ALL TRENCHES IN OR WITHIN 1.0 OF ROADWAYS ARE TO BE BACKFILLED WITH CLASS 2 BACKFILL. BACKFILL IN LANDSCAPED AREAS IS TO BE CLASS 4 BACKFILL.
  - PROVIDED COMPACTED GRANULAR MATERIAL TO SUPPORT UTILITIES WHERE CROSSING BENEATH.
  - RESTORE ALL SURFACES TO A CONDITION EQUAL TO OR BETTER THAN ORIGINAL CONDITIONS.

**METRIC**  
WHOLE NUMBERS INDICATE MILLIMETRES  
DECIMALIZED NUMBERS INDICATE METRES

SYMBOL	DESCRIPTION	SYMBOL	DESCRIPTION	SYMBOL	DESCRIPTION
150 WM	WATERMAIN	150 WM	WATERMAIN	150 WM	WATERMAIN
HYDRANT	HYDRANT	REDUCER	REDUCER	HYDRANT	HYDRANT
VALVE	VALVE	COUPLING	COUPLING	VALVE	VALVE
300 LDS	LAND DRAINAGE SEWER	300 LDS	LAND DRAINAGE SEWER	300 LDS	LAND DRAINAGE SEWER
250 WWS	WASTE WATER SEWER	250 WWS	WASTE WATER SEWER	250 WWS	WASTE WATER SEWER
MANHOLE	MANHOLE	MTS	MTS	MANHOLE	MANHOLE
CATCH BASIN	CATCH BASIN	GAS	GAS	CATCH BASIN	CATCH BASIN
CURB INLET	CURB INLET	TESTHOLE	TESTHOLE	CURB INLET	CURB INLET
CULVERT	CULVERT	LAMP STANDARD	LAMP STANDARD	CULVERT	CULVERT
PIPE ABANDONMENTS	PIPE ABANDONMENTS	TREE	TREE	PIPE ABANDONMENTS	PIPE ABANDONMENTS
SURVEY BAR	SURVEY BAR			SURVEY BAR	SURVEY BAR
EXISTING	LEGEND - PLAN	NEW	LEGEND - PLAN	EXISTING	LEGEND - PLAN

**LOCATION APPROVED**  
UNDERGROUND STRUCTURES

DATE COMMITTEE

NOTE:  
LOCATION OF UNDERGROUND STRUCTURES AS SHOWN ARE BASED ON THE BEST INFORMATION AVAILABLE. BUT NO GUARANTEE IS GIVEN THAT ALL EXISTING UTILITIES ARE SHOWN OR THAT THE GIVEN LOCATIONS ARE EXACT. CONFIRMATION OF EXISTENCE AND EXACT LOCATION OF ALL SERVICES MUST BE OBTAINED FROM THE INDIVIDUAL UTILITIES BEFORE PROCEEDING WITH CONSTRUCTION.

NO.	REVISIONS	DATE	BY
0	ISSUED FOR CONSTRUCTION	17/03/29	KLC

**AECOM**

DESIGNED BY: GSK  
DRAWN BY: WJd  
HOR. SCALE: 1:250  
VERT. SCALE: 1:50

CHECKED BY: PwI  
APPROVED BY: [Signature]  
RELEASED FOR CONSTRUCTION: April 13, 2017  
DATE: [Signature]

PROFESSIONAL'S SEAL  
PROVINCE OF MANITOBA  
**BRAUN**  
Member  
24450  
REGISTERED PROFESSIONAL ENGINEER

CONSULTANT DRAWING NO.  
60516883-SHT-30-0000-C-1004

**THE CITY OF WINNIPEG**  
WATER AND WASTE DEPARTMENT

**CIVIL MAINTENANCE/ AQUEDUCT STORAGE BUILDING**  
INSTALLATION OF ELECTRICAL AND COMMUNICATION UTILITIES AND SEWER AND WATER SERVICING

TELEPHONE CABLE INSTALLATION  
FROM THE EXISTING MTS PEDESTAL TO  
CIVIL MAINTENANCE/ AQUEDUCT STORAGE BUILDING

SHEET 4 OF 8  
CITY DRAWING NUMBER  
1-0601H-E0015-001  
REV 0

BID OPPORTUNITY NO. 259-2017