

NOTE: CHAINAGES SHOWN ARE ALONG CL OF PROPOSED PIPE

**WARNING**  
 IF POWER EQUIPMENT OR EXPLOSIVES ARE TO BE USED FOR EXCAVATION ON THIS PROJECT THE CONTRACTOR MUST:  
 1) NOTIFY THE GAS COMPANY OF THE PROPOSED LOCATION OF EXCAVATION.  
 2) TAKE PRECAUTION TO AVOID DAMAGE TO GAS COMPANY INSTALLATIONS.  
 SEE PROVINCIAL REGULATION 210/72 FOR DETAILS.

- CONSTRUCTION NOTES:**
- SEWER AND WATER SERVICES SHOWN ON DRAWING ARE APPROXIMATE ONLY.
  - LOCATION OF ALL SEWER AND WATER LINES TO BE CONFIRMED IN FIELD.
  - INSTALL NEW SEWER BY TRENCHLESS METHODS, UNLESS OTHERWISE NOTED.
  - CONTRACT 1 FINISHES AT MANHOLE MH 016 WITH MANHOLE TO INCLUDE HOLE FOR FUTURE 750 DIAMETER PIPE FROM EAST. HOLE TO BE SECURELY BOARDED UP.
  - EXISTING CROSS CONNECTION TO BE INVESTIGATED AND CONDITION OF EXISTING FLAP AND SLUICE GATE TO BE PROVIDED TO CONTRACT ADMINISTRATOR PRIOR TO REMOVAL FOR RE-USE CONFIRMATION.
  - REFER TO DRAWING C-505 FOR WEIR OVERFLOW STRUCTURE DETAILS.
  - UPSTREAM 750mm PIPE NOT IN CONTRACT 1. PROVISION FOR FUTURE CONTRACT 2 CONNECTION TO BE PROVIDED BY ENSURING NEW MH 016 HAS SUITABLE PRE-CORED HOLE IN PLACE.

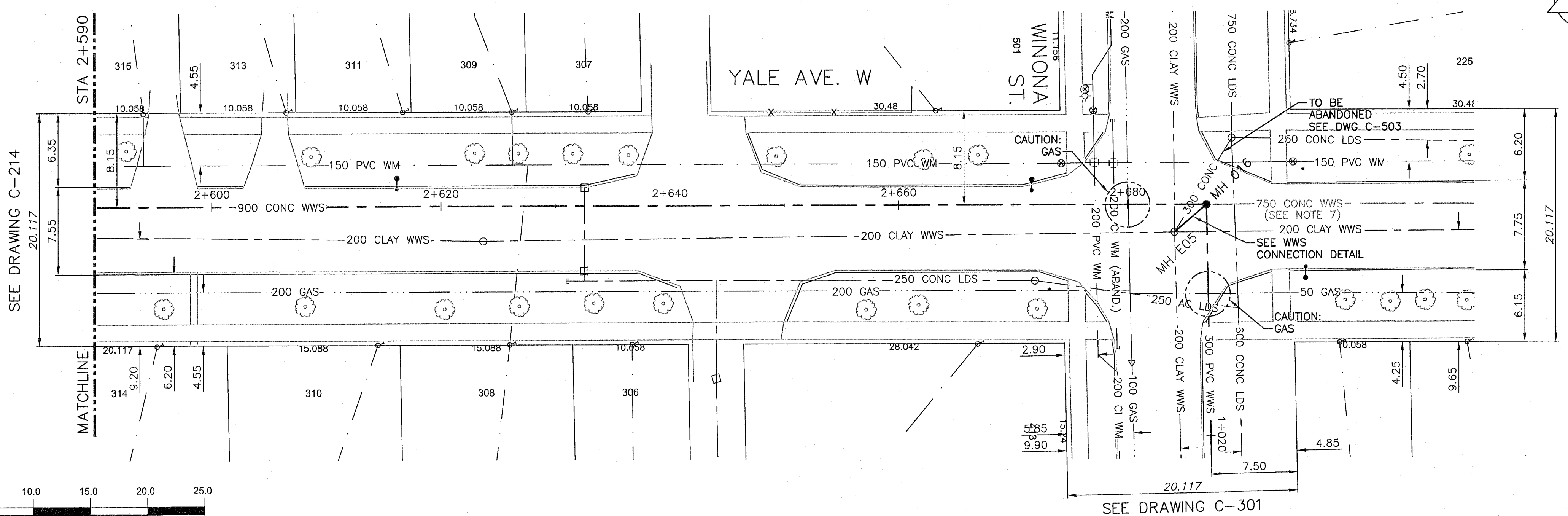

**APEGM**  
 Certificate of Authorization  
 CH2M HILL Canada Ltd.  
 No. 1441 Date: 2016 02 11

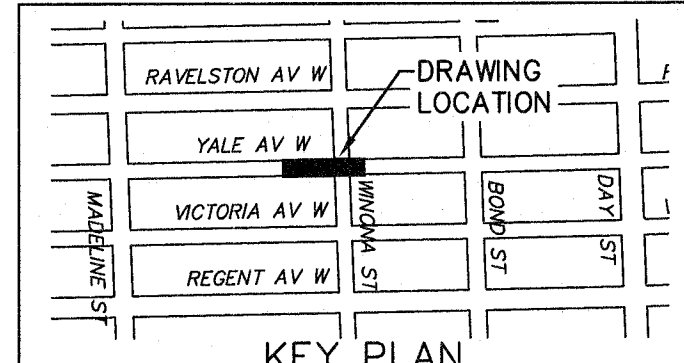

200 WM	WATERMAIN	200 WM	SL, HYDRO	150 WM	WATERMAIN	150 WM
525 LDS	LAND DRAINAGE SEWER	525 LDS	TRAFFIC SIGNALS	300 LDS	LAND DRAINAGE SEWER	300 LDS
375 WWS	WASTEWATER SEWER	375 WWS	GAS	250 WWS	WASTEWATER SEWER	250 WWS
MANHOLE	MANHOLE	MANHOLE	SURVEY BAR	250 WWS	WASTEWATER SEWER	250 WWS
CATCH BASIN	CATCH BASIN	CATCH BASIN	FENCE	250 WWS	WASTEWATER SEWER	250 WWS
CURB INLET	CURB INLET	CURB INLET	POLE - HYDRO, MTS	250 WWS	WASTEWATER SEWER	250 WWS
JUNCTIONS	JUNCTIONS	JUNCTIONS	CURB STOP	250 WWS	WASTEWATER SEWER	250 WWS
CULVERT	CULVERT	CULVERT	GUY ANCHOR	250 WWS	WASTEWATER SEWER	250 WWS
ANODE	ANODE	ANODE	LIGHT STANDARD	250 WWS	WASTEWATER SEWER	250 WWS
EXISTING	LEGEND-PLAN	PROPOSED	TREE	EXISTING	LEGEND-PROFILE	PROPOSED

LOCATION APPROVED UNDERGROUND STRUCTURES	B.M. ELEV.
SUPV. U/G STRUCTURES COMMITTEE	CONSTRUCTION COMPLETION DATE: YYYY MM DD
DATE	
NOTE: LOCATION OF UNDERGROUND STRUCTURES AS SHOWN ARE BASED ON THE BEST INFORMATION AVAILABLE BUT NO GUARANTEE IS GIVEN THAT ALL EXISTING UTILITIES ARE SHOWN OR THAT THE GIVEN LOCATIONS ARE EXACT. CONFIRMATION OF EXISTENCE AND EXACT LOCATION OF ALL SERVICES MUST BE OBTAINED FROM THE INDIVIDUAL UTILITIES BEFORE PROCEEDING WITH CONSTRUCTION.	

<b>ch2m</b>	
DESIGNED BY: MAF	CHECKED BY: MD
DRAWN BY: JBC	APPROVED BY: <i>[Signature]</i>
SCALE: HORIZONTAL 1:250	RELEASED FOR CONSTRUCTION
VERTICAL 1:50	DATE: 02-12-2016
ISSUED FOR TENDER	DATE: 02-12-2016
NO. REVISIONS	DATE BY



**THE CITY OF WINNIPEG**  
 WATER AND WASTE DEPARTMENT  
 ENGINEERING DIVISION

TRANSCONA SEWER RELIEF WORKS  
 CONTRACT NO. 1  
 YALE AVE W  
 FROM STA 2+590 TO WINONA ST

SHEET 18 OF 24  
 CITY DRAWING NUMBER LD-7759