

RECEP. DESK FINISH SCHEDULE:

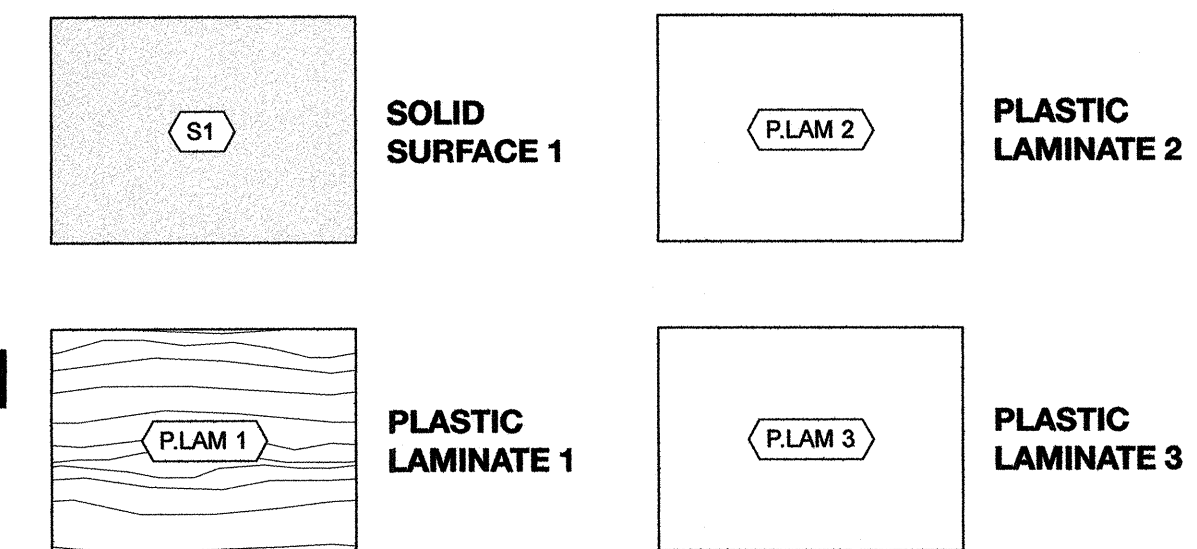

GENERAL NOTES:

- 13 G1S FIR PLY. WD. ON ALL VERT. SURFACES, TYP.
- BOTTOM PLATE OF PONY WALL ANCHORED TO FLOOR STRUCT. W/ POWER ACTUATED HILT ANCHORS AT 800 O.C., TYP.

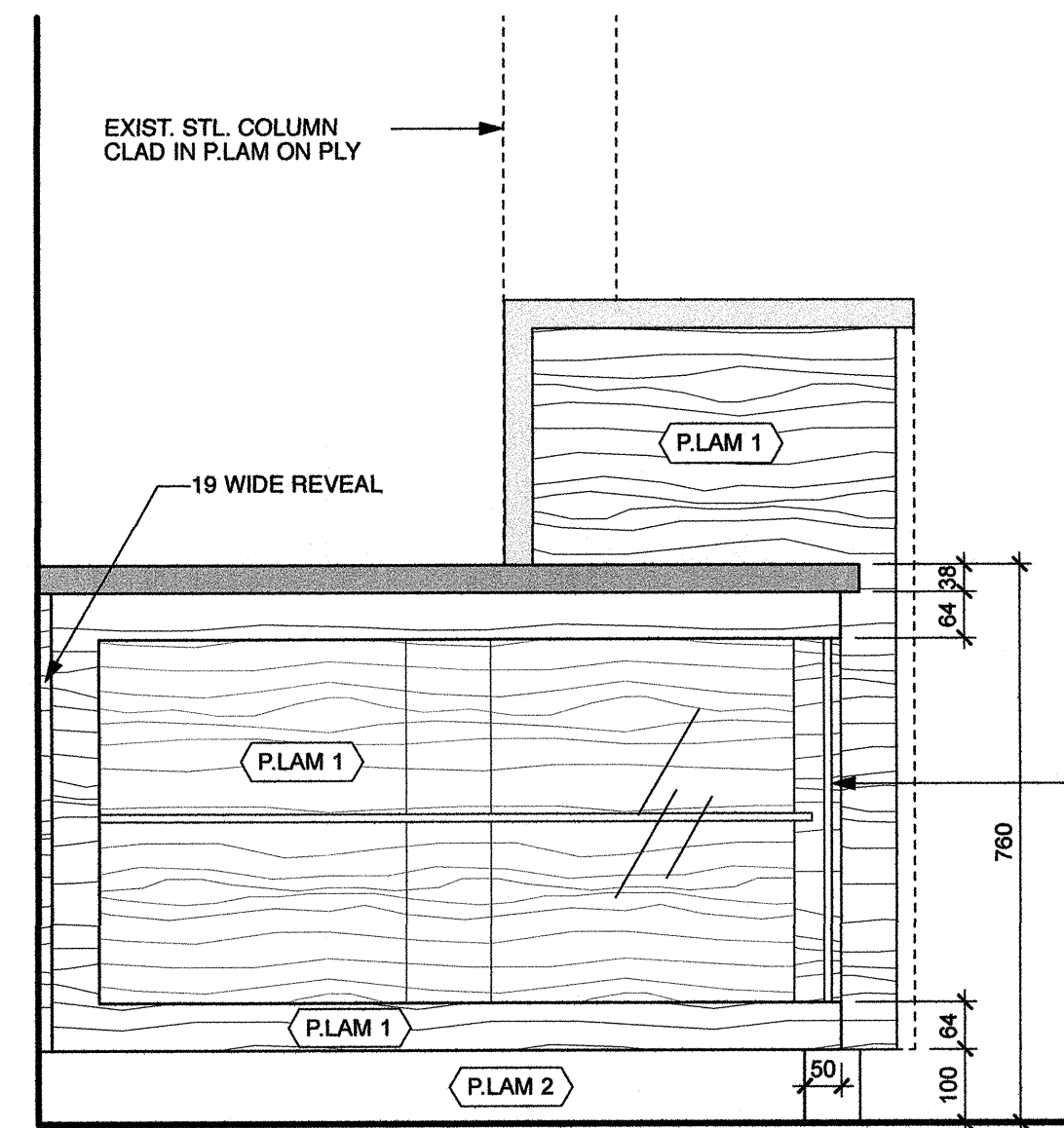

1 ELEVATION - RECEPTION DESK AT DISPLAY CASE
 Scale: 1:10

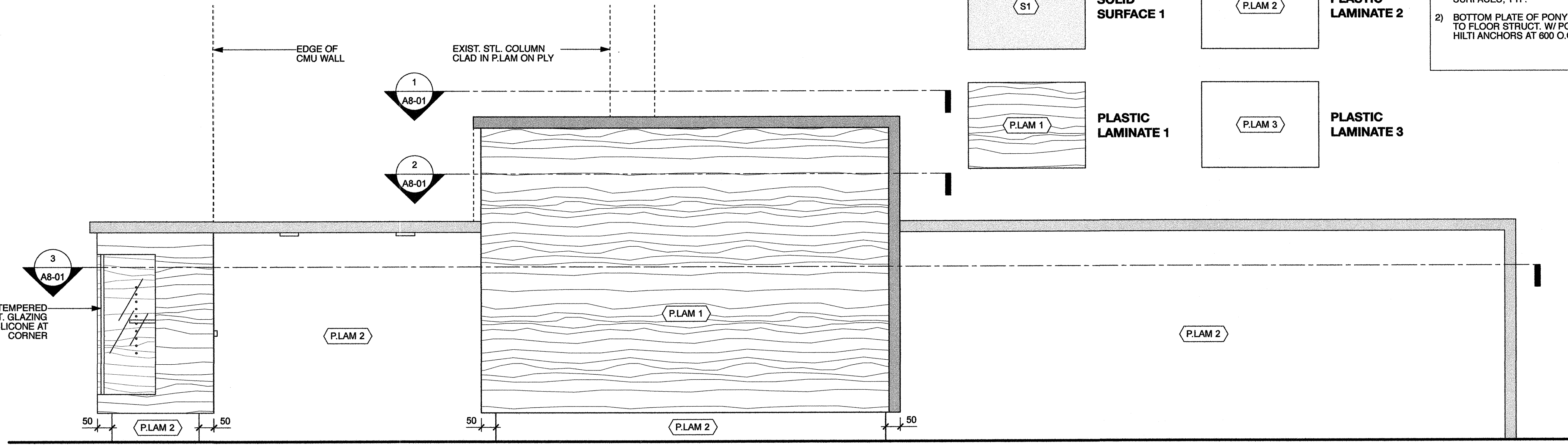

2 ELEVATION - RECEPTION DESK FRONT
 Scale: 1:10

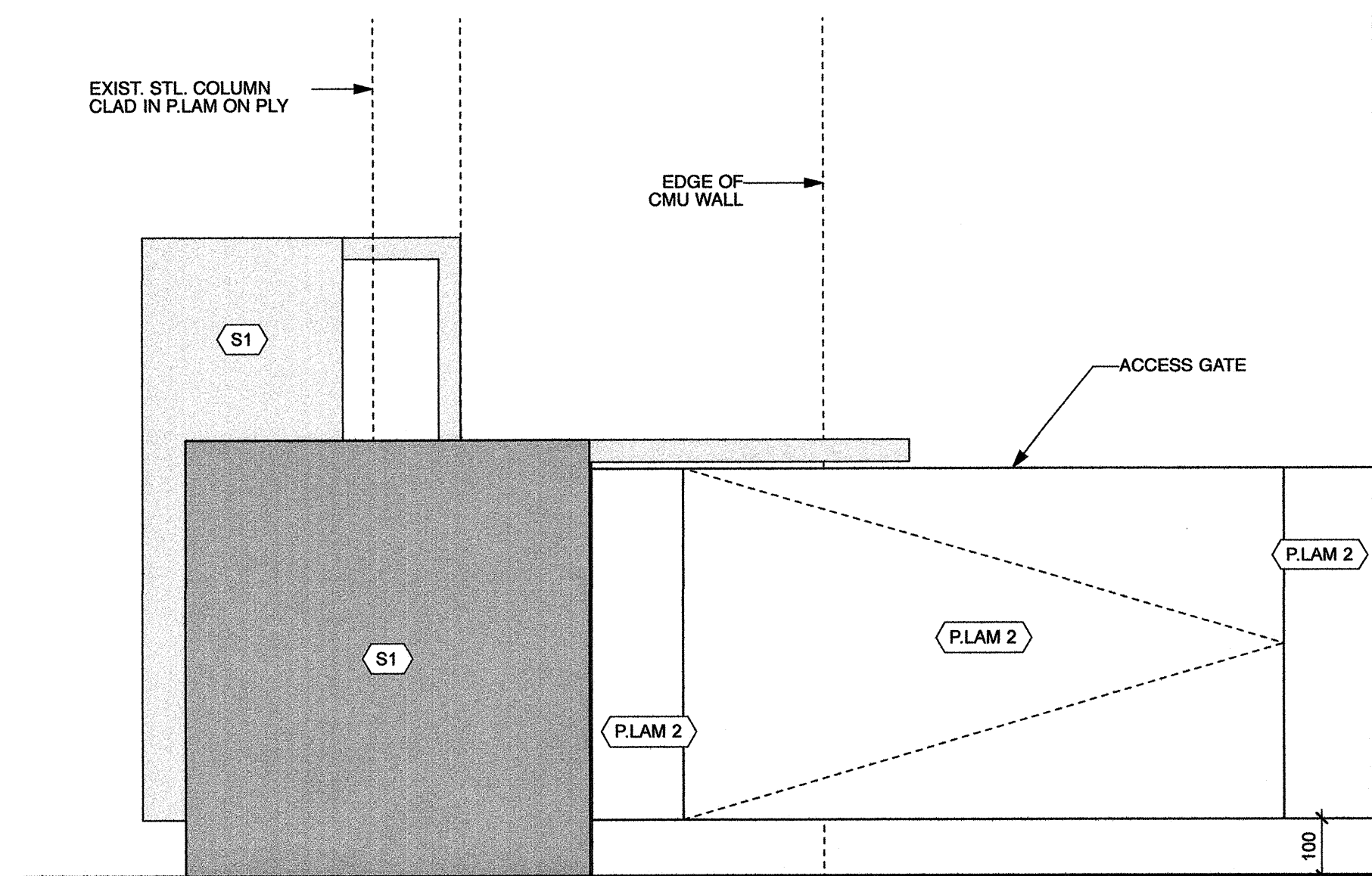

3 ELEVATION - RECEPTION DESK AT ACCESS GATE
 Scale: 1:10

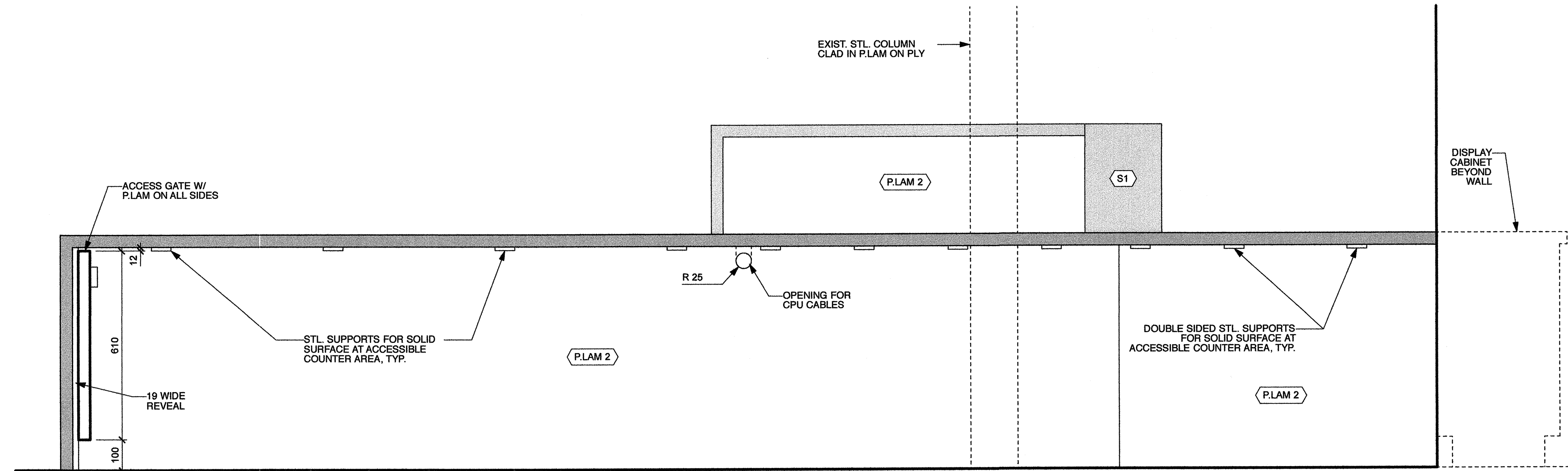

4 ELEVATION - RECEPTION DESK BACK
 Scale: 1:10

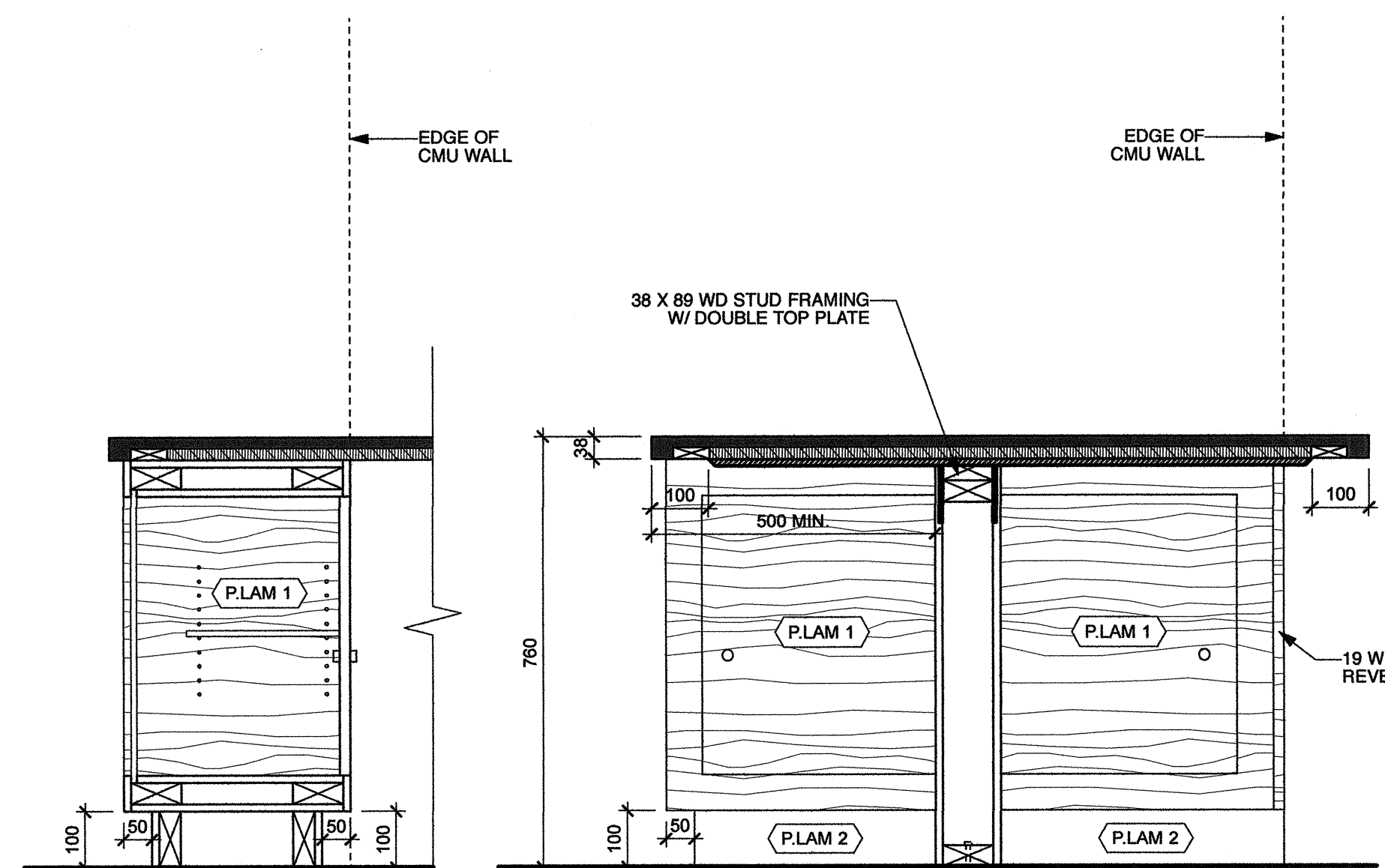

5 SECTION - RECEPTION DESK AT DISPLAY CABINET
 Scale: 1:10

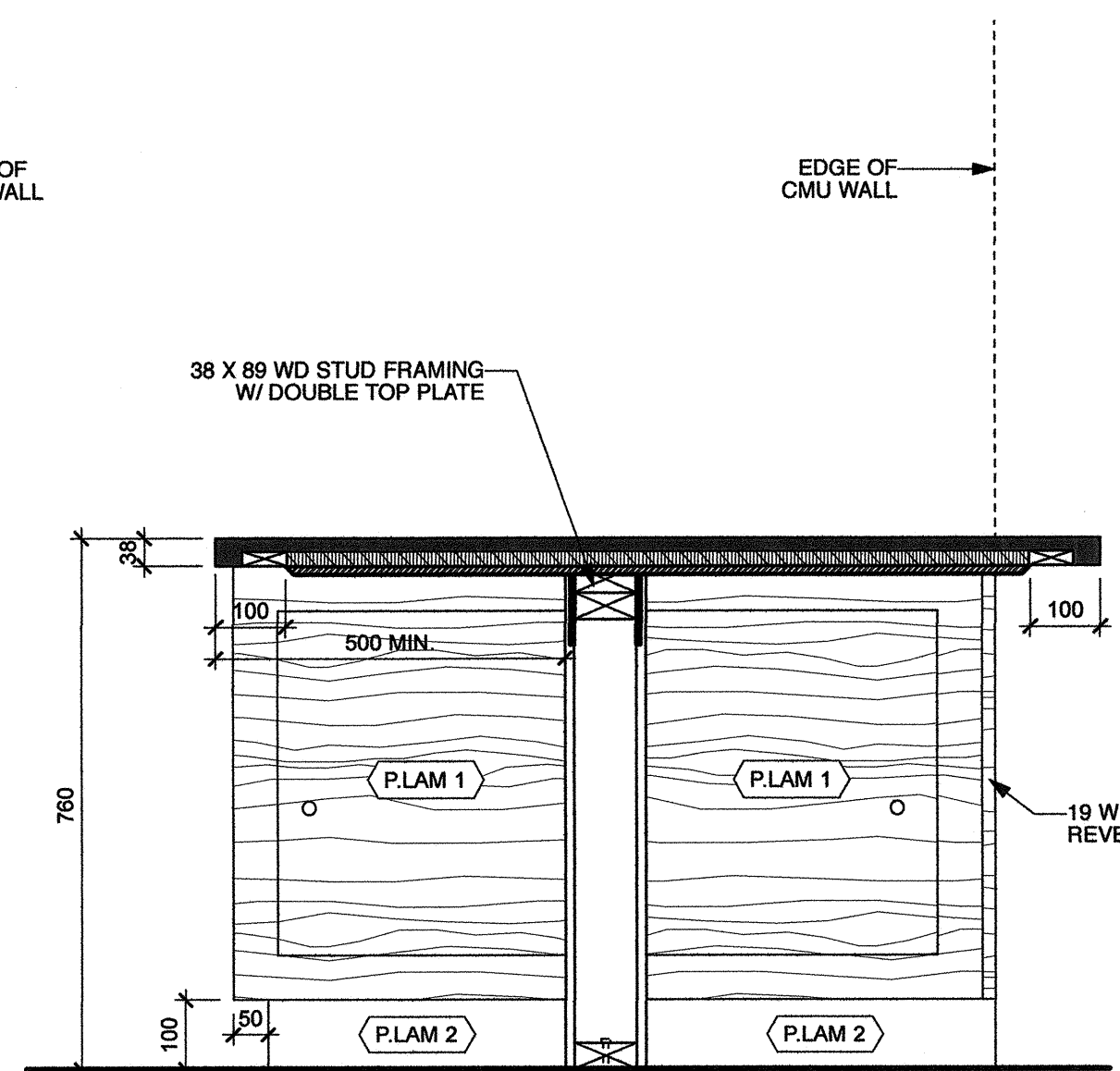

6 SECTION - RECEPTION DESK AT ACCESSIBLE COUNTER
 Scale: 1:10

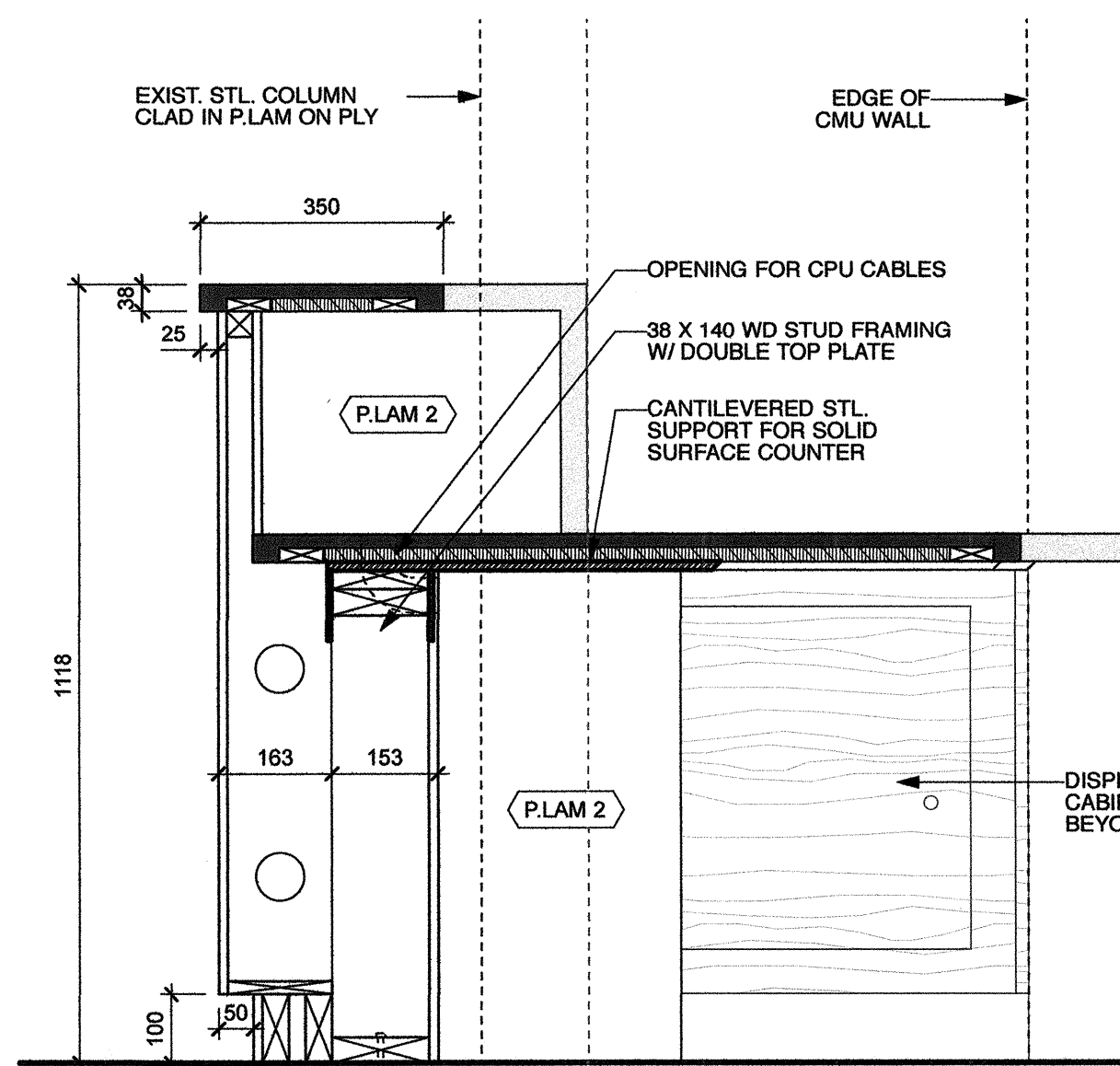

7 SECTION - RECEPTION DESK AT TRANSACTION COUNTER
 Scale: 1:10

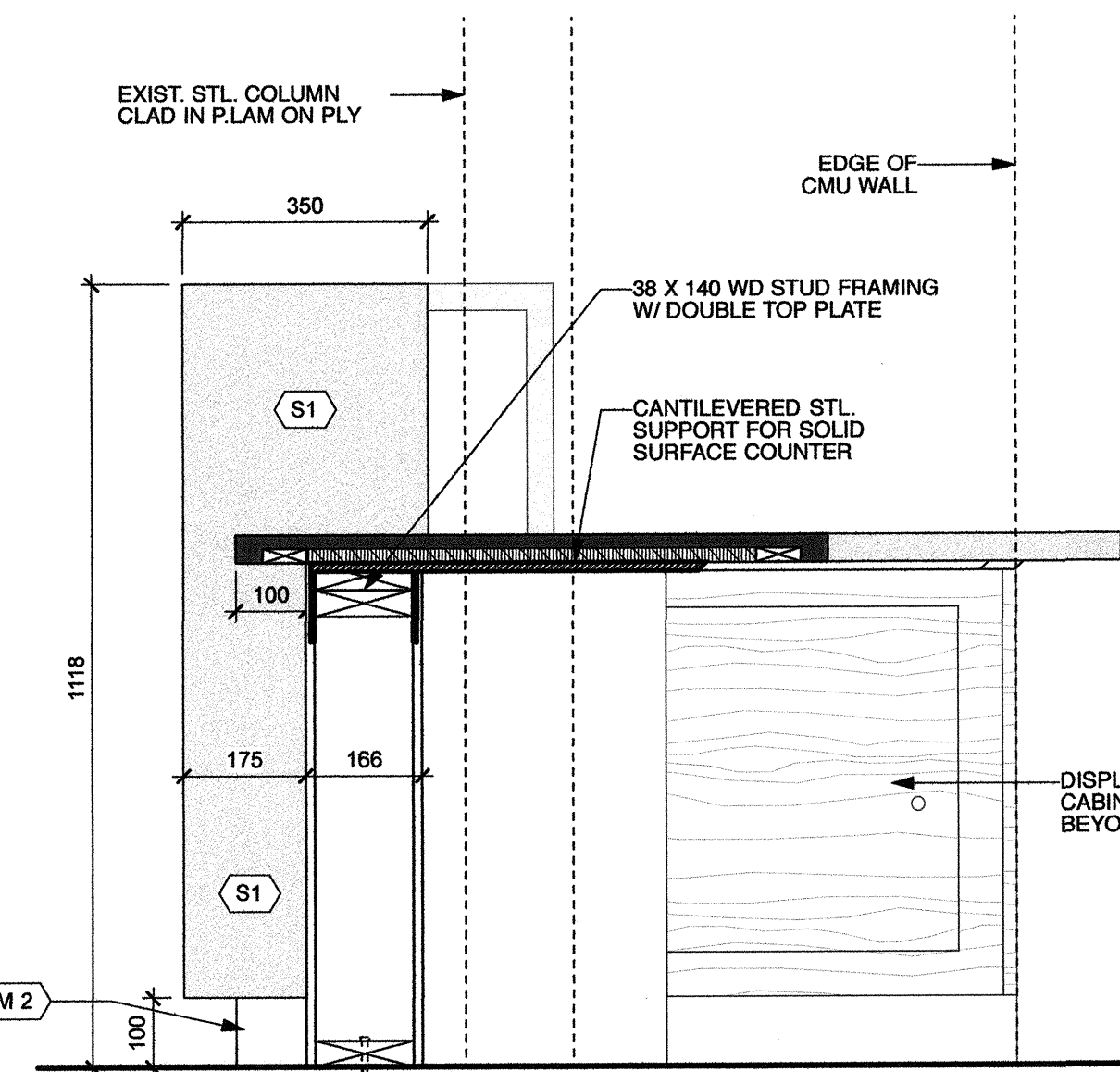

8 SECTION - RECEPTION DESK AT WORK STATION 02
 Scale: 1:10

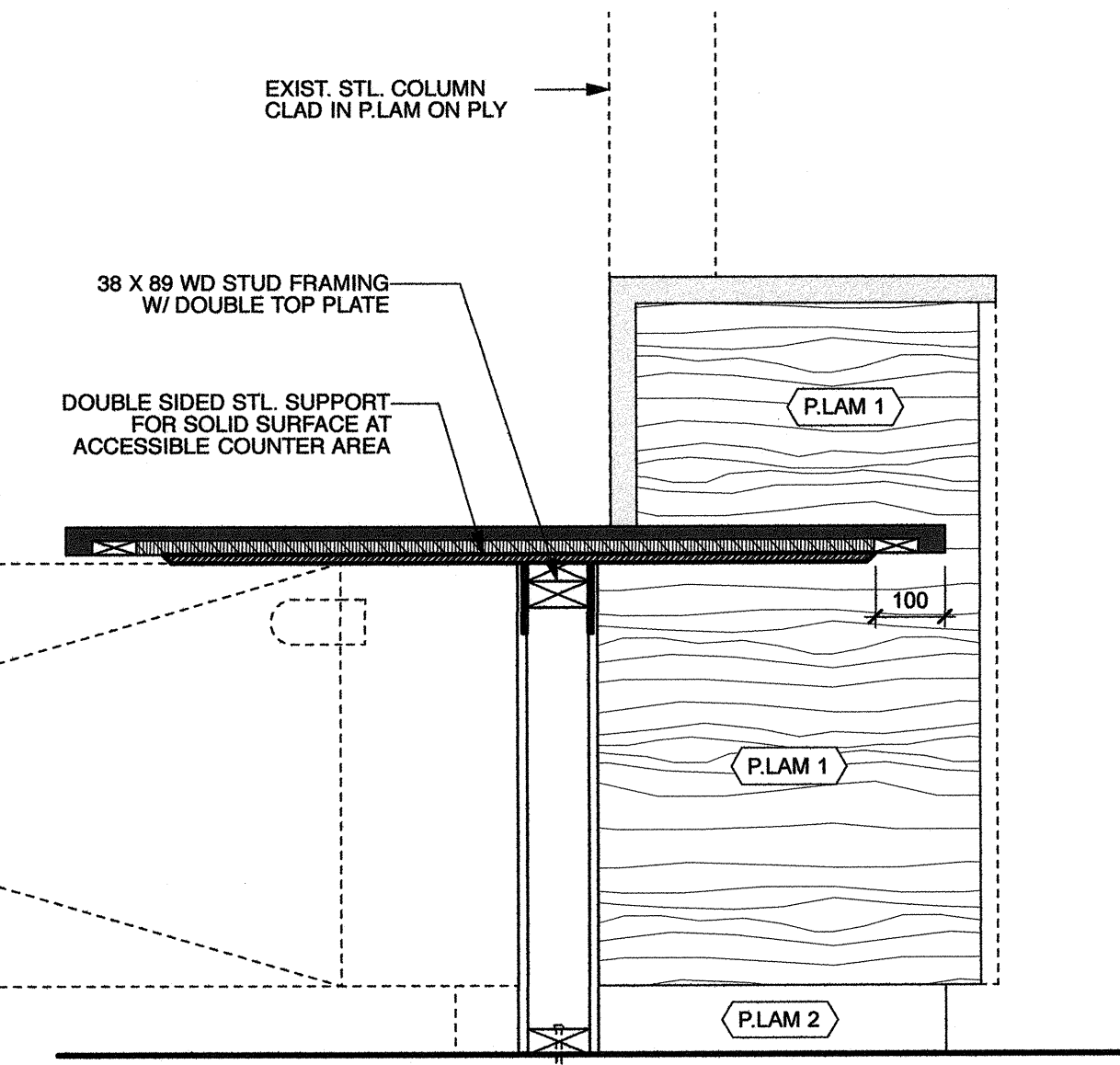

9 SECTION - RECEPTION DESK AT ACCESSIBLE COUNTER
 Scale: 1:10

issue / rev.

#	date	issue notes
1	2016.07.15	issued for construction

professional seals

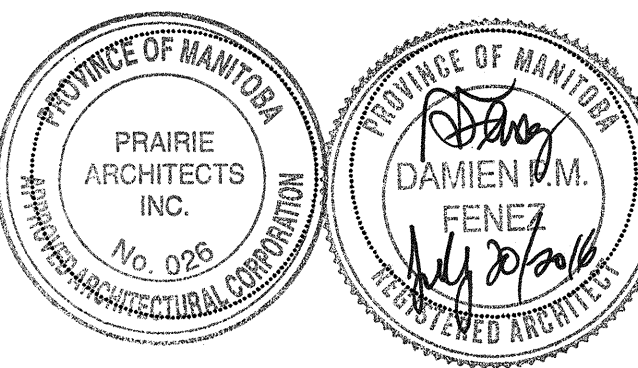

project information

SEVEN OAKS POOL RENOVATION & ADDITION

444 ADSUM DRIVE
 WINNIPEG, MB
 CANADA

client

CITY OF WINNIPEG
 4TH FLOOR - 185 KING ST.
 WINNIPEG, MB

drawing information

**MILLWORK DETAILS
 RECEPTION DESK**

drawn by: **DFI**
 approved by: **DF**

scale: **1:10**
 date issued: **2016.07.15**
 proj. #: **2014.66**
 rev. #: **R-0**

SEVEN OAKS POOL RENOVATION & ADDITION
 BID OPPORTUNITY NO. 645-2016

A8 02

This drawing must not be scaled. The contractor shall verify all dimensions and other data on site prior to commencement of work. All discrepancies, errors, and omissions are to be reported to the architect. Drawing and specifications are the property of the architect. No reproduction may be made without the permission of the architect, and when made, must bear the same. All prints to be returned to the architect on request.