



Area D1 Existing
 steel deck
 felt vapor barrier
 6" extruded polystyrene
 1/2" fiberboard
 Grace CRM







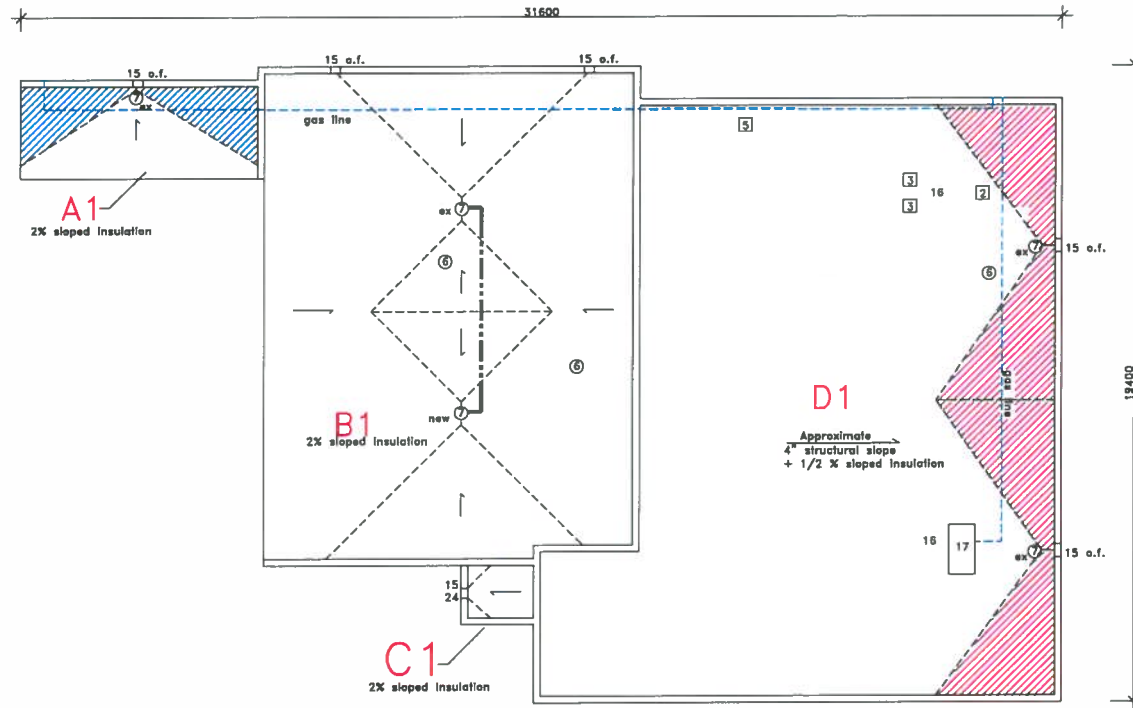

Areas A1, B1, C1 Existing
 steel deck
 felt vapor barrier
 1 1/2" fiberboard
 4 ply fell
 Gravel

Areas A1, B1, C1, D1 (2015)
 steel deck
 1/2" DensDeck
 min 3.0 mm torch grade SBS VB
 sloped type 2 EPS min 3"
 2" acrylic faced polyisocyanurate
 8"x8" slope drain sumps (2"-0.25")
 1" mineral wool
 180 gram torch grade base
 250 gram torch grade cap

 6"-0" x 12' back slope
 4"-0" x 12' back slope



GRAPHIC LEGEND

- Parapet 
- Gravel stop 
- Gas line 
- Control joint 
- Expansion joint 
- New insulated drain pipe 
- Photo vantage point 
- Area Label  area no. of stories
-  = attic vent X = leak

KEYNOTE LEGEND

- 1 core sample
- 2 chimney
- 3 AC unit
- 4 vent hood
- 5 ventilator
- 6 vent pipe
- 7 roof drain
- 8 skylight
- 9 eavestrough
- 10 firewall
- 11 antenna
- 12 ladder
- 13 slab column
- 14 roof hatch
- 15 scupper
- 16 pitch box
- 17 HVAC unit
- 18 capped curb
- 19 flag pole
- 20 electrical mast
- 21 cooling tower
- 22 splash pad
- 23 splash pan
- 24 downspout/rainwater leader
- 25 back slope
- 26 cant
- 27 increase slope to drain
- 28 cricket
- 29 parapet/wide flashing
- 30 life line anchor

Approx. Area
 sq.m.
 A1 = 22
 B1 = 171
 C1 = 4
 D1 = 248
 Total = 445

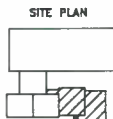

Notes:
 .01 Contractor is responsible for the site verification of all dimensions
 .02 Drawings are not to be scaled for estimating purposes
 .03 All areas given are approximate
 .04 Contractor is responsible for site verification of existing roof constructions

Stated scale is when in 11x17 format

 Agassiz Consulting Group Ltd.
 Box 41, Warren, Manitoba R0C 3E0
 Office Phone: (204) 383-5538

Project: Splash Day Care
 Strathcona Recreation Center
 233 McKenzie Street

Date: August 30, 2015

Drawing No. R-1

File no: 3376-15 Scale: 1:150

BID OPP 581-2016

ROOF PLAN