

V:\1137\active\113706880\0300_drawing\0302_sheet_files\02_civil\06880c-101-884.dwg
2016/07/05 2:23 PM By: Desrosiers, Jeremy

- NOTES:
- LOCATION OF EXISTING SERVICES TO BE VERIFIED IN FIELD BY CONTRACTOR
 - MAINTAIN TRAFFIC AS OUTLINED IN THE TRAFFIC MANAGEMENT SPECIFICATION AND STAGING DRAWINGS

- CONSTRUCTION NOTES:
- MILL EXISTING ASPHALT OVERLAY REQUIRED DEPTH FOR 60mm (AVERAGE) ASPHALT OVERLAY
 - COMPLETE CONCRETE PAVEMENT REPAIRS, AREAS TO BE VERIFIED BY CONTRACT ADMINISTRATOR
 - COMPLETE CURB & SIDEWALK RENEWAL WORKS, AREAS TO BE VERIFIED BY CONTRACT ADMINISTRATOR (75mm MIN CURB REVEAL)
 - COMPLETE GLASS GRID PLACEMENT AREAS TO BE VERIFIED BY CONTRACT ADMINISTRATOR
 - PLACE DETECTABLE WARNING SURFACE TILES WHERE INDICATED, COMPLETE WITH NEW RAMP CURB
 - COMPLETE DRAINAGE INLET WORKS AS NOTED
 - COMPLETE ADJUSTMENTS OF ANY PAVEMENT APPURTENANCES
 - PLACE 60mm (AVERAGE) ASPHALT OVERLAY
 - CURB RENEWAL WHERE NOTED ON ALL RADII TO BE MODIFIED BARRIER CURB OTHER THAN RAMP CURB

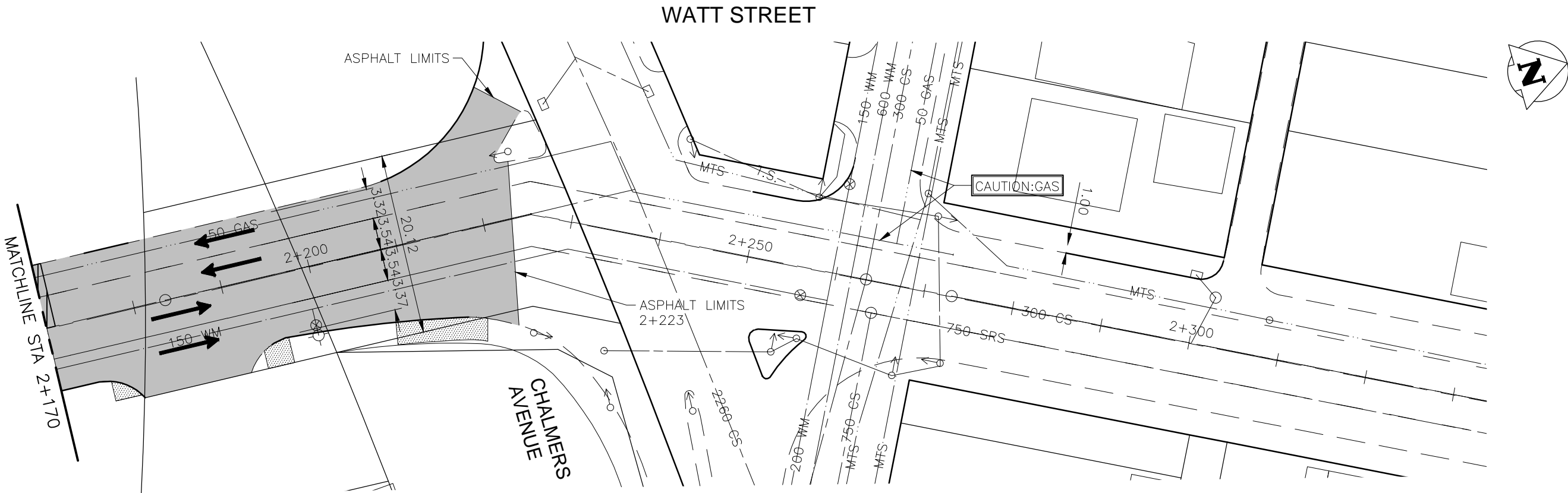

METRIC

WHOLE NUMBERS INDICATE MILLIMETRES
DECIMALIZED NUMBERS INDICATE METRES



Certificate of Authorization

Stantec Consulting Ltd.

No. 1301

BOULEVARD SEEDING
GLASS GRID
CURB RENEWAL
SIDEWALK RENEWAL

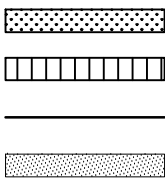

MILL AND ASPHALT
OVERLAY AREA
SLAB / JOINT
REPAIRS
DETECTABLE TILES

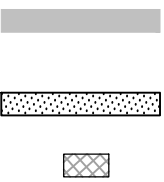

Stantec

Stantec Consulting Ltd.

WINNIPEG

MANITOBA



Winnipeg

CITY DRAWING NO.:
J205-16-04
P-3478-04

DATE 16.07.04

DRAWN BY: G.P.

DRAWING NO.:
C-104
SHT 4 OF 62

SCALE:

1:500

ISSUED FOR TENDER 16.07.04

2016 REGIONAL STREET PROGRAM
WATT STREET
STA 2+170 TO STA 2+312
MILL AND FILL