

PEMBINA HIGHWAY SOUTHBOUND PROFILE

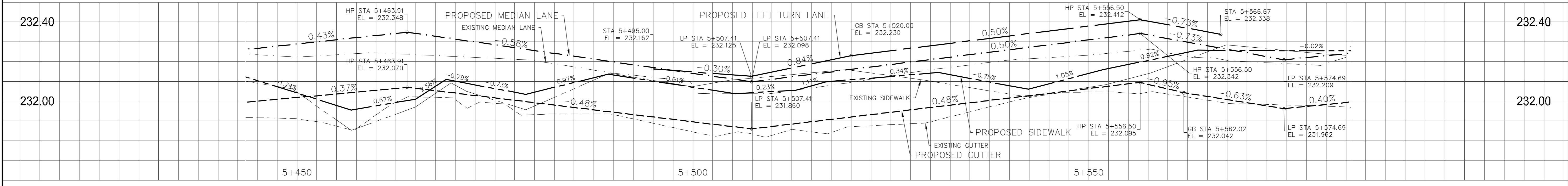

PEMBINA HIGHWAY NORTHBOUND PROFILE

Curve #	Length
C28	2'02'27"
ART L	262.650
T	4.68
L	9.36
BC	5525586.980
EC	633197.404
EC	5525578.401
EC	633193.672
C29	5'42'33"
ART L	140.000
T	6.98
L	13.95
BC	5525604.806
EC	633227.430
EC	5525617.763
EC	633232.585
C30	5'42'34"
ART L	140.000
T	6.98
L	13.95
BC	5525650.804
EC	633244.591
EC	5525637.846
EC	633239.437
C58	37'58'52"
ART L	10.000
T	3.44
L	6.63
BC	5525667.586
EC	633252.257
EC	5525674.064
EC	633252.887
C59	51'09'28"
ART L	9.000
T	4.31
L	8.04
BC	5525691.035
EC	633258.807
EC	5525683.265
EC	633258.949

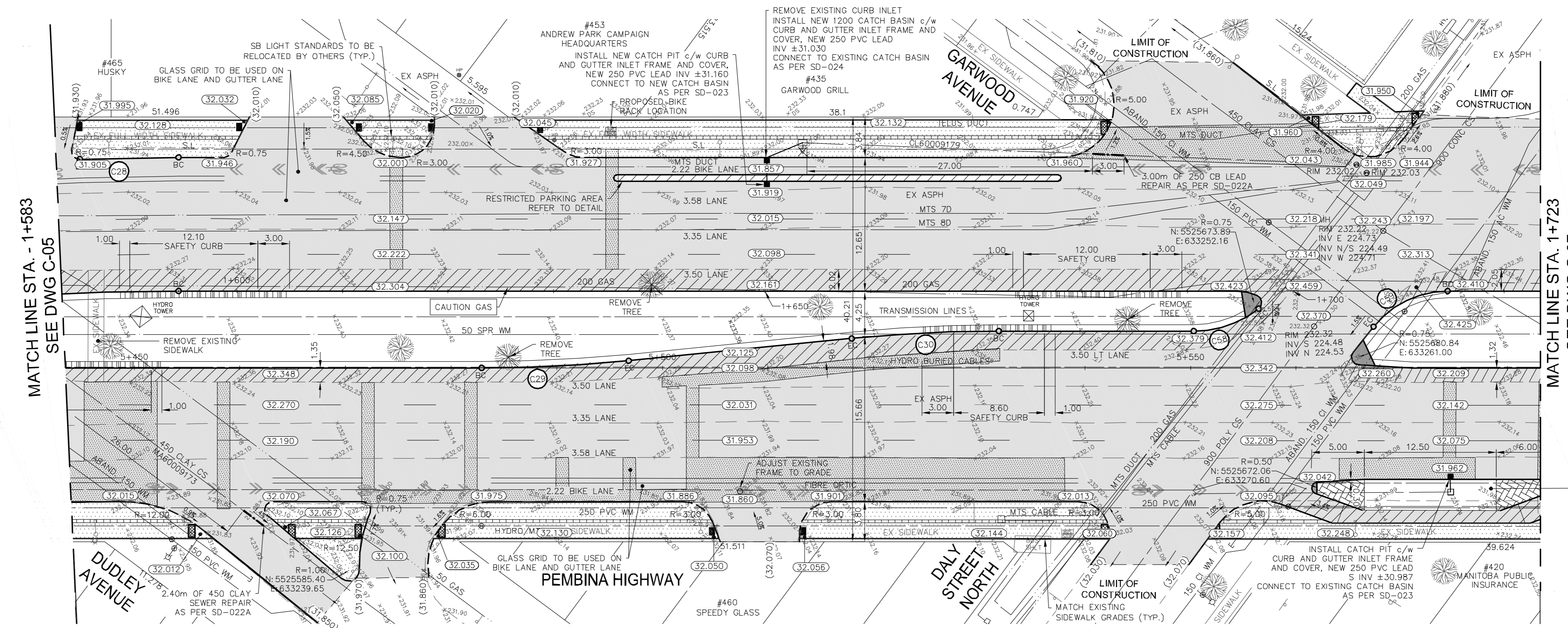

MATCH LINE STA. - 1+583
SEE DWG C-05

MATCH LINE STA. 1+723
SEE DWG C-07

FOR SECTIONS AND DETAILS
REFER TO C-20

SYMBOL	DESCRIPTION	SYMBOL	DESCRIPTION
---	WATER MAIN	---	CIVIC ADDRESS
---	LAND DRAINAGE SEWER	---	HYDRO POLE & LIGHT STANDARD
---	WASTE WATER SEWER	---	LIGHT STANDARD
---	HYDRO	---	HYDRO POLE
---	M.T.S.	---	CURB RAMP
---	GAS	---	DETECTABLE WARNING SURFACE TILE c/w RAMP
---	SIGNALS	---	EDGE OF SIDEWALK
---	MANHOLE	---	PROPERTY LINE
---	CATCH BASIN	---	EDGE OF ASPHALT
---	CURB INLET	---	MODIFIED BARRIER CURB
---	UTILITIES ADJUSTED	---	BARRIER CURB
---	PLUG	---	BARRIER CURB WITH SPLASH STRIP
---	HYDRANT	---	TRAFFIC SIGNAL
---	VALVE	---	SIDEWALK
---	CURB STOP	---	CONCRETE SLAB REPAIR
---	GROUND GRADE	---	ASPHALT
---	PAVEMENT GRADE	---	CONCRETE
---	LOT GRADE	---	INTERLOCKING PAVING STONES
---	ANCHOR	---	BULLNOSE
---	EXISTING	---	PROPOSED
---	LEGEND-PLAN	---	LEGEND-PROFILE

NOTE: These design documents are prepared solely for the use by the party with whom the design professional has entered into a contract and there are no representations of any kind made by the design professional to any party with whom the design professional has not entered into a contract.

NO.	REVISIONS	DATE	BY
4	ADDENDUM 1	28.MAY.16	VM
3	ISSUED FOR TENDER	16.MAY.16	VM
2	ISSUED TO UNDERGROUND STRUCTURES	16.MAY.16	VM
1	ISSUED FOR CLIENT REVIEW	28.APR.16	VM

MMM GROUP
 DESIGNED BY: SQ/JP
 CHECKED BY: VM/TP
 DRAWN BY: HK/LT
 APPROVED BY: VM
 HORIZONTAL SCALE: 1:250
 VERTICAL SCALE: 1:10
 DATE: MARCH 2016

ENGINEER'S SEAL
V.M. MAROTI
 Member 30809
 CONSULTANT ACADEMY NO. 5516006-C-06

THE CITY OF WINNIPEG
 PUBLIC WORKS DEPARTMENT
 ENGINEERING DIVISION
PEMBINA HIGHWAY
 FROM CARTER AVENUE TO OSBORNE STREET
 PAVEMENT REHABILITATION
 SOUTHBOUND STA. 1+583 - STA. 1+723

CITY DRAWING NUMBER: 06 OF 27
 BID NO. 386-2016

METRIC
 WHOLE NUMBERS INDICATE MILLIMETRES
 DECIMALIZED NUMBERS INDICATE METRES
APEGM
 Certificate of Authorization
 MMM Group Limited
 No. 4531

May 25, 2016 - 3:09pm
 P:\5616001-5516006- Pembina Hwy Pavement Rehab. & Bike Lane\MMW Drawings\Construction Drawings\5516006 CD1-C12 Rehabilitation Addendum 1_20160526.dwg - Tab: STA. 1+610.00 - STA. 1+750.00