

NOTE: CHAINAGES SHOWN ARE ALONG
E. P. OF ST MARYS RD

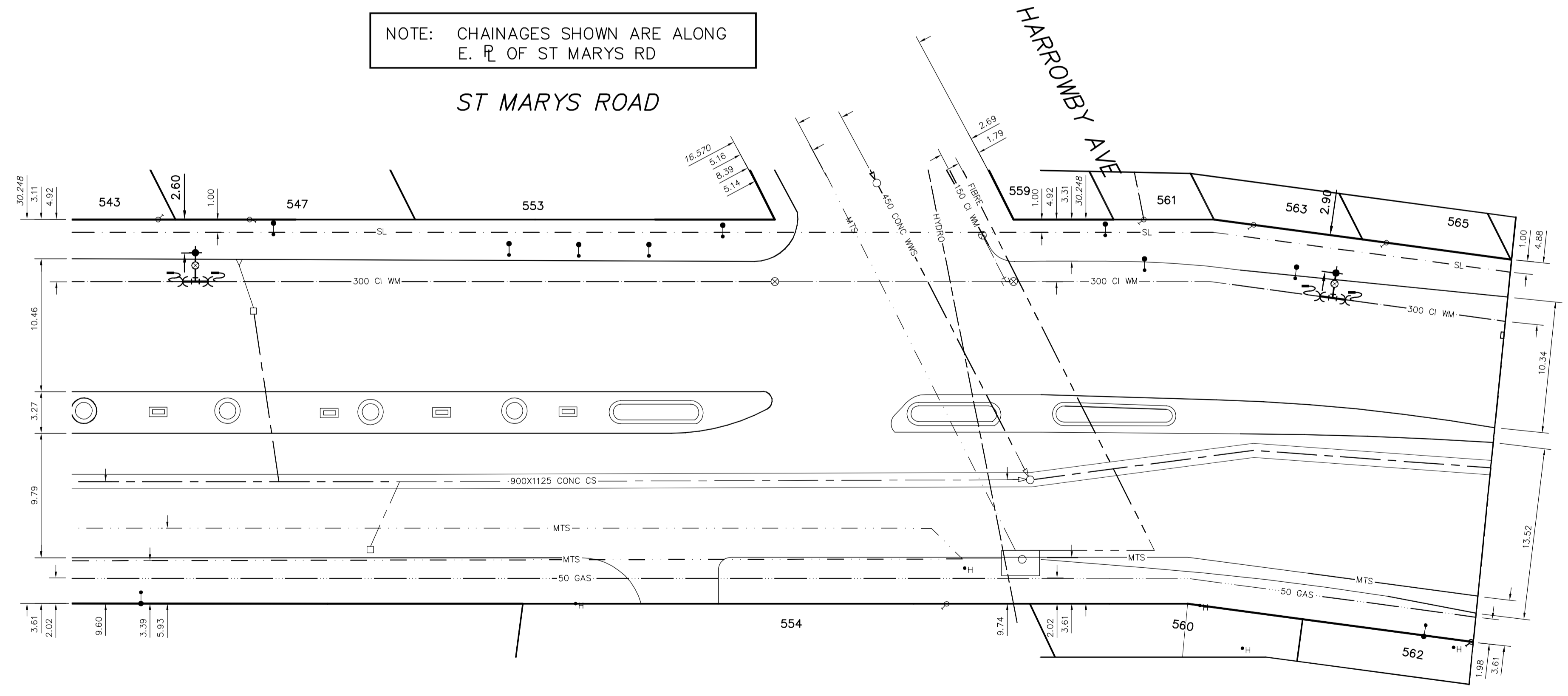

FOR INDEX SEE
D-14362

NOTE: ALL VALVES TO BE INSTALLED
CLOCKWISE TO CLOSE

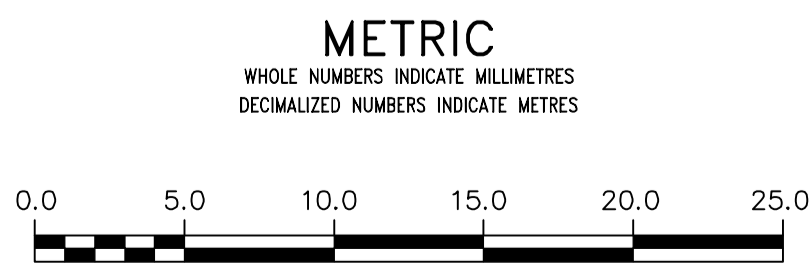

WARNING

IF POWER EQUIPMENT OR EXPLOSIVES
ARE TO BE USED FOR EXCAVATION ON
THIS PROJECT THE CONTRACTOR MUST:

- 1) NOTIFY THE GAS COMPANY OF THE
PROPOSED LOCATION OF EXCAVATION.
- 2) TAKE PRECAUTION TO AVOID DAMAGE
TO GAS COMPANY INSTALLATIONS.

SEE PROVINCIAL REGULATION 210/72 FOR DETAILS

LOCATION APPROVED
UNDERGROUND STRUCTURES

SUPV. U/G STRUCTURES COMMITTEE DATE

NOTE:
LOCATION OF UNDERGROUND STRUCTURES AS SHOWN ARE BASED ON THE BEST INFORMATION AVAILABLE BUT NO GUARANTEE IS GIVEN THAT ALL EXISTING UTILITIES ARE SHOWN OR THAT THE GIVEN LOCATIONS ARE EXACT. CONFIRMATION OF EXISTENCE AND EXACT LOCATION OF ALL SERVICES MUST BE OBTAINED FROM THE INDIVIDUAL UTILITIES BEFORE PROCEEDING WITH CONSTRUCTION.

B.M. ELEV.			
DESIGNED BY	NC	CHECKED BY	SC
DRAWN BY	RS	APPROVED BY	KZ
SCALE:		RELEASED FOR CONSTRUCTION	
HORIZONTAL	1:250	KAS ZUREK	
VERTICAL	1:50	DATE	2016 04 29
DATE	2016 04 29	DATE	2016 04 29
NO.	REVISIONS	DATE	BY

ENGINEER'S SEAL
ORIGINAL SIGNED BY N.M. CONTI
16/04/29

CONSULTANT DRAWING NUMBER: -

ENGINEER'S SEAL

ORIGINAL SIGNED BY N.M. CONTI
16/04/29

CONSULTANT DRAWING NUMBER: -

THE CITY OF WINNIPEG
WATER AND WASTE DEPARTMENT
ENGINEERING DIVISION

2016 WATER MAIN RENEWALS
CONTRACT 2
ST MARYS ROAD
HYDRANT INSTALLATION

SHEET 14 OF 16
CITY DRAWING NUMBER
D-14375