

NOTE: CHAINAGES SHOWN ARE ALONG
E. R. OF FERNSDALE AVE.

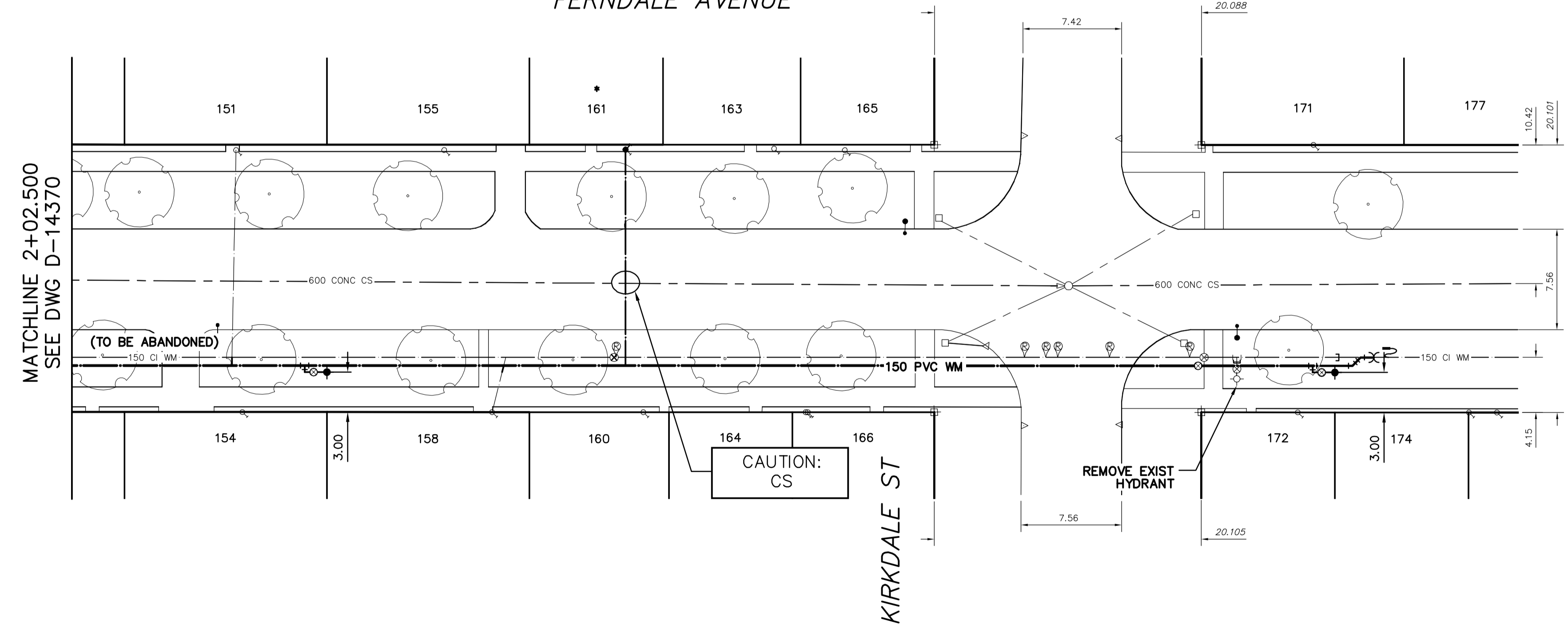

FERNSDALE AVENUE



WATER SERVICE INFORMATION

ADDRESS	SIZE (mm) MATERIAL (STREET)	SIZE (mm) MATERIAL (PROP.)	SHORT & LONG MEASUREMENT	CORP. LOCATION	REMARKS
123 FERNSDALE AVE RESIDENTIAL	-	20	0.73 SNL HSE	-	RECONNECT SERVICE
124 FERNSDALE AVE RESIDENTIAL	-	20	12.91>NNL HIGHFIELD ST	-	RECONNECT SERVICE
126 FERNSDALE AVE RESIDENTIAL	-	20	0.19 SNL HSE	-	RECONNECT SERVICE
129 FERNSDALE AVE RESIDENTIAL	-	20	8.55>NNL HIGHFIELD ST	-	RECONNECT SERVICE
130 FERNSDALE AVE RESIDENTIAL	-	20	0.43>NNL HSE	-	RECONNECT SERVICE
133 FERNSDALE AVE RESIDENTIAL	-	20	10.78>NNL HIGHFIELD ST	-	RECONNECT SERVICE
134 FERNSDALE AVE RESIDENTIAL	-	20	4.70>NNL HSE	-	RECONNECT SERVICE
137 FERNSDALE AVE RESIDENTIAL	-	20	61.95>NNL HIGHFIELD ST	-	RECONNECT SERVICE
138 FERNSDALE AVE RESIDENTIAL	-	20	3.60>NNL HSE	-	RECONNECT SERVICE
141 FERNSDALE AVE RESIDENTIAL	-	20	24.01>NNL HIGHFIELD ST	-	RECONNECT SERVICE
142 FERNSDALE AVE RESIDENTIAL	-	20	4.03>NNL HSE	-	RECONNECT SERVICE
144 FERNSDALE AVE RESIDENTIAL	-	20	37.83>NNL HIGHFIELD ST	-	RECONNECT SERVICE
145 FERNSDALE AVE RESIDENTIAL	-	20	1.02>NNL HSE	-	RECONNECT SERVICE
146 FERNSDALE AVE RESIDENTIAL	-	20	43.49>NNL HIGHFIELD ST	-	RECONNECT SERVICE
147 FERNSDALE AVE RESIDENTIAL	-	20	0.39>NNL HSE	-	RECONNECT SERVICE
148 FERNSDALE AVE RESIDENTIAL	-	20	59.94>NNL HIGHFIELD ST	OPP S/C	RECONNECT SERVICE
149 FERNSDALE AVE RESIDENTIAL	-	20	0.42>NNL HSE	-	RECONNECT SERVICE
150 FERNSDALE AVE RESIDENTIAL	-	20	59.78>NNL HIGHFIELD ST	-	RECONNECT SERVICE
151 FERNSDALE AVE RESIDENTIAL	-	20	4.82>NNL HSE	-	RECONNECT SERVICE
152 FERNSDALE AVE RESIDENTIAL	-	20	69.04>NNL HIGHFIELD ST	-	RECONNECT SERVICE
153 FERNSDALE AVE RESIDENTIAL	-	20	3.91>NNL HSE	-	RECONNECT SERVICE
154 FERNSDALE AVE RESIDENTIAL	-	20	67.41>NNL HIGHFIELD ST	-	RECONNECT SERVICE
155 FERNSDALE AVE RESIDENTIAL	-	20	4.51>NNL HSE	-	RECONNECT SERVICE
156 FERNSDALE AVE RESIDENTIAL	-	20	84.69>NNL HIGHFIELD ST	OPP S/C	RECONNECT SERVICE
157 FERNSDALE AVE RESIDENTIAL	-	20	3.40>NNL HSE	-	RECONNECT SERVICE
158 FERNSDALE AVE RESIDENTIAL	-	20	85.69>NNL HIGHFIELD ST	-	RECONNECT SERVICE
159 FERNSDALE AVE RESIDENTIAL	-	20	5.50>NNL HSE	OPP S/C	RECONNECT SERVICE
160 FERNSDALE AVE RESIDENTIAL	-	20	99.87>NNL HIGHFIELD ST	-	RECONNECT SERVICE
161 FERNSDALE AVE RESIDENTIAL	-	20	1.39>NNL HSE	-	RECONNECT SERVICE
162 FERNSDALE AVE RESIDENTIAL	-	20	98.97>NNL HIGHFIELD ST	-	RECONNECT SERVICE
163 FERNSDALE AVE RESIDENTIAL	-	20	3.98>NNL HSE	0.3 S OF S/C	RECONNECT SERVICE
164 FERNSDALE AVE RESIDENTIAL	-	20	52.54>NNL HIGHFIELD ST	-	RECONNECT SERVICE
165 FERNSDALE AVE RESIDENTIAL	-	20	4.19>NNL HSE	-	RECONNECT SERVICE
166 FERNSDALE AVE RESIDENTIAL	-	20	52.05>NNL HIGHFIELD ST	-	RECONNECT SERVICE
167 FERNSDALE AVE RESIDENTIAL	-	20	2.90>NNL HSE	-	RECONNECT SERVICE
168 FERNSDALE AVE RESIDENTIAL	-	20	36.87>NNL HIGHFIELD ST	-	RECONNECT SERVICE
169 FERNSDALE AVE RESIDENTIAL	-	20	1.18>NNL HSE	-	RECONNECT SERVICE
170 FERNSDALE AVE RESIDENTIAL	-	20	33.27>NNL HIGHFIELD ST	0.5 N OF S/C	RECONNECT SERVICE
171 FERNSDALE AVE RESIDENTIAL	-	20	0.85>NNL HSE	-	RECONNECT SERVICE
172 FERNSDALE AVE RESIDENTIAL	-	20	22.73>NNL HIGHFIELD ST	-	RECONNECT SERVICE
173 FERNSDALE AVE RESIDENTIAL	-	20	1.90>NNL HSE	-	RENEW TO R W/20 CU
174 FERNSDALE AVE RESIDENTIAL	-	20	23.23>NNL HIGHFIELD ST	-	RECONNECT SERVICE
175 FERNSDALE AVE RESIDENTIAL	-	20	0.46>NNL HSE	-	RECONNECT SERVICE
176 FERNSDALE AVE RESIDENTIAL	-	20	12.05>NNL HIGHFIELD ST	-	RECONNECT SERVICE
177 FERNSDALE AVE RESIDENTIAL	-	20	2.07>NNL HSE	-	RECONNECT SERVICE
178 FERNSDALE AVE RESIDENTIAL	-	20	9.87>NNL HIGHFIELD ST	-	RECONNECT SERVICE
179 FERNSDALE AVE RESIDENTIAL	-	20	2.82>NNL HSE	-	RECONNECT SERVICE
180 FERNSDALE AVE RESIDENTIAL	-	20	6.73>NNL HIGHFIELD ST	-	RECONNECT SERVICE
181 FERNSDALE AVE RESIDENTIAL	-	20	0.30>NNL HSE	-	RECONNECT SERVICE
182 FERNSDALE AVE RESIDENTIAL	-	20	9.51>NNL HIGHFIELD ST	-	RECONNECT SERVICE

* SERVICES TO BE RENEWED TO R. ALL OTHERS TO BE RECONNECTED

FOR INDEX SEE
D-14362

NOTE: ALL VALVES TO BE INSTALLED
CLOCKWISE TO CLOSE

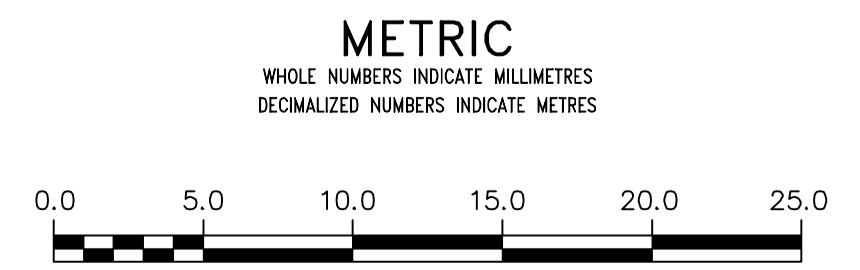

WARNING
IF POWER EQUIPMENT OR EXPLOSIVES ARE TO BE USED FOR EXCAVATION ON THIS PROJECT THE CONTRACTOR MUST:
1) NOTIFY THE GAS COMPANY OF THE PROPOSED LOCATION OF EXCAVATION.
2) TAKE PRECAUTION TO AVOID DAMAGE TO GAS COMPANY INSTALLATIONS.
SEE PROVINCIAL REGULATION 210/72 FOR DETAILS

LOCATION APPROVED
UNDERGROUND STRUCTURES
SUPV. U/G STRUCTURES COMMITTEE DATE
NOTE:
LOCATION OF UNDERGROUND STRUCTURES AS SHOWN ARE BASED ON THE BEST INFORMATION AVAILABLE BUT NO GUARANTEE IS GIVEN THAT ALL EXISTING UTILITIES ARE SHOWN OR THAT THE GIVEN LOCATIONS ARE EXACT. CONFIRMATION OF EXISTENCE AND EXACT LOCATION OF ALL SERVICES MUST BE OBTAINED FROM THE INDIVIDUAL UTILITIES BEFORE PROCEEDING WITH CONSTRUCTION.

B.M. ELEV.	NO.	REVISIONS	DATE	BY

DESIGNED BY	NC	CHECKED BY	SC
DRAWN BY	RJ	APPROVED BY	KZ
SCALE:		RELEASED FOR CONSTRUCTION	
HORIZONTAL	1:250		
VERTICAL	1:50		
		KAS ZUREK	
DATE	2016 04 29	DATE	2016 04 29
PLOT DATE:	2016 04 29		

ENGINEER'S SEAL
ORIGINAL SIGNED
BY N.M. CONTI
16/04/29
CONSULTANT DRAWING NUMBER

THE CITY OF WINNIPEG
WATER AND WASTE DEPARTMENT
ENGINEERING DIVISION
2016 WATER MAIN RENEWALS
CONTRACT 2
FERNSDALE AVENUE
103 N OF HIGHFIELD STREET TO
KIRKDALE STREET

SHEET 10 OF 16
CITY DRAWING NUMBER
D-14371