

UNDERGROUND SERVICE NOTES:

- 1. CONFIRM LOCATIONS OF UNDERGROUND SERVICES PRIOR TO COMMENCEMENT OF SITE WORKS.
- 2. REPORT ANY ENCUMBRANCES TO THE CONTRACT ADMINISTRATOR & OWNER IMMEDIATELY.

GENERAL LEGEND

- | | | | |
|---------|-------------------------|--------------|---------------------------------------------------------------|
| MH ○ | MANHOLE | - - - - - | CHAIN LINK FENCE |
| CB ○ | CATCH BASIN | — 200 GAS — | GAS LINES |
| CI □ | CURB INLET | — 250 WM — | WATERMAIN |
| ⊙ | WATER VALVE | — 750 CS — | SEWER |
| ⊕ | FIRE HYDRANT | — OH HYDRO — | OVERHEAD HYDRO |
| ● LS | LIGHT STANDARDS | — UG HYDRO — | UNDERGROUND HYDRO |
| ● PED-X | PEDESTRIAN X-WALK LIGHT | — TS — | TRAFFIC SIGNALS |
| ● HP | HYDRO POLE | - - - - - | LIMIT OF CONSTRUCTION |
| ○ S | SIGN | ○ | EXISTING TREES TO BE RETAINED & PROTECTED DURING CONSTRUCTION |
| ● B | BOLLARDS | | |
| □ | BOLLARD TO REMAIN | | |

GRADING LEGEND

- | | |
|-----------------|------------------------------------------------------------------------------------------------------------|
| 231.94 | EXISTING ELEVATION |
| ⊙ BM | BENCH MARK: ELEVATIONS ARE REFERRED TO CITY OF WINNIPEG GEODETIC BENCH MARK NO. 26-020 TAKEN TO BE 232.072 |
| ⬆ (232.00) | PROPOSED FINISHED GRADE ELEVATION |
| ⬆ (LSG: 232.32) | FINISHED GRADE AT LIGHT STANDARD |
| ⬆ (ME: 232.00) | MATCH EXISTING ELEVATION |
| HP | HIGH POINT ELEVATION |
| TC | TOP OF CURB ELEVATION |
| BC | BOTTOM OF CURB ELEVATION |
| CB RIM | CATCH BASIN RIM ELEVATION |
| 1.5% | PERCENTAGE & DIRECTION OF SLOPE |

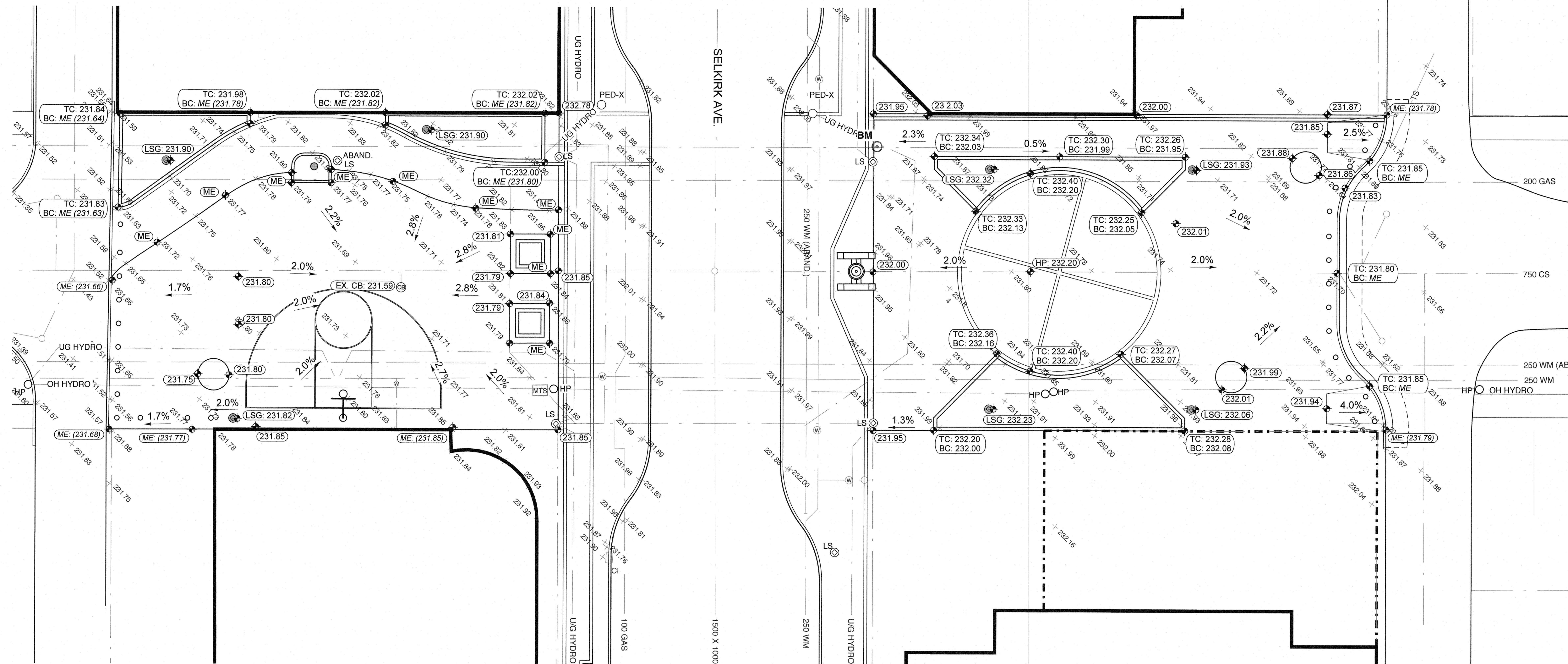

1 GRADING PLAN
 L3.0 SCALE: 1:150
 NORTH

METRIC
 WHOLE NUMBERS INDICATE MILLIMETRES
 DECIMALIZED NUMBERS INDICATE METRES

EXISTING		LEGEND - PLAN		PROPOSED		EXISTING		LEGEND - PLAN		PROPOSED		EXISTING		LEGEND - PROFILE		PROPOSED		LOCATION APPROVED UNDERGROUND STRUCTURES <i>Approved Feb 16/2017</i> SUPV. UG STRUCTURES COMMITTEE NOTE: LOCATION OF UNDERGROUND STRUCTURES AS SHOWN ARE BASED ON THE BEST INFORMATION AVAILABLE. BUT NO GUARANTEE IS GIVEN THAT ALL EXISTING UTILITIES ARE SHOWN OR THAT THE GIVEN LOCATIONS ARE EXACT. CONFIRMATION OF EXISTENCE AND EXACT LOCATION OF ALL SERVICES MUST BE OBTAINED FROM THE INDIVIDUAL UTILITIES BEFORE PROCEEDING WITH CONSTRUCTION.		B.M. ELEV.		DESIGNED BY: HC		CHECKED BY: HC		DRAWN BY: JH		APPROVED BY:		HOR. SCALE: as shown VERTICAL: as shown		RELEASED FOR CONSTRUCTION BY:		ENGINEER'S SEAL Monica Giesbrecht Member No. 101 Feb 22/16		THE CITY OF WINNIPEG PUBLIC WORKS DEPARTMENT ENGINEERING DIVISION SELKIRK AVENUE PAVEMENT RECONSTRUCTION ARLINGTON STREET TO SALTER STREET POWERS PLAZA UPGRADE GRADING PLAN		CITY DRAWING NUMBER P-3471-17 SHEET 17 OF 20 BID NO. 24-2016	
0		Issued for Tender		02/26/16		JH		DATE		FEB. 26/2016		DATE		FEB. 26/2016		CONSULTANT DRAWING NO. L3.0																							