

RIGHT-OF-WAY CROSS SECTION SELKIRK AVENUE  
ANDREWS STREET TO SALTER STREET  
N.T.S.

DESCRIPTION	RIM ELEV.	INVERT		
		EAST	WEST	NORTH SOUTH
CB 35	231.705	230.250		230.105
CB 36	231.665			230.065
CB 37	231.600	230.650	230.650	230.000
CP 17	231.600			230.600

- REFERENCE NOTES**
- A. PAVEMENT DIMENSIONS ARE TO BACK OF CURB
  - B. BASELINE IS CENTRELINE OF RIGHT-OF-WAY
  - C. PROPERTY LINES OBTAINED FROM THE CITY OF WINNIPEG L.B.I.S., AND NO SCALE FACTOR WAS APPLIED
  - D. REFER TO AECOM FIELD BOOK NO. 4703
  - E. REFER TO DWGS CT-12 TO CT-14 FOR STREETSCAPING ELEMENTS.

- CONSTRUCTION NOTES**
1. REMOVE EXISTING PAVEMENT, INCLUDING CONCRETE STREET CAR BEDDING AND WOOD TIES, AND CONSTRUCT NEW 230mm PLAIN DOWELLED CONCRETE PAVEMENT c/w 180mm BARRIER CURB (SEPARATE)
  2. CONSTRUCT NEW 200mm REINFORCED CONCRETE PAVEMENT
  3. REMOVE EXISTING CONCRETE SIDEWALK/PAVER STONE SIDEWALK AND CONSTRUCT NEW 100mm SIDEWALK c/w PAVING STONE BAND (REFER TO DETAIL 4 CT-14)
  4. INSTALL NEW CURB AND GUTTER INLET c/w CATCHBASIN (SD024) ON SOUTH SIDE (AP-008 & AP-009), AND NEW CATCHBASIN (SD-025) ON NORTH SIDE c/w SOLID COVER (AP-004 & AP-005). CONNECT NEW 250mm LEAD TO EXISTING COMBINED SEWER /MANHOLE
  5. INSTALL NEW CURB AND GUTTER INLET c/w CATCHPIT(SD023) AND CONNECT NEW 250mm LEAD TO NEW CATCHBASIN
  6. REMOVE EXISTING CATCHBASIN AND ABANDON EXISTING LEAD
  7. REMOVE EXISTING FRAME AND COVER AND INSTALL NEW FRAME AND SOLID COVER (AP-005 & AP-005)
  8. CONSTRUCT NEW MONOLITHIC CURB RAMP (10mm HT. INTEGRAL)
  9. CONSTRUCT NEW MODIFIED BARRIER CURB (180mm HT. INTEGRAL)
  10. REMOVE EXISTING CURB AND GUTTER INLET AND LEAD
  11. ADJUST EXISTING CATCHBASIN/MANHOLE FRAME AND COVER
  12. ADJUST EXISTING WATERMAIN VALVE BOX TO GRADE
  13. INSTALL NEW 50mm CAST IRON RISER RING
  14. INSTALL 150mm SUBDRAIN 12m ON EACH SIDE OF CATCHBASIN
  15. ADJUST EXISTING CURB STOP TO GRADE
  16. INSTALL NEW DETECTABLE SURFACE WARNING TILES
  17. PLACE 50mm ASPHALT PAVEMENT (TYPE 1A)
  18. CONSTRUCT CONCRETE TREE WELL (REFER TO CT-14)
  19. REMOVE EXISTING TREE WELL
  20. EXISTING TRAFFIC SIGNAL POLE TO BE RELOCATED (BY OTHERS)
  21. EXISTING STREET LIGHT POLE TO BE RELOCATED (BY OTHERS)
  22. DECORATIVE BASKETS W/ ATTACHMENT BRACKETS (REFER TO CT-14)
  23. REMOVE AND REINSTALL EXISTING PARKING PAY STATION (BY OTHERS)
  24. INSTALL FLOW RESTRICTOR PIPE 150mm SDR 35 CENTER RESTRICTOR PIPE IN CB LEAD (SD-122)
  25. CONTRACTOR TO SALVAGE AND RE-INSTALL ALL GAS METER BOLLARDS DURING SIDEWALK REPLACEMENT

CAUTION: SHALLOW GAS SERVICES

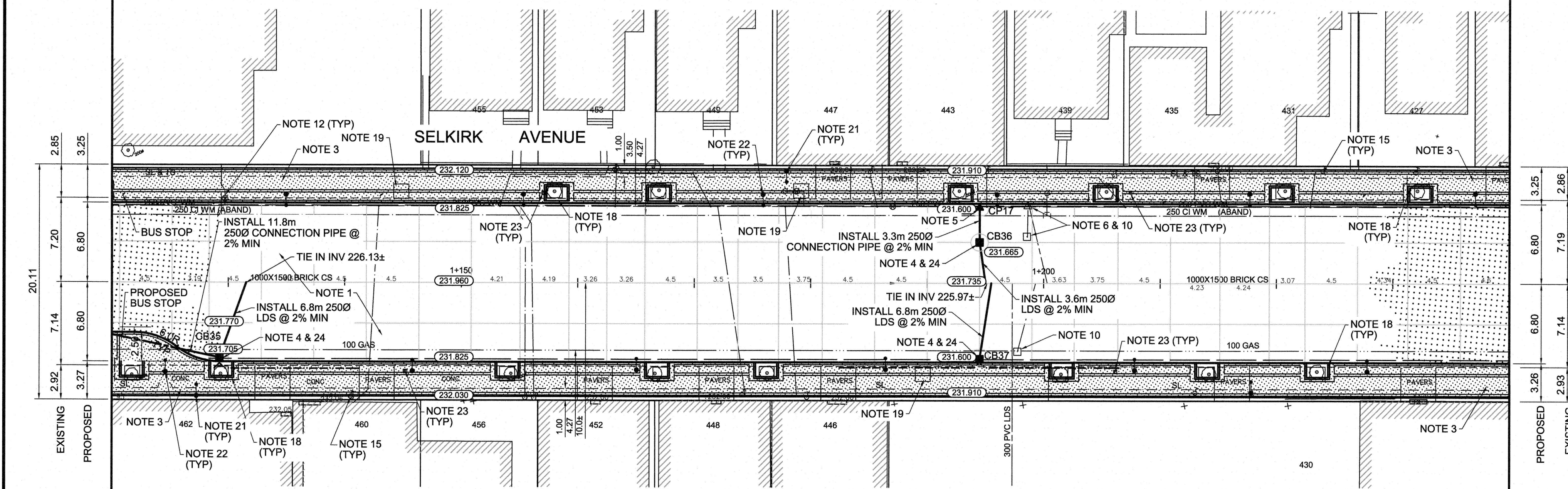
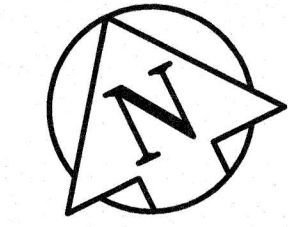

EXISTING	LEGEND - PLAN	PROPOSED	EXISTING	LEGEND - PLAN	PROPOSED	EXISTING	LEGEND - PROFILE	PROPOSED
150 mm W.M.	WATERMAIN	150 mm W.M.	---	HYDRO	---	---	C PROFILE	---
Hydrant	HYDRANT	Hydrant	---	M.T.S.	---	---	NORTHWEST GUTTER	---
Valve	VALVE	Valve	---	CONCRETE	---	---	SOUTHWEST GUTTER	---
300mm L.D.S.	LAND DRAINAGE SEWER	300mm L.D.S.	---	ASPHALT	---	---	N/W PROPERTY LINE	---
250mm W.W.S.	WASTEWATER SEWER	250mm W.W.S.	---	PROPERTY LINE	---	---	S/E PROPERTY LINE	---
Manhole	MANHOLE	Manhole	---	SURVEY BAR	---	---		---
Catch Basin	CATCH BASIN	Catch Basin	---	ELEVATION	---	---		---
Catch Pit	CATCH PIT	Catch Pit	---	TREE	---	---		---
Junctions	JUNCTIONS	Junctions	---	SIDEWALK RAMP	---	---		---
Culvert	CULVERT	Culvert	---	CONCRETE SIDEWALK	---	---		---
Gas	GAS	Gas	---	FENCE	---	---		---

**LOCATION APPROVED UNDERGROUND STRUCTURES**  
*Approved Per 2014/02/17*  
 SUPV. U/G STRUCTURES COMMITTEE DATE

**NOTE:**  
 LOCATION OF UNDERGROUND STRUCTURES AS SHOWN ARE BASED ON THE BEST INFORMATION AVAILABLE. BUT NO GUARANTEE IS GIVEN THAT ALL EXISTING UTILITIES ARE SHOWN OR THAT THE GIVEN LOCATIONS ARE EXACT. CONFIRMATION OF EXISTENCE AND EXACT LOCATION OF ALL SERVICES MUST BE OBTAINED FROM THE INDIVIDUAL UTILITIES BEFORE PROCEEDING WITH CONSTRUCTION.

B.M. 25 - 011 N.W. Cor. Arlington St. & Selkirk Ave. Tblt. In .Contc. foundation of King Edward Community School, 0.5m W. & 0.1 m below Tyndall Stone of most S.Ely. Cor.

NO.	REVISIONS	DATE	BY
0	ISSUED FOR TENDER	02/26/2016	KR
A	ISSUED FOR REVIEW	01/25/2016	BC

**AECOM**

DESIGNED BY: KWR/BC  
 CHECKED BY: KWR

DRAWN BY: PP/PB  
 APPROVED BY:

HOR. SCALE: 1:250  
 VERTICAL: 1:10

RELEASED FOR CONSTRUCTION BY:

DATE: 12/03/2015



**THE CITY OF WINNIPEG**  
 PUBLIC WORKS DEPARTMENT  
 ENGINEERING DIVISION

SELKIRK AVENUE PAVEMENT RECONSTRUCTION  
 ARLINGTON STREET TO SALTER STREET

PLAN/PROFILE  
 STATION 1+120 TO STATION 1+240

CITY DRAWING NUMBER: P-3471-10  
 SHEET 10 OF 20



**METRIC**  
 WHOLE NUMBERS INDICATE MILLIMETRES  
 DECIMALIZED NUMBERS INDICATE METRES